

# EASTLAKE COMMONS

44801-44975 Hayes Road / Sterling Heights, MI



**MID-AMERICA**<sup>®</sup>  
Real Estate-Michigan, Inc.

**FOR LEASE**

**AVAILABLE**  
**11,638 - 38,661 SF**



**RETAIL OPPORTUNITY**

# EASTLAKE COMMONS



## Address

44801- 44975 Hayes Road  
Sterling Heights, MI 48313

## Availability

1,500 SF  
11,638 - 38,661 SF

## Features

Eastlake Commons is situated along the Hall Road corridor in Sterling Heights, on the southwest corner of M-59 and Hayes Road. The Hall Road retail corridor is a vibrant shopping destination, featuring an array of national and local retailers. The corridor is anchored by two major malls and sees daily traffic volumes that exceed 80,000 vehicles. Hall Road stands as one of Metro Detroit's most active retail corridors and serves as a first-to-market entry point for retailers looking to establish a strong presence in the region. Anchor position available.

## Area Tenants



## Demographics (2025)

	1 MILE	3 MILES	5 MILES
POPULATION	12,925	110,857	256,894
HOUSEHOLDS	6,461	46,303	103,132
AVG HOUSEHOLD INCOME	\$79,762	\$109,600	\$112,407
DAYTIME POPULATION	16,988	95,662	237,067

# EASTLAKE COMMONS

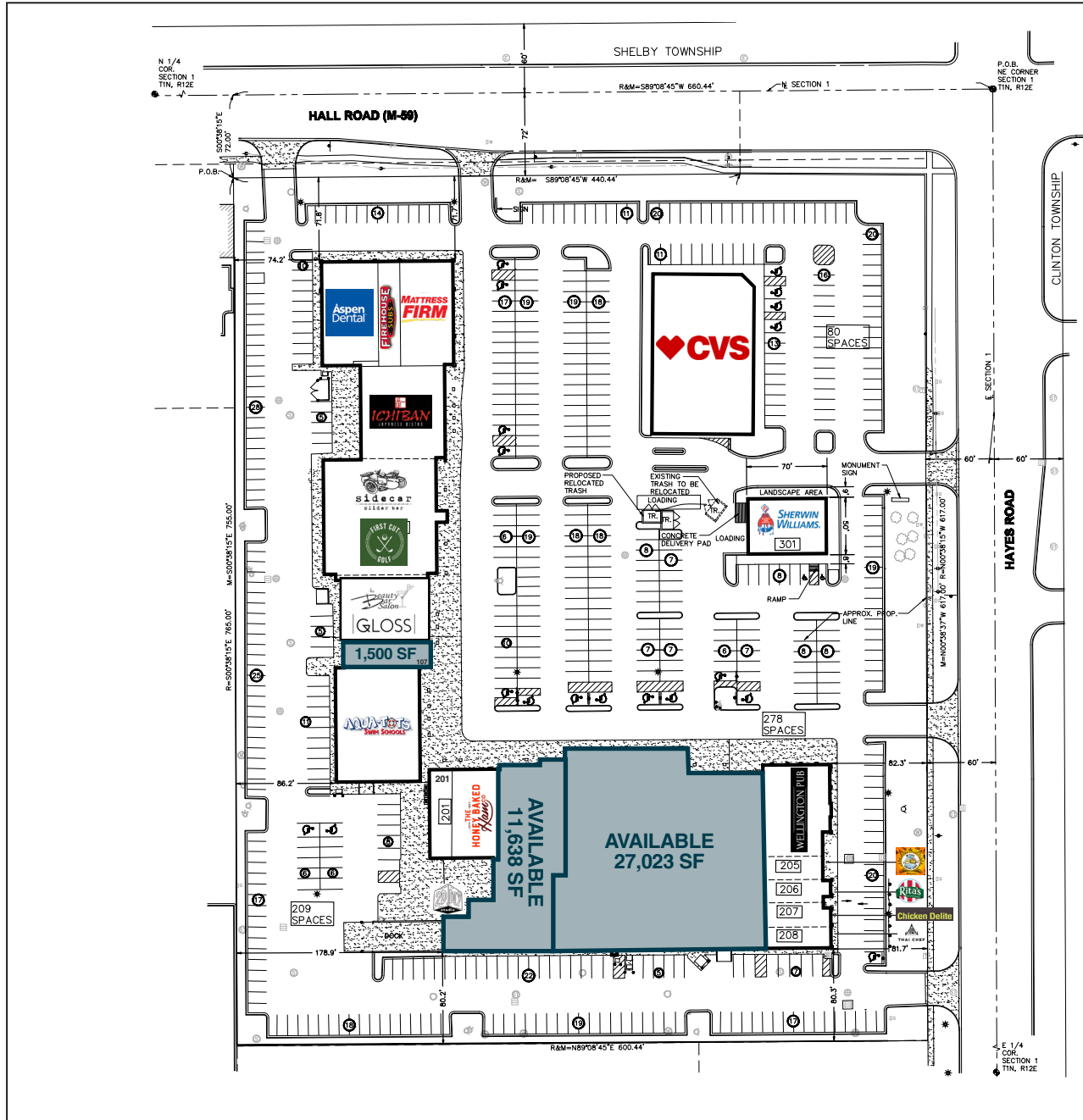

# EASTLAKE COMMONS

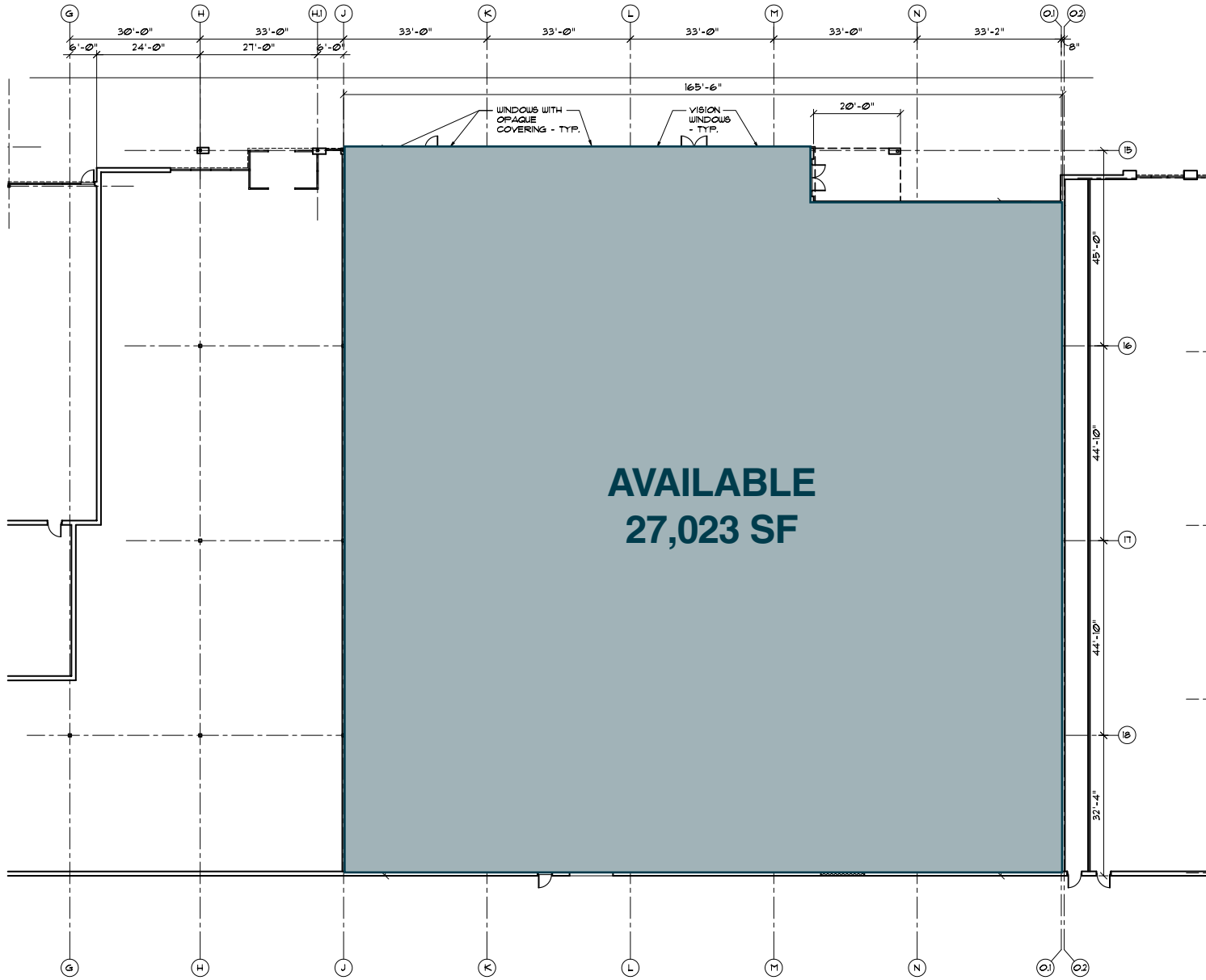

**AVAILABLE  
27,023 SF**

# EASTLAKE COMMONS

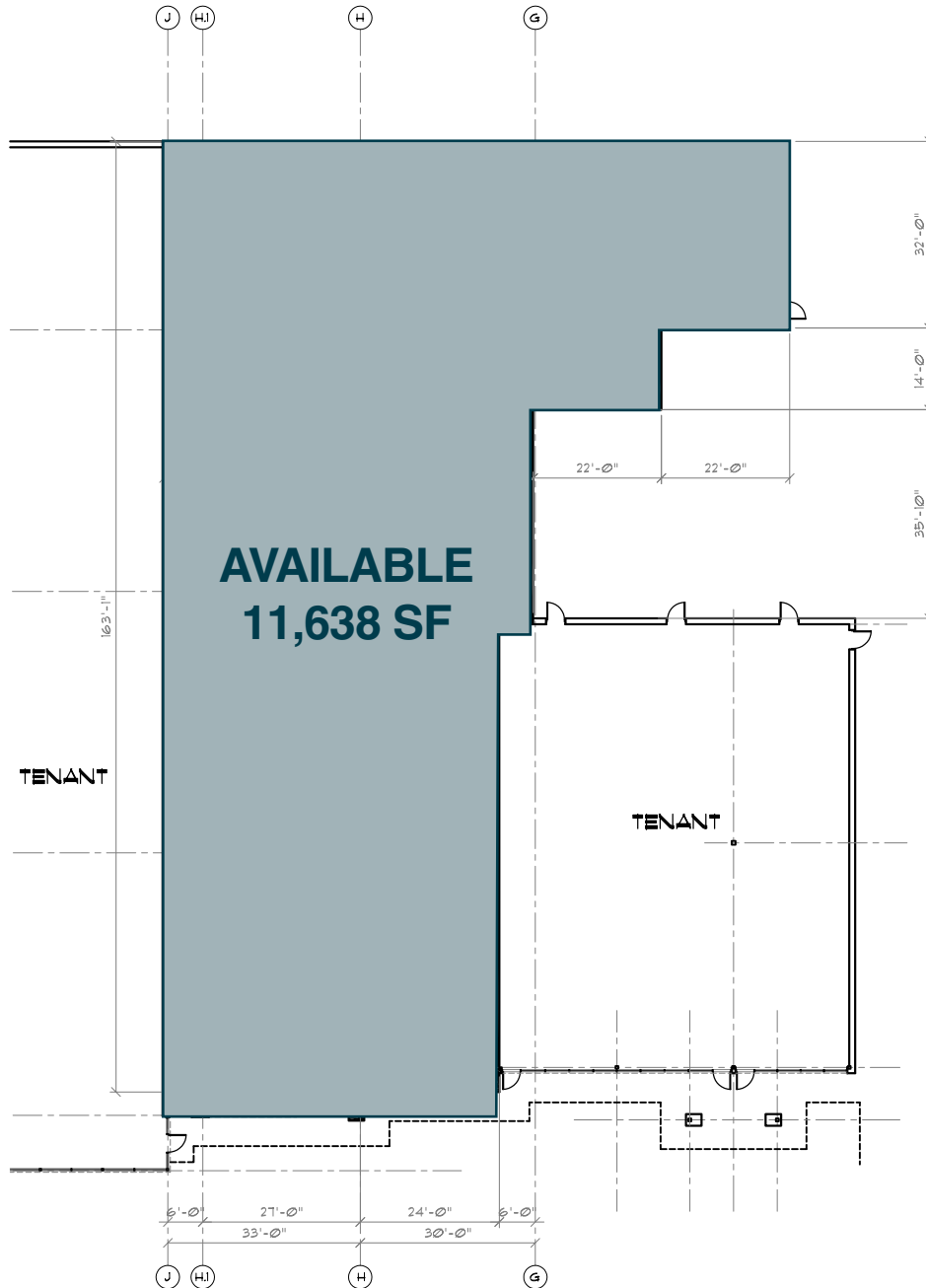

# EASTLAKE COMMONS





# EASTLAKE COMMONS



Eric  
Unatin

Mid-America Real Estate -  
Michigan, Inc.  
T: 248.855.6800  
[EUnatin@MidAmericaGrp.com](mailto:EUnatin@MidAmericaGrp.com)

Anthony  
Mekani

Mid-America Real Estate -  
Michigan, Inc.  
T: 248.855.6800  
[AMekani@MidAmericaGrp.com](mailto:AMekani@MidAmericaGrp.com)



38500 Woodward Ave, Suite 100  
Bloomfield Hills, Michigan 48304  
248.855.6800  
[MidAmericaGrp.com](http://MidAmericaGrp.com)