



Property Card: MAIN STREET 0201-0205
 Town of Brattleboro, VT



Proval PIN: 00275405.000
Parcel Number: 00275405.000
Parent Parcel Number: N/A

Owner: BRATTLEBORO REAL ESTATE
Co-Owner: INVESTMENTS

Mailing Address:
 PO BOX 357
Tax ID: BRATTLEBORO, VT 05302-0357
Property Class: 081-025-11380
Jurisdiction: 334 - Bank Buildings
Area: 025
 081

SITE DESCRIPTION

Topography: Level **Land Type:** Primary Commercial
Electric: Y **Street or Road:** Paved
Gas: N/A **Legal Acres:** 1.14
Water: Y
Sewer: Y

VALUATION RECORD

Assessment Year				04/01/2009	04/01/2010
Reason for Change				2009	2010
Valuation Assessed	L			\$0	\$249,840
	B			\$916,100	\$743,880
	T			\$916,100	\$993,720

SALE HISTORY

Sale Price 1: \$900,000	Sale Price 2:
Sale Date 1: 3/17/2006	Sale Date 2:
Book / Page: 347 267	Book / Page:
Grantor: NOT AVAILABLE	Grantor:



www.cai-tech.com

This information is believed to be correct but is subject to change and is not warranted.

SUMMARY OF IMPROVEMENTS

ID: C01

Use: General Office Grade: Avg- Const Type: Building Type: General Office:001 Stories: 3 Exterior: Year Built: 1982 Condition: below normal for age Fin Size SF: Foundation: Frame: Roof Desc: 1 Roof Material: Central AC:	Heating: Bsmt SF: Fin Bsmt SF: Fireplace: Num Rooms: 0 Num Bedrooms: Num Full Baths: 0 Num Half Baths: Enclosed Porch SF: Open Porch SF: Deck SF: Att. Garage SF: N/A Det. Garage SF: N/A Att. Carport SF: N/A
--	---

OUTBUILDINGS

ID: C01

Outbuilding 1: Res Paving
Outbuilding 2: ATMKiosk
Outbuilding 3: Elevator-Commercial MS
Outbuilding 4: N/A



www.cai-tech.com

This information is believed to be correct but is subject to change and is not warranted.

BUILDING SKETCH

201-205 Main Street

00275405.000

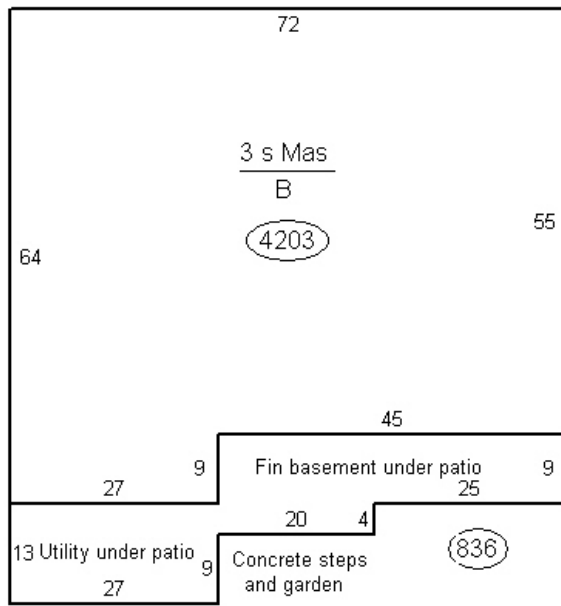

05

06

08



www.cai-tech.com

This information is believed to be correct but is subject to change and is not warranted.