

# CONCEPTUAL SITE PLAN

**AVAILABLE VARIOUS S.F. OFFICE / RETAIL SPACES WITHIN AN EXISTING TWO STORY 30,891 S.F. MULTI-TENANT BUILDING**

**PARCEL #1  
10-196 KEYSTONE AVENUE  
CENTERPOINT COMMERCE AND  
TRADE PARK EAST - PHASE IIC  
JENKINS TOWNSHIP  
PITTSBURGH, PA 15260**

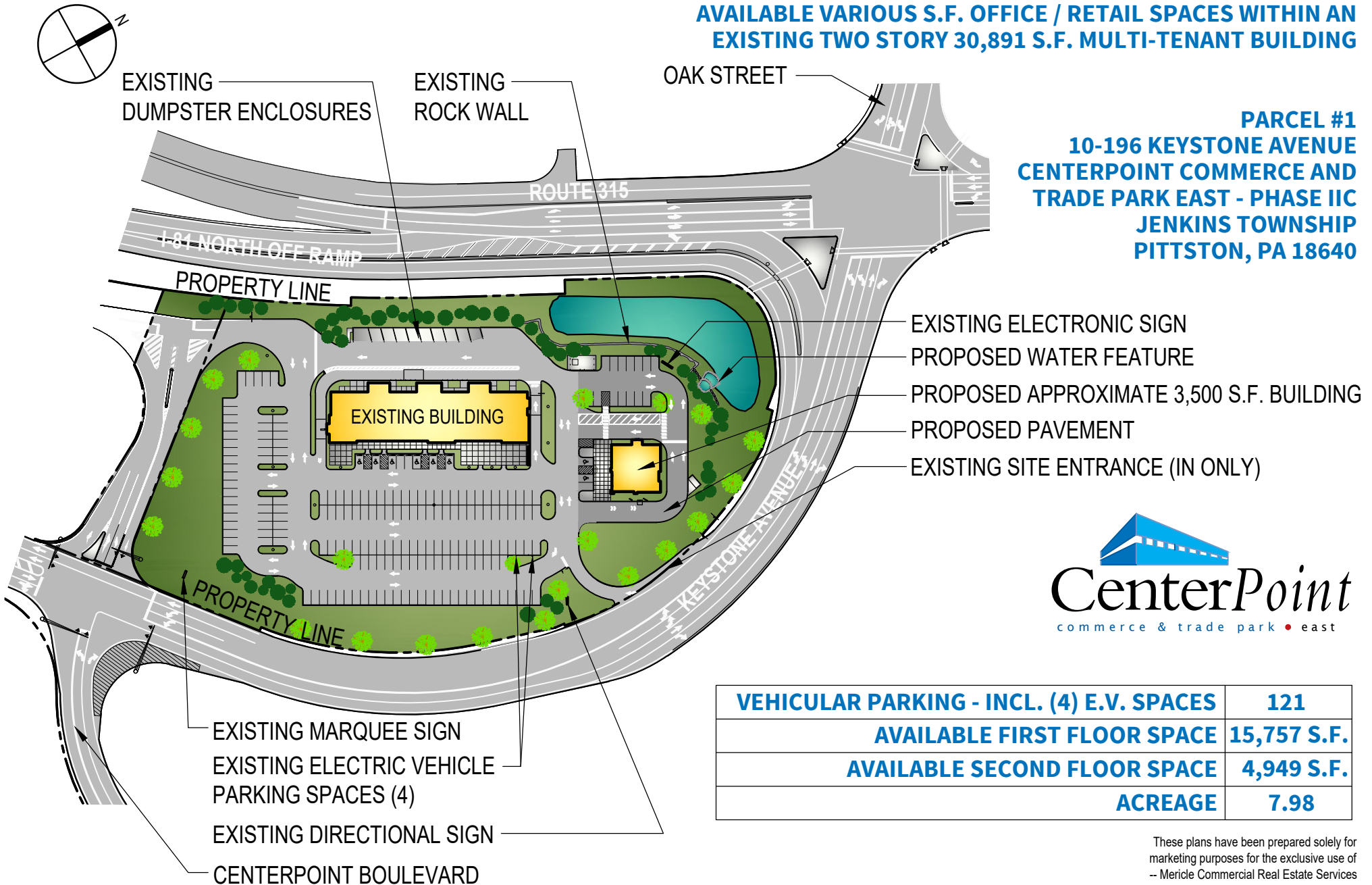

|  |                    |
|--|--------------------|
| <b>VEHICULAR PARKING - INCL. (4) E.V. SPACES</b> | <b>121</b>         |
| <b>AVAILABLE FIRST FLOOR SPACE</b>               | <b>15,757 S.F.</b> |
| <b>AVAILABLE SECOND FLOOR SPACE</b>              | <b>4,949 S.F.</b>  |
| <b>ACREAGE</b>                                   | <b>7.98</b>        |



These plans have been prepared solely for marketing purposes for the exclusive use of -- Mericle Commercial Real Estate Services

Q:\Shared\Properties\CPE IIC\100 Keystone (1) (J2658)\Base Bldg. (J2658)\2658\mdc\DWG-SPEC\mktg\MKT2658 - PARCEL 1 CPE-PHIC (08222023).dwg LD

570.823.1100



mericle.com



East Mountain Corporate Center  
100 Baltimore Drive, Wilkes-Barre, PA 18702

WE BUILD BUILDINGS.  
WE BUILD CAREERS.  
WE BUILD COMMUNITIES.