



FULLY FURNISHED HIGH IMAGE OFFICE CONDO
NEWPORT BEACH // FOR SALE // ±1,279 SF

4340 SUITE 250
VON KARMAN AVENUE
NEWPORT BEACH, CALIFORNIA



Lee & Associates® - Newport Beach (the "Agent") has been engaged as the exclusive sales representative for the sale of 4340 Von Karman - Suite 250, Newport Beach, CA (the "Property") by 'Ownership' (the "Seller").

The Property is being offered for sale in an "as-is, where-is" condition, and the Seller and Agent make no representations or warranties as to the accuracy of the information contained in this Offering Memorandum. The enclosed materials include confidential information and are being furnished solely for the purpose of review by prospective purchasers ("Purchasers") of the interest described herein for which it shall be fully and solely responsible. Neither the enclosed materials, nor any information contained herein, are to be used for any other purpose, or made available to any other person without the express written consent of the Seller. Each recipient, as a prerequisite to receiving the enclosed information, should be registered with the Agent as a "Registered Potential Investor" or as a "Buyer's Agent" for an identified "Registered Potential Investor." The use of this Offering Memorandum, and the information provided herein, is subject to the terms, provisions and limitations of the Confidentiality Agreement furnished by the Agent prior to delivery of this Brochure.

The material contained herein is based on information and sources deemed to be reliable, but no representation or warranty, express or implied, is being made by the Agent or the Seller or any of their respective representatives, affiliates, officers, employees, shareholders, partners, and directors, as to its accuracy or completeness. Summaries contained herein of any legal or other documents are not intended to be comprehensive statements of the terms of such documents, but rather only outlines of some of the principal provisions contained therein. Neither the Seller nor the Agent shall have any liability whatsoever for any other written or oral communication or information transmitted, or made available, or any action taken, or decision made by the recipient with respect to the Property.

The Seller reserves the right, at its sole and absolute discretion, to withdraw the Property from the market for sale at any time and for any reason without notice, to reject any and all expressions of interest or offers regarding the Property, and/or to terminate discussions with any entity at any time, with or without notice. This Offering Memorandum is made subject to omissions, correction of errors, change of price or other terms, prior sale or withdrawal from the market without notice. The Agent is not authorized to make any representations or agreements on behalf of the Seller. The Seller shall have no legal commitment or obligation to any recipient reviewing the enclosed materials, performing additional investigation, and/or making an offer to purchase the Property unless and until a binding written agreement for the purchase of the Property has been fully executed, delivered, and approved by Seller and any conditions required under the contract for title to pass from the Seller to the buyer have been satisfied or waived.

By taking possession of and reviewing the information contained herein, the recipient agrees that (a) the enclosed materials and their contents will be held and treated in the strictest of confidence; and (b) the recipient shall not contact employees, contractors, sub-contractors or lien-holders of the Property directly or indirectly regarding any aspect of the enclosed materials or the Property without the prior written approval of the Seller or the Agent; and (c) no portion of the enclosed materials may be copied or otherwise reproduced without the prior written authorization of the Seller or the Agent or as otherwise provided in the Confidentiality Agreement executed and delivered by the recipient(s) to Agent.

The Seller will be responsible for any commission due to the Agent in connection with a sale of the Property. However, any broker engaged by Purchaser ("Buyer's Broker") shall seek its commission only from the Purchaser. Under no circumstances will the Agent or the Seller be liable for same and recipient will indemnify and hold the Agent and the Seller harmless from any claims by any brokers having dealt with recipient other than the Agent. Any Buyer's Broker must provide a registration signed by the recipient acknowledging said Buyer's Broker's authority to act on the recipient's behalf.

EXCLUSIVELY LISTED BY:

BRIAN GARBUTT
SVP/Principal
DRE # 01215482
949.724.4721
bgarbutt@lee-associates.com





4340 SUITE 250

VON KARMAN AVENUE
NEWPORT BEACH, CALIFORNIA

04

PROPERTY
DESCRIPTION

06

FLOOR
PLAN

07

AREA
OVERVIEW

property description

BUILDING PROFILE

<i>Property Address</i>	4340 Von Karman, Suite 250 Newport Beach, CA 92660
<i>APN</i>	934-05-717
<i>Location</i>	Orange County
<i>Year Built/Renovated</i>	1976 - 2022
<i>Building Size</i>	±1,279 Square Feet
<i>Zoning</i>	PC Planned Commercial
<i>Parking</i>	3.2/1,000 SF, Surface Parking
<i>Flooring</i>	Concrete
<i>Construction</i>	Steel Frame

OFFERING SUMMARY

Association Fee:	\$1,120/Month
Offering Price:	\$1,058,000





property overview

OFFERING SUMMARY

Lee & Associates® – Newport Beach, as exclusive advisor, is pleased to present the opportunity to acquire the fee simple interest in an office condo located at 4340 Von Karman Avenue, Suite 250 Newport Beach, CA.

The office condo was completely renovated in 2022. The suite comes fully furnished with Herman Miller furniture offering a user the opportunity to purchase a turnkey class A property rivaling any office space in Orange County

4340 Von Karman Suite 250 offers close proximity to John Wayne Airport and is near numerous amenities including health clubs, restaurants and across the street from the Pacific Club, the premier business club in Orange County.

PROPERTY HIGHLIGHTS

- High image top of class office space
- Lake views from the private offices
- Suite comes turnkey with Herman Miller furniture
- 2 private offices

floor plan

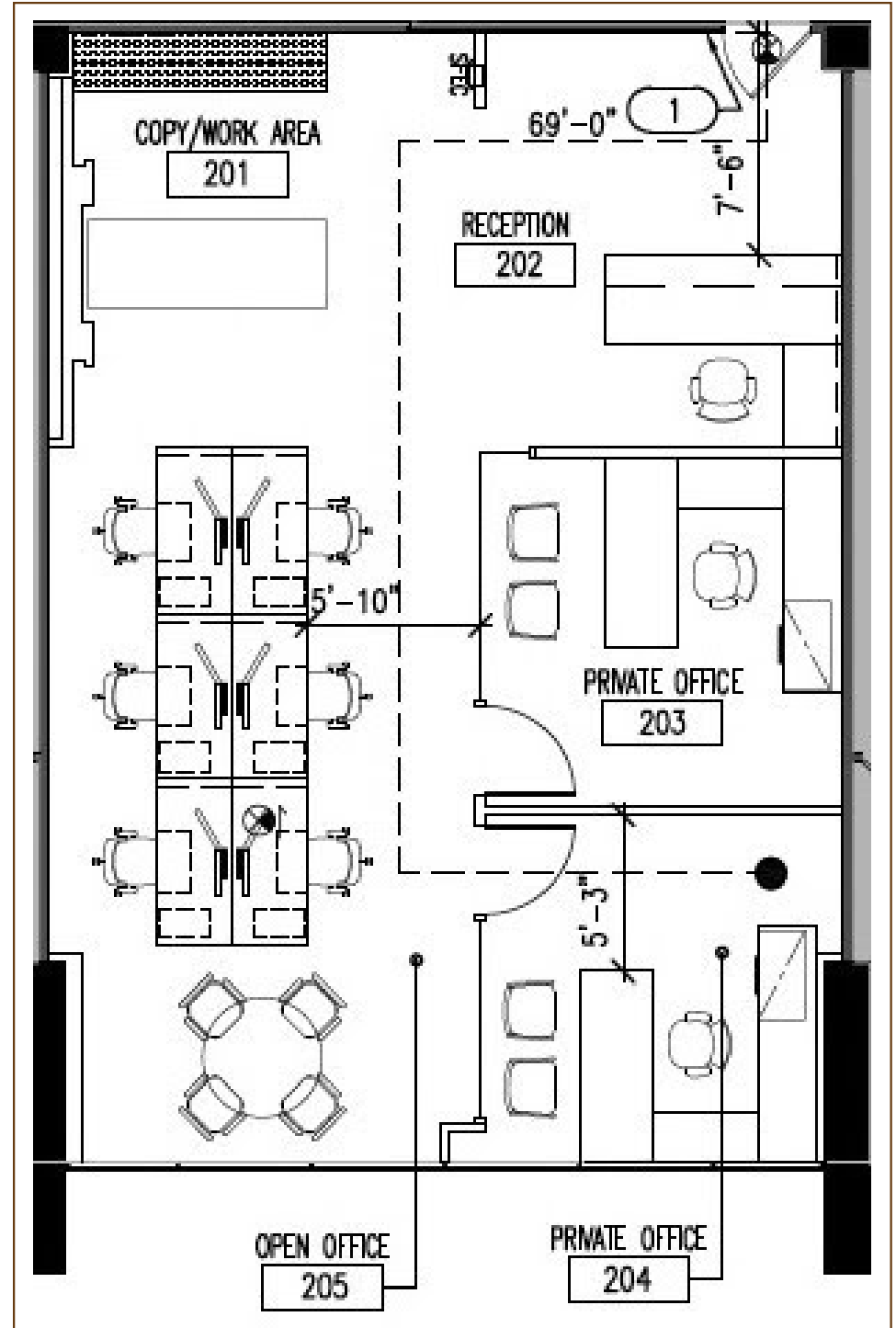

area overview

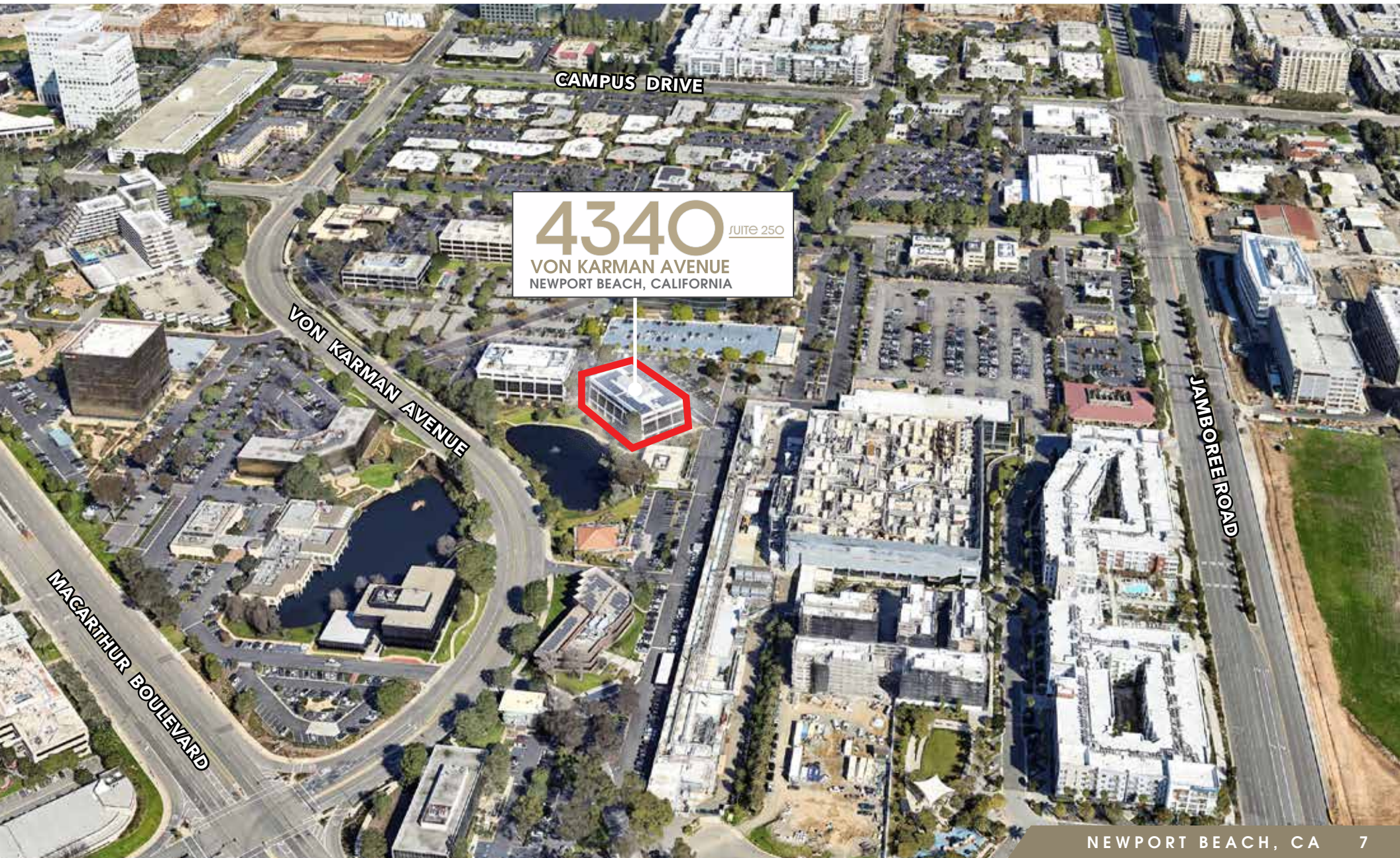

area overview...continued

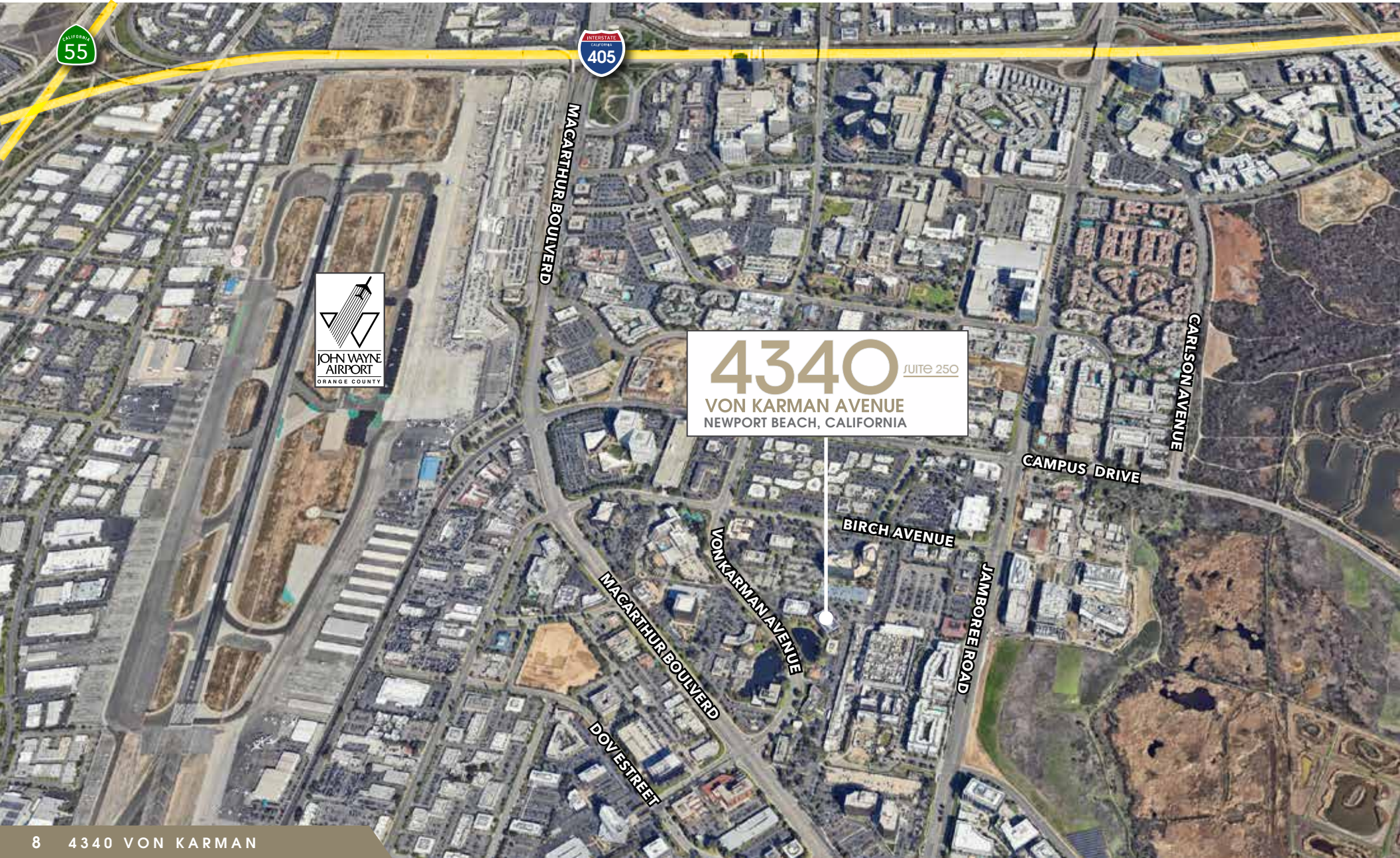

4340 SUITE 250
VON KARMAN AVENUE
NEWPORT BEACH, CALIFORNIA



FULLY FURNISHED HIGH IMAGE OFFICE CONDO

NEWPORT BEACH // FOR SALE // ±1,279 SF

4340

SUITE 250

VON KARMAN AVENUE

NEWPORT BEACH, CALIFORNIA

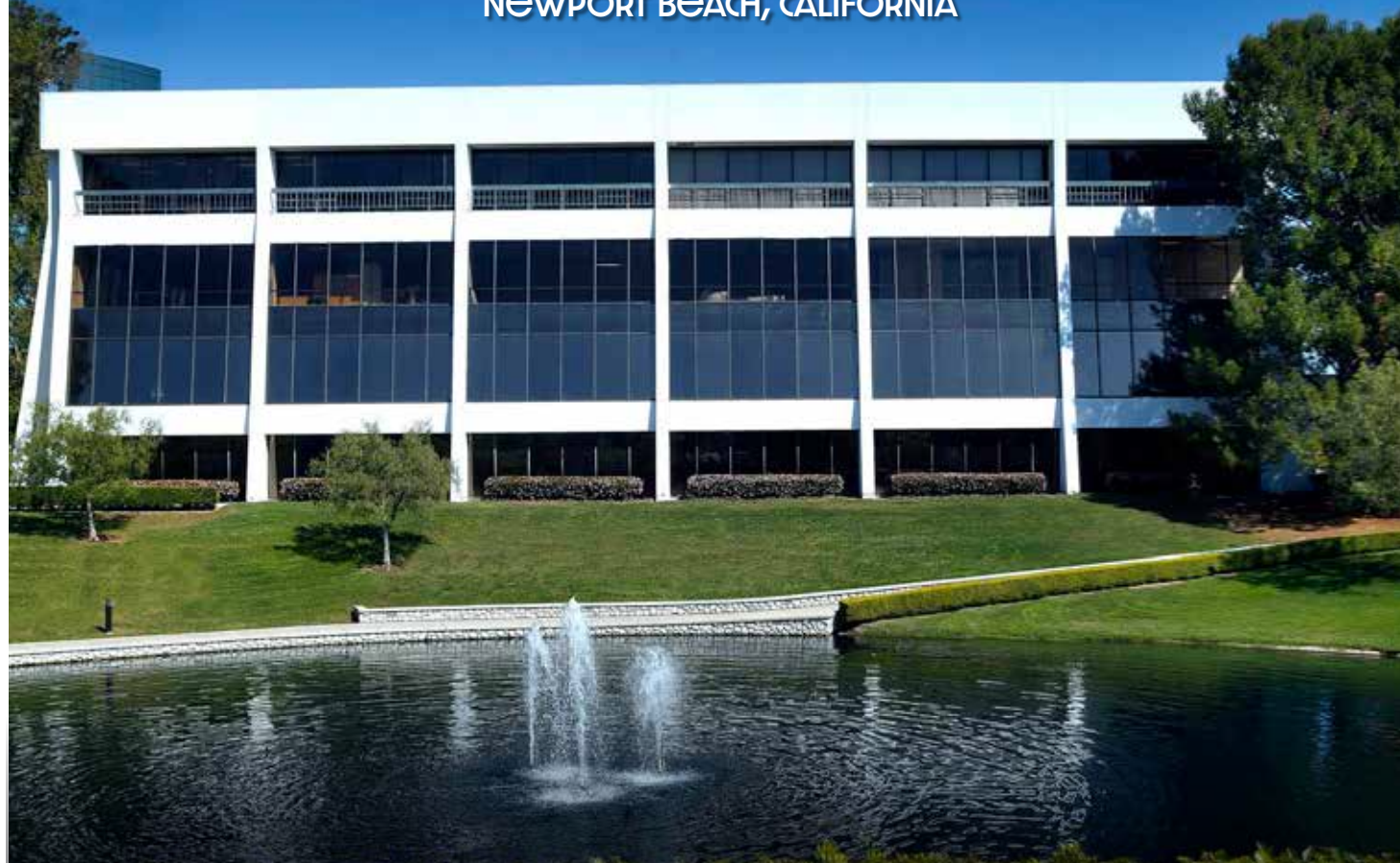

EXCLUSIVELY LISTED BY:

LEE & ASSOCIATES - NEWPORT BEACH
100 Bayview Circle, Suite 600
Newport Beach, CA 92660
949.724.1000
www.lee-associates.com

BRIAN GARBUTT
SVP/Principal
DRE # 01215482
949.724.4721

bgarbutt@lee-associates.com

 **LEE & ASSOCIATES**
COMMERCIAL REAL ESTATE SERVICES
NEWPORT BEACH

 **GARBUTT**
VALUE-ADD PROPERTY GROUP
OFFICE • INDUSTRIAL • RETAIL
"Maximizing Property Values"™