



**INTERSTATE**  
COMMERCE CENTER



- State-of-the-art industrial development located just south of 1960 with Frontage along Interstate 45
- Immediate access to Interstate 45, FM 1960 and less than five miles from Beltway 8
- Exceptional visibility from Interstate 45



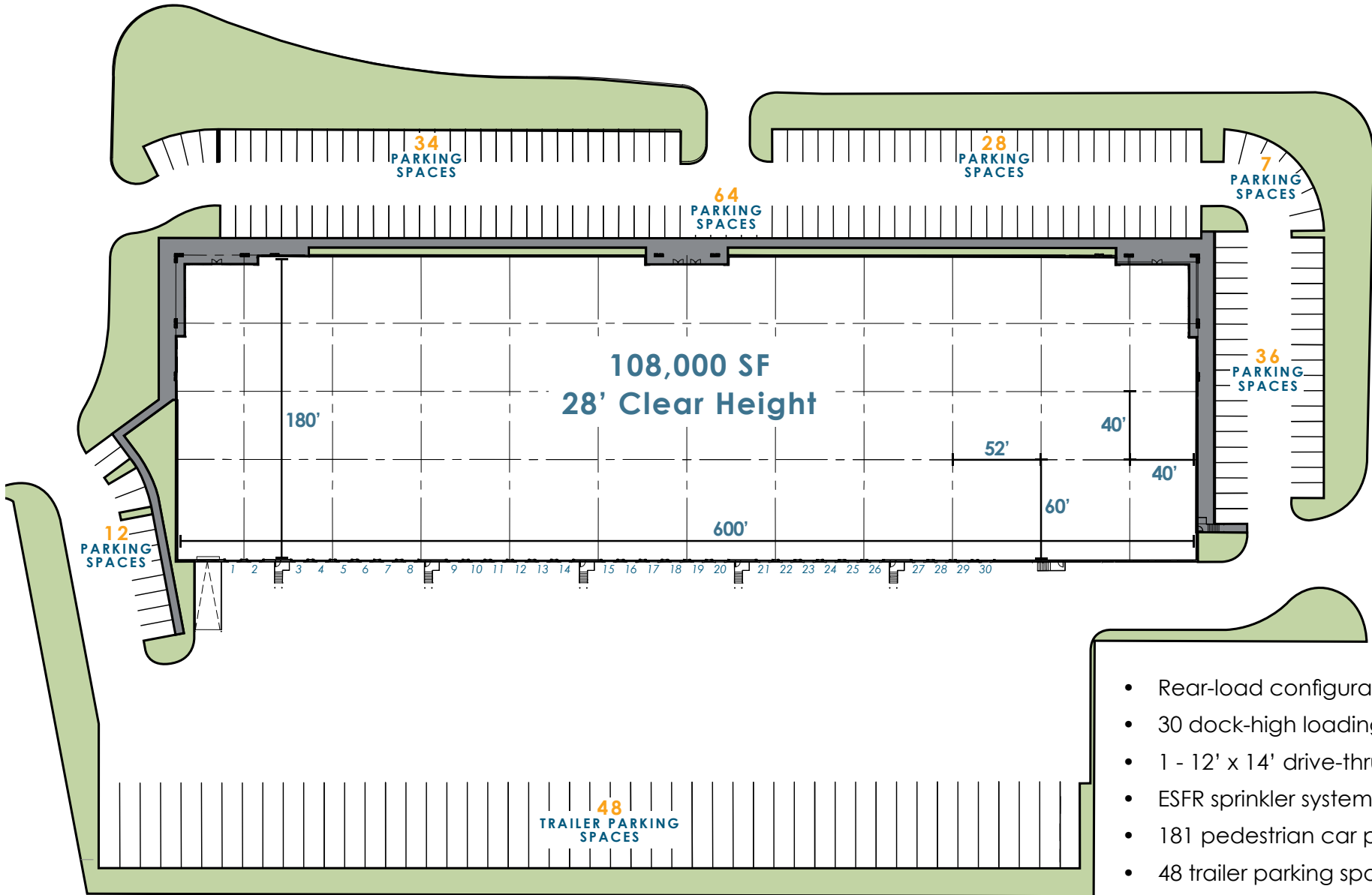

- Rear-load configuration
- 30 dock-high loading doors
- 1 - 12' x 14' drive-thru door
- ESFR sprinkler system
- 181 pedestrian car parking spots
- 48 trailer parking spots

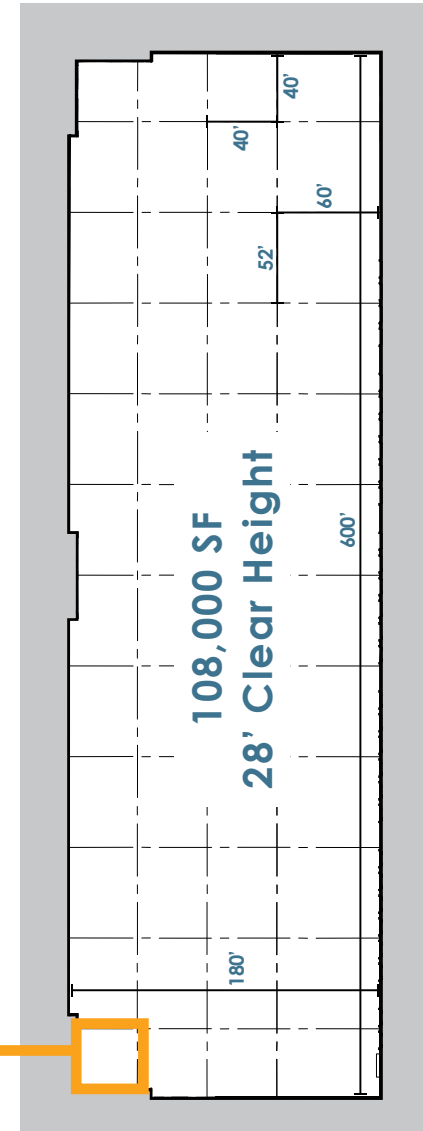
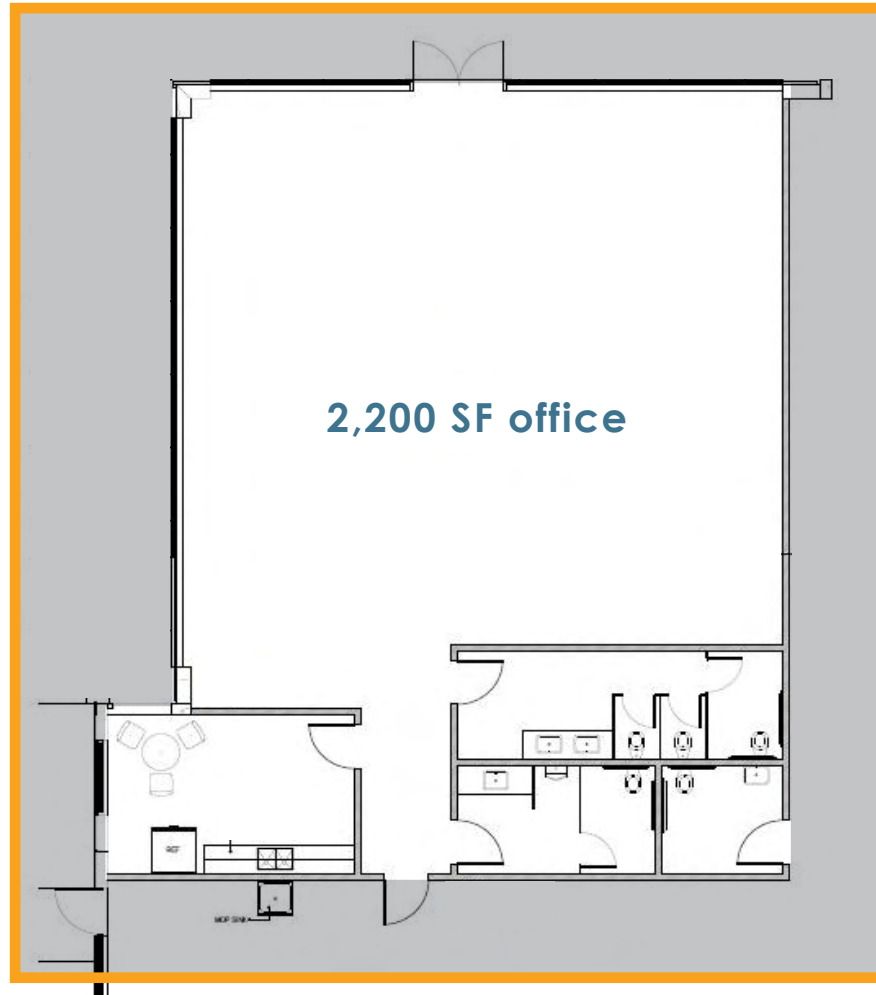



## LOCATION MAP

2031 + 2032 CYPRESS STATION DRIVE | HOUSTON, TEXAS 77090



**HIGH STREET**  
LOGISTICS PROPERTIES

FOR FURTHER INFORMATION, CONTACT:

**JEREMY LUMBRERAS**

[jlumbreras@streamrealty.com](mailto:jlumbreras@streamrealty.com)  
713.300.0322

**MEG ZSCHAPPEL**

[meg.zschappel@streamrealty.com](mailto:meg.zschappel@streamrealty.com)  
713.300.0284