

100

**FINANCIAL
PARK**

FRANKLIN, MA

FOR LEASE

10,000 AMPS OF POWER

NEW RENOVATIONS

- DEMO WORK
- WHITE BOXING

**±177,087 SF Advanced
Manufacturing Facility**



BUILDING SPECIFICATIONS

GALLERY

Building Size	±177,087 SF (subdividable)
Building Dimensions	459' x 397'
Loading	Four (4) loading docks One (1) drive-in door
Clear Height	21'
Column Spacing	30' x 40' (typical)
Zoning	Industrial
Year Built/Renovated	1981 / 1994
Site Size	32.34 acres
Power	10,000 amp 480V, 3-phase power
Sprinklers	Wet
Roof	EPDM
Zoning	Industrial
Utilities	Water & Sewer: Town of Franklin Gas: Eversource Electric: National Grid

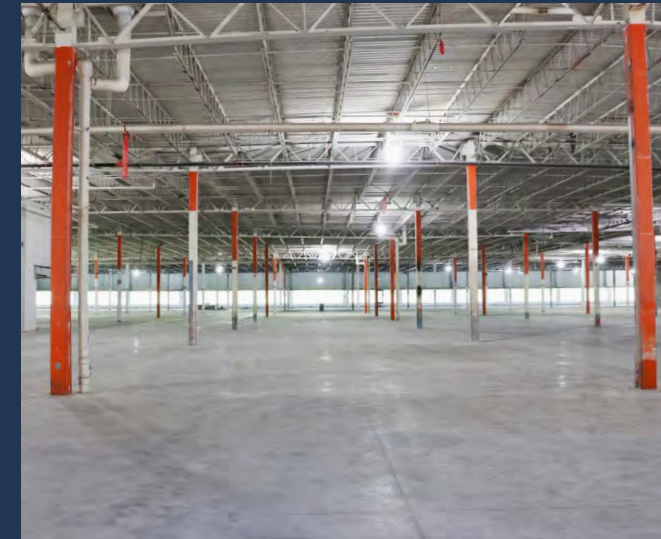

SITE PLAN

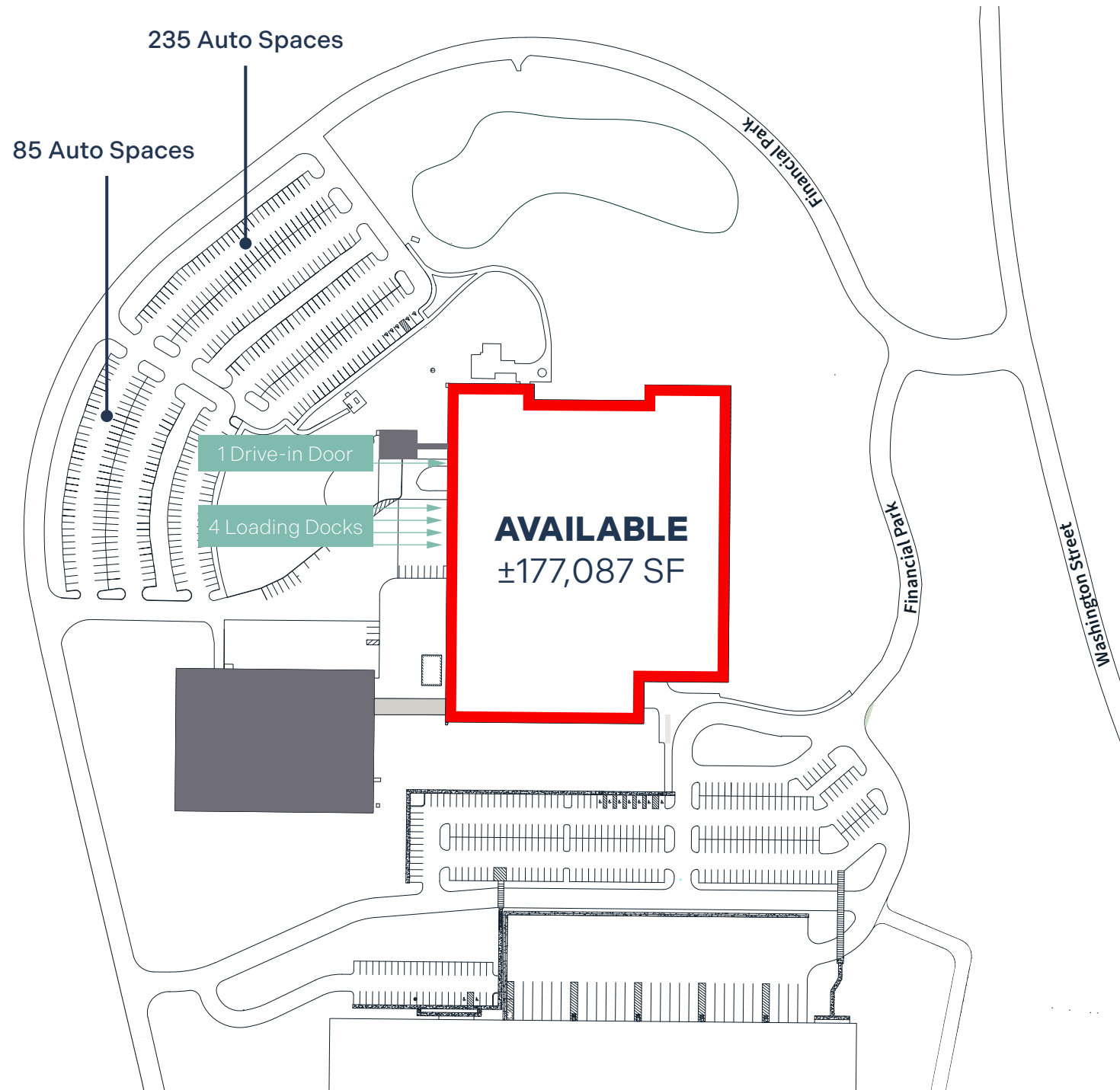

SUBDIVISION PLAN

- TENANT 1: ±89,315 SF
- TENANT 2: ±83,966 SF
- Common Area: ±3,806 SF

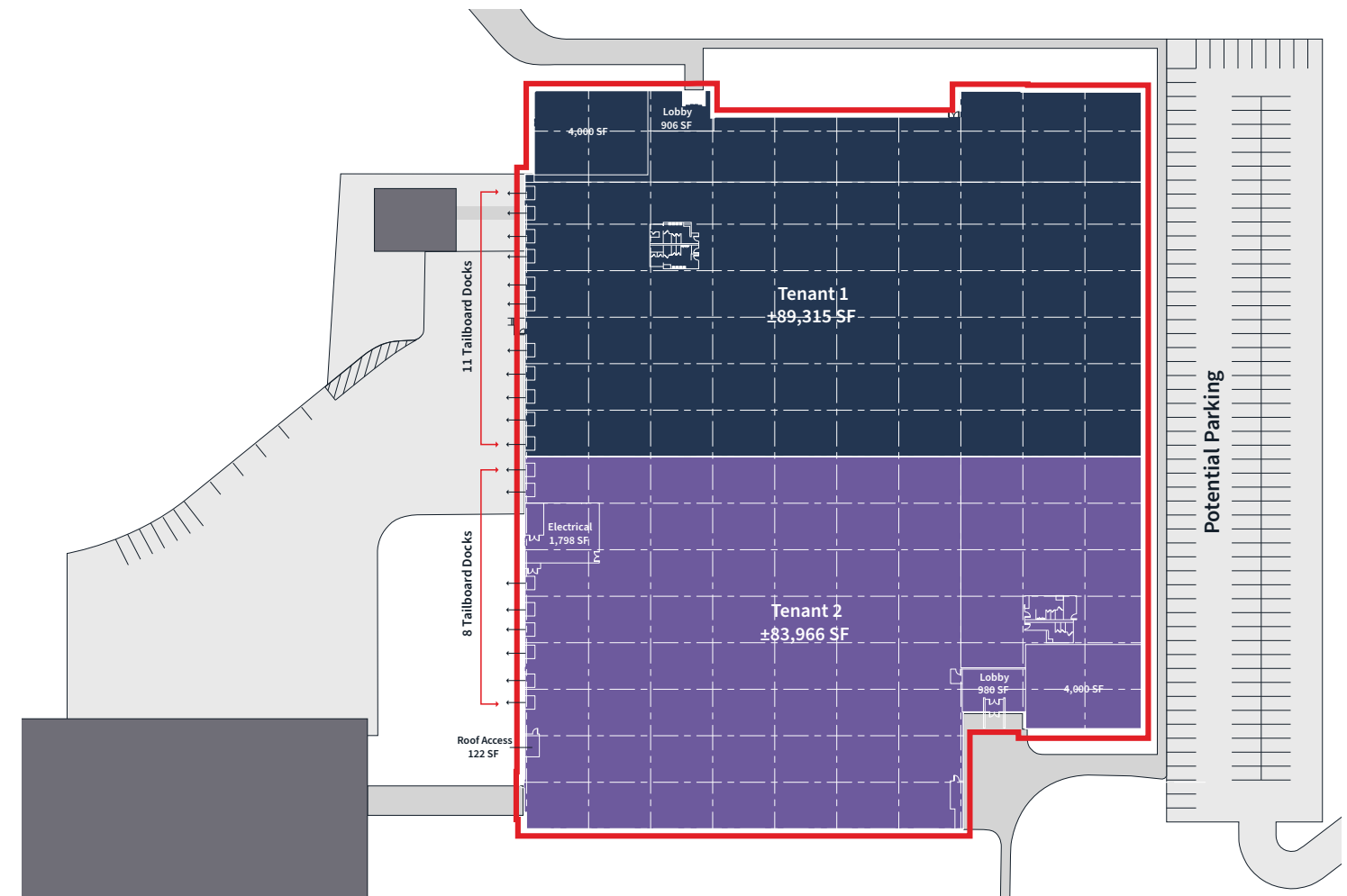

Proposed additional loading shown

LOCATION AND ACCESS

Amenity-Rich Submarket



REGIONAL MAP

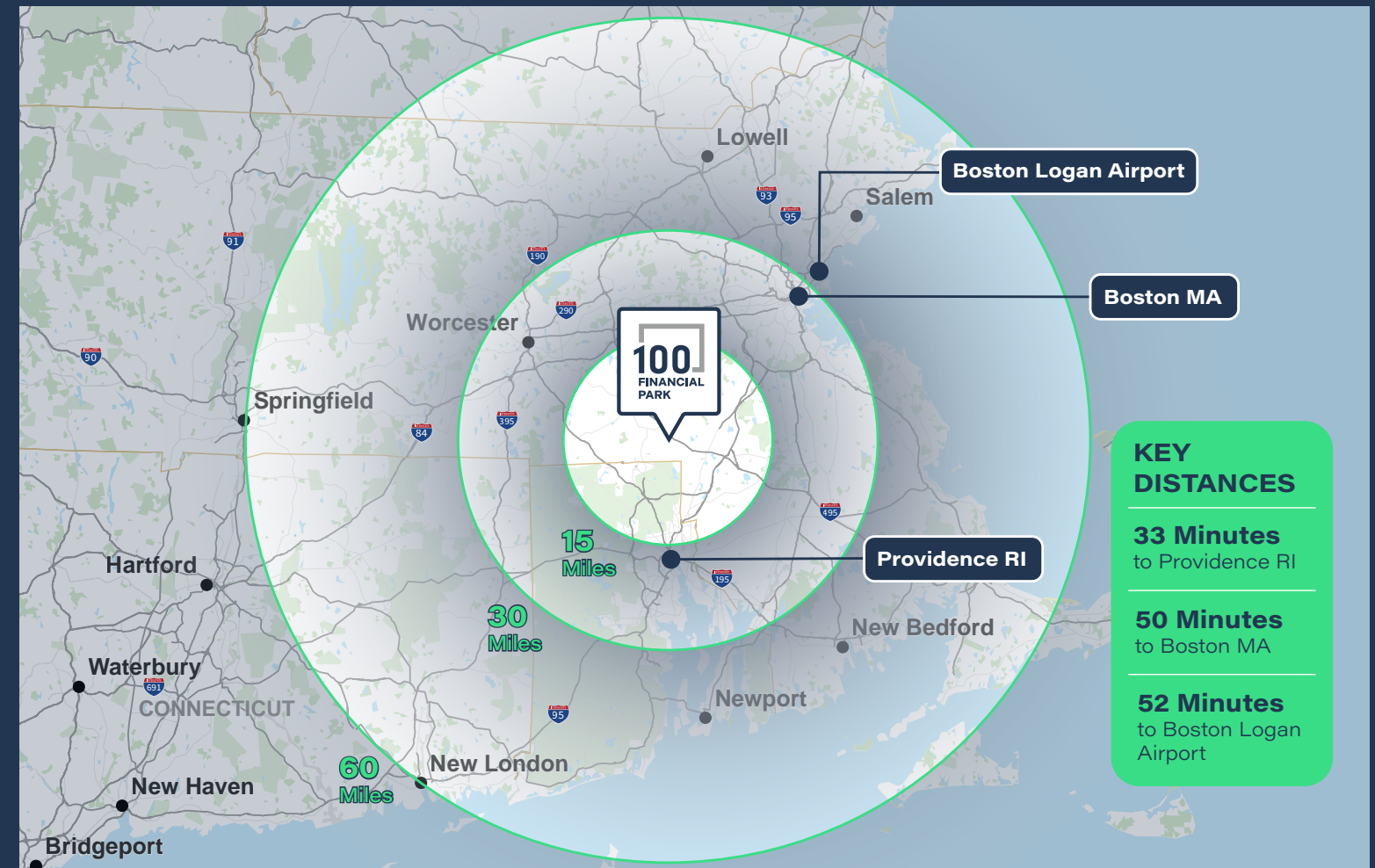



FOR MORE INFORMATION, CONTACT:

Rachel Marks

Rachel.Marks@jll.com
+1 508 259 2440

Michael Ciummei

Michael.Ciummei@jll.com
+1 978 621 7241

Joe Fabiano

Joe.Fabiano@jll.com
+1 781 844 7893

Chelsea Andre

Chelsea.Andre@jll.com
+1 508 951 7817

Dane Caracino

Dane.Caracino@jll.com
+1 617 640 0316

Kendall Sullivan

Kendall.Sullivan@jll.com
+1 978 882 3259

FOR LEASE
+177,087 SF

100
FINANCIAL
PARK

