



Inside Suite



Restroom



Parking lot

RETAIL SPACE FOR LEASE

642 E. 2nd Street. Irving, TX 75060

- **Suite 110** – ANM Insurance
- **Suite 120** – Barbershop
- **Suite 130** – Available, Approx. 900 sqft, \$2,500
- **Suite 140** – Available, Approx. 900 sqft, \$2,500

- **NNN** - included in the monthly rent

Building Square Footage

3.600

Year of Construction

2025

Real Estate Broker

Joe Goldsmith

214-499-8569

gdj405@gmail.com

*

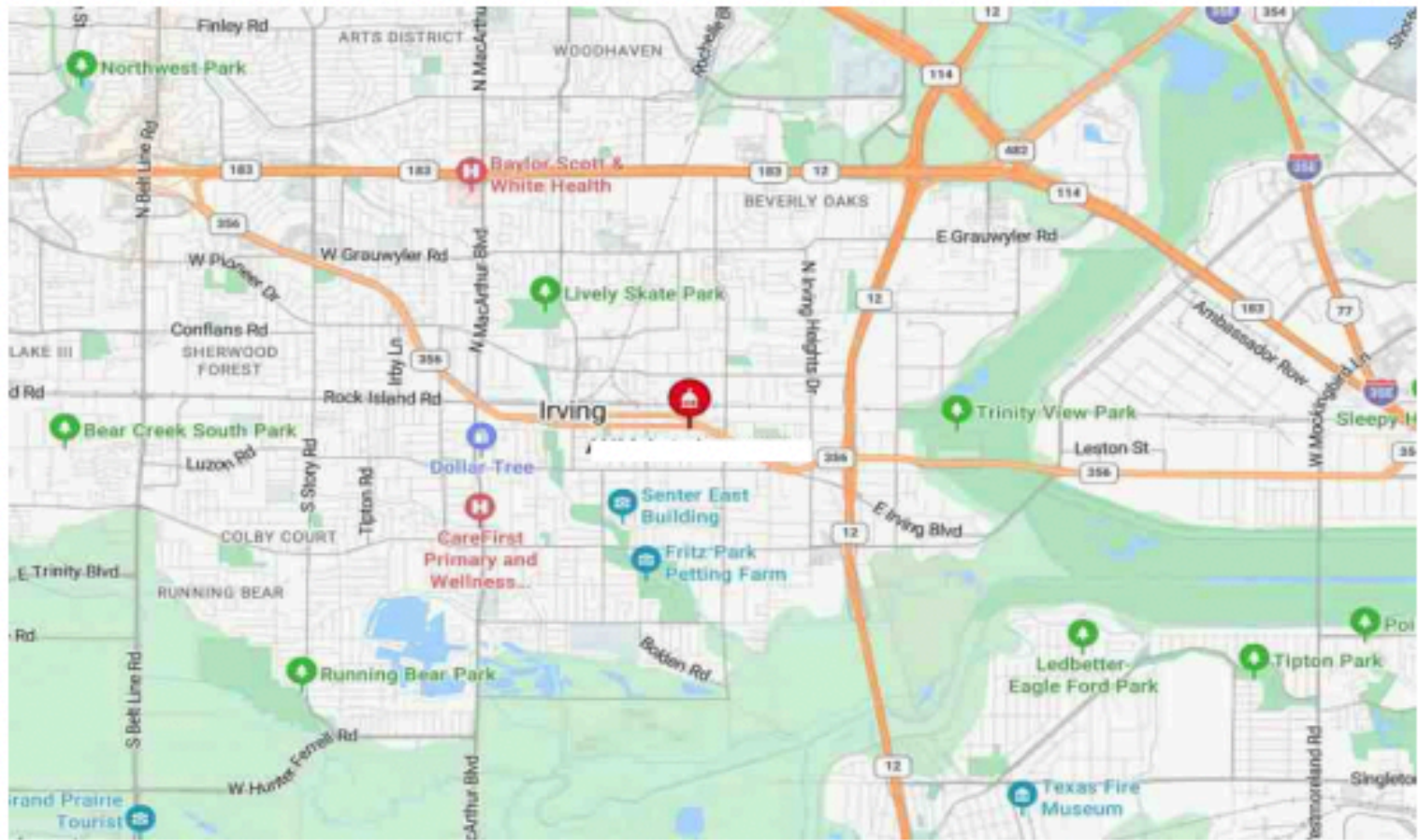
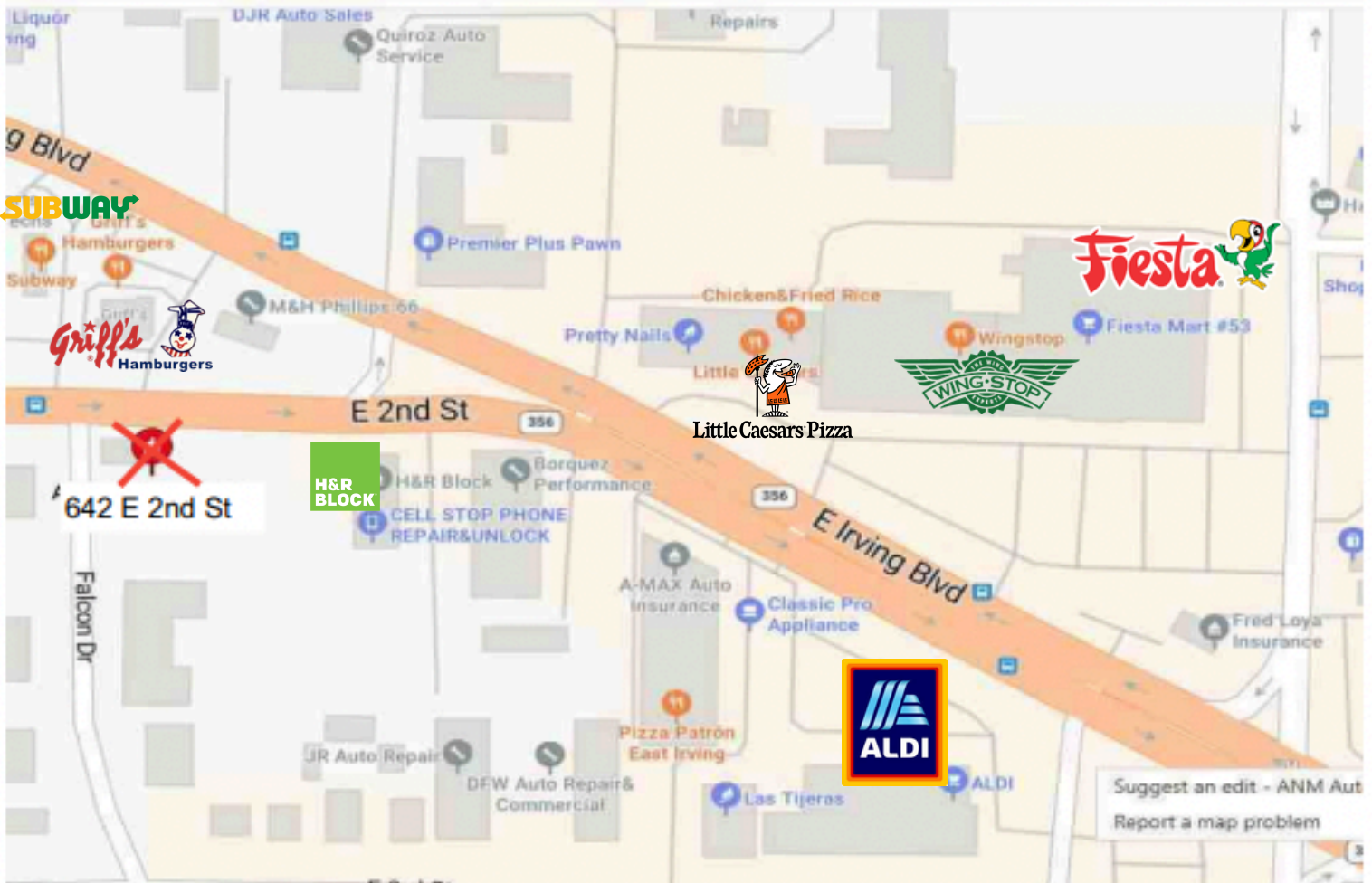

The information contained herein is believed to be correct, however, no representation as to the completeness or accuracy of this information is made. The property is subject to withdrawal from the market, change in price, or prior sale at any time.

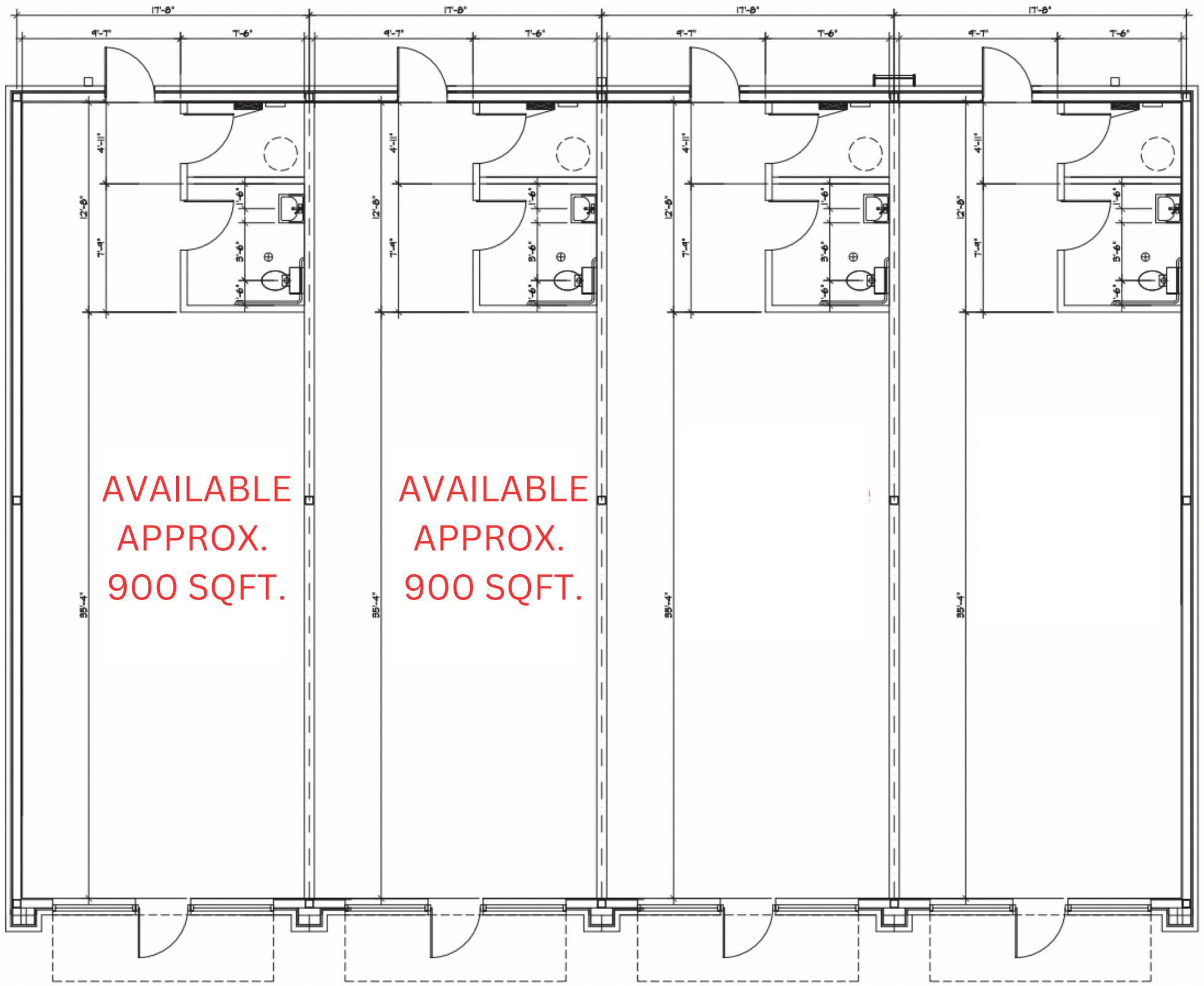

AVAILABLE
APPROX.
900 SQFT.

AVAILABLE
APPROX.
900 SQFT.

1

