

FOR SUBLEASE  
**5500 ADAMS STREET**  
MATTESON, IL



**20,432 SF AVAILABLE**



**UNIQUE OPPORTUNITY  
IMMEDIATE OCCUPANCY**

# PROPERTY FEATURES



**249,860 SF**

TOTAL BUILDING SIZE



**20,432 SF**

AVAILABLE SIZE



**PRE-CAST**  
CONSTRUCTION



**32'**

CLEAR HEIGHT



**ESFR**

SPRINKLER



**2 DOCKS**

LOADING



**10 SPACES**

CAR PARKING



**SUBJECT TO OFFER**

LEASE RATE

# PROPERTY SITE PLAN

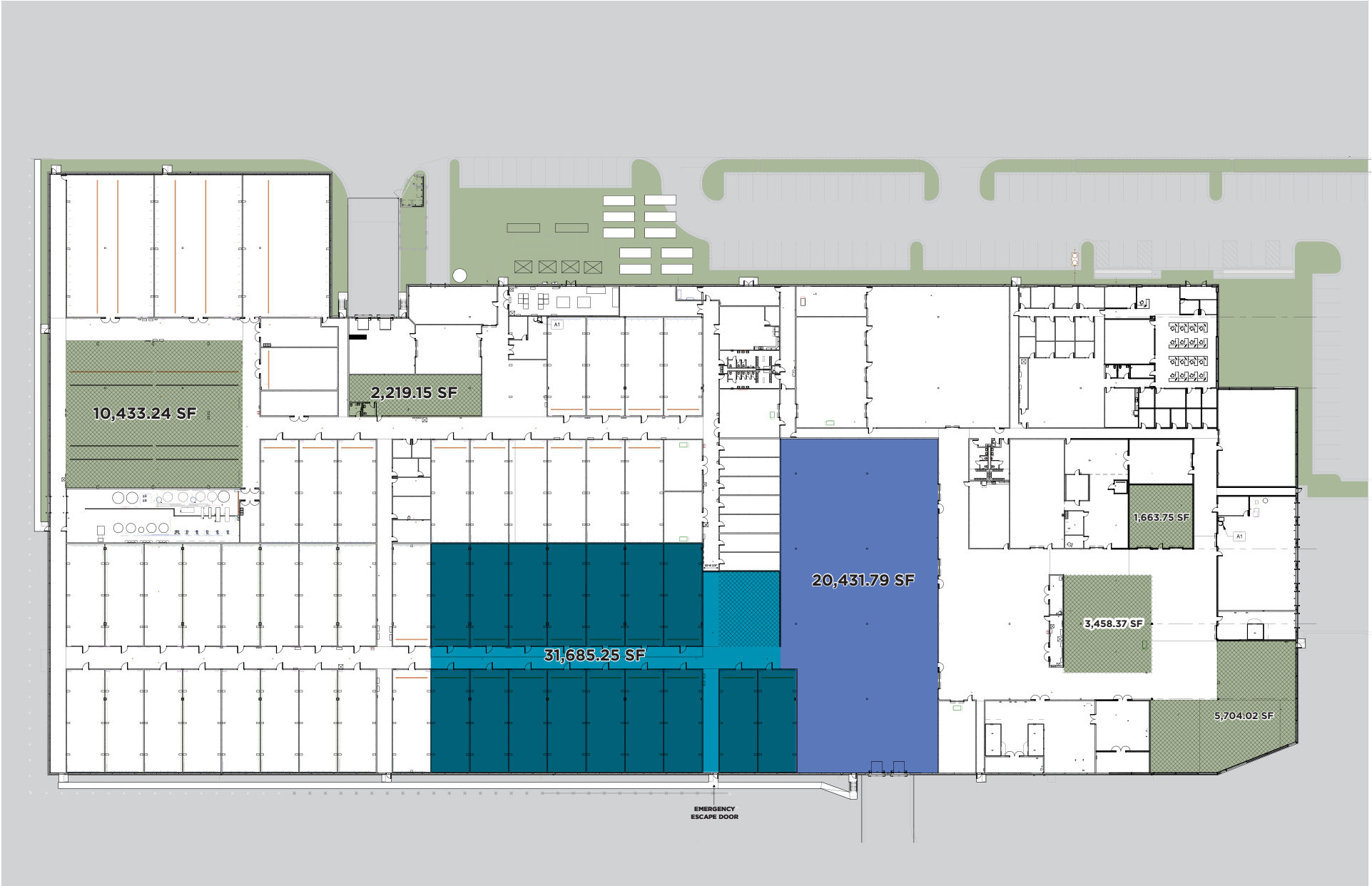

# PROPERTY PHOTOGRAPHY

**SITE**

S Central Ave

57



**CLASS 8 TAX INCENTIVE  
ALREADY APPROVED**



**STRATEGICALLY LOCATED 5  
MINUTES FROM I-57 & I-80  
INTERCHANGE**



**CENTRALLY LOCATED WITH  
CONVENIENT ACCESS TO 6  
INTERMODAL FACILITIES**



**SURROUNDED BY A RICH  
COLLECTION OF LOCAL  
AMENITIES INCLUDING RETAIL,  
RESTAURANTS AND MORE**

# PROPERTY AERIAL MAP



# PROPERTY PROXIMITY MAP



## DRIVE TIMES

**O'HARE INTERNATIONAL AIRPORT**  
45 miles / 45 minutes

**MIDWAY INTERNATIONAL AIRPORT**  
24 miles / 41 minutes

**CHICAGO CBD**  
32 miles / 37 minutes



## INTERMODAL FACILITIES

**UP INTERMODAL, JOLIET**  
24 miles / 40 minutes

**CN INTERMODAL, HARVEY**  
11 miles / 17 minutes

**UP INTERMODAL, DOLTON**  
16 miles / 24 minutes

**NS INTERMODAL, CALUMET**  
22 miles / 26 minutes

**BNSF INTERMODAL, HODGKINS**  
25 miles / 28 minutes

**CSX INTERMODAL, BEDFORD PARK**  
24 miles / 35 minutes

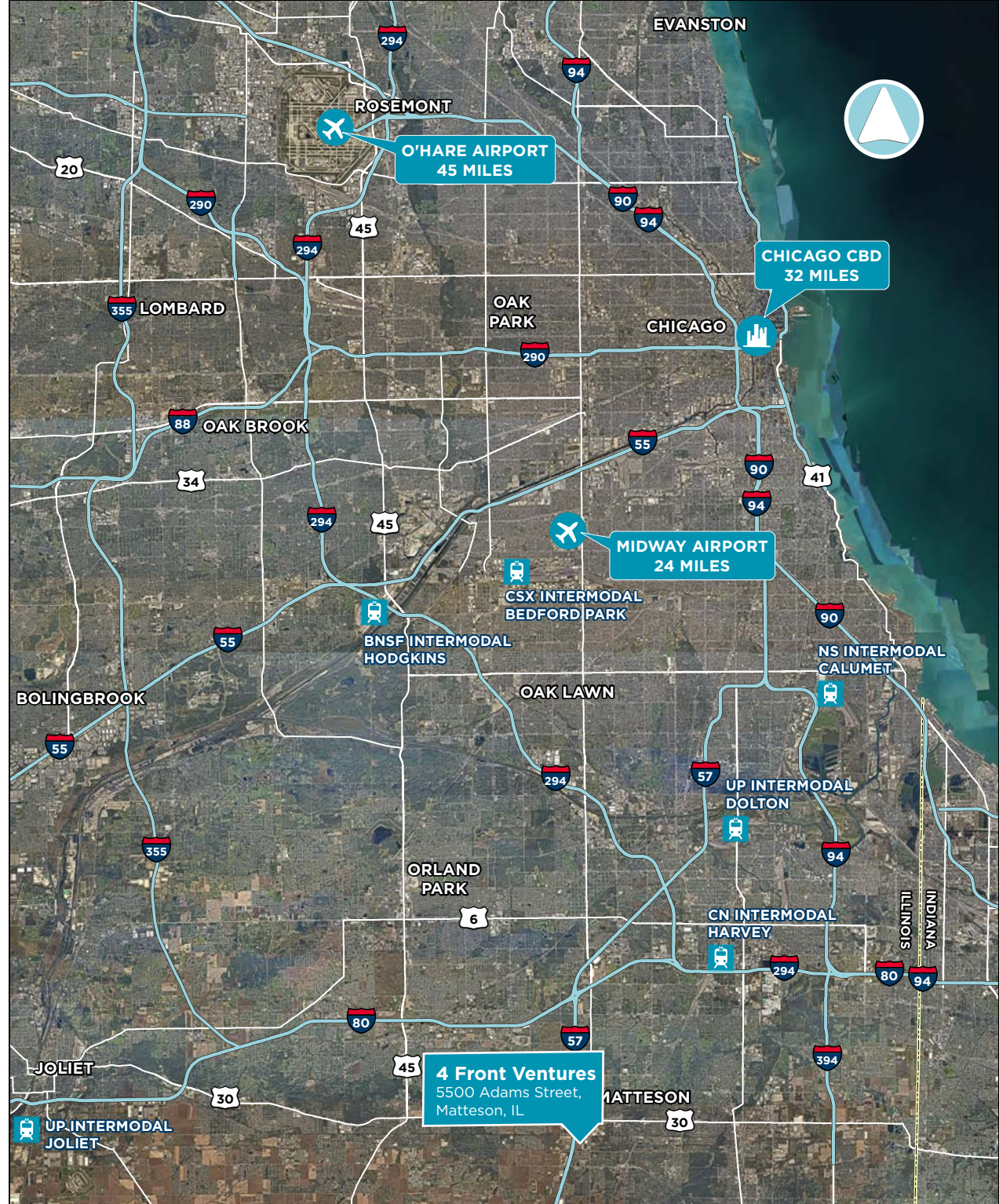



**Matt Saddler**  
Director  
+1 312 470 3834  
[matt.saddler@cushwake.com](mailto:matt.saddler@cushwake.com)

**Sally Macoicz**  
Managing Director  
+1 312 470 1823  
[sally.macoicz@cushwake.com](mailto:sally.macoicz@cushwake.com)