

4475 West 700 South  
Salt Lake City, UT 84104

# PACIFIC LANDING



# FOR LEASE

\$0.65/MONTHLY NNN

## PROPERTY HIGHLIGHTS

- Available: 115,638 SF
  - Approx 1,500 SF of Office Space
  - Warehouse: 114,138
- Loading:
  - Three (3) 12'x14' Drive in Doors
  - Twenty-five (25) Dock High Doors
- Dock Equipment:
  - Four (4) Docks Equipped with Pit Levelers, Seals, Lights and Shelters
- Clear Height: 32'
- Column Spacing: 52'x56'
- Fully Climate Controlled Space with HVAC
- ESFR Fire Suppression System
- LED Motion Sensor Lighting
- Skylights throughout
- Gas Forced Heat in Warehouse
- Power: 900 Amps 480 V | 3-Phase (Tenant to verify)
- Power Drops and Warehouse Fans
- Trailer Parking Available
- Zoning: Salt Lake City Light Industrial (M-1)

# FLOOR PLAN

## LEGEND



DRIVE IN DOORS



DOCK HIGH DOORS



DOCK WITH LEVELERS

OFFICE FLOOR PLAN  
1500 SF

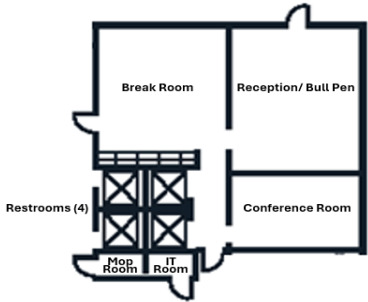



# CONTACT US

**Culum J. Mills**  
 +1 801 456 9526  
 culum.mills@jll.com

**Wick Udy +1**  
 801 456 9523  
 wick.udy@jll.com

**Rhett Rasmussen**  
 +1 385 419 3195 rhett.  
 rasmussen@jll.com

Although information has been obtained from sources deemed reliable, neither Owner nor JLL makes any guarantees, warranties or representations, express or implied, as to the completeness or accuracy as to the information contained herein. Any projections, opinions, assumptions or estimates used are for example only. There may be differences between projected and actual results, and those differences may be material. The Property may be withdrawn without notice. Neither Owner nor JLL accepts any liability for any loss or damage suffered by any party resulting from reliance on this information. If the recipient of this information has signed a confidentiality agreement regarding this matter, this information is subject to the terms of that agreement. ©2025 Jones Lang LaSalle IP, Inc. All rights reserved.

