



# Rialto Commerce Center

305 S. Cedar Avenue, Rialto, CA



**198,334 sq ft**  
available space



**36 feet**  
clear height



**Class A**  
Warehouse Facility



**Secured Private**  
Yard



# Rialto Commerce Center

Property features and offered space



**±198,334 SF**  
Available space



**±3,476 SF**  
Office space



**36 feet**  
Clear height



**ESFR**  
Sprinkler System



**26 (9' x 10')**  
Dock High Doors: 10 w/  
35,000 lbs Pit Levelers



**2 (12' x 14')**  
Ground Level Doors



**Spec LED**  
Warehouse Lighting



**141**  
Car parking spaces



**39**  
Trailer Parking Stalls

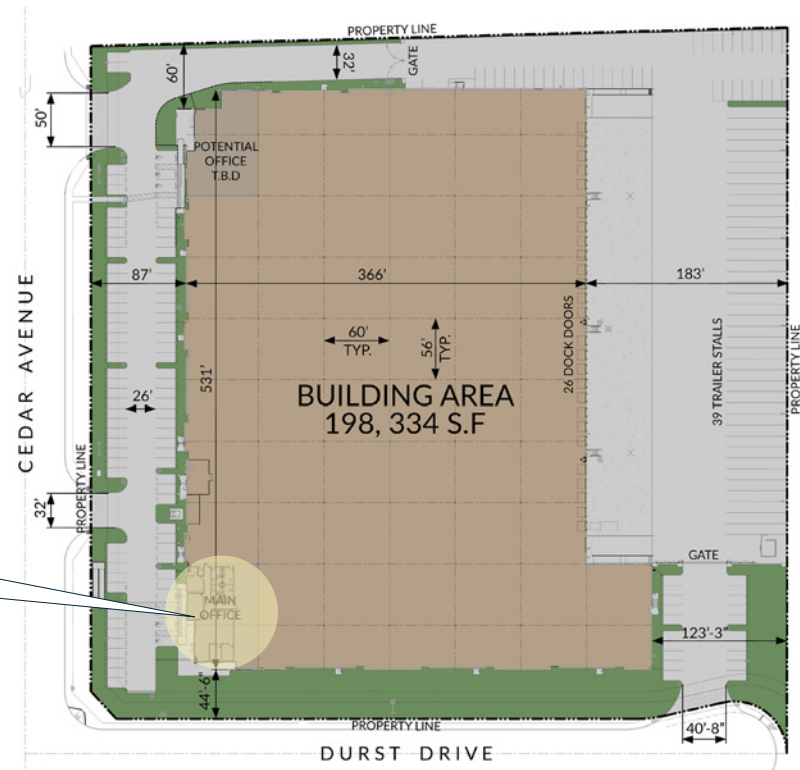



## Distances



I-215 Freeway	6.6 mi
I-15 Freeway	10.2 mi
I-210 Freeway	2.9 mi
I-10 Freeway	1.8 mi



## Points of interest

BNSF Intermodal Yard	4.9 mi
UPS Hub	14.6 mi
FedEx Hub	5.6 mi
Ontario International Airport	13.4 mi

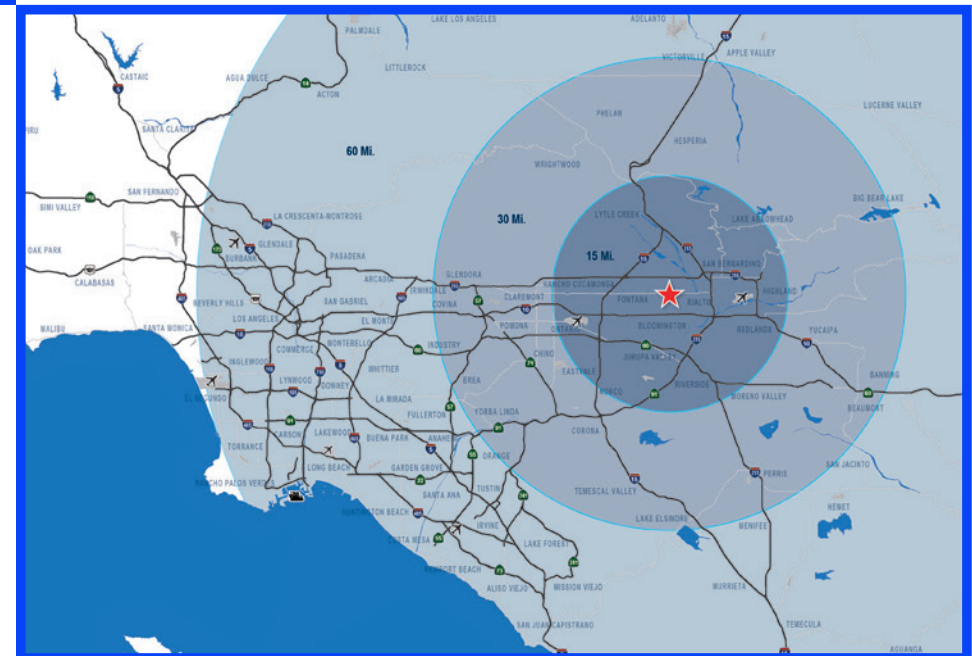



# Photos





## Warehouse Photos





# Office Photos



# Proven track record

of Marq Logistics



Marq Logistics is a global leader in the development and operation of modern logistics facilities and manages a portfolio of approximately 2,000 properties totaling more than 645 million square feet. With a mission to deliver institutional-quality logistics facilities and a consistent, best-in-class experience to customers around the world, Marq's highly specialized and dedicated team provides a powerful combination of global scale with local expertise.

Learn more about Marq at [www.marqlogistics.com](http://www.marqlogistics.com), and view our current properties at [www.glp.com](http://www.glp.com).

## Juan Gutierrez, SIOR

Executive Vice President, Partner

(909) 545-8008

[jgutierrez@voitco.com](mailto:jgutierrez@voitco.com)

## Sean Sullivan, SIOR

Senior Vice President, Partner

(909) 545-8004

[ssullivan@voitco.com](mailto:ssullivan@voitco.com)

## Nicholas Chang, SIOR

Senior Vice President

(909) 418-2014

[nicholas.chang@cbre.com](mailto:nicholas.chang@cbre.com)

## Richard Lee, SIOR

Senior Vice President

(909) 418-2010

[richard.leeg@cbre.com](mailto:richard.leeg@cbre.com)

**Voit**  
REAL ESTATE SERVICES

**CBRE**