

# INVOICE

**FROM:**

Marc Roth Appraisals  
 Marc Roth Appraisals  
 6879 Oveja Ave  
 El Paso, TX 79912-2309

Telephone Number: (915) 240-6580 Fax Number:

**TO:**

Fernando Valenzuela

E-Mail: fernandotherealtor93@gmail.com

Telephone Number: 915-493-9793 Fax Number:  
 Alternate Number:

**INVOICE NUMBER**

00942

**DATES**

Invoice Date: 05/20/2026

Due Date: Upon Reciept

**REFERENCE**

Internal Order #:

Lender Case #:

Client File #:

FHA/VA Case #:

Main File # on form: 00942

Other File # on form:

Federal Tax ID:

Employer ID:

**DESCRIPTION**

**Lender:** Client: Fernando Valenzuela  
**Purchaser/Borrower:** N/A  
**Property Address:** 7595 Alameda Ave  
**City:** El Paso  
**County:** El Paso **State:** TX **Zip:** 79915  
**Legal Description:** 27 YSLETA TR 3-B-3 (0.382 AC)

**FEES**

**AMOUNT**

Size Calculation	150.00
------------------	--------

Thank you for your business. **SUBTOTAL** 150.00

**PAYMENTS**

**AMOUNT**

Check #:	Date:	Description:
Check #:	Date:	Description:
Check #:	Date:	Description:

SUBTOTAL

**TOTAL DUE** \$ 150.00

# MEASUREMENT OF REAL PROPERTY

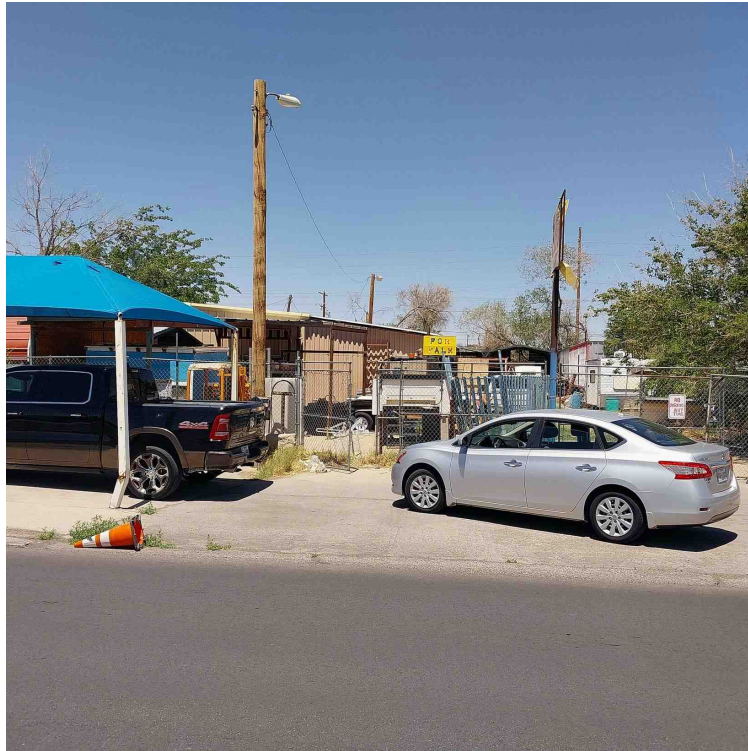

## LOCATED AT

7595 Alameda Ave  
El Paso, TX 79915  
27 YSLETA TR 3-B-3 (0.382 AC)

## FOR

Fernando Valenzuela  
CURRENT OWNER - MARTINEZ DELIA N (LE) & ALFREDO A

## AS OF

05/18/2026

## BY

Marc Roth Appraisals  
6879 Oveja Ave  
El Paso, TX  
79912

915-240-6580

Marc Roth Appraisals  
6879 Oveja Ave  
El Paso, TX  
79912  
915-240-6580

05/20/2026

Fernando Valenzuela

Re: Property: 7595 Alameda Ave  
El Paso, TX 79915  
Borrower: N/A  
File No.: 00941

In accordance with your request, I have measured the above referenced property. The results of that assignment are attached.

The Appraiser has measured the improvements as accurately as possible, but a survey is recommended for exact determination.

The Appraiser is not involved with the project, and is only assisting in rendering an approximate estimate of the square footage of the property for possible future marketing purposes. My findings and conclusions are attached.

It has been a pleasure to assist you. Please do not hesitate to contact me if I can be of additional service to you.

Sincerely,



Marc P Roth

## Building Sketch

Borrower	N/A				
Property Address	7595 Alameda Ave				
City	El Paso	County	El Paso	State	TX
Lender/Client				Zip Code	79915

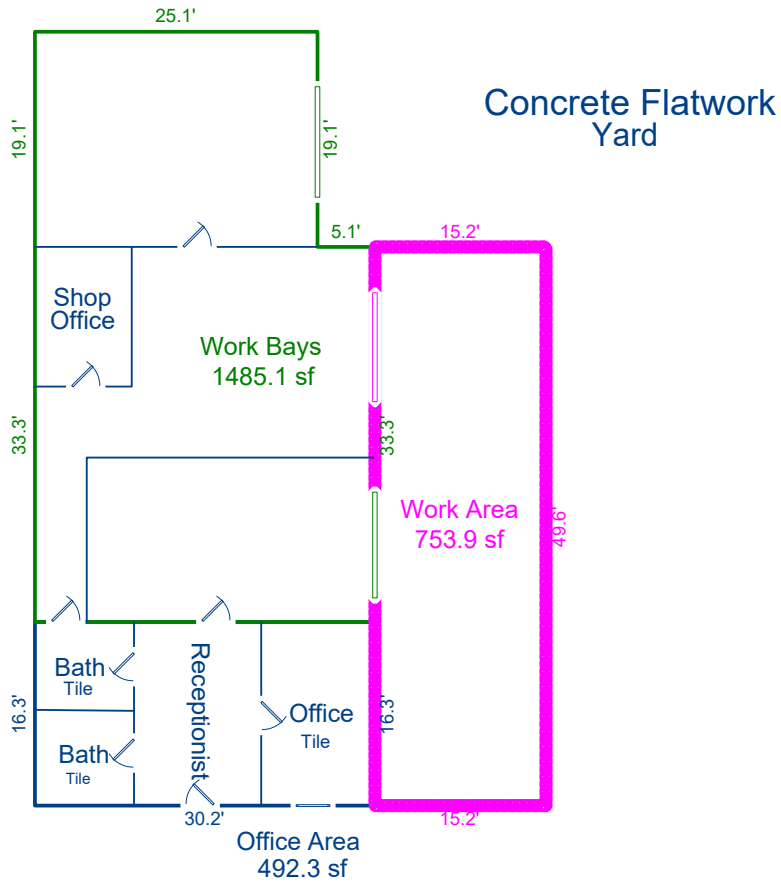
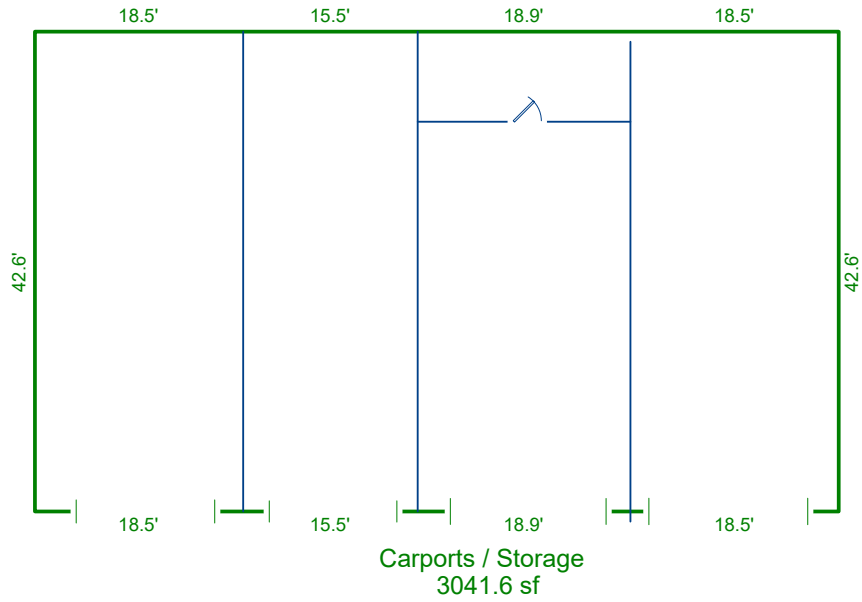

Sketch by ApexSketch

AREA CALCULATIONS SUMMARY						AREA CALCULATIONS BREAKDOWN				
Code	Description	Factor	Net Size	Perimeter	Net Totals	Name	Base x	Height x	Width =	Area
GLA1	Office Area	1.0	492.3	93.0	492.3	Office Area		30.2 x	16.3 =	492.3
GAR	Work Bays	1.0	1485.1	165.2						
	Carports / Stora	1.0	3041.6	228.0	4526.7					
P/P	Work Area	1.0	753.9	129.6	753.9					
Net LIVABLE			cnt	1 (rounded)	492	1 total items			(rounded)	492

## Location Map

Borrower	N/A						
Property Address	7595 Alameda Ave						
City	El Paso	County	El Paso	State	TX	Zip Code	79915
Lender/Client							

