



## PROPERTY FEATURES

**AVAILABLE** ±4,800 SF

**ZONING** CAML

- Common Area Maintenance Fee: \$0.08 / SF
- Fenced & Gated Multi-Tenant Industrial Park
- Professionally Managed & Maintained Business Park
- Easy Access to Parking
- Immediate Access to 91, 110 & 405 Freeways
- Recently Renovated Industrial/Flex Units
- 3D Matterport Virtual Tour Available to View

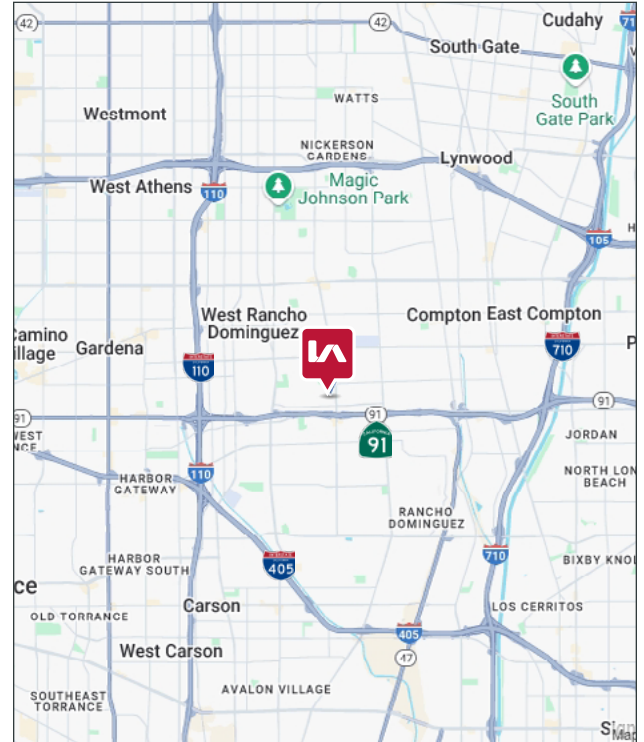

LOCAL EXPERTISE. INTERNATIONAL REACH. WORLD CLASS.

### Max P. Eddy

Associate | Cal DRE# 02163858

P: +1(562) 354-2538

E: meddy@leelalb.com

### Brandon Carrillo

Principal | Cal DRE# 01745362

P: +1(562) 354-2510

E: bcarrillo@leelalb.com

### Garrett Massaro, SIOR

Principal | Cal DRE# 01771471

P: +1(562) 354-2516

E: gmassaro@leelalb.com

Copyright © Lee & Associates. All rights reserved. No part of this work may be reproduced or distributed without written permission of the copyright owner. The information contained in this report was gathered by Lee & Associates from sources believed to be reliable. Lee & Associates, however, makes no representation concerning the accuracy or completeness of such information and expressly disclaims any responsibility for any inaccuracy contained herein.

## AVAILABLE SUITES

UNIT	SQ FT	RATE	DESCRIPTION	3D TOUR
17101 - 1B	±4,800 SF	\$1.00/SF Gross (\$4,800.00 / Month)	Available Now. 11' x 12' GL Door. 15' Clear Height. Reception, Private Office, Large Warehouse Area.	<b>VIRTUAL TOUR</b>

Pricing Note: Teaser Rate for Deals Signed Before December 1, 2026

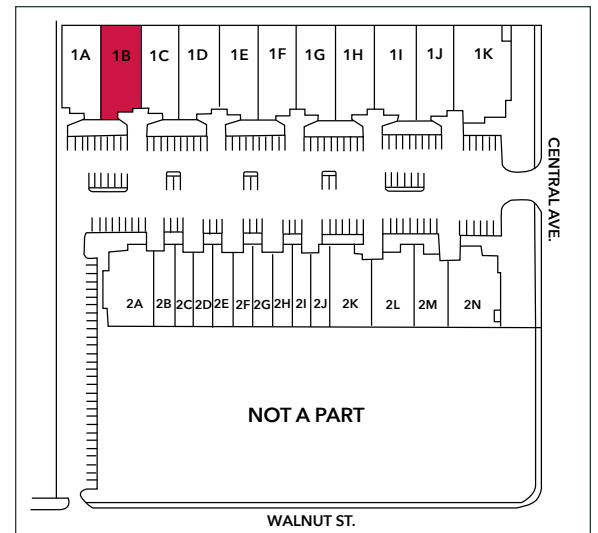

LOCAL EXPERTISE. INTERNATIONAL REACH. WORLD CLASS.

### Max P. Eddy

Associate | Cal DRE# 02163858

P: +1(562) 354-2538

E: meddy@leelalb.com

### Brandon Carrillo

Principal | Cal DRE# 01745362

P: +1(562) 354-2510

E: bcarrillo@leelalb.com

### Garrett Massaro, SIOR

Principal | Cal DRE# 01771471

P: +1(562) 354-2516

E: gmassaro@leelalb.com

Copyright © Lee & Associates. All rights reserved. No part of this work may be reproduced or distributed without written permission of the copyright owner. The information contained in this report was gathered by Lee & Associates from sources believed to be reliable. Lee & Associates, however, makes no representation concerning the accuracy or completeness of such information and expressly disclaims any responsibility for any inaccuracy contained herein.

17101 CENTRAL AVE - UNIT 1B- FLOOR PLAN  
(NOT DRAWN TO SCALE)

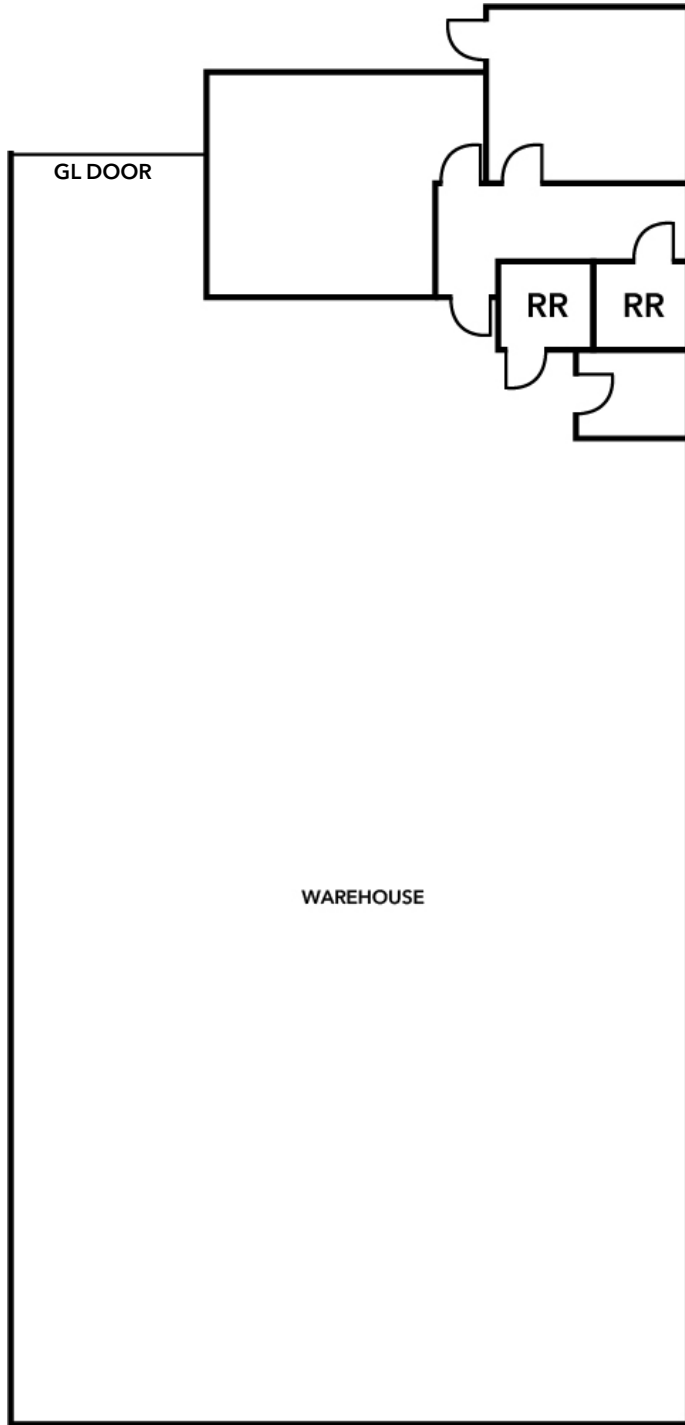

LOCAL EXPERTISE. INTERNATIONAL REACH. WORLD CLASS.

### Max P. Eddy

Associate | Cal DRE# 02163858

P: +1(562) 354-2538

E: meddy@leelalb.com

### Brandon Carrillo

Principal | Cal DRE# 01745362

P: +1(562) 354-2510

E: bcarrillo@leelalb.com

### Garrett Massaro, SIOR

Principal | Cal DRE# 01771471

P: +1(562) 354-2516

E: gmassaro@leelalb.com

Copyright © Lee & Associates. All rights reserved. No part of this work may be reproduced or distributed without written permission of the copyright owner. The information contained in this report was gathered by Lee & Associates from sources believed to be reliable. Lee & Associates, however, makes no representation concerning the accuracy or completeness of such information and expressly disclaims any responsibility for any inaccuracy contained herein.