

# BINGHAM INDUSTRIAL

SUITE A 2025 BINGHAM DR | NAMPA, ID 83651



## PROPERTY SUMMARY

<b>Submarket:</b>	Nampa
<b>Bldg Type:</b>	Industrial Office/Warehouse
<b>Bldg Size:</b>	5,800 SF
<b>Lot Size:</b>	0.68 Acres
<b>Clear Height:</b>	14'
<b>Grade Level:</b>	1 - 10' x 12'
<b>Power:</b>	125 Amp 240 Volt Single-Phase
<b>Listing Type:</b>	Lease
<b>Available:</b>	7/1/2026
<b>Zoning:</b>	BC - Community Business

## PROPERTY HIGHLIGHTS

- Rare flex-industrial opportunity located in Nampa, near 3 major thoroughfares and I-84.
- Secured and powered storage units available to tenants.
- Paved and secured yard available to tenants.
- Tenant improvement allowance will be considered.
- Location anchored by Lowes, Karcher Mall and Home Depot.
- Ideal layout; 900sf office and 2000sf warehouse.

## AVAILABLE SPACE

SPACE	RSF	RATE
Suite A	2,900 SF	\$1.35/SF, NNN
	<b>EST. NNN'S</b>	<b>\$0.22/SF</b>



**Mike Arnold** | 208.957.5609 | mike@tokcommercial.com

UPDATED: 3.27.2026

THIS PROPERTY IS EXCLUSIVELY MARKETED BY TOK BOISE LLC DBA TOK COMMERCIAL. This information was obtained from sources believed reliable but cannot be guaranteed. Any opinions or estimates are used for example only.

**GRADE-LEVEL DOOR**



**2,000 SF WAREHOUSE**

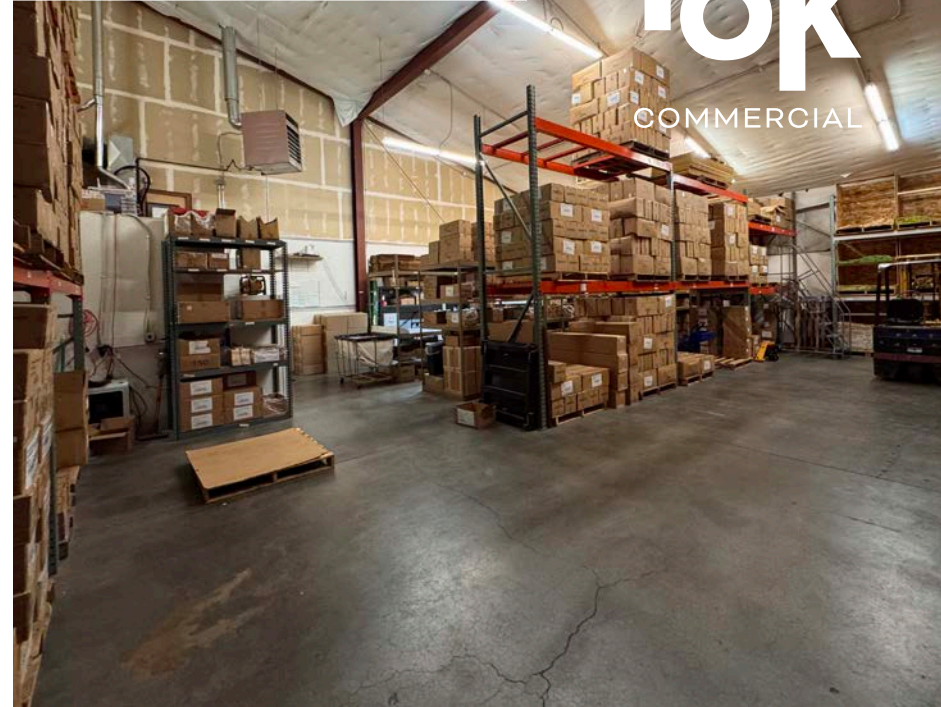

**TOK**  
COMMERCIAL

**900 SF OFFICE**



**PHOTOS**

UPDATED: 3.27.2026  
THIS PROPERTY IS EXCLUSIVELY MARKETED BY TOK BOISE LLC DBA TOK COMMERCIAL.  
This information was obtained from sources believed reliable but cannot be guaranteed. Any opinions or estimates are used for example only.

# FLOOR PLAN

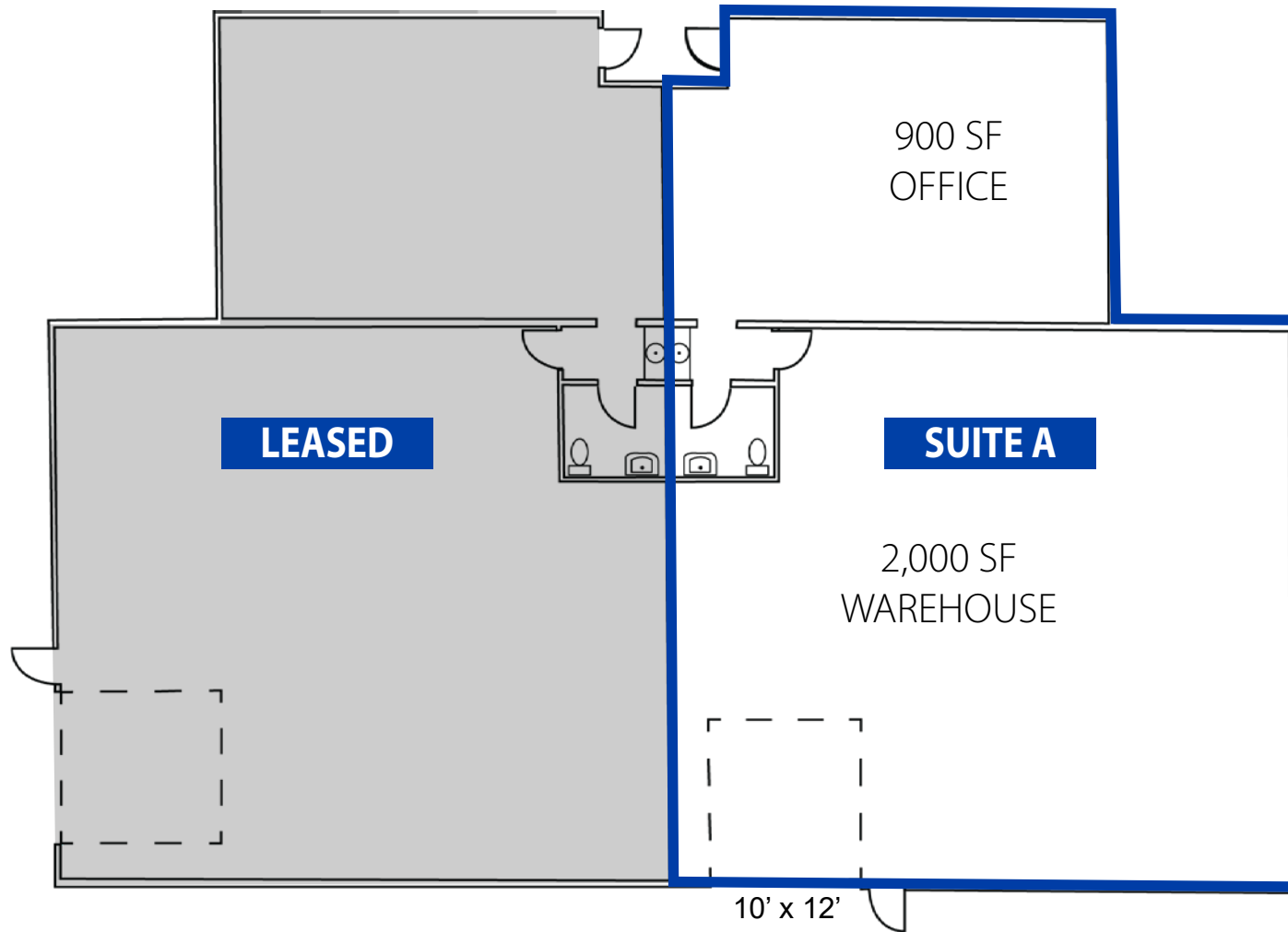

UPDATED: 3.27.2026

THIS PROPERTY IS EXCLUSIVELY MARKETED BY TOK BOISE LLC DBA TOK COMMERCIAL.  
This information was obtained from sources believed reliable but cannot be guaranteed. Any opinions or estimates are used for example only.

KARCHER RD



1,224 SF  
FENCED YARD

16 SECURED STORAGE  
UNITS

SUITE A

FINCH DR

HEMINGWAY BLVD

## FLEX-INDUSTRIAL LAYOUT

UPDATED: 3.27.2026

THIS PROPERTY IS EXCLUSIVELY MARKETING BY TOK BOISE LLC DBA TOK COMMERCIAL  
This information was obtained from sources believed reliable but cannot be guaranteed. Any opinions or estimates are used for example only.



1 MILE RADIUS



POPULATION  
**8,206**  
1 MI. RADIUS



HISTORIC ANN. GROWTH  
**1.6%**  
1 MI. RADIUS



AVG. HOUSEHOLD INC.  
**\$73,843**  
1 MI. RADIUS

3 MILE RADIUS



POPULATION  
**71,518**  
3 MI. RADIUS



HISTORIC ANN. GROWTH  
**3.7%**  
3 MI. RADIUS



AVG. HOUSEHOLD INC.  
**\$85,345**  
3 MI. RADIUS

5 MILE RADIUS



POPULATION  
**157,866**  
5 MI. RADIUS



HISTORIC ANN. GROWTH  
**3.7%**  
5 MI. RADIUS



AVG. HOUSEHOLD INC.  
**\$91,519**  
5 MI. RADIUS

UPDATED: 3.27.2026

THIS PROPERTY IS EXCLUSIVELY MARKETING BY TOK BOISE LLC DBA TOK COMMERCIAL  
THIS INFORMATION WAS OBTAINED FROM SOURCES BELIEVED RELIABLE BUT CANNOT BE GUARANTEED. ANY OPINIONS OR ESTIMATES ARE USED FOR EXAMPLE ONLY.