



HARD CORNER BUILDING FOR LEASE

NWC

**ALMA SCHOOL RD
& BASELINE RD**

MESA, AZ

PCA
PHOENIX COMMERCIAL ADVISORS

property highlights

AVAILABLE	±2,208 SF
PARCEL SIZE	±21,693 SF
PRICING	Call for Pricing
ZONING	PAD

LOCATION HIGHLIGHTS

- » Located in Mesa, AZ half a mile south of U.S. 60.
- » Fully improved parcel.
- » The surrounding area has a population of over 422,876 within a 5-mile radius, with average household incomes exceeding \$102,995.

TRAFFIC COUNTS

Alma School Rd

N ±41,803 VPD (NB & SB)
S ±35,491 VPD (NB & SB)

Baseline Rd

E ±26,562 VPD (EB & WB)
W ±25,352 VPD (EB & WB)

ADOT 2025

NEARBY TENANTS

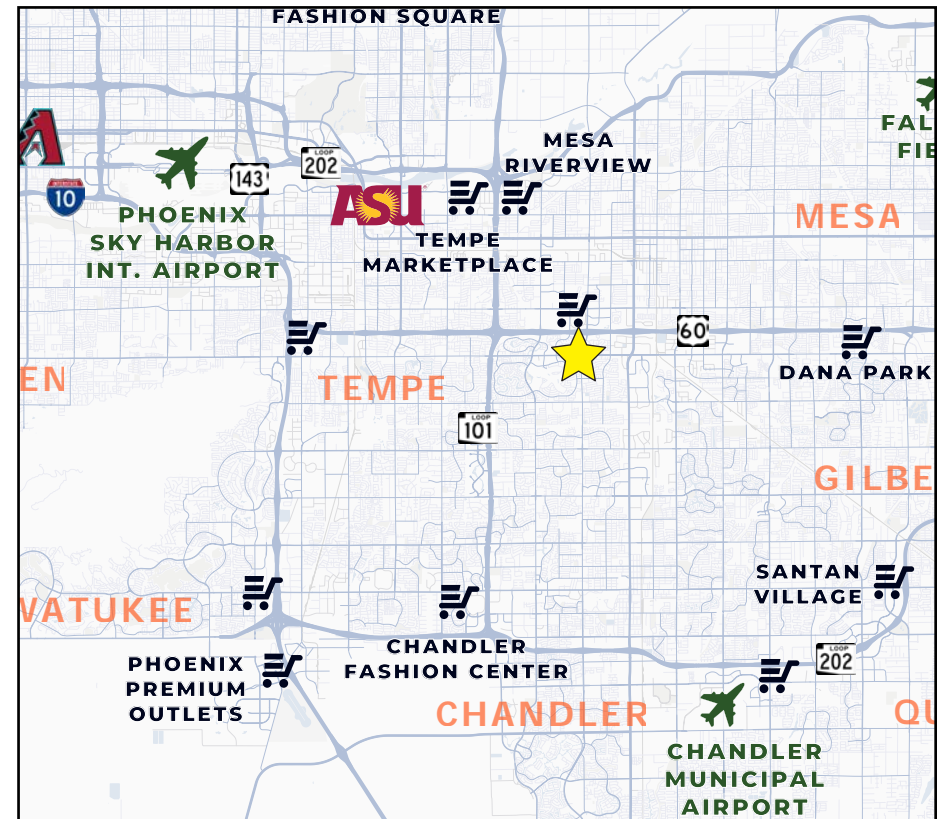

HARD CORNER BUILDING FOR LEASE

ALMA SCHOOL RD & BASELINE RD | MESA, AZ



oblique aerial



oblique aerial



zoom aerial

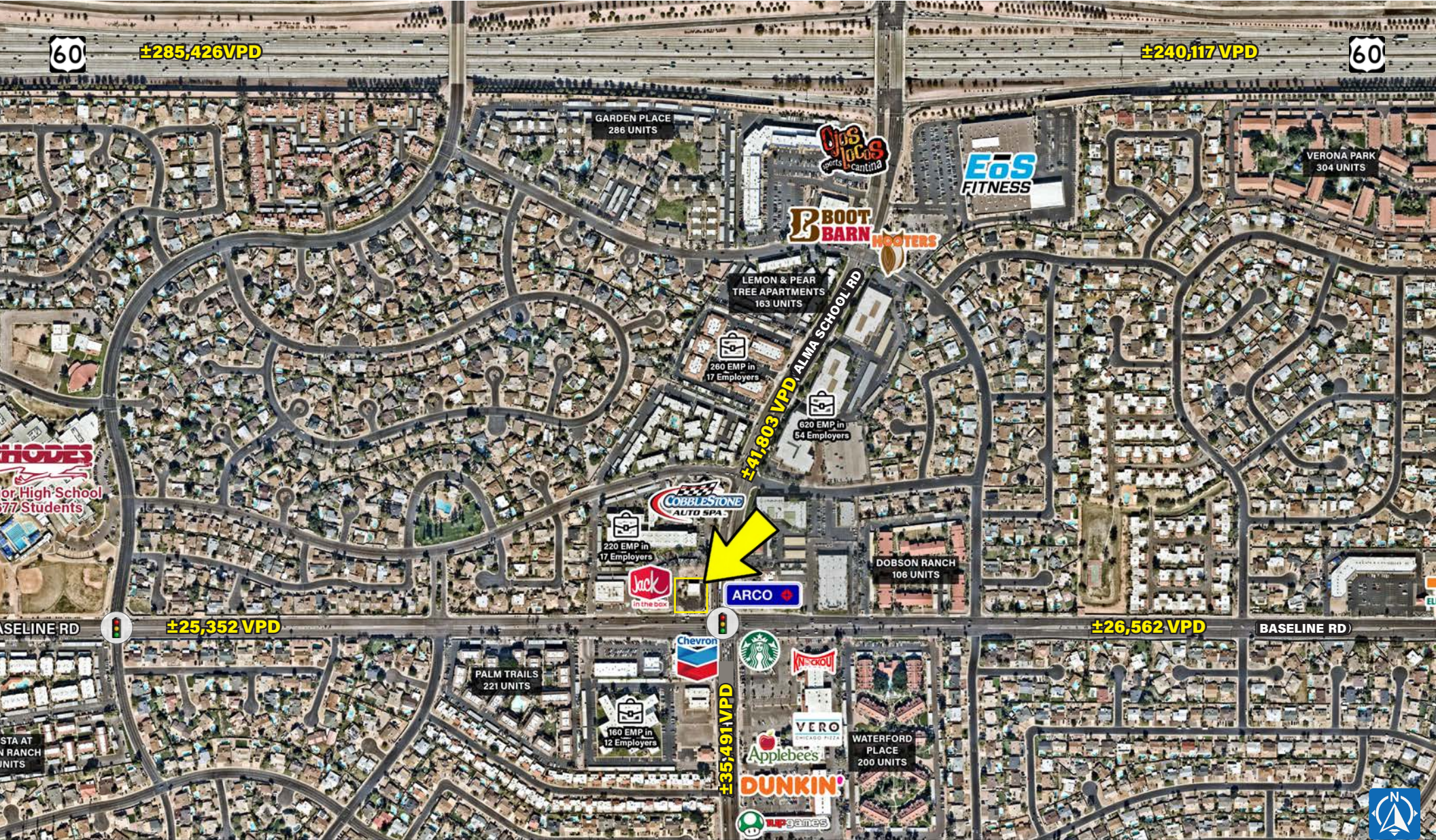

wide aerial

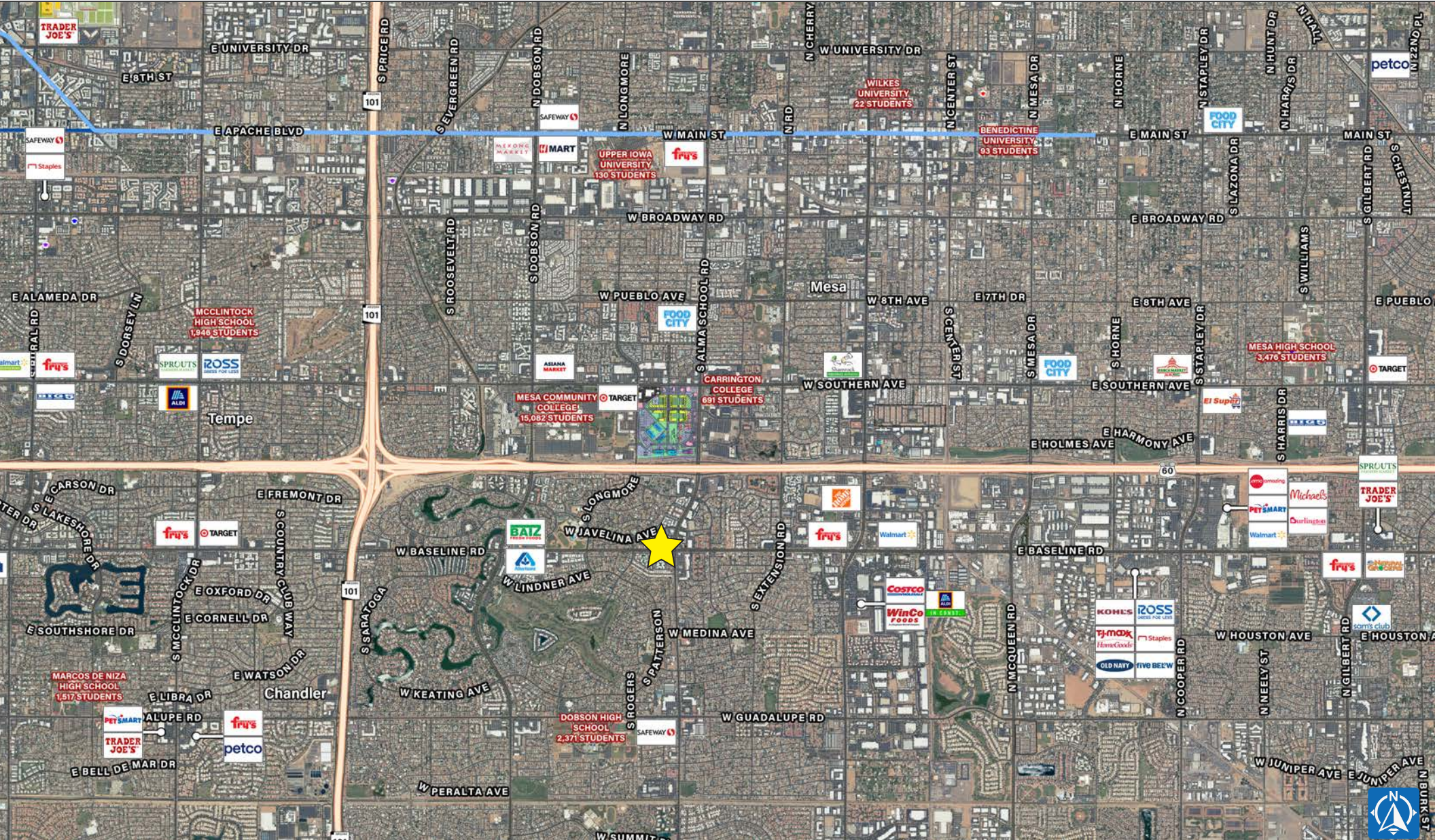

demographics

2025 ESRI

2025 DAYTIME POPULATION



TOTAL

WORKERS

RESIDENTS

	TOTAL	WORKERS	RESIDENTS
1 MILE	19,073	12,655	6,418
3 MILE	167,263	102,474	64,789
5 MILE	428,038	235,574	192,464

2025 HOUSEHOLD INCOMES



MEDIAN

AVERAGE

PER CAPITA

	MEDIAN	AVERAGE	PER CAPITA
1 MILE	\$81,764	\$105,005	\$45,494
3 MILE	\$75,788	\$97,418	\$39,783
5 MILE	\$78,724	\$102,995	\$40,956

2025 HOUSING UNITS



7,208

1 MILE

63,123

3 MILE

177,962

5 MILE

OWNER OCCUPIED

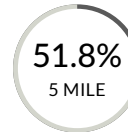
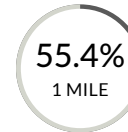

2025 BUSINESSES

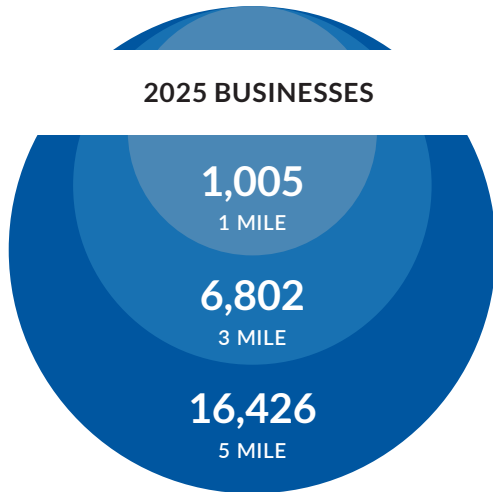

1 MILE 3 MILE 5 MILE

2025 POPULATION	16,176	147,402	422,876
2030 POPULATION	15,935	151,126	433,854



1 MILE 3 MILE 5 MILE

2025 HOUSEHOLDS	6,968	59,765	167,347
2030 HOUSEHOLDS	6,952	62,185	174,634



exclusively listed by

LANCE UMBLE

(602) 734-7206
lumble@pcaemail.com

NICK DEDONA

(602) 734-7208
ndedona@pcaemail.com



The information contained herein has been obtained from sources believed reliable. While we do not doubt its accuracy, we have not verified it and make no guarantee, warranty or representation about it. It is your responsibility to independently confirm its accuracy and completeness. Any projections, opinions, assumptions or estimates used are for example only, and do not represent the current or future performance of the property. The value of this transaction to you depends on tax and other factors which should be evaluated by your tax, financial and legal advisors. You and your advisors should conduct a careful, independent investigation of the property to determine to your satisfaction the suitability of the property for your needs. May 4, 2026 12:16 PM

3131 East Camelback Road, Suite 340 | Phoenix, Arizona 85016
P. (602) 957-9800 F. (602) 957-0889
phoenixcommercialadvisors.com