

COMMERCIAL BUILDING FOR LEASE



1704 NW 6TH ST. OKLAHOMA CITY OK 73106

Contact: Shyon Keoppel Text: 405.229.1475 Email: shyon@skventuregroup.com



FOR LEASE

1704 NW 6th St, Oklahoma City OK

PROPERTY HIGHLIGHTS:

- 5,000 SF of professionally finished Art Deco office space with reception area and parts desk
- Warehouse equipped with a 2-ton crane, ideal for fabrication, light manufacturing, or heavy equipment storage
- Grade-level access with 12' and 14' overhead doors
- Secure, fenced storage yard
- Located in an established commercial corridor with convenient access to major highways
- Turn-key condition — pride of ownership shines throughout
- Perfect for an owner-user or specialized industrial operation seeking a rare combination of character, utility, and secure storage.

**Reach out to schedule a tour and see first hand
how this space can transform your business.**

Text: Shyon Keoppel @ 405-229-1475

Email: shyon@skventuregroup.com

10,000 SF MOL Art Deco Office/Warehouse.





FOR LEASE

1704 NW 6th St, Oklahoma City OK

Discover a unique 10,000 SF Art Deco–inspired office situated on an estimated 15,775 square foot lot. This meticulously maintained property has remained under original ownership and shows exceptionally well, blending historic character with functional, modern industrial space.

OFFERING SUMMARY SUITE 100

BUILDING SIZE	10,098 SF MOL
LAND SIZE	15,775 SF MOL
LEASE TYPE	NNN
BASE RENT	\$5.50/SF - \$4,628.25/MONTH
NNN	\$.88/SF - \$740.52/MONTH
TOTAL RENT	\$6.38/SF - \$5,368.77/MONTH
TERM	3 YEARS / 36 MONTHS





FOR LEASE

1704 NW 6th St, Oklahoma City OK

3,500 warehouse space situated on an estimated 15,775 square foot lot. Position your business in the heart of Oklahoma City with this versatile warehouse opportunity just minutes from downtown. Located in a rapidly developing commercial corridor

OFFERING SUMMARY

SUITE 101

BUILDING SIZE	3,500 SF MOL
LAND SIZE	15,775 SF MOL
LEASE TYPE	NNN
BASE RENT	\$6.75/SF - \$1,968.75/MONTH
NNN	\$.88/SF - \$256.67/MONTH
TOTAL RENT	\$7.63/SF - \$2,225.42/MONTH
TERM	3 YEARS / 36 MONTHS

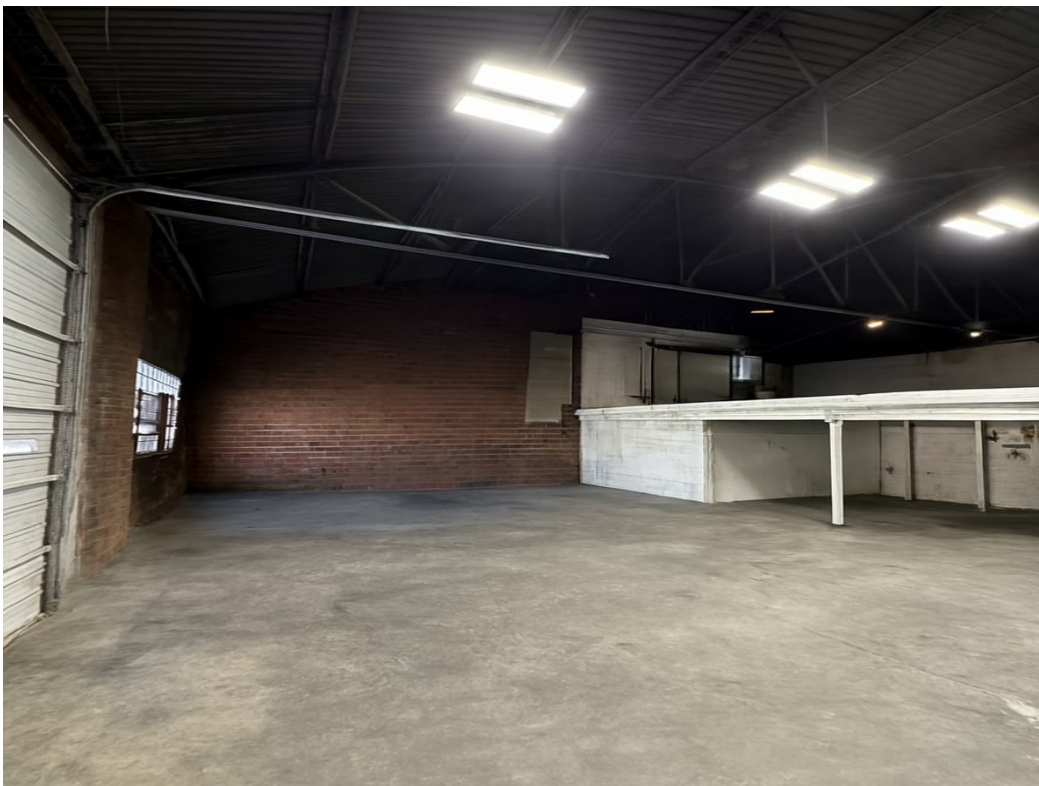

LOCATION HIGHLIGHTS

- Zoned I-2
- Near Downtown OKC
- Close to I-44 & I-35
- Easy Access to I-40

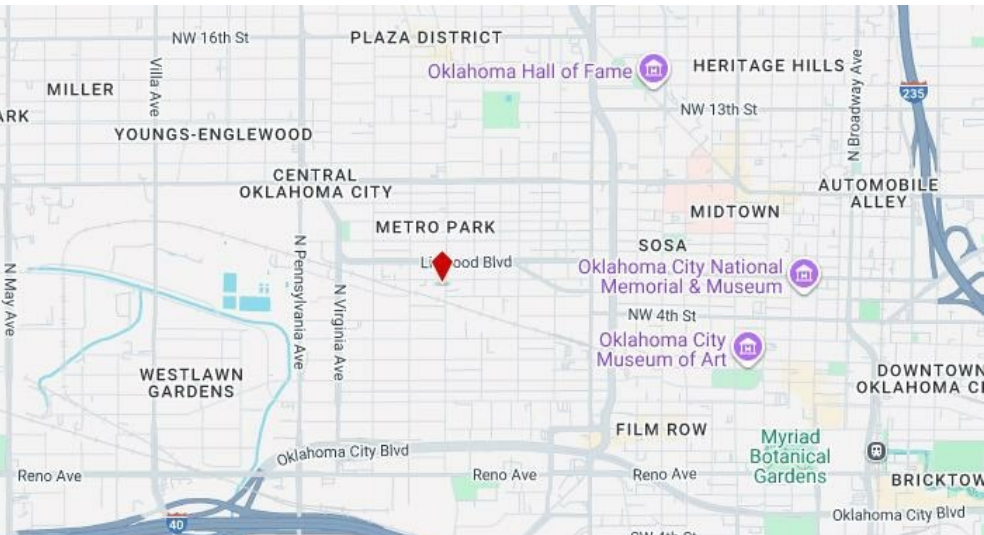

Presented By:

Shyon Keoppel

Sales Associate

Text: 405.229.1475

Email: shyon@skventuregroup.com



OTHER PROPERTIES AVAILABLE

FOR LEASE

2010-2021 Exchange Ave, Oklahoma City, OK
-2,929 - 8,406 SF @ \$4.75-\$7.00/SF plus NNN
3841 NW 10th, Oklahoma City, OK
-1,875 – 2,035 SF @ \$5.00-\$7.00/SF plus NNN
1704 NW 6th, Oklahoma City, OK
-3,500 – 13,598 SF @ \$5.50-\$6.75 /SF plus NNN
2412 SW 14th, Oklahoma City, OK
-5,083 – 7,140 SF @ \$6/SF plus NNN
8301 N Glade Ave. Oklahoma City, OK
-4,631 SF @ \$12/SF plus NNN
1236 NW 4th Oklahoma City OK
-28,700 SF @ \$3.95/SF plus NNN
1139 NW 4th St, Oklahoma City OK
-Land/Yard for Lease \$1,200/month, plus NNN

FOR SALE

3841-3845 NW 10th, Oklahoma City, OK
\$540,000
8301 Glade Ave, Oklahoma City, OK
\$622,703
508 NW 8th Oklahoma City, OK
Lot For Sale in Midtown
\$348,000
502 NW 8th Oklahoma City, OK
Lot For Sale in Midtown
\$348,000

Contact: Shyon Keoppel
405-229-1475
shyon@coastmanagementcre.com
Please text for best response!

