

**NOW  
LEASING**

# RETAIL/RESTAURANT 2900 N MESA

MINER VILLAGE SHOPPING CENTER - EL PASO-WEST-UTEP AREA

**LOCATION:**

**AMENITIES:**

## APPROX. 8,020 RSF

DEMISABLE

**SUITE D  
FULLY EQUIPPED RESTAURANT SPACE**

- State-of-the-Art Kitchen, Less Than Five Years Old
- Fully Furnished, Built-in Sound System, and Indoor Water Feature
- Large Bar Area, Private Dining Rooms, Indoor/Outdoor Balcony Seating Area
- Thirty Foot Temperature & Humidity Controlled Wine Wall
- Building and Pylon Signage Available
- Individual HVAC and Heating Systems
- Ample Free Parking with Optional Valet Parking Potential

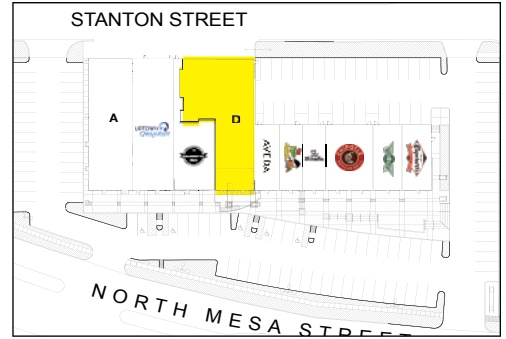
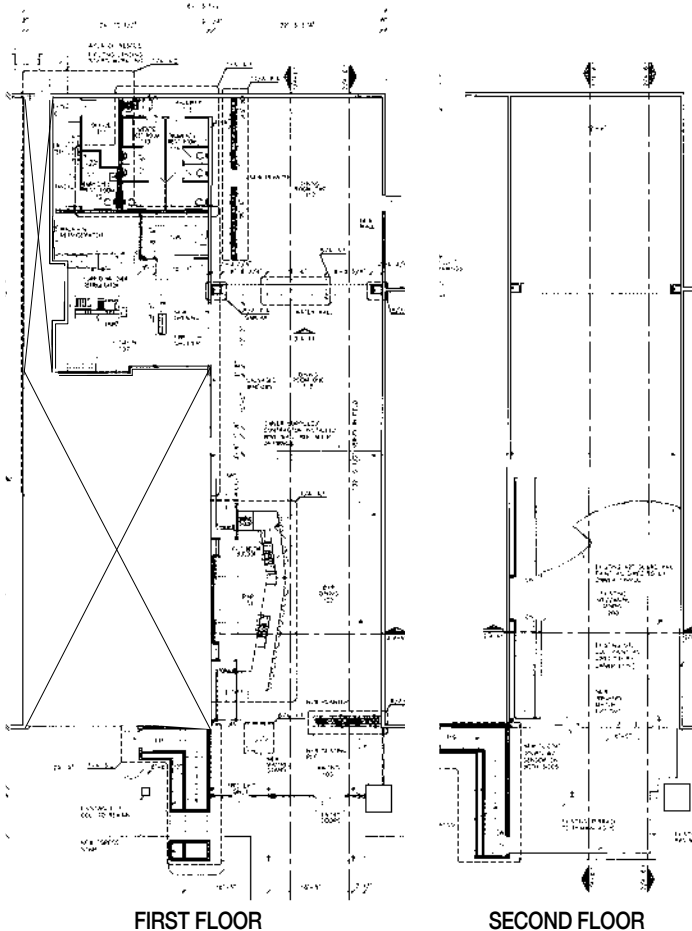

Commercial Setting in the Heart of El Paso's Most Popular Entertainment Neighborhood. Directly Across from UTEP, with Exposure to over 24,000 Students Daily, Don Haskins Special Events Center (Over One Million Visitors Annually) & Sun Bowl Stadium.

### TRAFFIC COUNT

**31,864+** Through Traffic on North Mesa,  
per day North of Baltimore Dr

### KEY TENANTS

Chipotle, WingStop, Aveda, Uptown Cheapskate



[www.epleasing.com](http://www.epleasing.com) | [info@epleasing.com](mailto:info@epleasing.com)

PROFESSIONALLY MANAGED BY EP SHALOM MANAGEMENT, LLC  
444 EXECUTIVE CENTER BLVD., SUITE 120, EL PASO, TX 79902

**915-532-3456**

Notwithstanding any other information (including, without limitation, any marketing, sales, advertising, brochures, or similar information), all prices, building design, architectural renderings, plans, amenities, features and specifications or any and all improvements to any part of the property are subject to change or cancellation without notice.