



4272 South Zevex Park Lane | Murray, UT

BUILDING SIZE:	15,602 sq. ft.
OFFICE:	1,543 sq. ft.
WAREHOUSE:	14,059 sq. ft.
CLEAR HEIGHT:	24'
LOADING:	Two 12' x 14' drive in doors (Designed to add one dock high door)
DIMENSIONS:	95' deep x 170' wide
CONSTRUCTION:	Concrete tilt-up
POWER:	800 amp service
YARD:	Fenced, asphalt yard with two manual gates and 8' vinyl fencing
ZONING:	MG (Murray City)
PARKING:	33 spaces



**CENTRALLY
LOCATED IN
THE VALLEY**



**LESS THAN
5 MINUTES
TO I-15**

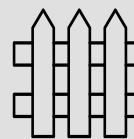

**FENCED
ASPHALT YARD**



**MANUFACTURING
GENERAL ZONING**

BUILDING FOR LEASE



FLOOR PLAN

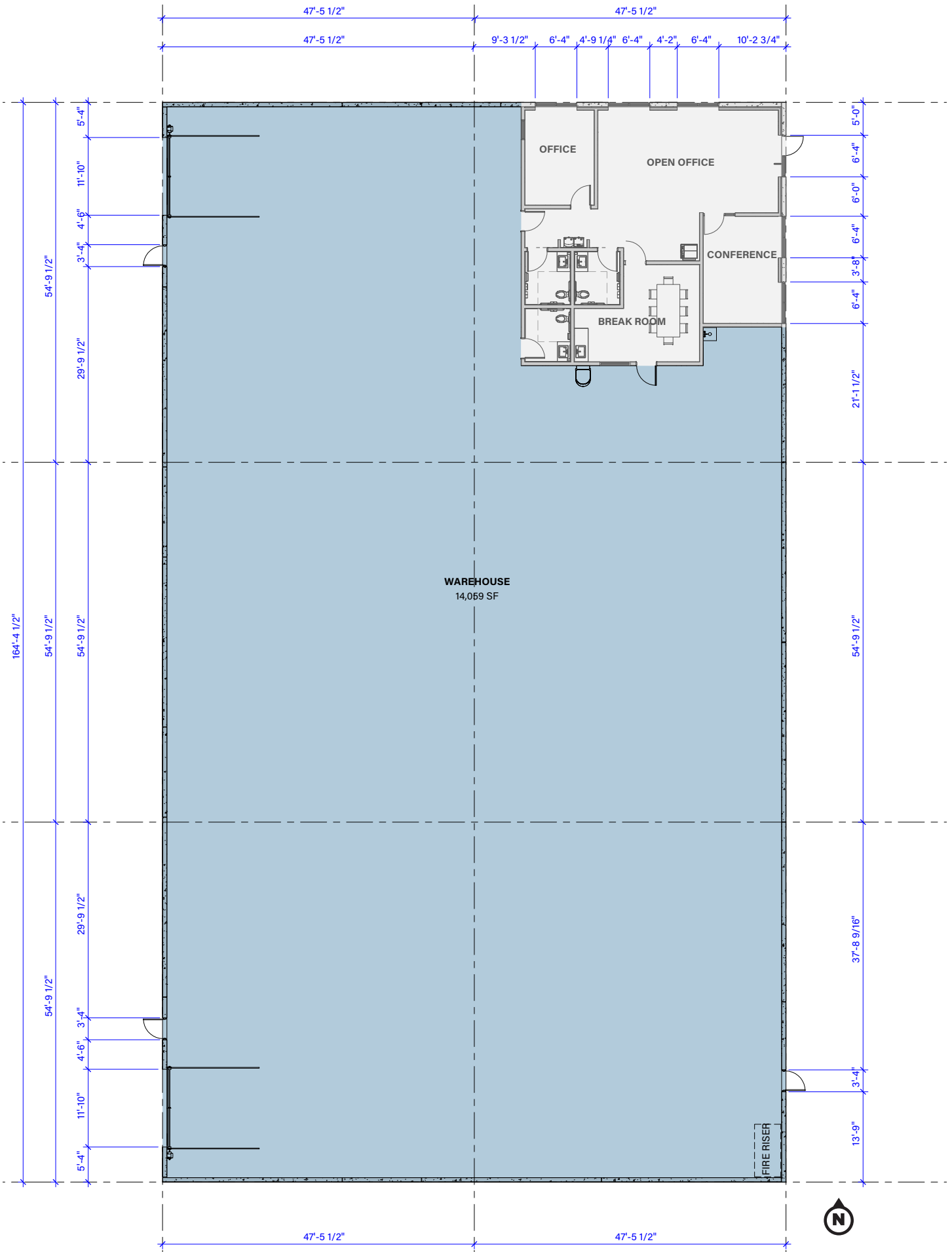

Downtown Salt Lake City



Location Details

- CENTRALLY LOCATED IN THE SALT LAKE VALLEY, OFFERING TREMENDOUS ACCESS TO ALL REGIONS OF SALT LAKE COUNTY
- LOCATED JUST WEST OF THE 4500 SOUTH EXIT OFF I-15—THE VALLEY'S MAJOR NORTH/SOUTH INTERSTATE
- SALT LAKE INTERNATIONAL AIRPORT IS A QUICK 15 MINUTE DRIVE NORTH OF THE SUBJECT PROPERTY
- THE MURRAY TRAX STATION IS LOCATED TO THE EAST, AND I-215 TO THE WEST—BOTH 8 MINUTES TO THE SUBJECT PROPERTY



CONTACT INFORMATION:

Tom Dischmann
Executive Vice President
+1 801 243 9411
tom.dischmann@cbre.com

Jeff Richards
Executive Vice President
+1 801 869 8026
jeff.richards@cbre.com

Chris Liddell
Senior Vice President
+1 801 869 8007
chris.liddell@cbre.com

Matt McAfee
Senior Vice President
+1 801 869 8023
matt.mcafee@cbre.com

OMP
CBRE

© 2026 CBRE, Inc. All rights reserved. This information has been obtained from sources believed reliable but has not been verified for accuracy or completeness. CBRE, Inc. makes no guarantee, representation or warranty and accepts no responsibility or liability as to the accuracy, completeness, or reliability of the information contained herein. You should conduct a careful, independent investigation of the property and verify all information. Any reliance on this information is solely at your own risk.