

⬡ PATIO KEYNOTES:

- 3.1 RELOCATE EQUIPMENT IN OUTSIDE SERVICE BAR
- 3.2 INSTALL EXHAUST HOOD & ANSUL SYSTEM
- 3.3 INSTALL STAINLESS STEEL WALL PANELS BEHIND EQUIPMENT

GENERAL NOTES:

- 1. PAINT THROUGHOUT
- 2. NEW FURNITURE THROUGHOUT
- 3. NEW MUSIC SYSTEM PER PLAN
- 4. NEW TV PER PLAN

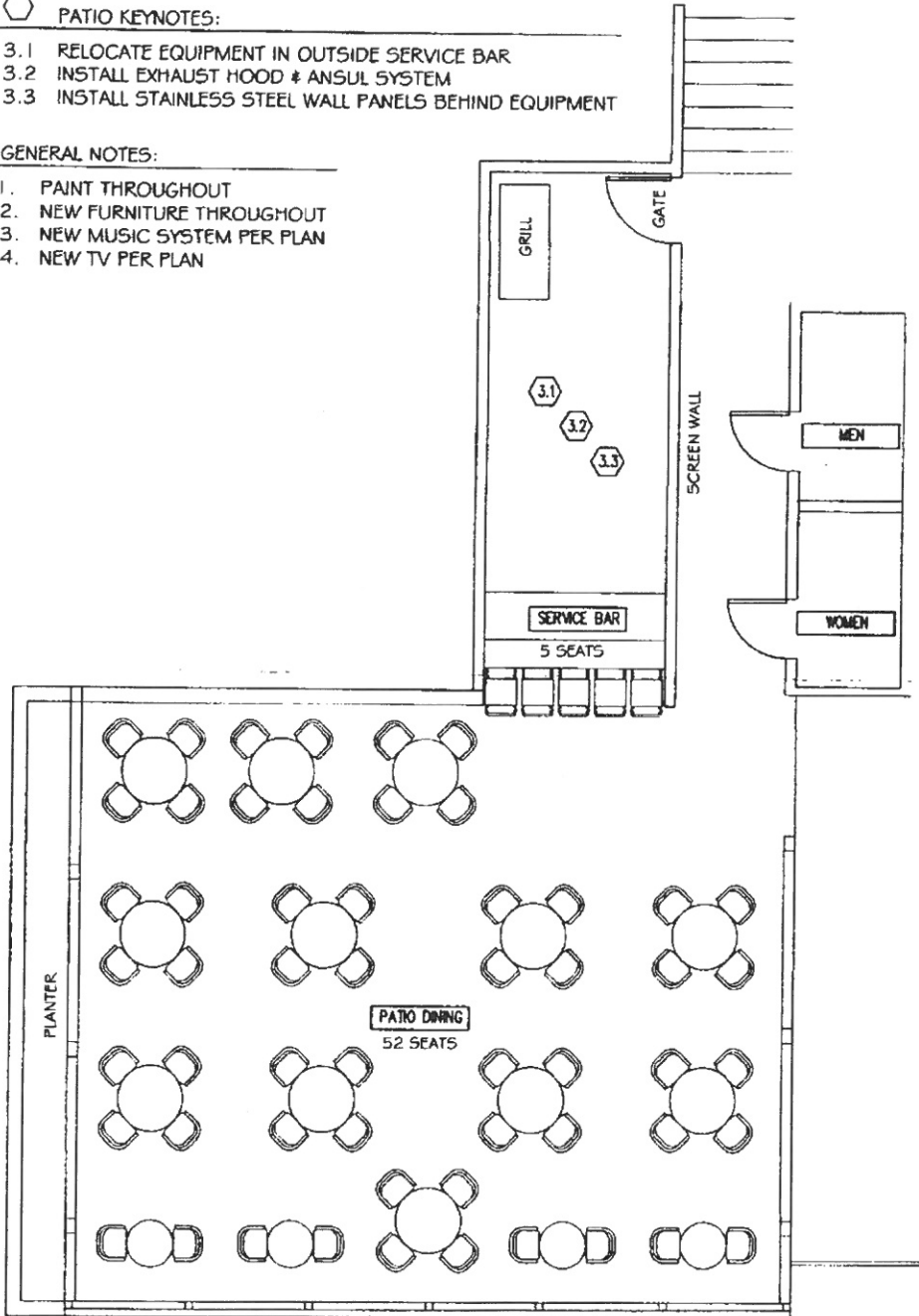

145 NANTASKET AVENUE

PATIO PLAN

JANUARY 17, 2019

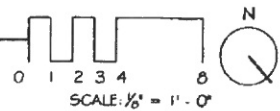

OCCUPANT LOAD CALCULATIONS				
	EXISTING		PROPOSED	
	BAR	DINING	BAR	DINING
1st FLOOR	15	75	15	63
2nd FLOOR	10	90	10	56
PATIO	5	60	5	56
TOTAL	255		205	

- FLOOR 1 KEYNOTES:**
- 1.1 EXTEND BAR PER PLAN
 - 1.2 RELOCATE BAR EQUIPMENT PER PLAN
 - 1.3 RELOCATE KITCHEN EQUIPMENT PER PLAN
 - 1.4 INSTALL REFRIGERATED WALK-IN PER PLAN
 - 1.5 INSTALL NEW FINISHES AT VESTIBULE
 - 1.6 REFINISH FLOOR

- GENERAL NOTES:**
1. PAINT THROUGHOUT
 2. NEW FURNITURE THROUGHOUT
 3. NEW MUSIC SYSTEM PER PLAN
 4. NEW TV PER PLAN

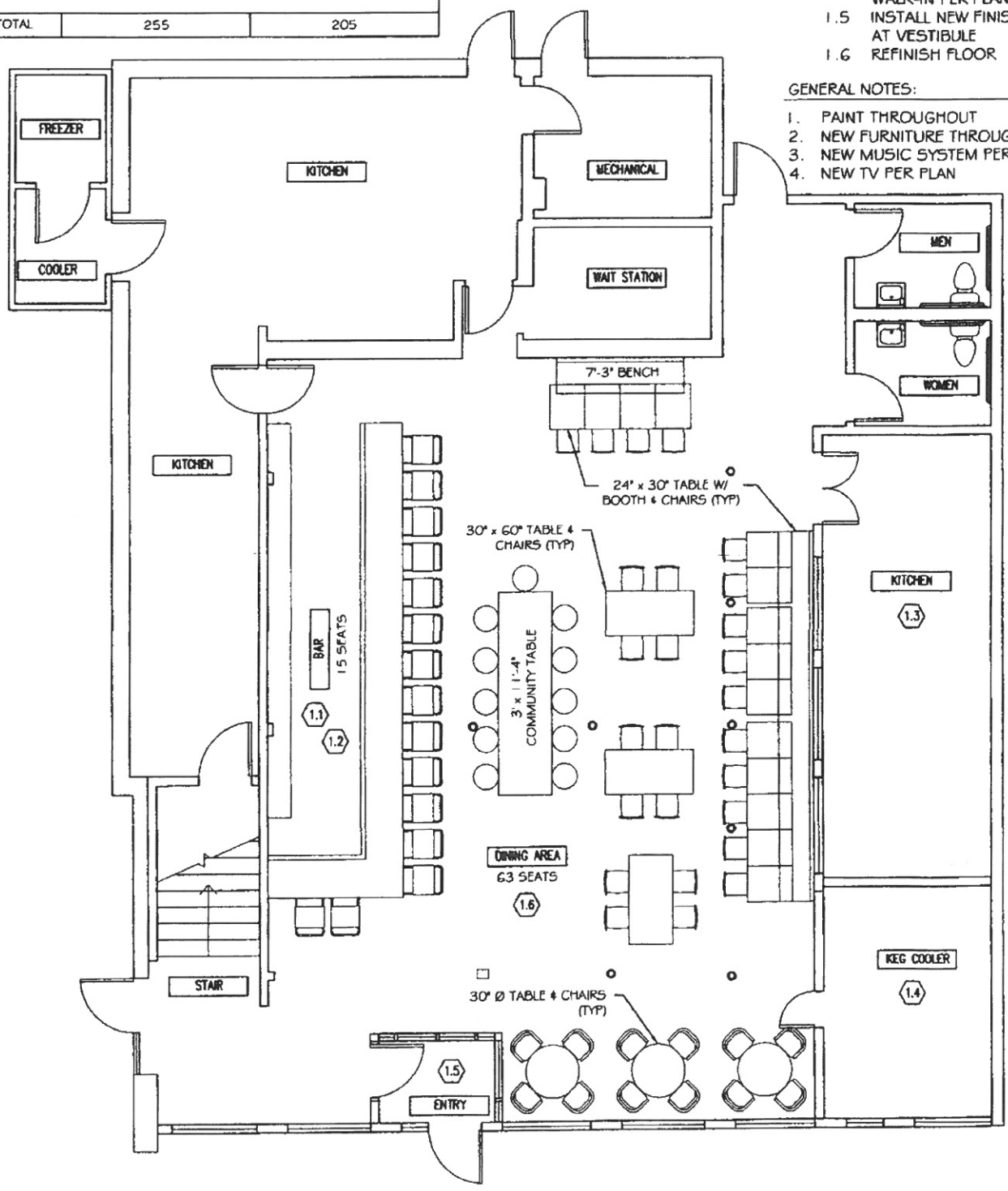

145 NANTASKET AVENUE
FIRST FLOOR PLAN

JANUARY 17, 2019

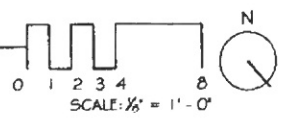

 FLOOR 2 KEYNOTES:

- 2.1 REPLACE BAR TOP
- 2.2 RELOCATE BAR EQUIPMENT PER PLAN
- 2.3 REFINISH FLOOR

GENERAL NOTES:

- 1. PAINT THROUGHOUT
- 2. NEW FURNITURE THROUGHOUT
- 3. NEW MUSIC SYSTEM PER PLAN
- 4. NEW TV PER PLAN

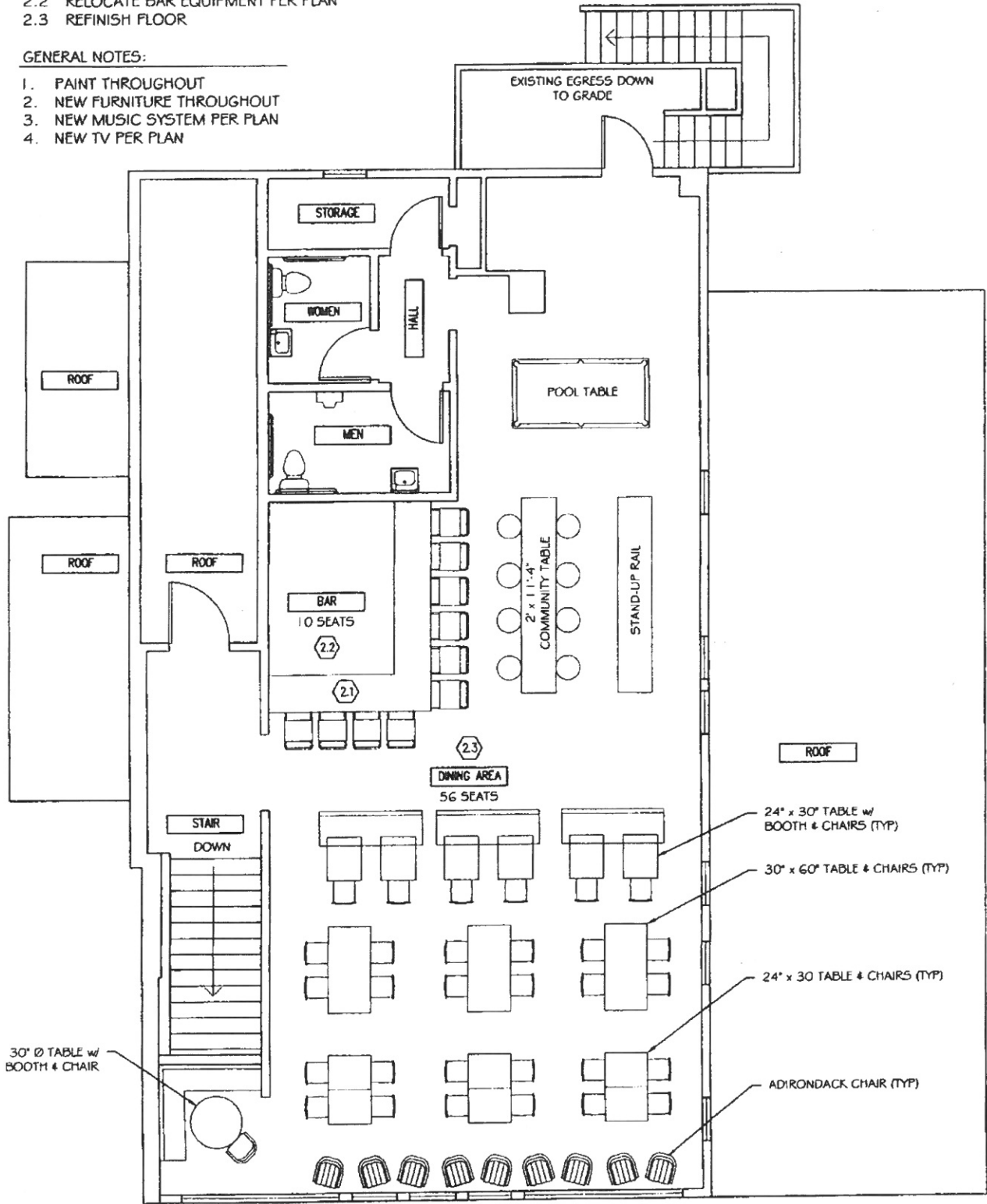

145 NANTASKET AVENUE

SECOND FLOOR PLAN

JANUARY 17, 2019

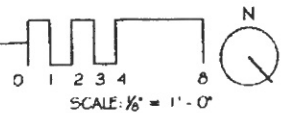

Alcohol:

Interior: Monday – Saturday 8:00am-1:00am and Sunday 10:00am-1:00am

Patio: 11:00am to 10:00pm and Vacated by 11:00pm

Common Vic:

Sunday –Saturday 8:00am-1:00am

Entertainment:

Interior: Sun-Sat 10:00am to 1:00am for a DJ and 3-piece acoustic and piped music

Exterior: Friday and Saturday from 11:00 am to 8:00pm for acoustic only and Sunday from 12:00pm to 6:00pm for acoustic only

Owner to provide sound mitigation on the side of Atherton Road and along the back property line;
Planters must be maintained

Entertainment on Monday holidays permitted on the deck during the same hours as a Sunday

Automatic Amusement:

1 Pool Table