

**5025 MARCONI AVE
CARMICHAEL, CA**

**FOR LEASE
2,350 SF RETAIL SUITE**

ETHAN CONRAD
PROPERTIES INC.



COMPLETELY REMODELED

VIEW VIRTUAL TOUR

FOR MORE INFORMATION CONTACT:

Race Merritt
DRE: #01700659
race@ethanconradprop.com

Joey Chiurazzi
DRE: #02123466
joey@ethanconradprop.com

Austin Barron
DRE: #02082721
abarron@ethanconradprop.com

916.779.1000

FEATURES:

- Shopping center is anchored by CVS Pharmacy, Grocery Outlet, and DollarTree
- Located at the intersection of Marconi Ave and Walnut Ave
- Good visibility and signage on both Marconi Ave and Walnut Ave
- Abundant parking
- Surrounded by dense residential population
- EVgo fast charging stations on-site



PROPERTY DETAILS:

Shopping center tenants include Grocery Outlet, Dollar Tree, NAPA Auto, CVS Pharmacy, Chevron and Round Table Pizza. Centrally located within a dense residential suburb of Sacramento.

Nearby tenants include Arby's, 7-Eleven and Little Caesars. 2.6 miles from American River College and its' 34,500 students.

LEASE RATE:

Suite C: 2,350 SF \$3,032.00 (\$1.29 PSF, NNN)

NNN costs are approximately \$0.29 PSF

DEMOGRAPHICS:

	1 Mile	3 Mile	5 Mile
2023 Total Population (est):	21,926	131,393	375,545
2023 Average HH Income:	\$104,600	\$111,519	\$98,813
Traffic Count @ Marconi & Walnut:		32,500	

ETHAN CONRAD PROPERTIES, INC.

1300 NATIONAL DRIVE, SUITE 100 | SACRAMENTO CA, 95834 | 916.779.1000

www.ethanconradprop.com

The information contained herein has been obtained from sources we believe to be reliable. However, we cannot guarantee, warrant or represent its accuracy and all information is subject to error, change or withdrawal. An interested party and their advisors should conduct an independent investigation of the property to determine to your satisfaction the suitability of the property for your needs.

FLOOR PLAN

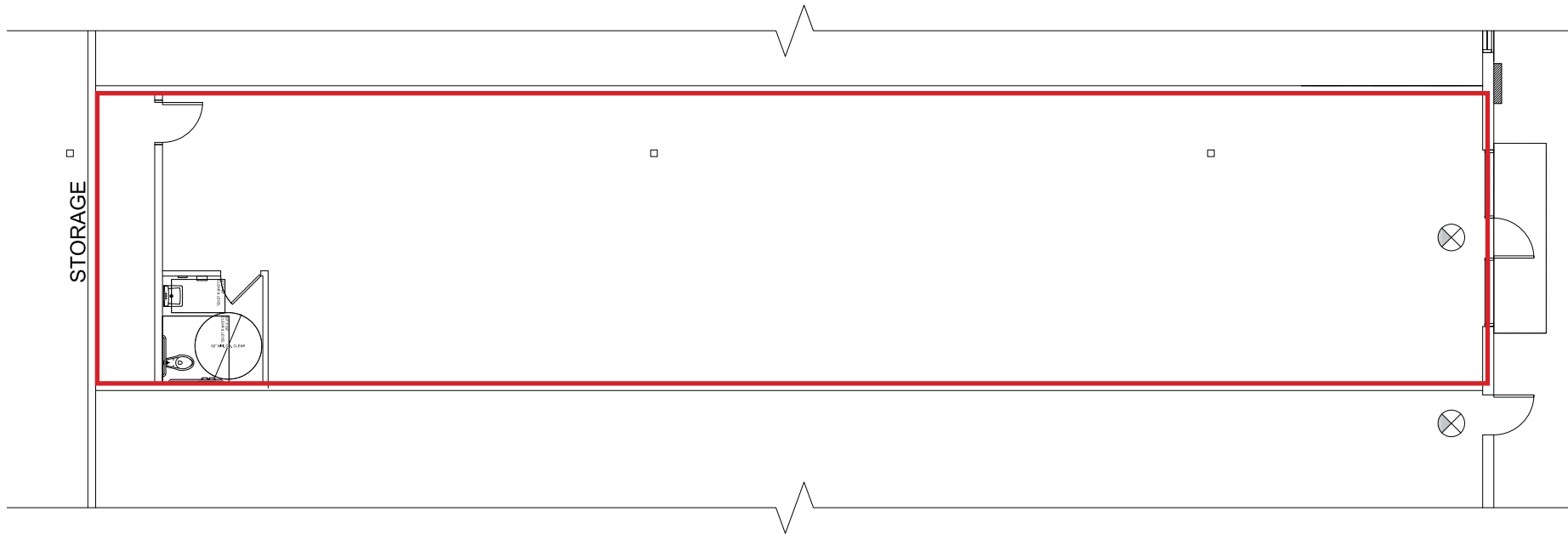

**AVAILABLE
SUITE C
2,350 SF**

[VIEW VIRTUAL TOUR](#)

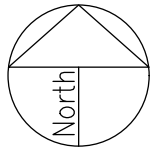

ETHAN CONRAD PROPERTIES, INC.

1300 NATIONAL DRIVE, SUITE 100 | SACRAMENTO CA, 95834 | 916.779.1000

www.ethanconradprop.com

The information contained herein has been obtained from sources we believe to be reliable. However, we cannot guarantee, warrant or represent its accuracy and all information is subject to error, change or withdrawal. An interested party and their advisors should conduct an independent investigation of the property to determine to your satisfaction the suitability of the property for your needs.

SITE PLAN



ETHAN CONRAD PROPERTIES, INC.

1300 NATIONAL DRIVE, SUITE 100 | SACRAMENTO CA, 95834 | 916.779.1000

www.ethanconradprop.com

The information contained herein has been obtained from sources we believe to be reliable. However, we cannot guarantee, warrant or represent its accuracy and all information is subject to error, change or withdrawal. An interested party and their advisors should conduct an independent investigation of the property to determine to your satisfaction the suitability of the property for your needs.



ETHAN CONRAD PROPERTIES, INC.

1300 NATIONAL DRIVE, SUITE 100 | SACRAMENTO CA, 95834 | 916.779.1000

www.ethanconradprop.com

The information contained herein has been obtained from sources we believe to be reliable. However, we cannot guarantee, warrant or represent its accuracy and all information is subject to error, change or withdrawal. An interested party and their advisors should conduct an independent investigation of the property to determine to your satisfaction the suitability of the property for your needs.



ETHAN CONRAD PROPERTIES, INC.

1300 NATIONAL DRIVE, SUITE 100 | SACRAMENTO CA, 95834 | 916.779.1000

www.ethanconradprop.com

The information contained herein has been obtained from sources we believe to be reliable. However, we cannot guarantee, warrant or represent its accuracy and all information is subject to error, change or withdrawal. An interested party and their advisors should conduct an independent investigation of the property to determine to your satisfaction the suitability of the property for your needs.