

# 3841 SWANSON COURT

## Gurnee, IL

### Warehouse For Lease

**David Conroy**  
 (630) 729-7943  
 dconroy@cawleycre.com

**Joe Shapiro**  
 (847) 418-1190  
 jshapiro@cawleycre.com



### Unit 3841

|                  |   |
|------------------|---|
| Total Available: | 26,033 SF   |
| Office:          | 1,209 SF  |
| Loading:         | 3 Interior Docks<br>2 Drive-In-Doors<br>(12'x10' & 14'x12') |
| Power:           | 1,600 Amps @ 480/277 Volts                                  |
| Available:       | Immediately   |
| Lease Rate:      | Subject to Offer  |

### Details

|                 |   |
|-----------------|---|
| Building Size   | 100,000 SF  |
| Clear Height:   | 24'   |
| Car Parking     | 1 per 1,000 SF (26 Cars)                                      |
| Zoning:         | I-3   |
| Sprinklered:    | Wet   |
| Column Spacing: | 40' x 40'   |
| OPEX:           | \$1.37 PSF RE Taxes<br>\$0.69 PSF CAM<br>\$0.14 PSF Insurance |

 Institutional Ownership

 Low Property Taxes





DISCLAIMER: The information contained in this marketing brochure has been secured from sources we believe to be reliable. All information is presented "as is" and Cawley CRE makes no representations or warranties, expressed or implied, as to the accuracy of the information. All information references to, but not limited to, acreage, square footage, age and other measurements are approximations based on reliable sources. All interested parties to purchase, or to lease, should conduct an independent, thorough investigation of the property, and verify all information. Any reliance to the information contained within this marketing material is solely at your own risk, and the interested party bears all risk for any inaccuracies. The property owner reserves the right, at its sole discretion, to reject any offer or expressions of interest, and/or to terminate, or withdraw status of availability, at any time, without notice.

# 3841 SWANSON COURT Gurnee, IL

## Warehouse For Lease

**David Conroy**  
(630) 729-7943  
dconroy@cawleycre.com

**Joe Shapiro**  
(847) 418-1190  
jshapiro@cawleycre.com

### Space Plan & Location Map

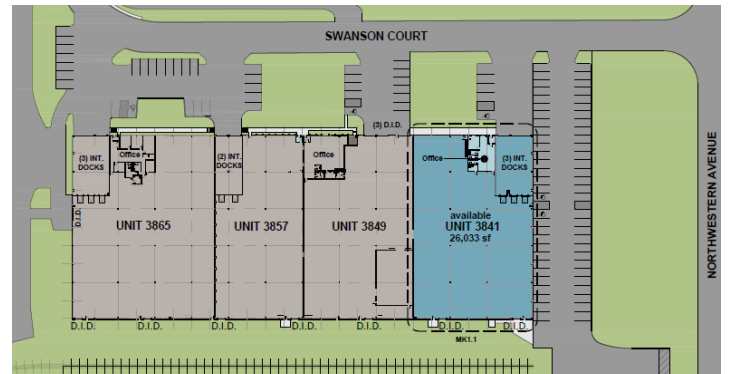
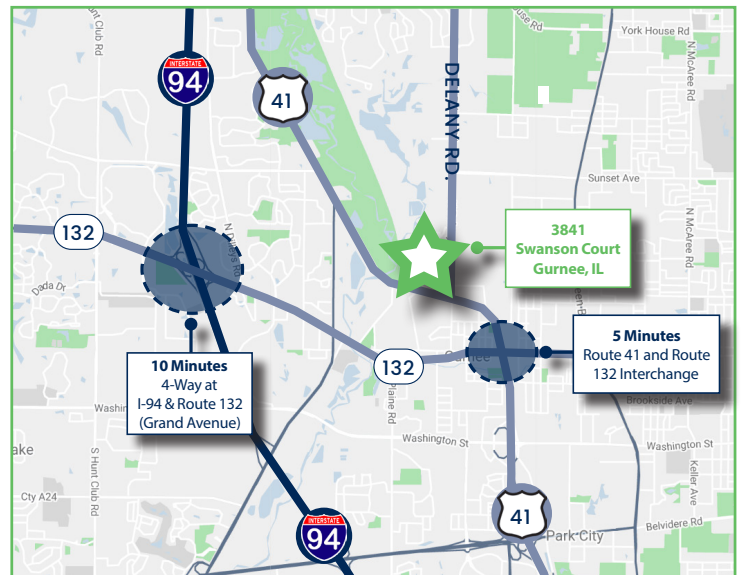
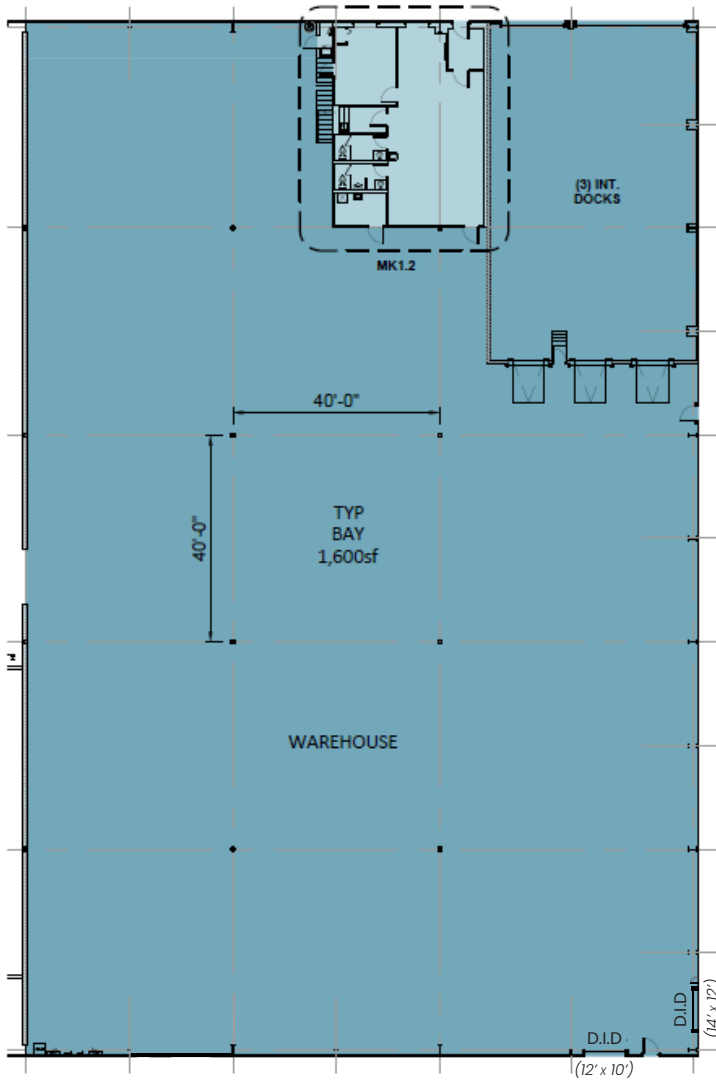

**P PLYMOUTH REIT**

# 3841 SWANSON COURT Gurnee, IL

## Warehouse For Lease

David Conroy  
(630) 729-7943  
dconroy@cawleycre.com

Joe Shapiro  
(847) 418-1190  
jshapiro@cawleycre.com

### Racking Plan | 1,450 Pallet Positions

