

For Lease
2979 West Parkway Blvd
West Valley City, UT 84119



LEASE RATE

\$1.05 NNN

PROPERTY DETAILS

Total SF: 4,848 SF
Office: 600 SF
Warehouse: 4,248 SF
Doors: (1) 12' x 14' GL
(1) 8' x 9' DH
Ceiling: 24' Clear
Power: 3 Phase
Zoning: M

HIGHLIGHTS

- Fire Sprinkled
- Great access to 21st south freeway



CONTACT

Bob Mills

385.988.6477

bob@adventut.com

Riley Mills

385.988.6478

riley@adventut.com



5284 S. Commerce Dr. #C 274, Murray, Utah 84107 / o:801.433.2480 f: 801.290.3172

For Lease
2979 West Parkway Blvd
West Valley City, UT 84119



NORTH
↓

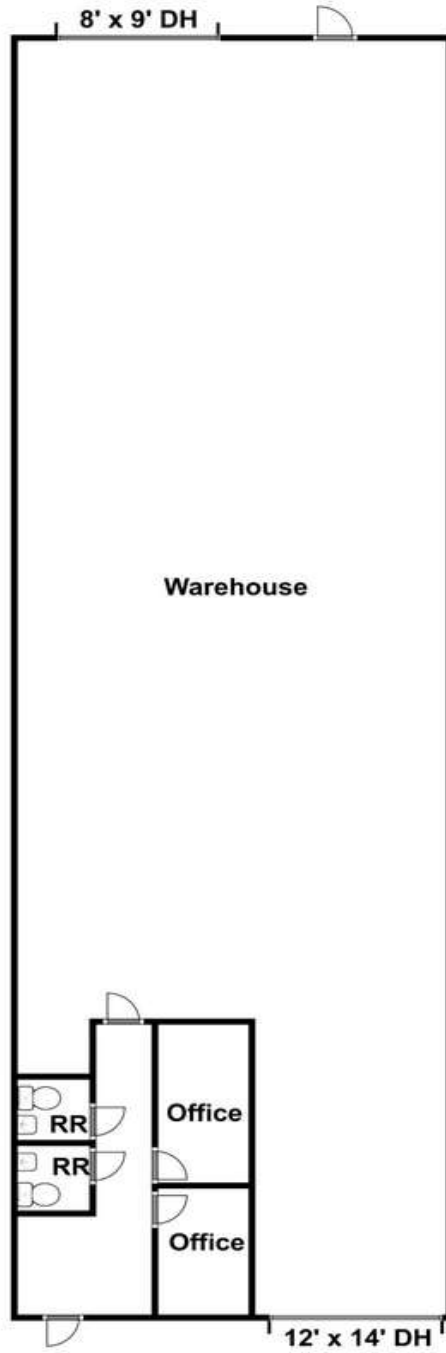

5284 S. Commerce Dr. #C 274, Murray, Utah 84107 / o:801.433.2480 f: 801.290.3172