

35801 Mound Road

Sterling Heights, MI

- 94,209 Sq Ft Corporate Hi-Tech Office Building
- Plug & Play Furnished Office Suites Available from 4,540 to 54,292 RSF
- 20,000 Sq Ft 100% Air Conditioned High-Bay Warehouse/Research Available - Expandable to 44,000 Sq Ft
- Aggressive Rental Rates
- Professionally Managed
- Excellent Freeway Access

CORPORATE HI-TECH INDUSTRIAL OFFICE FOR SALE/LEASE

FOR MORE INFORMATION:

Al Iafrate, SIOR
Senior Vice President
248.637.7791
aiafrate@LMCap.com

248.637.9700 | LMCap.com

Information contained herein was obtained from sources deemed to be reliable but is not guaranteed. Subjects to prior sales, changes of price or withdrawal.

Liberty Place

SALE PRICE REDUCED!



L. MASON CAPITANI
CORFAC INTERNATIONAL

35801 Mound Road

Sterling Heights, MI



248.637.9700 | LMCap.com

Information contained herein was obtained from sources deemed to be reliable but is not guaranteed. Subjects to prior sales, changes of price or withdrawal.

35801 Mound Road

Sterling Heights, MI



L. MASON CAPITANI

CORFAC INTERNATIONAL



248.637.9700 | LMCap.com

Information contained herein was obtained from sources deemed to be reliable but is not guaranteed. Subjects to prior sales, changes of price or withdrawal.

35801 Mound Road

Sterling Heights, MI



248.637.9700 | LMCap.com

Information contained herein was obtained from sources deemed to be reliable but is not guaranteed. Subjects to prior sales, changes of price or withdrawal.

35801 Mound Road

Sterling Heights, MI

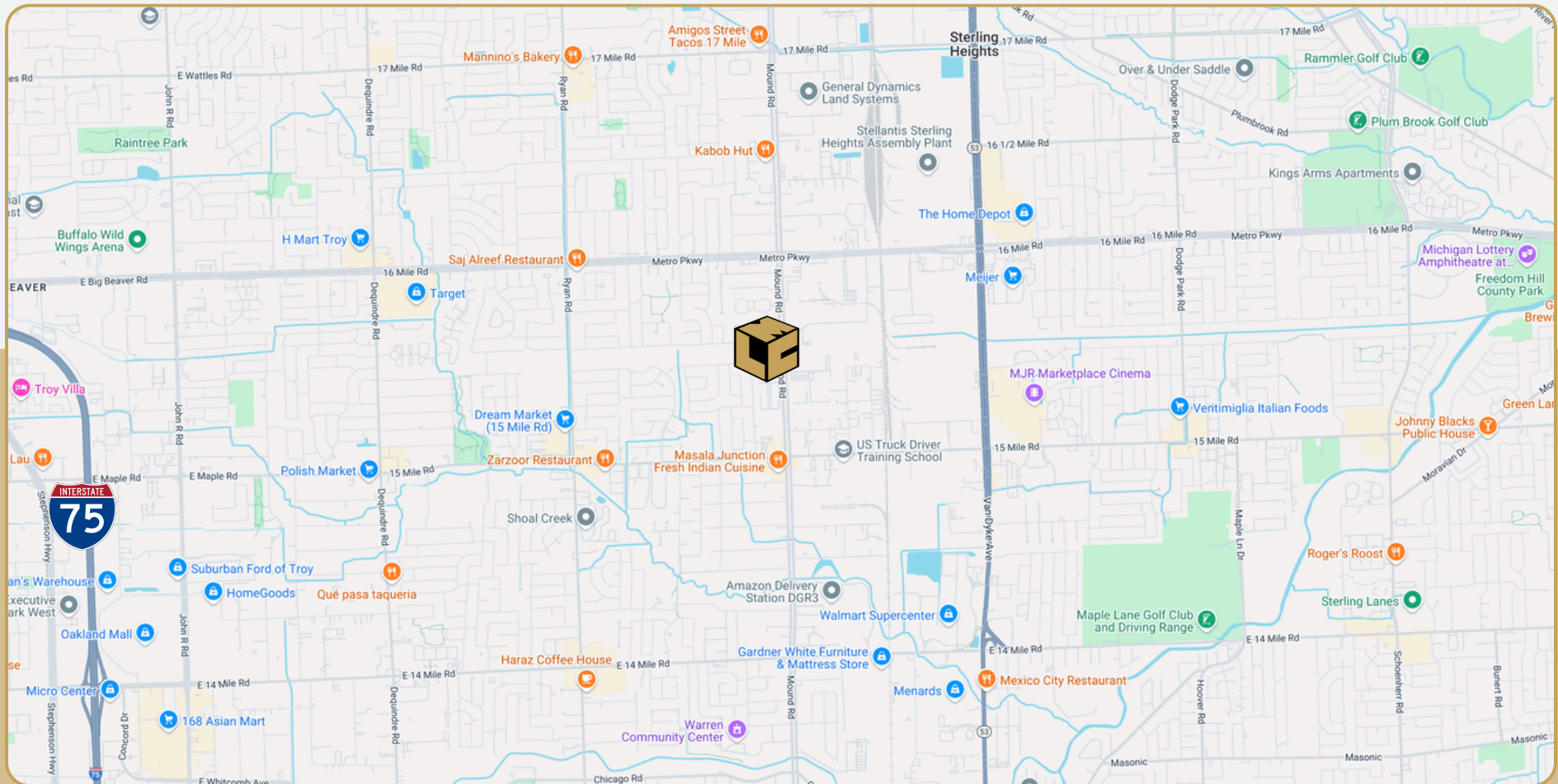

248.637.9700 | LMCap.com

Information contained herein was obtained from sources deemed to be reliable but is not guaranteed. Subjects to prior sales, changes of price or withdrawal.

35801 Mound Road

Sterling Heights, MI



L. MASON CAPITANI
CORFAC INTERNATIONAL

Office Property Details:

Details:

Location Description: 15 Mile/Mound
Building Type: Office
Class: B
Zoning: Innovation Support
Floors: 2
Year Built: 1991
Year Renovated: 2008
Gross SF: 94,209 SF
Total Rentable SF: 94,209 SF
Available SF: 54,262 SF
Min/Max SF: 4,540 SF - 54,262 SF
Acres: 5.05
Multitenant: No
Parcel ID: 20-21-351-012

Property Description: Hi-Tech Office Research building. Plug-and-play furnished office suites and a 100% A/C high-bay Warehouse/Research Facility expandable to 44,000 Sq Ft. Aggressive rental rates, Operating expenses include suite utilities, professionally managed. Sale price reduced!

Economic:

Min/Max Rental Rate: \$11.95/SF
Rental Terms: NNN
Annual Escalations: \$0.50/SF
Load Factor: 13.0%
Occupancy: Immediate
Parking: 325
Partition Allowance: Negotiable
Signage: Yes
Status: Existing
Operating Expenses: \$5.40
Sale Price: \$9,995,000
Price/SF: \$105.16/SF

35801 Mound Road

Sterling Heights, MI



Available Suites:



Suite 102: 26,669 RSF

Suite 200: 4,540 RSF

Suite 202: 4,732 RSF

Suite 200/202: 9,272 RSF

Suite 206: 18,231 RSF

Suite 102/200/202/206 54,292 RSF

248.637.9700 | LMCap.com

Information contained herein was obtained from sources deemed to be reliable but is not guaranteed. Subjects to prior sales, changes of price or withdrawal.

35801 Mound Road

Sterling Heights, MI



L. MASON CAPITANI
CORFAC INTERNATIONAL

First Floor Vacancies:

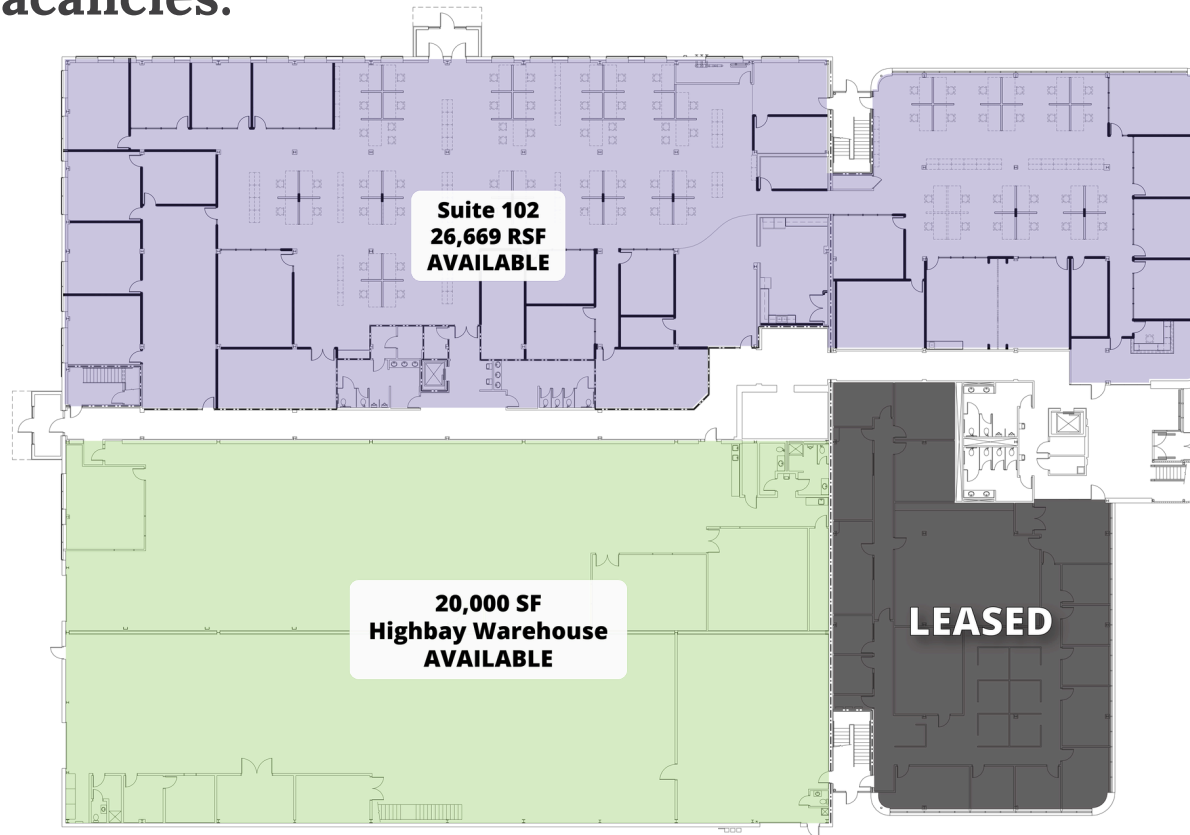

Suite Number	Square Footage
102	26,669 RSF
102/200/202/206	54,262 RSF
Warehouse	20,000 RSF

248.637.9700 | LMCap.com

Information contained herein was obtained from sources deemed to be reliable but is not guaranteed. Subjects to prior sales, changes of price or withdrawal.

35801 Mound Road

Sterling Heights, MI



L. MASON CAPITANI
CORFAC INTERNATIONAL

Second Floor Vacancies:

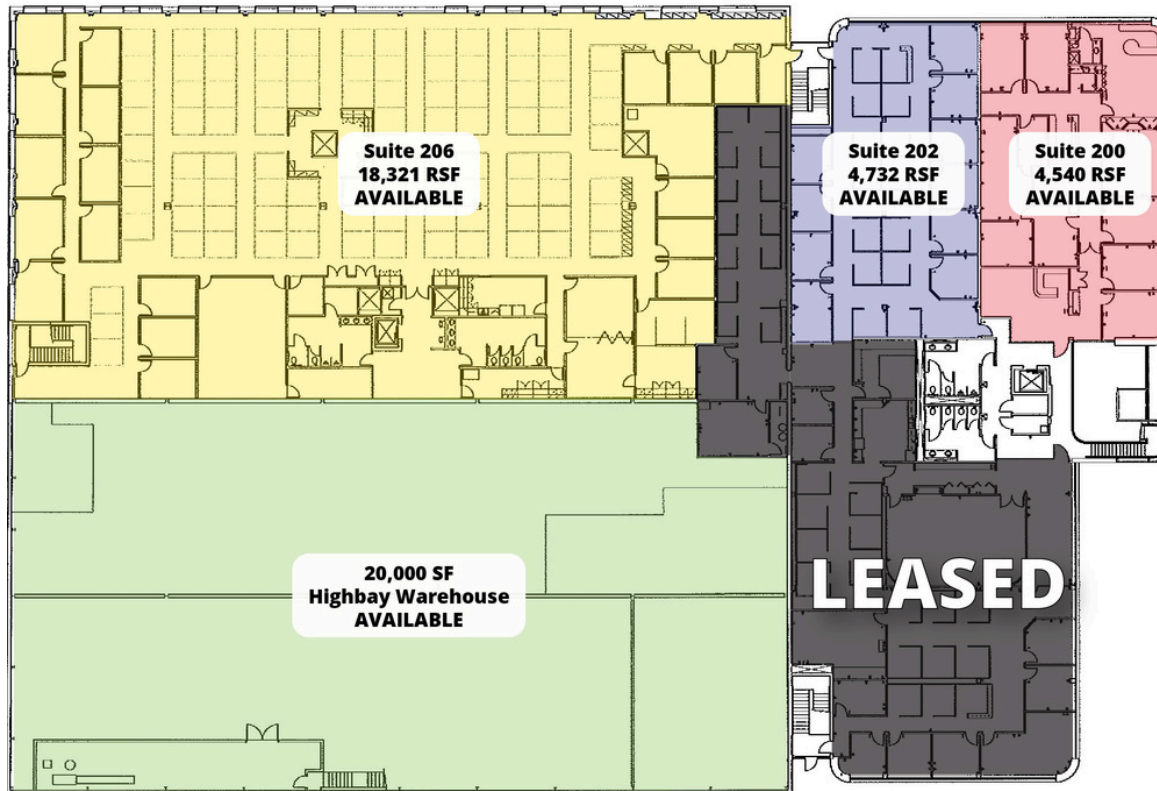

Suite Number	Square Footage
200	4,540 RSF
202	4,732 RSF
200/202	9,272 RSF
206	18,321 RSF
200/202/206	27,593 RSF
102/200/202/206	54,262 RSF
Warehouse	20,000 RSF

248.637.9700 | LMCap.com

Information contained herein was obtained from sources deemed to be reliable but is not guaranteed. Subjects to prior sales, changes of price or withdrawal.

35801 Mound Road

Sterling Heights, MI



L. MASON CAPITANI
CORFAC INTERNATIONAL

Site Plan:

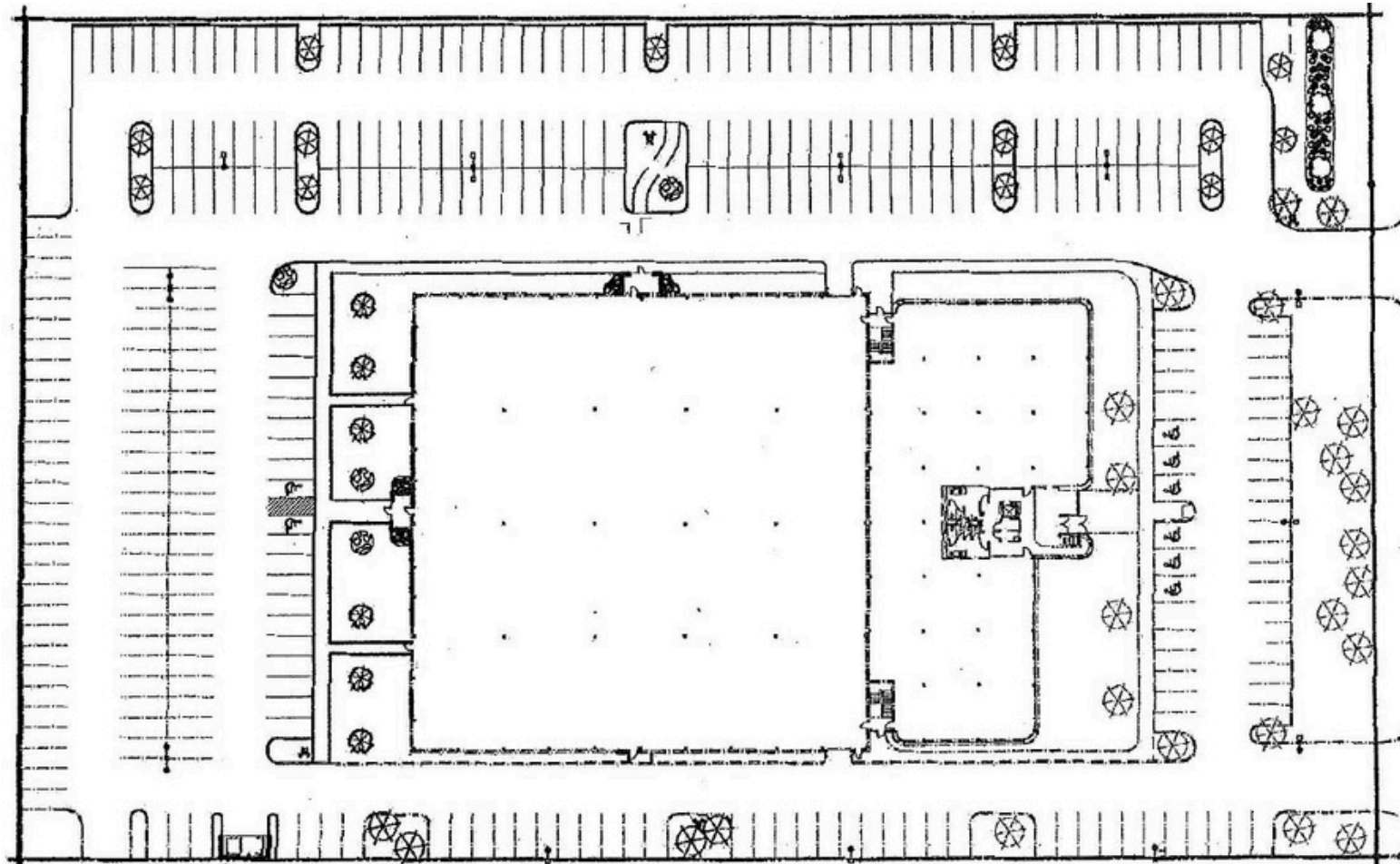

248.637.9700 | LMCap.com

Information contained herein was obtained from sources deemed to be reliable but is not guaranteed. Subjects to prior sales, changes of price or withdrawal.