

1370 Dundas Street E

Mississauga | Office space in 3 storey complex at the corner of Dundas St and Dixie Rd.

For Lease: Office



Available Space		Net Rent (PSF)
Suite 201:	1,140 SF	\$17.00
Suite 203B:	1,304 SF	\$17.00
Suite 204:	1,783 SF	\$17.00
Suite 205:	2,494 SF	\$15.00
Suite 210:	1,295 SF	\$15.00
Suite 205/210:	3,789 SF	\$15.00

Additional Rent

\$16.57 PSF (2026 est.)
(Includes utilities)

Property Highlights

- Close to Hwy 427 & QEW
- Bus stop at front of property
- 3 storey complex – office space on 2nd & 3rd floors
- Abundant free surface parking at back of property
- Great visibility podium & building fascia signage
- Ideal for medical, retail and professional uses
- Intercom for after hours

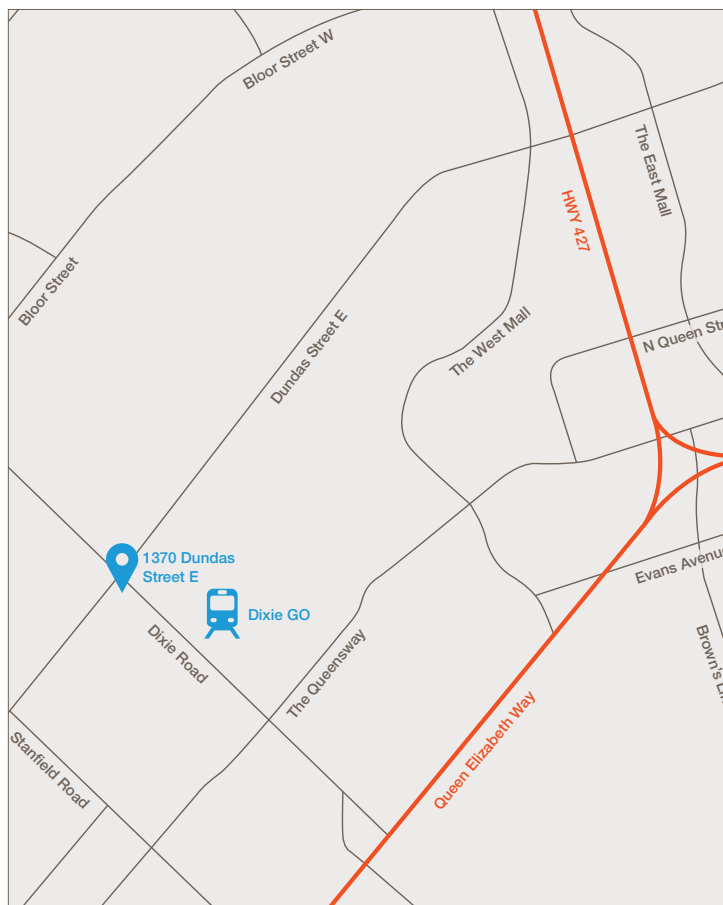

Lennard:

Lennard Commercial Realty, Brokerage
602-350 Burnhamthorpe Road W
905.625.5020 • lennard.com

Steven Gottdank*, Vice President
905.247.9221 • sgottdank@lennard.com
Bob Cranch*, Vice President
905.247.9223 • bcranch@lennard.com

1370 Dundas Street E



Floor Plan

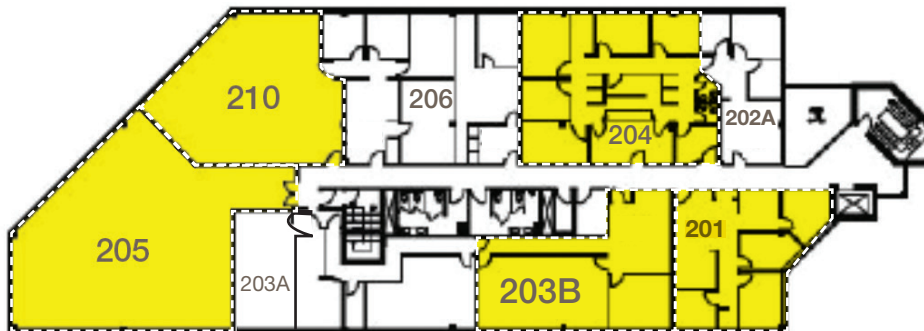

Lennard:

Lennard Commercial Realty, Brokerage
602-350 Burnhamthorpe Road W
905.625.5020 • lennard.com

Steven Gottdank*, Vice President
905.247.9221 • sgottdank@lennard.com

Bob Cranch*, Vice President
905.247.9223 • bcranch@lennard.com

*Sales Representative. Statements and information contained are based on the information furnished by principals and sources which we deem reliable but for which we can assume no responsibility. Property outlines are approximate. Lennard Commercial Realty, Brokerage.