



BE THE ONE



PENTHOUSE
I & II



**WHERE HEIGHT
HOLDS MEANING**

At the edge of the sky stands an offering of rare air.
A landmark of global recognition – accessible yet
reserved for those who rise beyond.



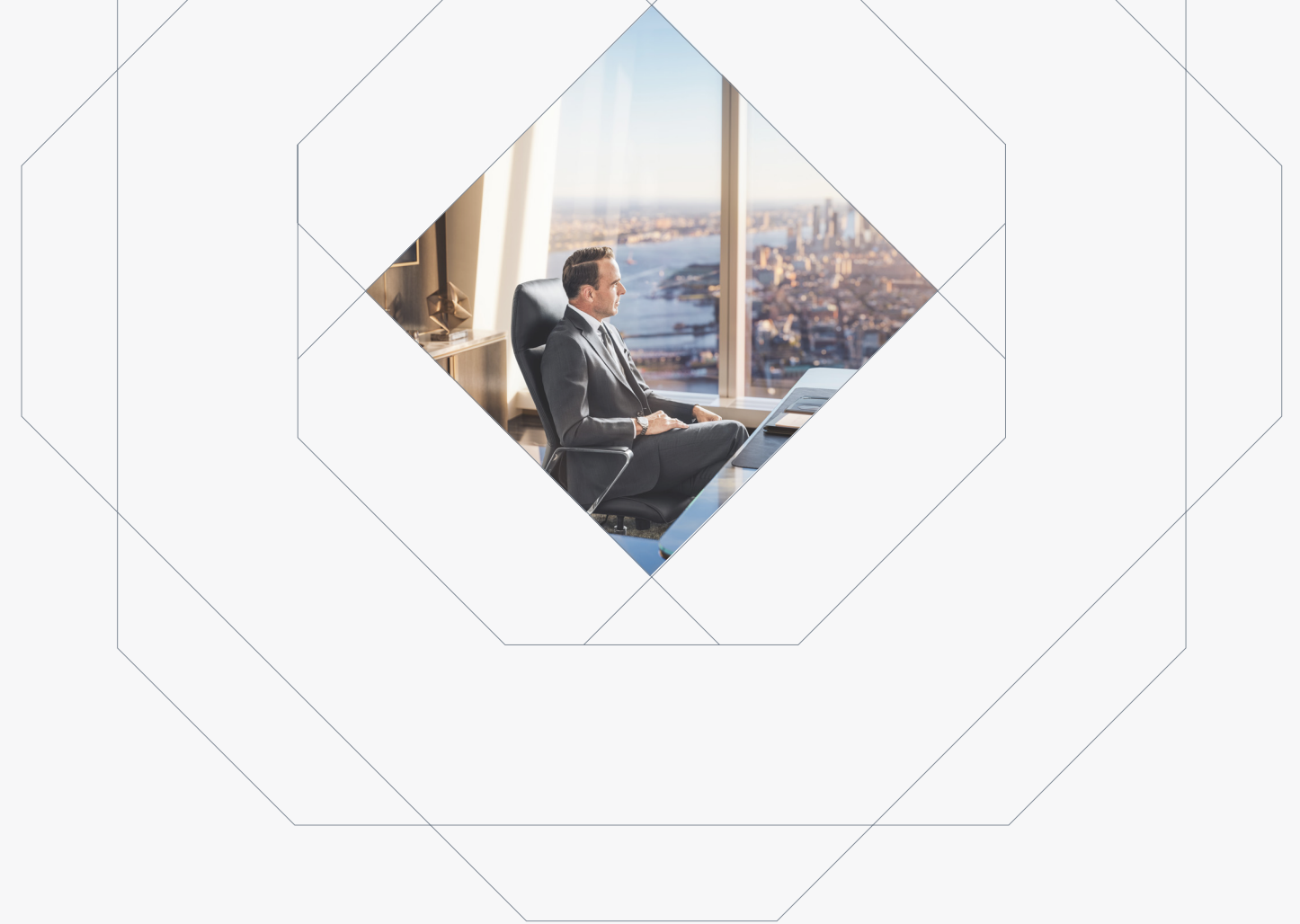

AIR, UNTOUCHED

Rise to the highest office floors in the nation. Here, altitude becomes opportunity – light-filled and limitless.

SPACE, AMPLIFIED

Ceilings soar to 23 feet. Double-height windows give way to the world. A luminous experience – expanded in every direction.





**PERSPECTIVE
WITHOUT PARALLEL**

360-degree views surround – Midtown to the Harbor, the Hudson to the East River.
A vantage drawn in glass.





CLARITY AFTER DARK

Ambition doesn't dim at dusk, it deepens – quietly, clearly, with intent.





CORE & SHELL

MIDTOWN MANHATTAN



NEW YORK HARBOR



PENTHOUSE I
33,043 SQ FT



TEST FIT

MIDTOWN MANHATTAN

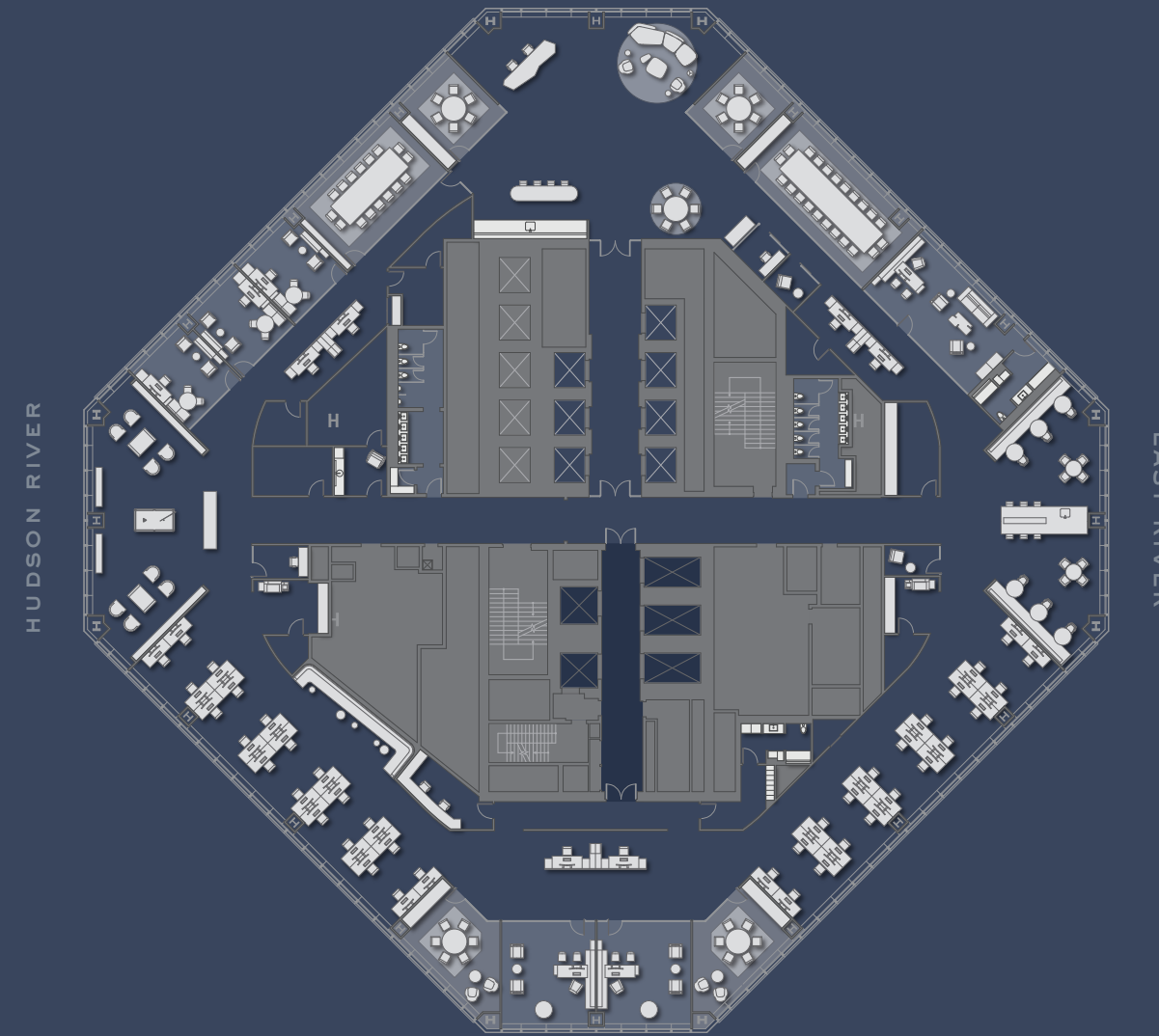

NEW YORK HARBOR

Reception	2
Executive Office	3
Office	3
Administrative Assistant	6
Workstation	40
TOTAL HEADCOUNT	54
CONFERRING	62

CORE & SHELL

MIDTOWN MANHATTAN



NEW YORK HARBOR

ONE
WORLD TRADE CENTER

PENTHOUSE II
12,908 SQ FT

TEST FIT

MIDTOWN MANHATTAN

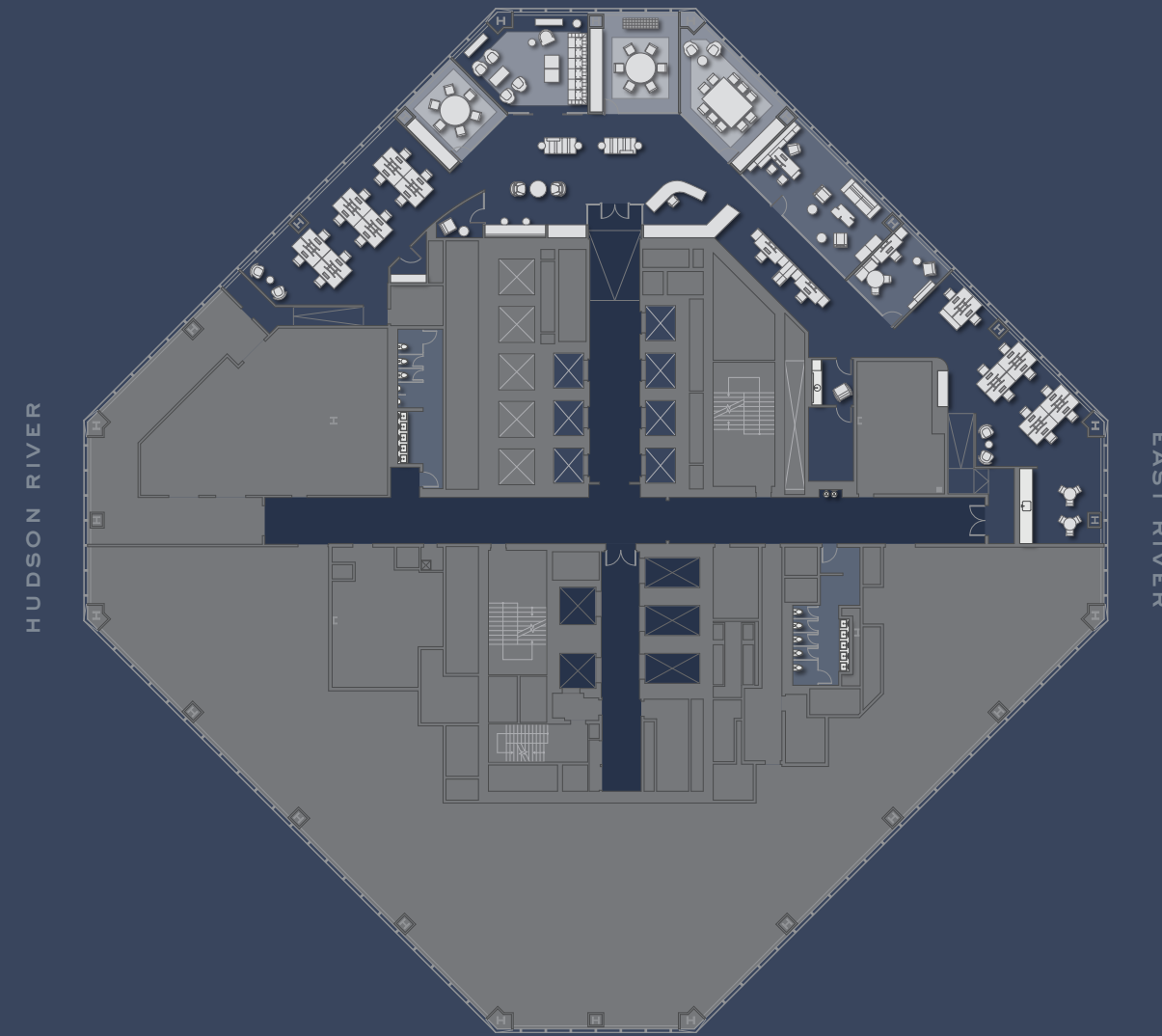

NEW YORK HARBOR

Reception	1
Executive Office	1
Office	1
Administrative Assistant	2
Workstation	22
TOTAL HEADCOUNT	27
CONFERRING	22

TEST FIT

MIDTOWN MANHATTAN

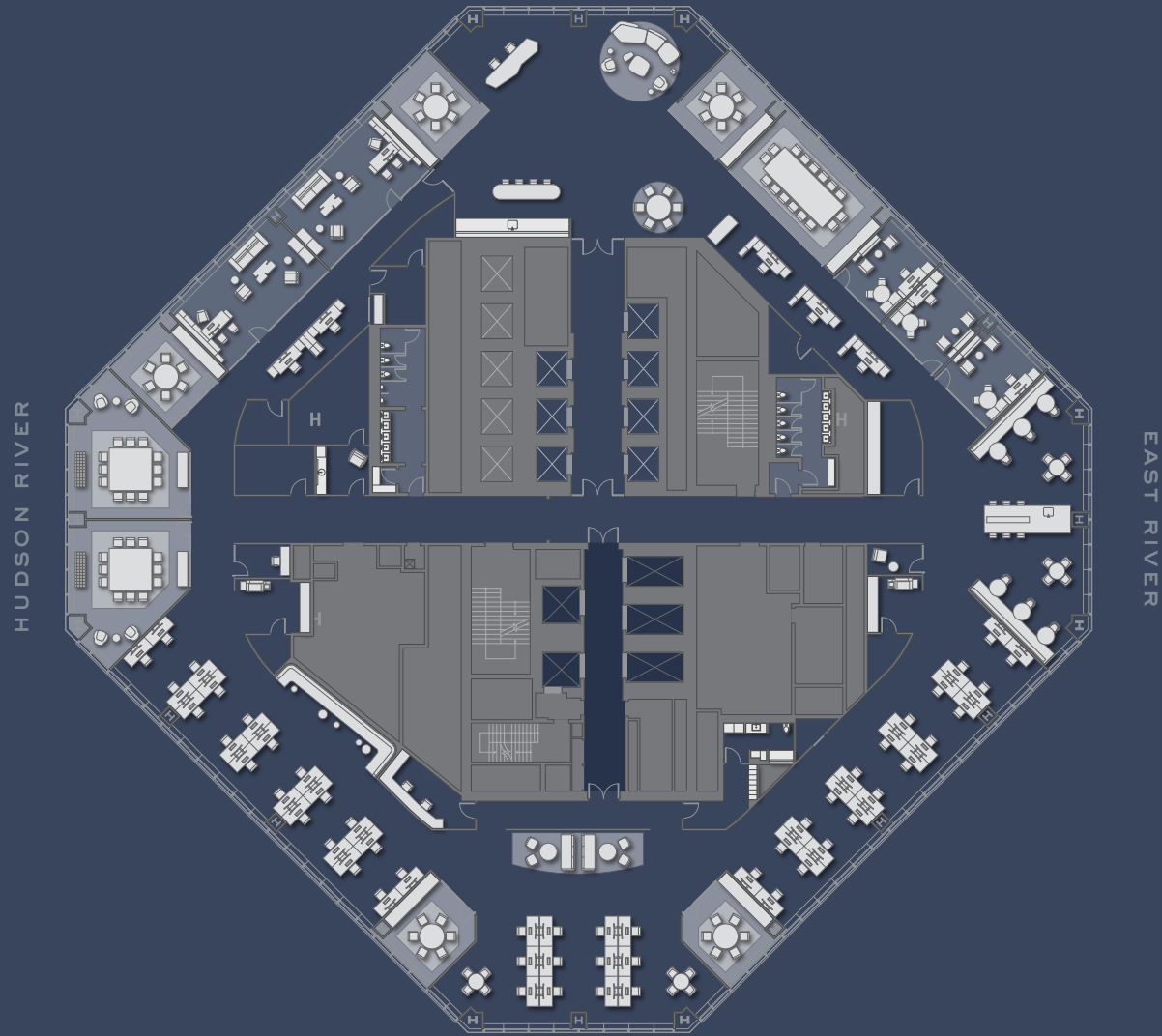

EAST RIVER

NEW YORK HARBOR



PENTHOUSE I & II
 45,951 SQ FT



TEST FIT

MIDTOWN MANHATTAN

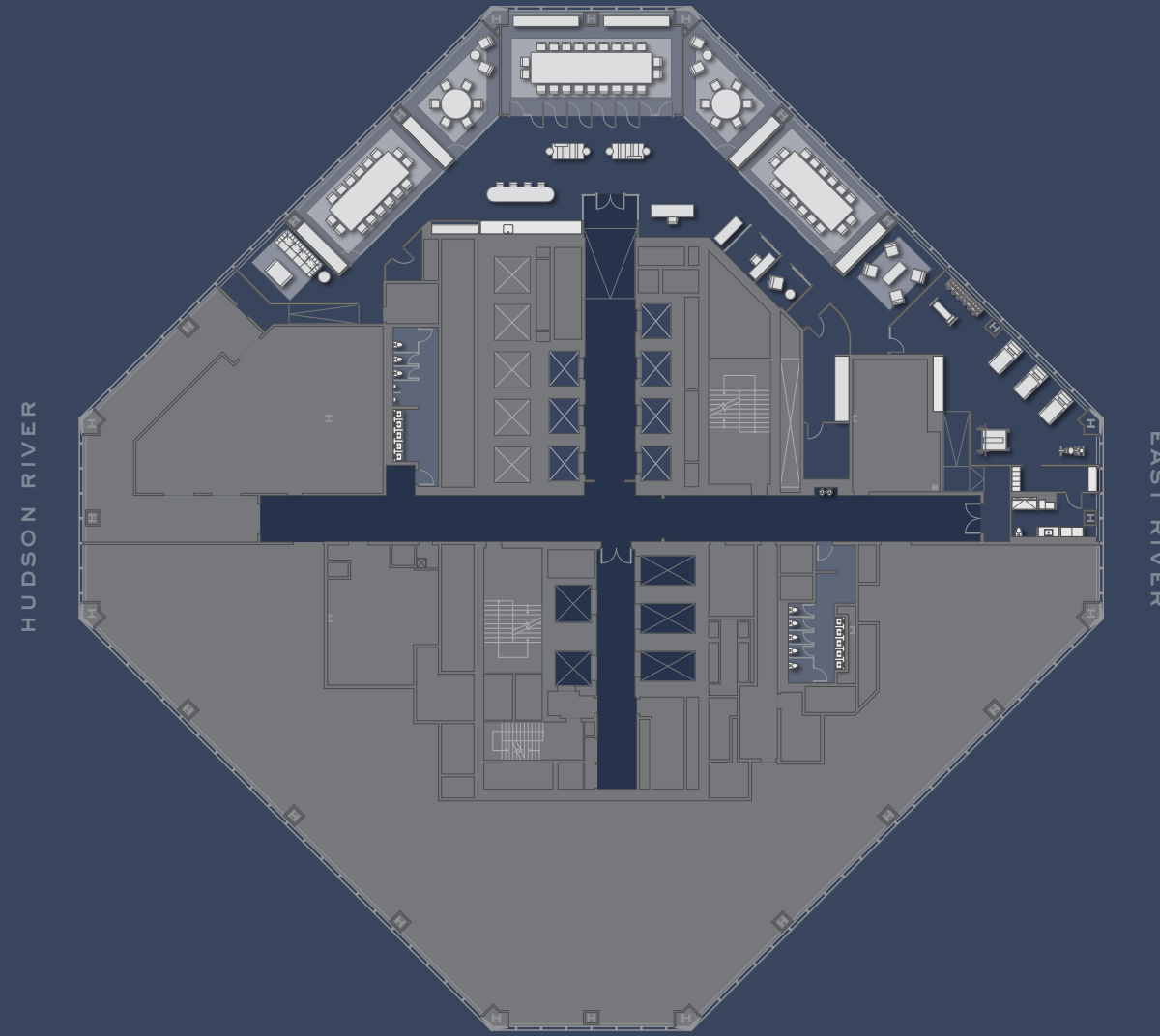

HUDSON RIVER

EAST RIVER

NEW YORK HARBOR

Reception	3
Executive Office	2
Office	3
Administrative Assistant	5
Workstation	52
TOTAL HEADCOUNT	65
CONFERRING	130

LEASING INQUIRIES



ERIC ENGELHARDT

212.667.8704
eengelhardt@durst.org

KAREN ROSE

212.667.8705
krose@durst.org

SAYO KAMARA

212.667.8710
skamara@durst.org

NEWMARK

DAVID FALK

212.372.2271
david.falk@nmrk.com

HAL STEIN

212.233.8185
hal.stein@nmrk.com

PETER SHIMKIN

212.372.2150
peter.shimkin@nmrk.com

NATHAN KROPP

212.372.2056
nathan.kropp@nmrk.com

PAIGE RAISIDES

212.655.1227
paige.raisides@nmrk.com



ONETM
WORLD TRADE CENTER
PENTHOUSE
I & II



Printed on FSC® Certified
Post-Consumer Fiber