



Kyle Selby, MSRE
kselby@selbyrealty.com
(386) 295-3313



**SELBY
REALTY**

200 E. Granada Blvd., Suite 207
Ormond Beach, FL 32176
(386) 238-4456 O.
(386) 238.8377 F.

13,000SF—25,800SF RETAIL SPACE FOR LEASE



333 W. Granada Blvd., UNIT 200 Ormond Beach, FL 32174

Property Highlights

- 333 West Granada— Multi-Tenant Retail Business Center
- Available space could be subdivided from 13,000sf up to 25,800sf.
- 20'+ Clear Height
- The red outline on the picture to the right is approximately 13,000SF and the blue is approximately 25,000SF
- 13,000sf (red) portion is approximately 84' x 155'.

Property Details

- Site:** Highly Visible and Well-Known Plaza Located between US1 and Nova Rd. on the most desirable commercial corridor in Ormond Beach.
- Building:** Single-story, Multi-Tenant Retail Building
- Parking:** On-site parking lot
- Unit 200:** 13,000SF—25,000SF of move-in ready space
- Rate:** \$14.95/SF NNN blended rate for taking entire 25,000sf. Base rate for front 13,000sf is \$19.50.
- Passthroughs:** Estimated to be \$4.14
- Signage:** Building and monument signage
- Zoning:** B-10, Central Business, City of Ormond Beach
- Traffic:** 36,000 (AADT 2020)
- Location:** Granada Blvd (St. Rt. 40), 1 block West of A1A
- Food Nearby:** Moe's, Jimmy John's, Wendy's, La Catrina Mexican, & many others
- Availability:** April 2026

333 W GRANADA UNIT 200 FLOOR PLAN

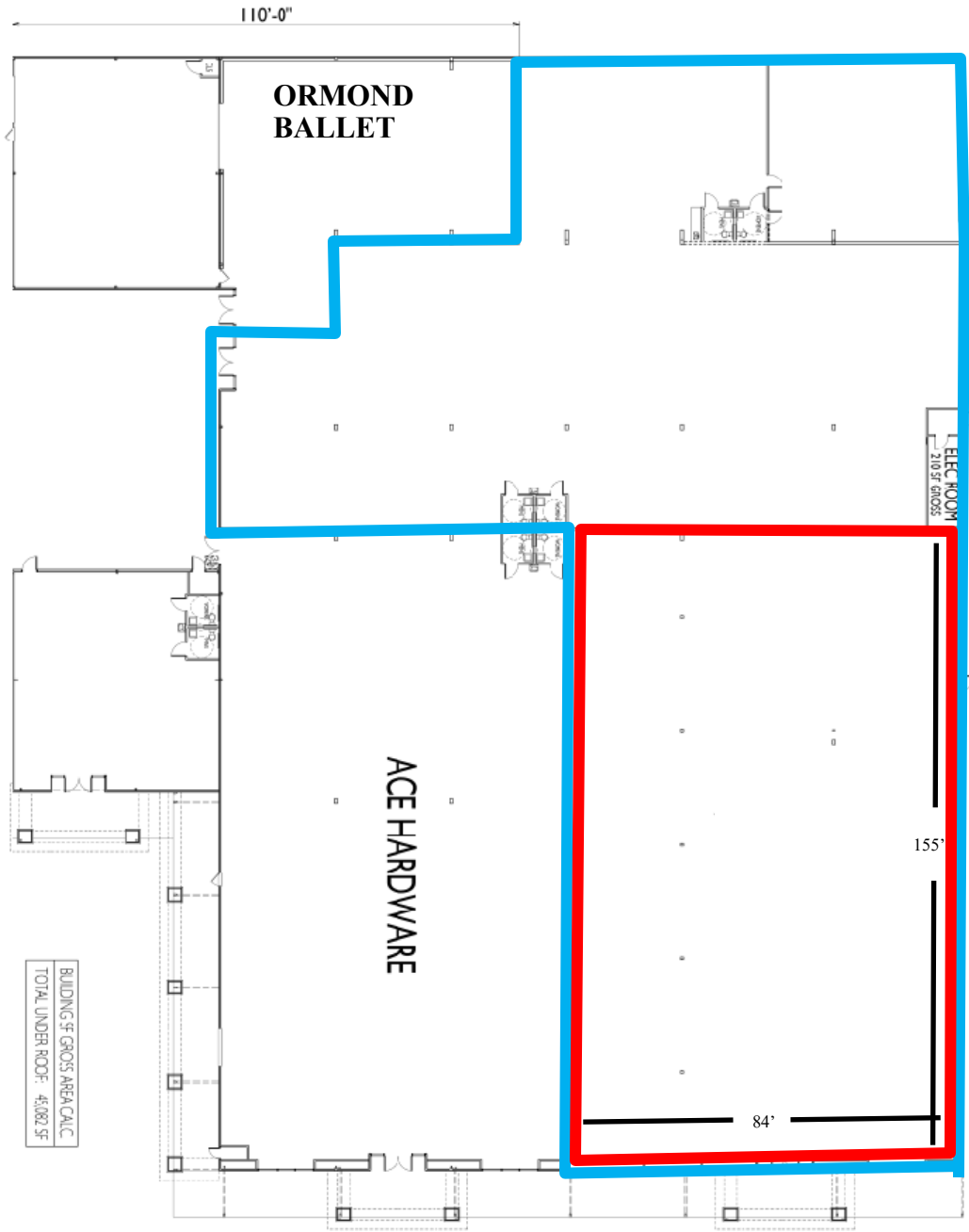

333 W GRANADA UNIT 200 PICTURES



SELBY
REALTY



*Pictures 2 and 3 are AI generated
to show what the space could look
like.*

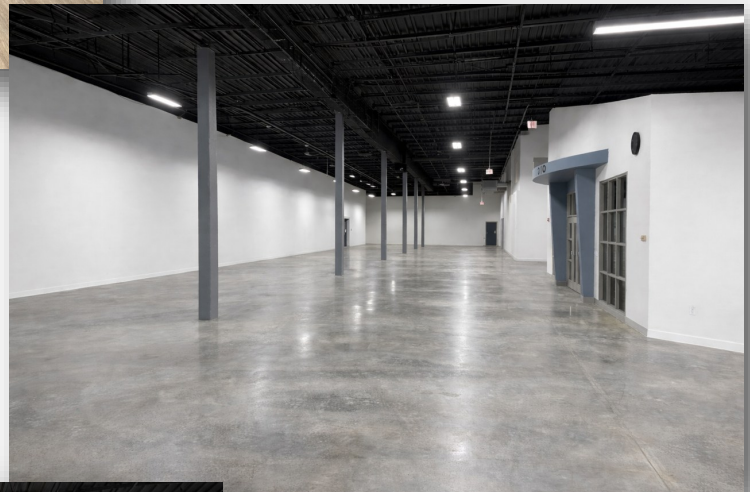

333 W. GRANADA UNIT 200 PROPERTY MAP

