

BAYSIDE REALTY PARTNERS PRESENTS

Park Place Medical

1761 Broadway Street, Vallejo, California

Healthcare Campus Adjacent MOB in North Bay



TRASK LEONARD
President and CEO
650.533.2591
tleonard@baysiderp.com
DRE#01152101



CAROLINE DOYLE
Senior Vice President
650.722.1495
cdoyle@baysiderp.com
DRE#01906397



Park Place Medical

1761 Broadway Street, Vallejo, California

LOCATION

- Immediately off Hwy 37 and Sonoma Blvd (Hwy 29)
- Great visibility from Broadway Street and access from Sonoma Blvd
- Next to public transportation, restaurants, pharmacies, Starbucks and supermarket
- Less than 0.5 mile from the 248-bed Kaiser Permanente Vallejo Medical Center and 1.5 miles from the 102-bed Sutter Solano Medical Center



BUILDING

2 story Class A medical office building — 58,000 sf

Security on premises

Building open 6 days a week

Spaces ready for built-out and move-in

Ample on-site parking; close proximity to retail services. 240 spaces

Park Place Medical

1761 Broadway Street, Vallejo, California

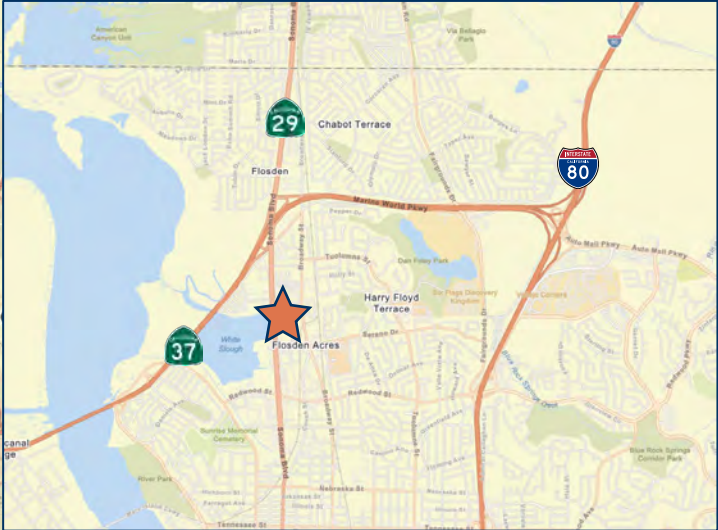

Park Place Medical

1761 Broadway Street, Vallejo, California

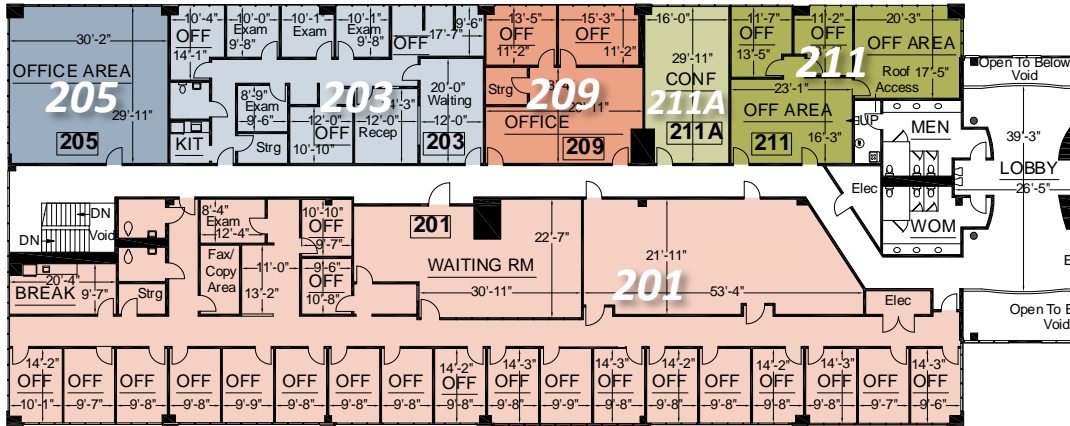

SECOND FLOOR

- Suite 201** **8,307 RSF**
 21 office/exam rooms, large waiting room, large conference/training room, large conference/training room, 2 restrooms, kitchen
- Suite 203** **2,141 RSF**
 3 offices, 4 exam rooms, waiting room, reception, kitchen, 1 restroom
- Suite 205** **1,090 RSF**
 Open office area
- Suite 209** **1,055 RSF**
 3 office/exam rooms, storage
- Suite 211** **1,346 RSF**
 4 office/exam rooms. *Can be combined with 211A for total of 1,948 RSF*
- Suite 211A** **602 RSF**
 1 office. *Can be combined with 211 for total of 1,948 RSF*

Park Place Medical

1761 Broadway Street, Vallejo, California



SECOND FLOOR

- Suite 200** **2,397 RSF**
 Waiting room/reception, 5 office/exam rooms, lab area
- Suite 210** **6,227 RSF**
 10 office/exam rooms, reception, break room, storage, open space, 2 restrooms
- Suite 211** **1,834 RSF**
 4 office/exam rooms, conference room
- Suite 240/260** **1,688-1,961 RSF**
 Waiting room/reception, 8 office/exam rooms + open office area

Meet Your Expert Team



TRASK LEONARD

President and CEO

650.533.2591

tleonard@baysiderp.com

DRE#01152101



CAROLINE DOYLE

Senior Vice President

650.722.1495

cdoyle@baysiderp.com

DRE#01906397

DOMINANT. EXPERT. INFLUENTIAL.

BAYSIDE REALTY PARTNERS

The preeminent provider of management, leasing, construction management and accounting services for healthcare properties.



MARKET LEADER

- Leasing & Property Management
- Investment Sales
- Tenant Representation
- Construction Management
- Property Repositioning



INFLUENTIAL NETWORK

- Institutional Investors
- Healthcare Systems and Healthcare Districts
- Physicians & Districts
- Private Investors



DOMINANT FOOTPRINT

- 2 million SF leased & managed
 - 50+ MOB portfolio
 - 10,000-240,000 SF
 - 500,000 SF portfolio
- San Francisco's largest MOBs
- 950+ leases executed
- 500+ medical and dental tenants

DOMINANT. EXPERT. INFLUENTIAL.