

DENTAL OFFICE SPACE FOR LEASE



WHAT MATTERS TO YOU >

LOCATION

HIGHLY VISIBLE LOCATION
WITH EASY ACCESS TO ROUTE 7

SIZE

2,301 RSF

LAKES AT ASHBROOK BUILDING 2

44345 PREMIER PLAZA, SUITE 220
ASHBURN, VA 20147

ADDITIONAL FEATURES

- Built out dental space
- Building signage
- Walkable amenity base
- Free and unreserved parking
- 5 plumbed operatories, 1 office, 2 ADA bathrooms, consultation room, kitchenette, storage room, utility room, 2 suite entry doors, beautiful lake views.



**GITTLESON
ZUPPAS**
MEDICAL REALTY

3 Bethesda Metro Center, Suite 700 // Bethesda, MD 20814
301.235.1300 // gzrealty.net

CONTACT US TODAY

ANDREW M. PAPANTONIOU
ANDREW@GZREALTY.NET

MICHAEL H. FRIEDLANDER
MICHAEL@GZREALTY.NET

Suite 220 | 2,301 RSF

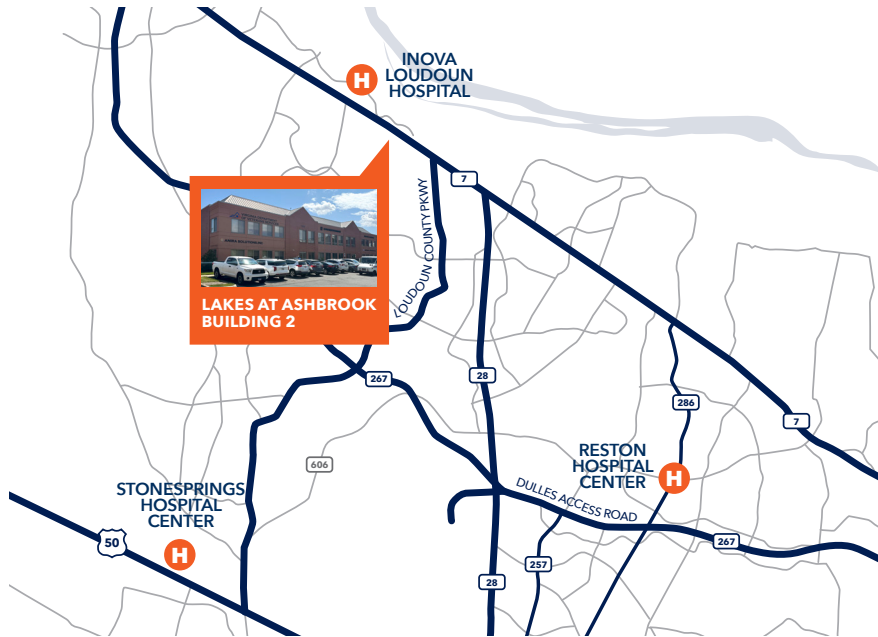
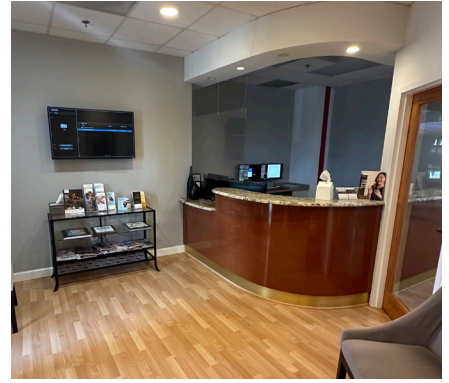
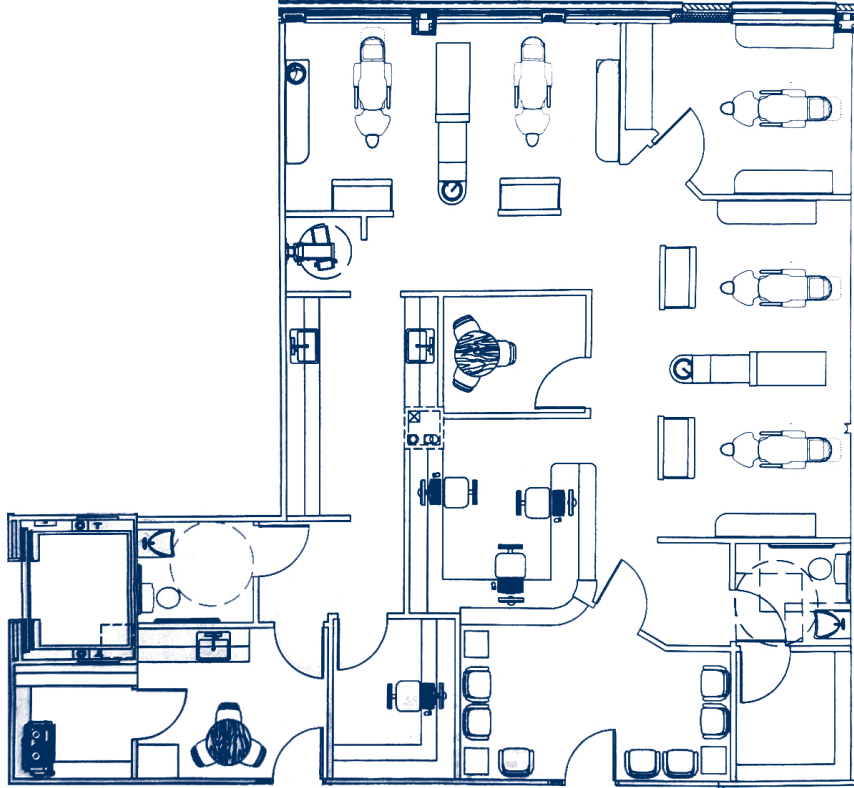

3 Bethesda Metro Center, Suite 700 // Bethesda, MD 20814
301.235.1300 // gzrealty.net

CONTACT US TODAY

ANDREW M. PAPANTONIOU
ANDREW@GZREALTY.NET

MICHAEL H. FRIEDLANDER
MICHAEL@GZREALTY.NET