

RETAIL SUITES FOR LEASE



705-735 CENTRE OF NEW ENGLAND BLVD

Coventry, RI 02816

DAN FEINER

Vice President
401.751.3200 x3310
dan@mgcommercial.com

GEORGE PASKALIS, SIOR

Partner
401.751.3200 x3303
george@mgcommercial.com

MG COMMERCIAL

365 Eddy Street, Penthouse Suite
Providence, RI 02903
401.751.3200 | mgcommercial.com

PROPERTY SUMMARY

RETAIL SUITES FOR LEASE



PROPERTY DESCRIPTION

Two units are currently available at the property. Unit 733 offers 1,200 SF, with the potential to expand up to 2,200 SF while Unit 737 is a 4,020 SF end-cap space. Both units feature large front-facing windows that provide abundant natural light. The property also offers ample storefront parking for customers and clients, along with excellent visibility from the road.

PROPERTY HIGHLIGHTS

- Unit interiors feature completely open floor plans
- Prime retail location, easily accessible
- Surrounded by high performing big box users
- Proven retail market & strong retail synergy w/in Centre of New England
- Ample parking on site

UNIT	LEASE RATE	SPACE SIZE
733	\$22.50 SF/yr	1,200 SF
737	\$19.50 SF/yr	4,020 SF

LOCATION DESCRIPTION

The Centre of New England is conveniently located off I-95 (Exit 7) in Coventry, Rhode Island. The development features major retailers and amenities, including Home Depot, Walmart Supercenter, BJ's Wholesale Club, Cracker Barrel, Applebee's, and several hotels, including Marriott, Holiday Inn, and Hampton Inn, along with hundreds of residential apartments with additional units under construction.

OFFERING SUMMARY

Lease Rate:	\$19.50 - 22.50 SF/yr (NNN)
Available SF:	1,200-2,200 & 4,020 SF
Building Size:	12,000 SF

DEMOGRAPHICS	3 MILES	5 MILES	7 MILES
Total Households	12,235	31,891	52,337
Total Population	28,312	74,090	124,250
Average HH Income	\$114,369	\$117,051	\$122,202

DAN FEINER
 Vice President
 401.751.3200 x3310
 dan@mgcommercial.com

GEORGE PASKALIS, SIOR
 Partner
 401.751.3200 x3303
 george@mgcommercial.com

365 Eddy Street, Penthouse Suite
 Providence, RI 02903
 mgcommercial.com



SITE PLAN

RETAIL SUITES FOR LEASE

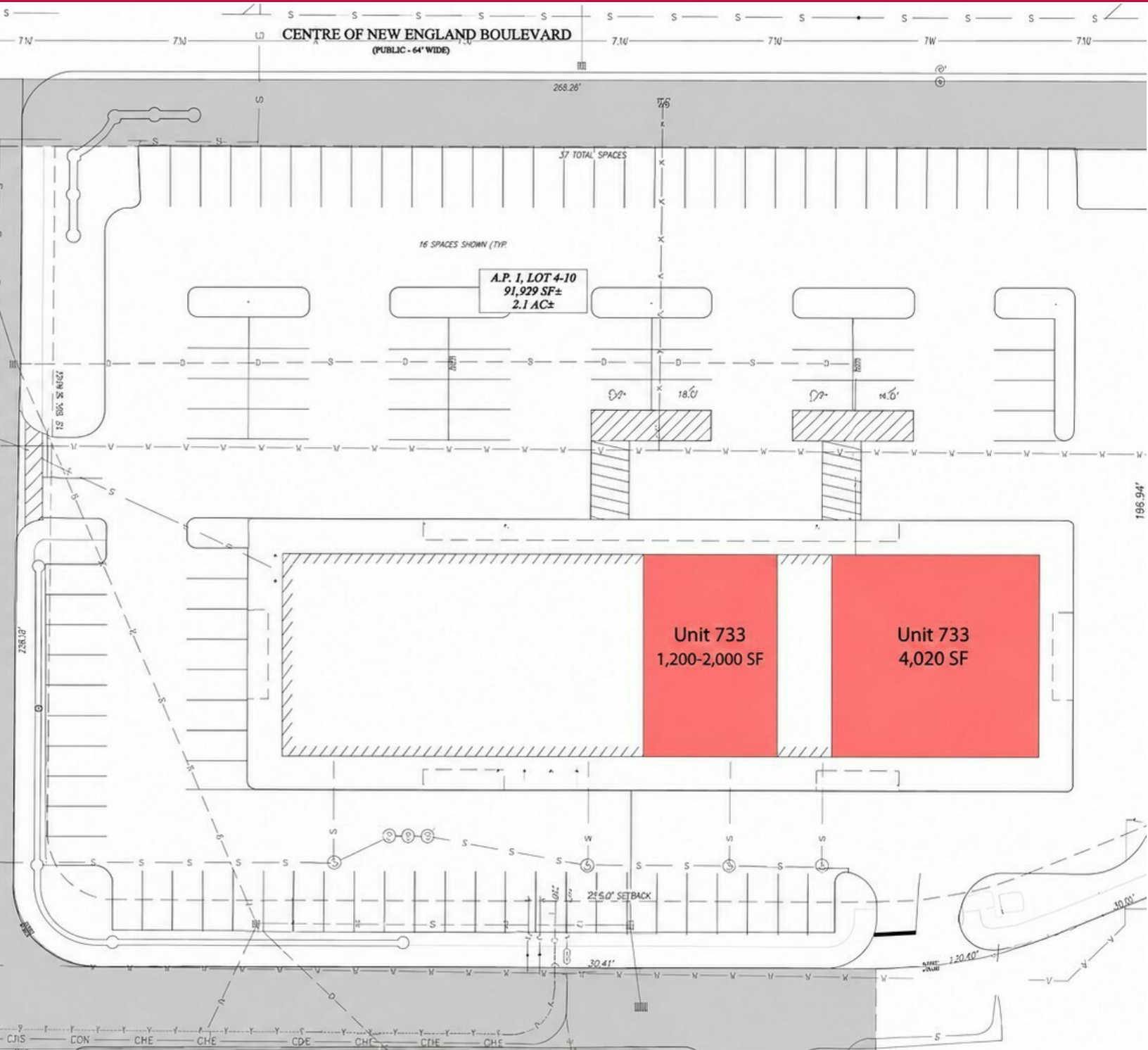

DAN FEINER
Vice President
401.751.3200 x3310
dan@mgcommercial.com

GEORGE PASKALIS, SIOR
Partner
401.751.3200 x3303
george@mgcommercial.com

365 Eddy Street, Penthouse Suite
Providence, RI 02903
mgcommercial.com



AREA MAP

RETAIL SUITES FOR LEASE



DAN FEINER
 Vice President
 401.751.3200 x3310
 dan@mgcommercial.com

GEORGE PASKALIS, SIOR
 Partner
 401.751.3200 x3303
 george@mgcommercial.com

365 Eddy Street, Penthouse Suite
 Providence, RI 02903
 mgcommercial.com

