

415 BANK ST, BRIDGETON, NJ 08302



## WAREHOUSE FACILITY

LOT AREA  
**17.1 Acres**

TOT. BUILDING AREA  
**310,000 SF**



**COURIER SYSTEMS INC.** ... *leaders in turnkey distribution systems*

Call us at 1-800-252-0353 x201 and ask for Rick Murad or e-mail us at [sales@csweb.biz](mailto:sales@csweb.biz)



ALL DIMENSIONS, AREA CALCULATIONS AND EXACT CONFIGURATIONS ARE APPROXIMATE. ACCURACY AND COMPLETENESS OF INFORMATION CONTAINED HEREIN IS NOT GUARANTEED.

**415 BANK ST, BRIDGETON, NJ 08302**

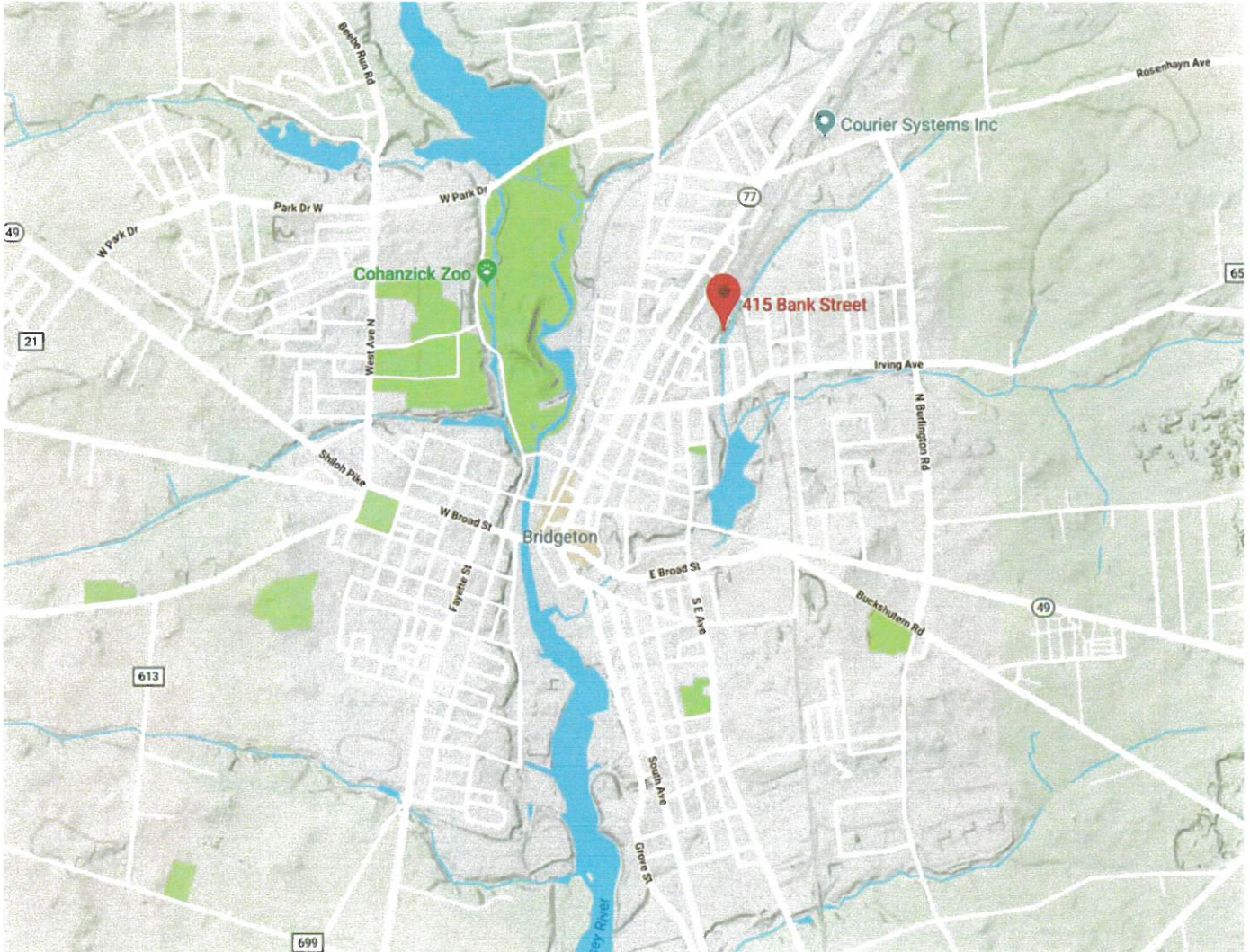

## LOCATION

**415 BANK ST  
BRIDGETON  
NJ 08302**



**COURIER SYSTEMS INC.** ... leaders in turnkey distribution systems

Call us at 1-800-252-0353 x201 and ask for Rick Murad or e-mail us at [sales@csweb.biz](mailto:sales@csweb.biz)



ALL DIMENSIONS, AREA CALCULATIONS AND EXACT CONFIGURATIONS ARE APPROXIMATE. ACCURACY AND COMPLETENESS OF INFORMATION CONTAINED HEREIN IS NOT GUARANTEED.

# 415 BANK ST, BRIDGETON, NJ 08302

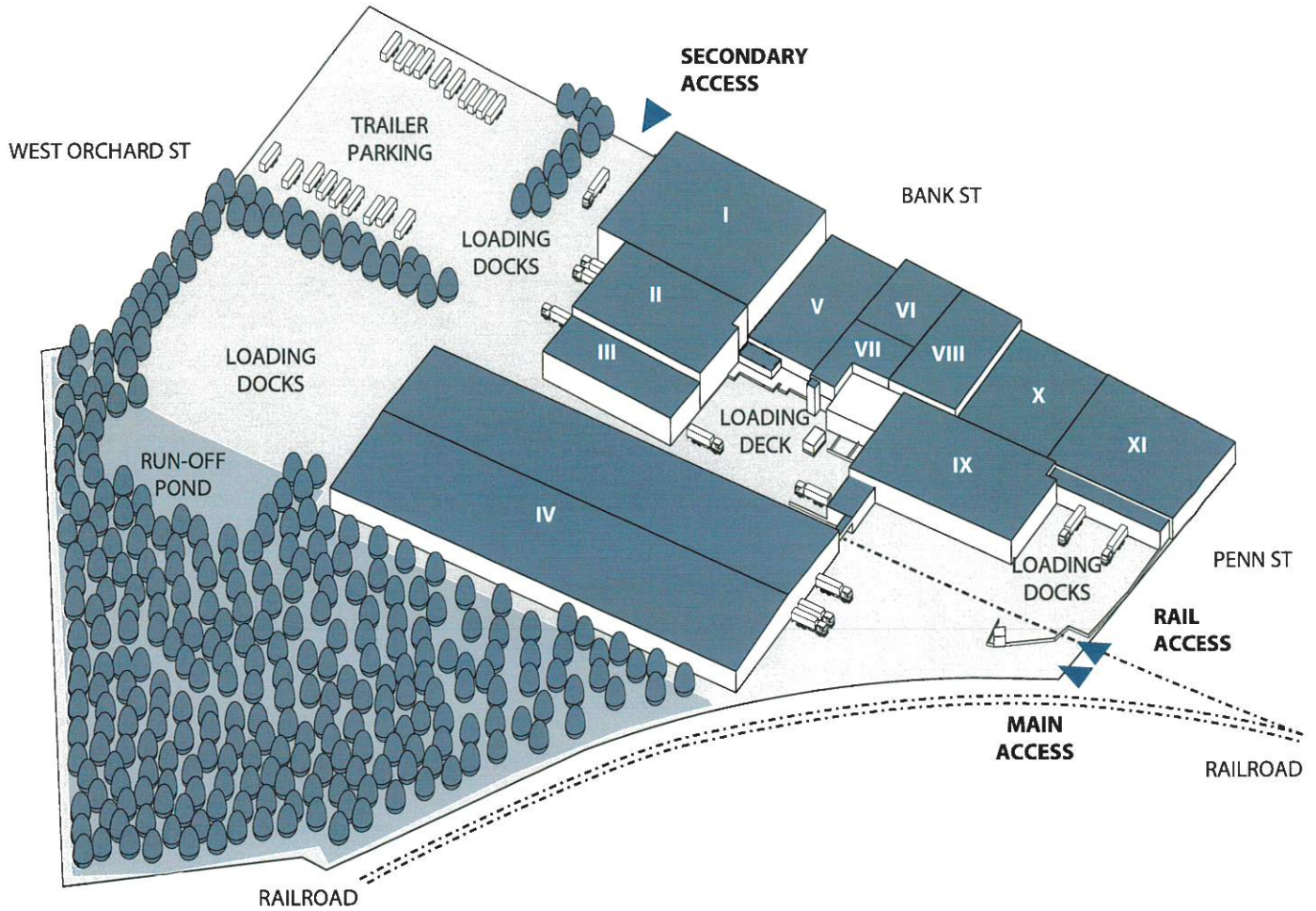

## BUILDING SUMMARY

BUILDING	GROSS AREA (SF)	STORIES
I	50,000 SF	2
II	45,000 SF	3
III	8,000 SF	1
IV	96,000 SF	1
V	13,500 SF	1
VI	16,000 SF	2

BUILDING	GROSS AREA (SF)	STORIES
VII	6,500 SF	1
VIII	17,000 SF	2
IX	25,000 SF	2
X	13,000 SF	1
XI	20,000 SF	1
<b>TOT</b>	<b>310,000 SF</b>	



**COURIER SYSTEMS INC.** ... leaders in turnkey distribution systems

Call us at 1-800-252-0353 x201 and ask for Rick Murad or e-mail us at [sales@csweb.biz](mailto:sales@csweb.biz)



# 415 BANK ST, BRIDGETON, NJ 08302

## BUILDING I & II

TOTAL FLOOR AREA	± 95,000 SF	
HEIGHT	<b>3 STORY</b>	<b>20 FT TYP.</b>

BUILDING I	Area	Height	
2nd FLOOR	± 25,000 SF	20 FT	***
1st FLOOR	± 25,000 SF	20 FT	***
TOTAL	± 50,000 SF		

\*\*\* REFRIGERATED or FREEZER AREA

BUILDING II	Area	Height
2nd FLOOR	± 15,000 SF	20 FT
1st FLOOR	± 15,000 SF	20 FT
BASEMENT	± 15,000 SF	12 FT
TOTAL	± 45,000 SF	

- 1 OFFICES / WC
- 2 STORAGE

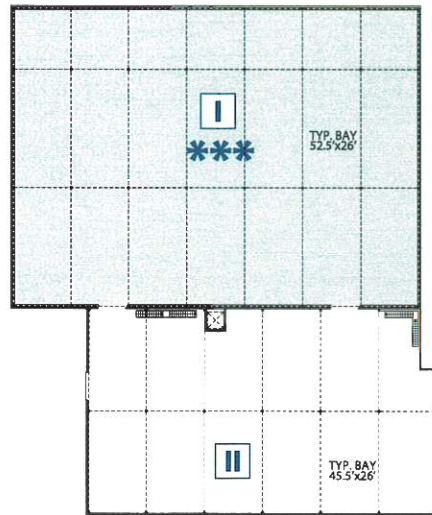

2ND FLOOR

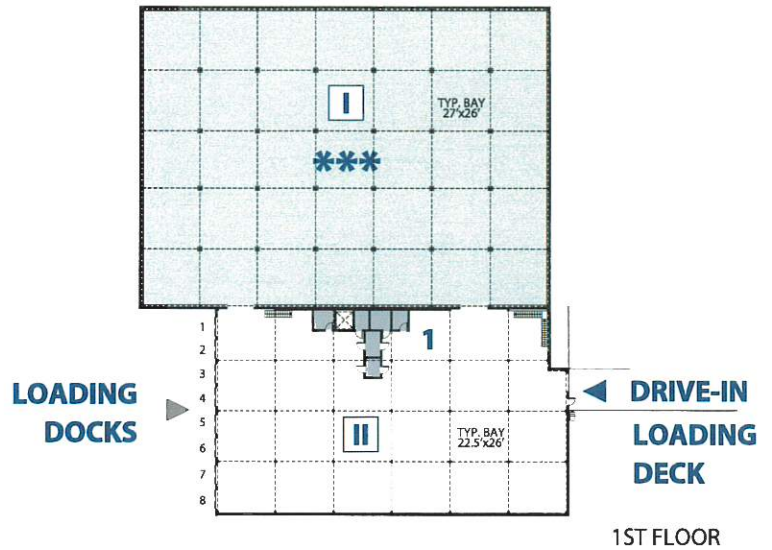

1ST FLOOR

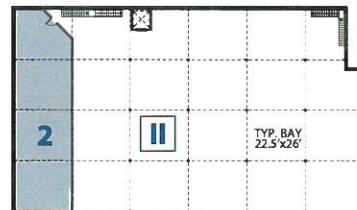
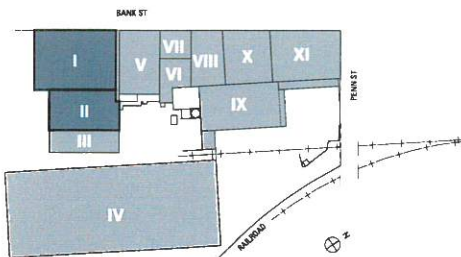

BASEMENT



**COURIER SYSTEMS INC.** ... leaders in turnkey distribution systems

Call us at 1-800-252-0353 x201 and ask for Rick Murad or e-mail us at [sales@csweb.biz](mailto:sales@csweb.biz)



# 415 BANK ST, BRIDGETON, NJ 08302

## BUILDING I & II

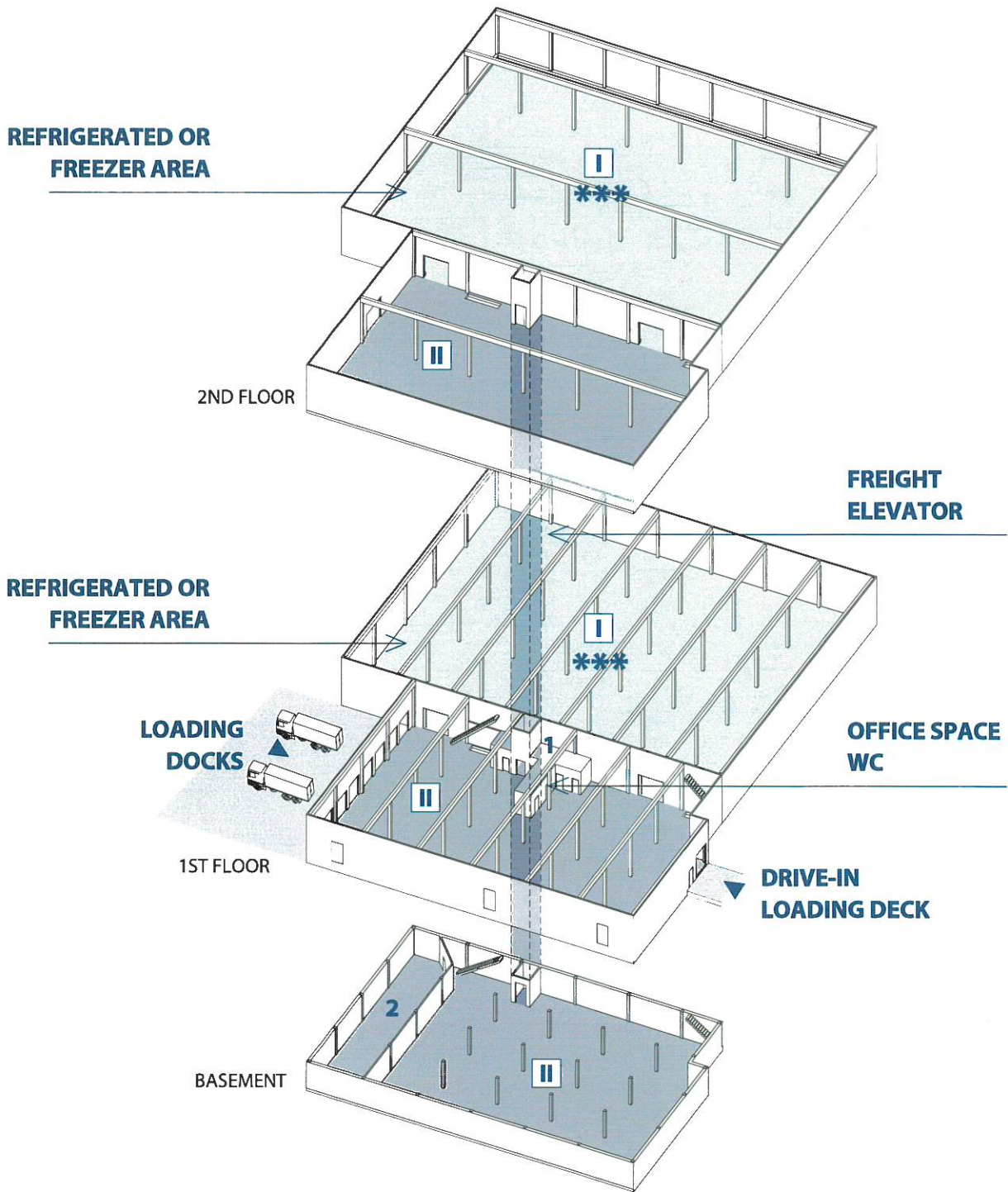

**COURIER SYSTEMS INC.** ... leaders in turnkey distribution systems

Call us at 1-800-252-0353 x201 and ask for Rick Murad or e-mail us at [sales@csweb.biz](mailto:sales@csweb.biz)



# 415 BANK ST, BRIDGETON, NJ 08302

## BUILDING III

FLOOR AREA		± 8,000 SF
HEIGHT	1 STORY	28.5 FT AVG.

- 1 OFFICE
- 2 LAVATORY

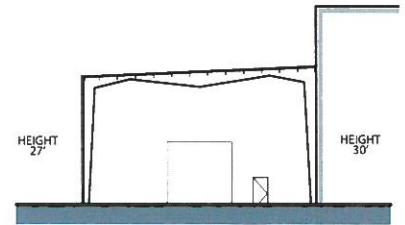

SECTION

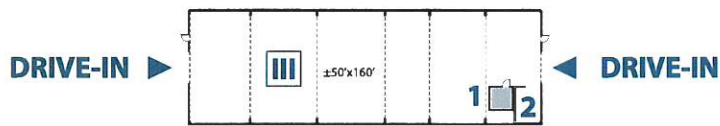

1ST FLOOR

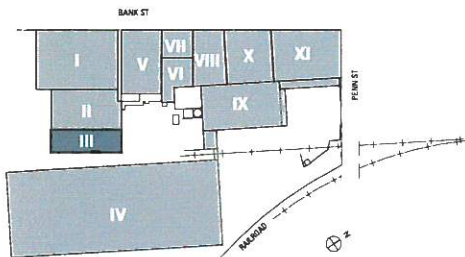
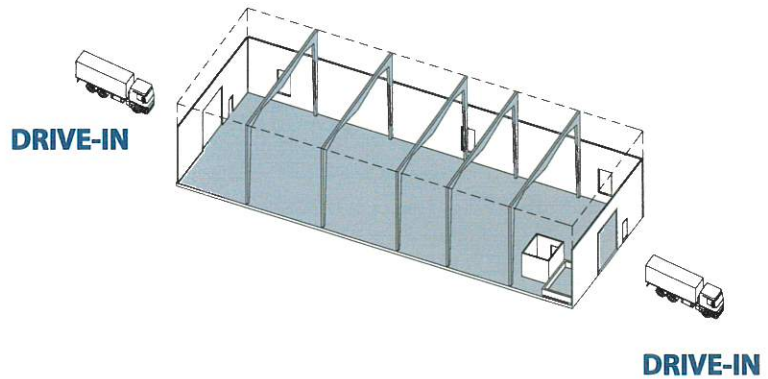

**COURIER SYSTEMS INC.** ... leaders in turnkey distribution systems

Call us at 1-800-252-0353 x201 and ask for Rick Murad or e-mail us at [sales@csweb.biz](mailto:sales@csweb.biz)



# 415 BANK ST, BRIDGETON, NJ 08302

## BUILDING IV

FLOOR AREA		± 96,000 SF
HEIGHT	1 STORY	±25 FT AVG.
1	OFFICES/WC	
2	OFFICE	

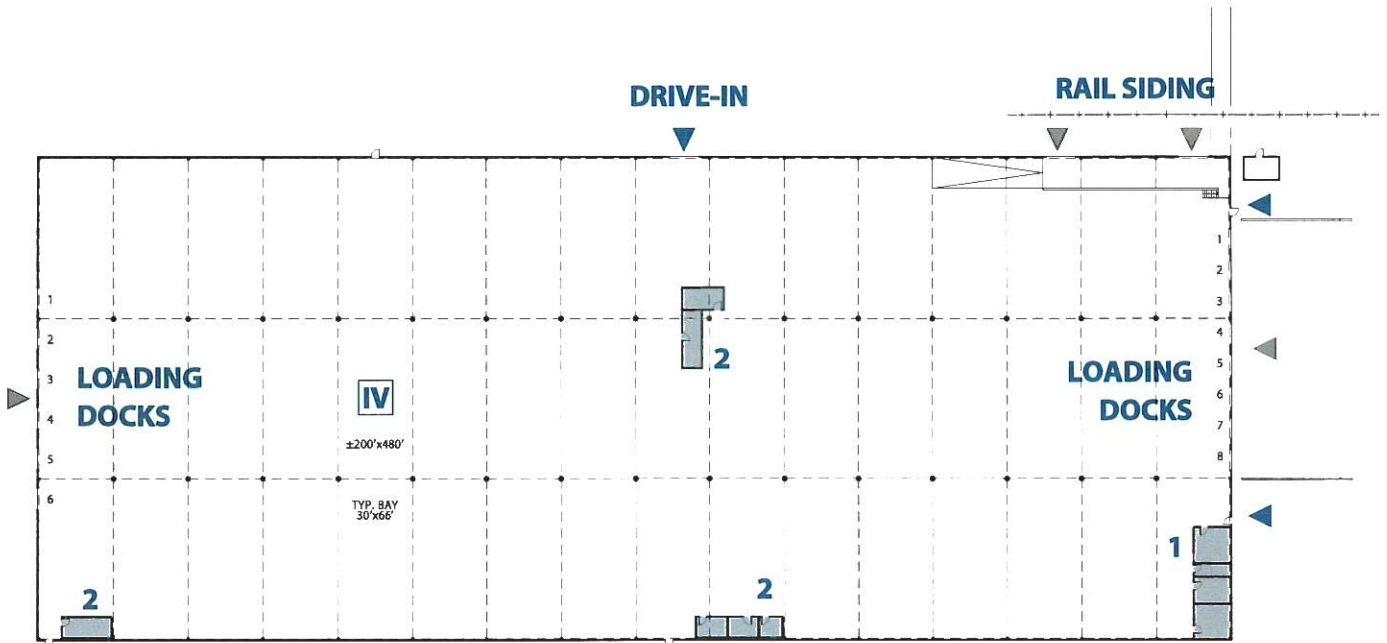

1ST FLOOR

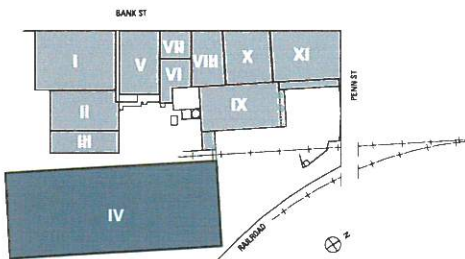

**COURIER SYSTEMS INC.** ... leaders in turnkey distribution systems

Call us at 1-800-252-0353 x201 and ask for Rick Murad or e-mail us at [sales@csweb.biz](mailto:sales@csweb.biz)



415 BANK ST, BRIDGETON, NJ 08302

BUILDING IV

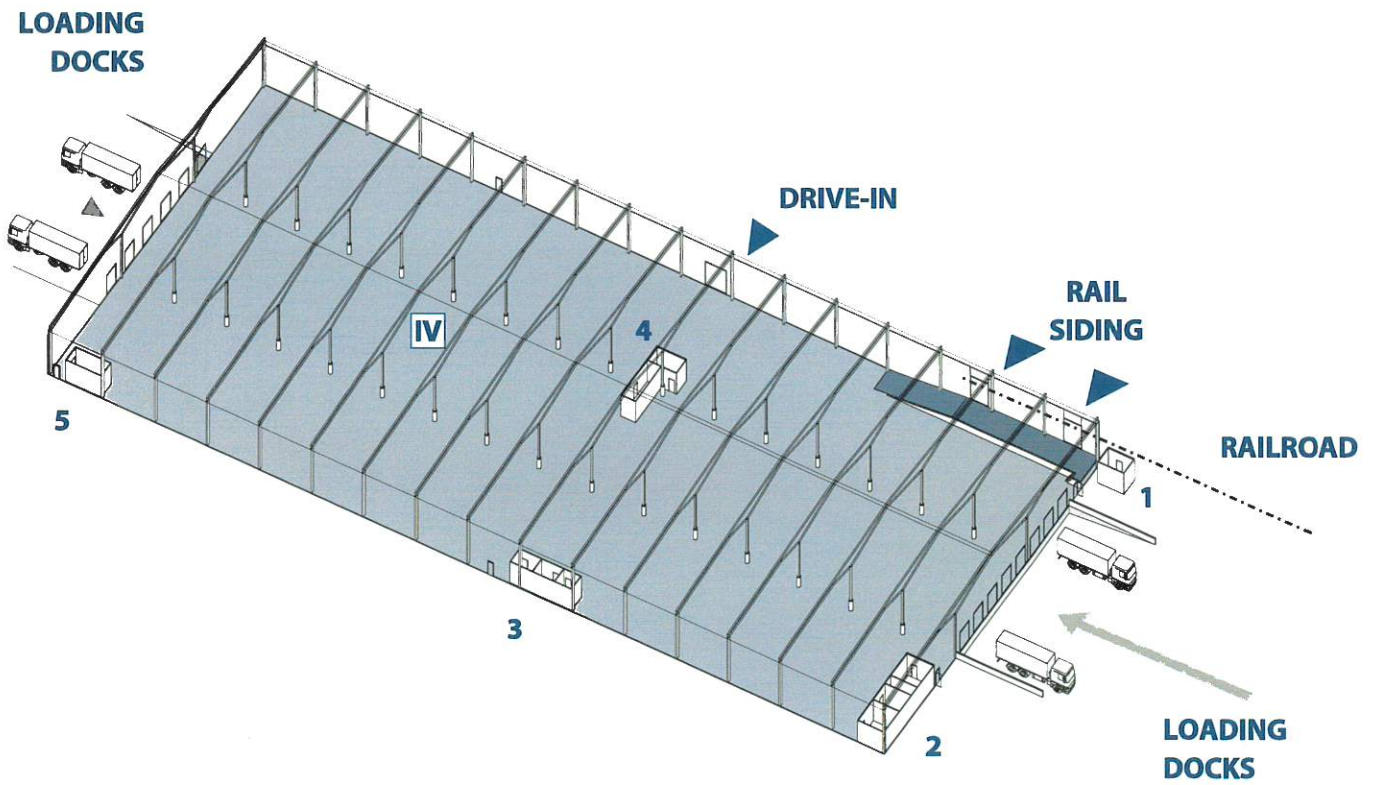

**COURIER SYSTEMS INC.** ... leaders in turnkey distribution systems

Call us at 1-800-252-0353 x201 and ask for Rick Murad or e-mail us at [sales@csweb.biz](mailto:sales@csweb.biz)



ALL DIMENSIONS, AREA CALCULATIONS AND EXACT CONFIGURATIONS ARE APPROXIMATE. ACCURACY AND COMPLETENESS OF INFORMATION CONTAINED HEREIN IS NOT GUARANTEED.

# 415 BANK ST, BRIDGETON, NJ 08302

## BUILDING V

FLOOR AREA	± 13,500 SF	
HEIGHT	1 STORY	16 FT
** REFRIGERATED AREA		

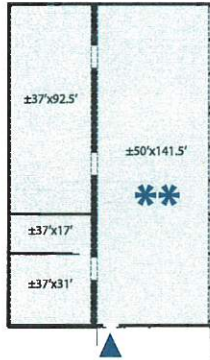

1ST FLOOR

**DRIVE-IN  
LOADING  
DECK**

**REFRIGERATED  
AREA**

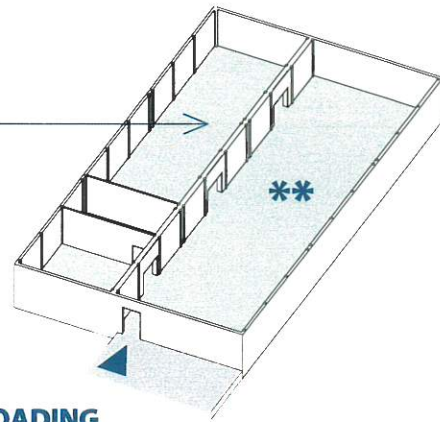

**LOADING  
DECK**

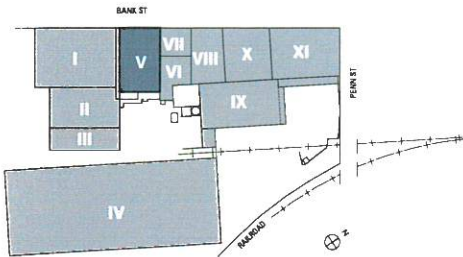

**COURIER SYSTEMS INC.** ... leaders in turnkey distribution systems

Call us at 1-800-252-0353 x201 and ask for Rick Murad or e-mail us at [sales@csweb.biz](mailto:sales@csweb.biz)



# 415 BANK ST, BRIDGETON, NJ 08302

## BUILDING VI, VI, VIII, IX

FLOOR AREA	± 65,500 SF
HEIGHT	2 STORY

- 1 OFFICES
- 2 STORAGE
- 3 WC

BUILDING VI	Area	Height
1st FLOOR	± 5,000 SF	17 FT
2nd FLOOR	± 11,000 SF	14 FT **
** REFRIGERATED AREA		

BUILDING VII	Area	Height
1st FLOOR	± 6,500 SF	17 FT **
** REFRIGERATED AREA		

BUILDING VIII	Area	Height
1st FLOOR	± 10,000 SF	15 FT
2nd Floor	± 8,000 SF	20 FT

BUILDING IX	Area	Height
1st FLOOR	± 21,000 SF	26 FT (TOT)
Mezzanine	± 4,000 SF	11 FT

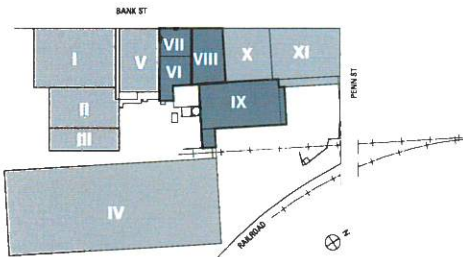
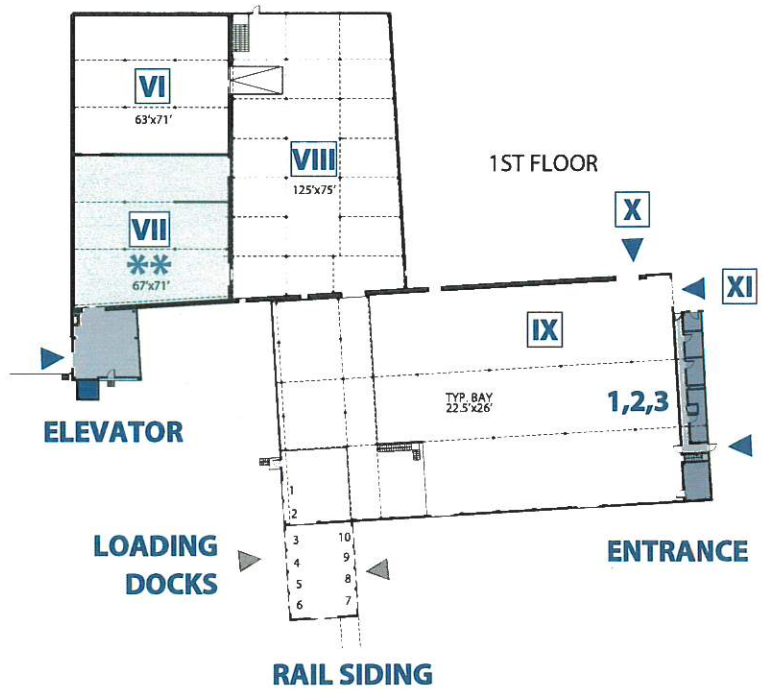
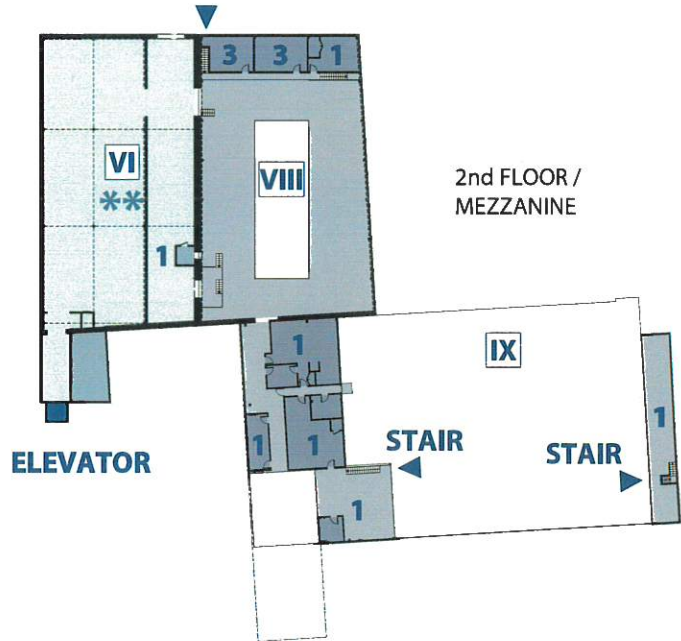

**COURIER SYSTEMS INC.** ... leaders in turnkey distribution systems

Call us at 1-800-252-0353 x201 and ask for Rick Murad or e-mail us at [sales@csweb.biz](mailto:sales@csweb.biz)



415 BANK ST, BRIDGETON, NJ 08302

BUILDING VI, VI, VIII, IX

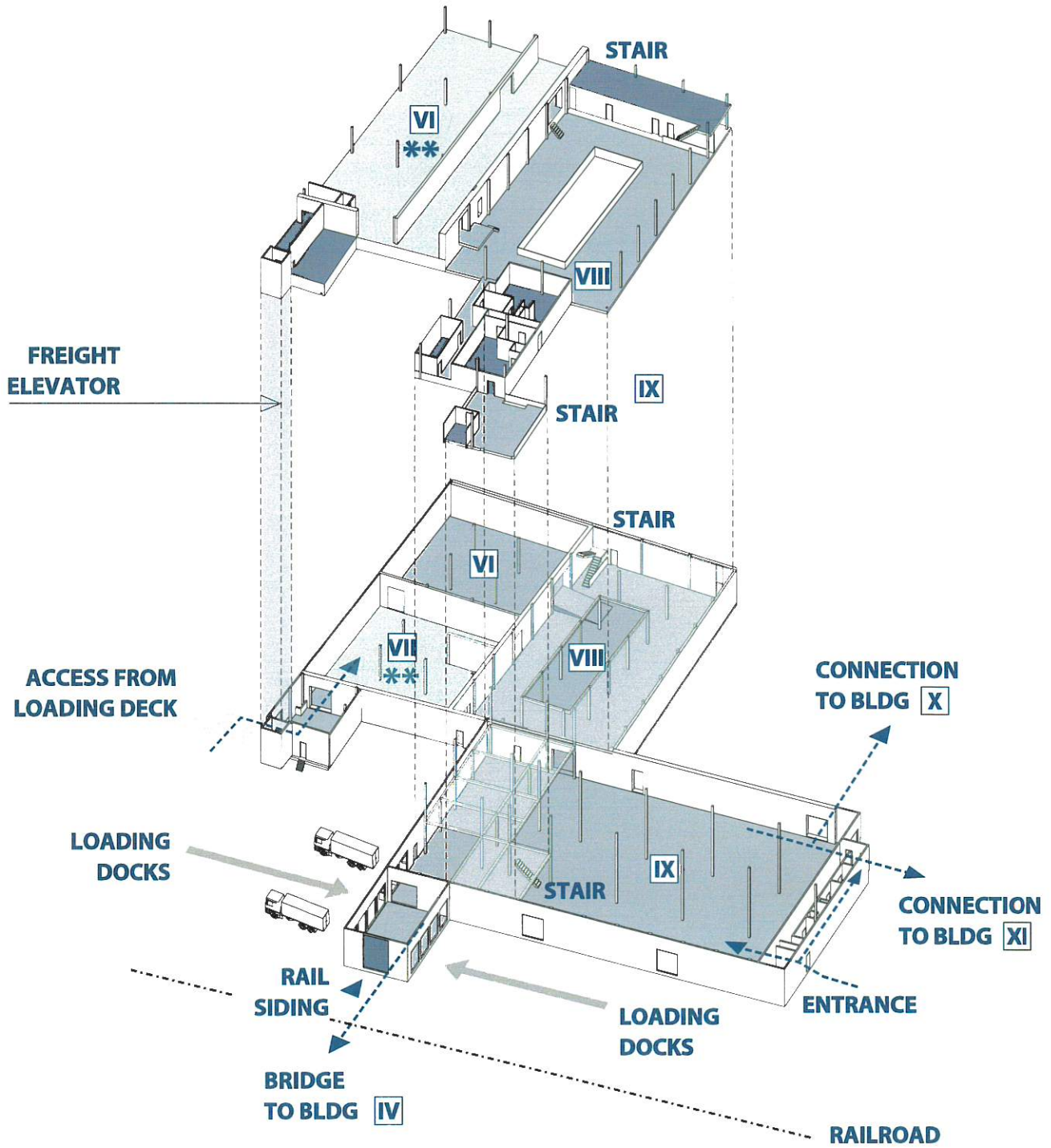

**COURIER SYSTEMS INC.** ... leaders in turnkey distribution systems

Call us at 1-800-252-0353 x201 and ask for Rick Murad or e-mail us at [sales@csweb.biz](mailto:sales@csweb.biz)



# 415 BANK ST, BRIDGETON, NJ 08302

## BUILDING X, XI

FLOOR AREA	± 33,000 SF
HEIGHT	1 STORY ±19 FT AVG.

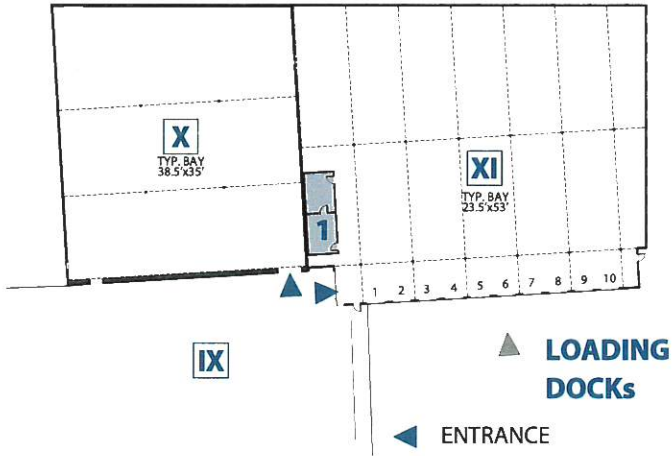

BUILDING X	Area	Height
1st FLOOR	± 13,000 SF	18 FT

BUILDING XI	Area	Height
1st FLOOR	± 20,000 SF	20 FT

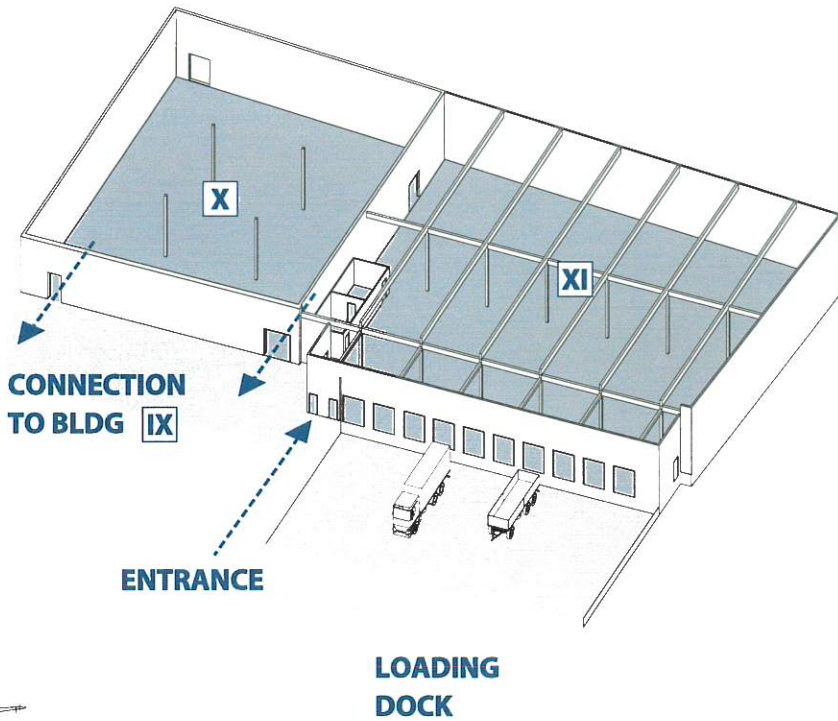

**COURIER SYSTEMS INC.** ... leaders in turnkey distribution systems

Call us at 1-800-252-0353 x201 and ask for Rick Murad or e-mail us at [sales@csweb.biz](mailto:sales@csweb.biz)

