

FOR LEASE

# 600± SF OFFICE SUITE

Powell Place | 3800 W. 12th Street, Suite 9 | Erie, PA 16505



**OFFERED AT:**  
\$23.00/SF/YR  
(FULL SERVICE)

## PROPERTY HIGHLIGHTS

- 600± SF Modern 3-Room Office
- Available September 2026
- Recently Renovated With Gray-Toned Commercial Carpet, Light Gray Paint & New Drop Ceiling
- Open Main Area (Approximately 13'10" x 22'10")
- Front Office (Approximately 12' x 12')
- Back Office with Window (Approximately 12' x 15'7")
- Floor Plan & 3D Tour Available
- Abundant Free Parking & Excellent Visibility
- Along A High Traffic Corridor With 14,000 Average Daily Traffic (PennDOT AADT 2024 Count Year)
- Centrally Located, Near I-79 & I-90, And On Bus Route
- Zoned MU-2, Corridor Mixed Use (Millcreek Township)
- Offered at \$23.00/SF/YR - All Included (\$1,150/Month)  
Tenant Pays for Desired Phone/Internet/Cable
- Join Brandon J. Broderick Attorney At Law, Edward Jones, Erie Pharmacy, Forest Counseling, Fortitude Counseling, Investment Center Of Erie, Thrivent & More At Powell Place!



©2026 SBRE - Sherry Bauer Real Estate. The information above has been obtained from sources believed reliable. While we do not doubt its accuracy, we have not verified it and make no guarantee, warranty or representation about it. It is your responsibility to independently confirm its accuracy and completeness.

## FOR MORE INFORMATION PLEASE CONTACT

**Sherry Bauer**  
Broker

O. 814.453.2000 x101 \ C. 814.460.2000  
sbauer@sherrybauerrealestate.com

**Amanda Bogert**  
V.P. of Sales & Marketing

O. 814.453.2000 x102 \ C. 814.790.8342  
abogert@sherrybauerrealestate.com

# SBRE

# 600± SF OFFICE SUITE

**For Lease** | Powell Place | 3800 W. 12th Street, Suite 9 | Erie, PA 16505

360° VIRTUAL TOUR

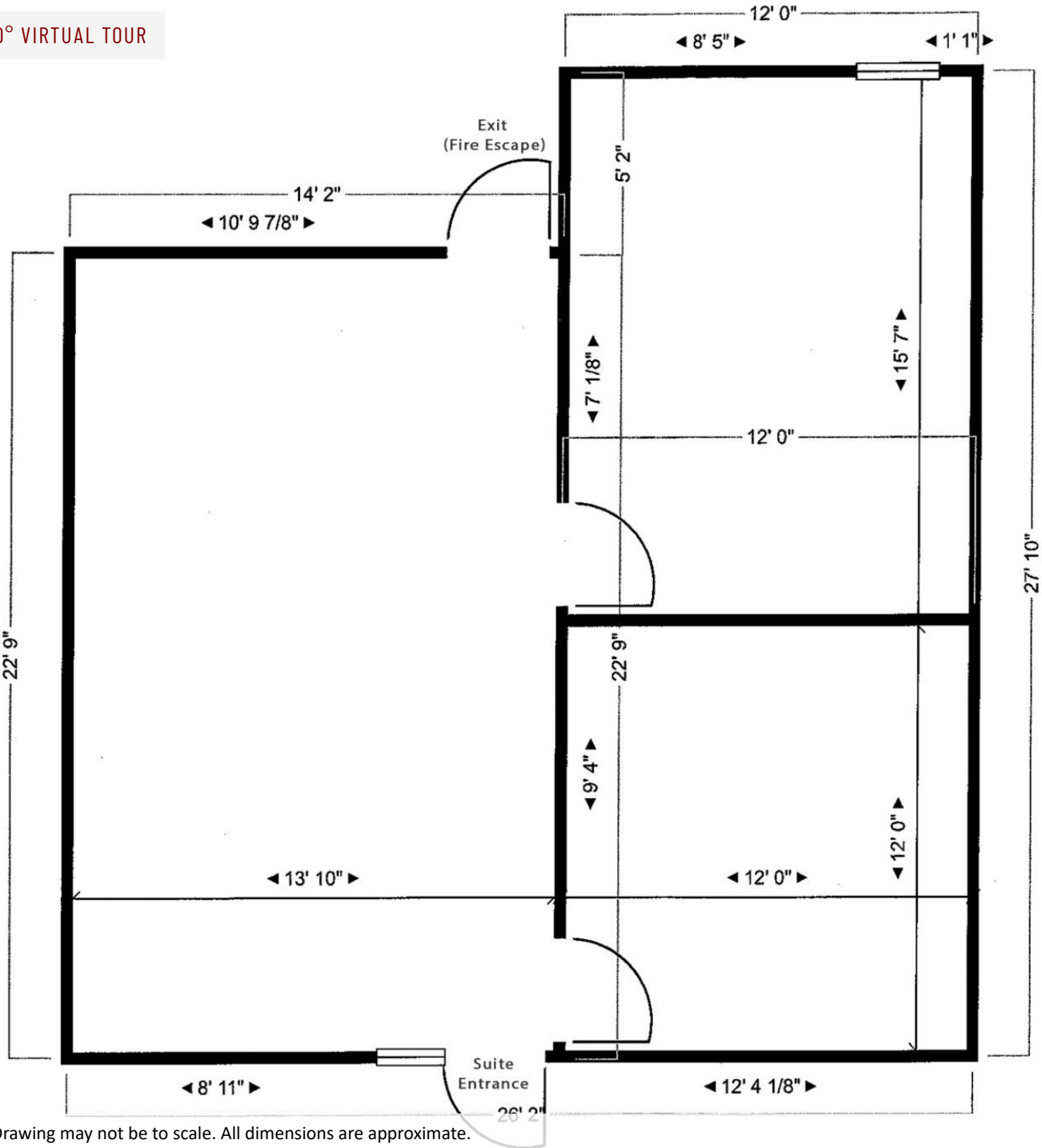

NOTE: Drawing may not be to scale. All dimensions are approximate.

©2023 Sherry Bauer Real Estate. The information above has been obtained from sources believed reliable. While we do not doubt its accuracy, we have not verified it and make no guarantee, warranty or representation about it. It is your responsibility to independently confirm its accuracy and completeness.

### FOR MORE INFORMATION PLEASE CONTACT

**Sherry Bauer**  
Broker

O. 814.453.2000 x101 \ C. 814.460.2000  
sbauer@sherrybauerrealestate.com

**Amanda Bogert**

V.P. of Sales & Marketing

O. 814.453.2000 x102 \ C. 814.790.8342  
abogert@sherrybauerrealestate.com

1315 Peninsula Drive, Suite 2, Erie, PA 16505

P. 814.453.2000

F. 814.453.2001

www.sherrybauerrealestate.com