

# CHURCHILL OFFICE/RETAIL SPACE FOR LEASE

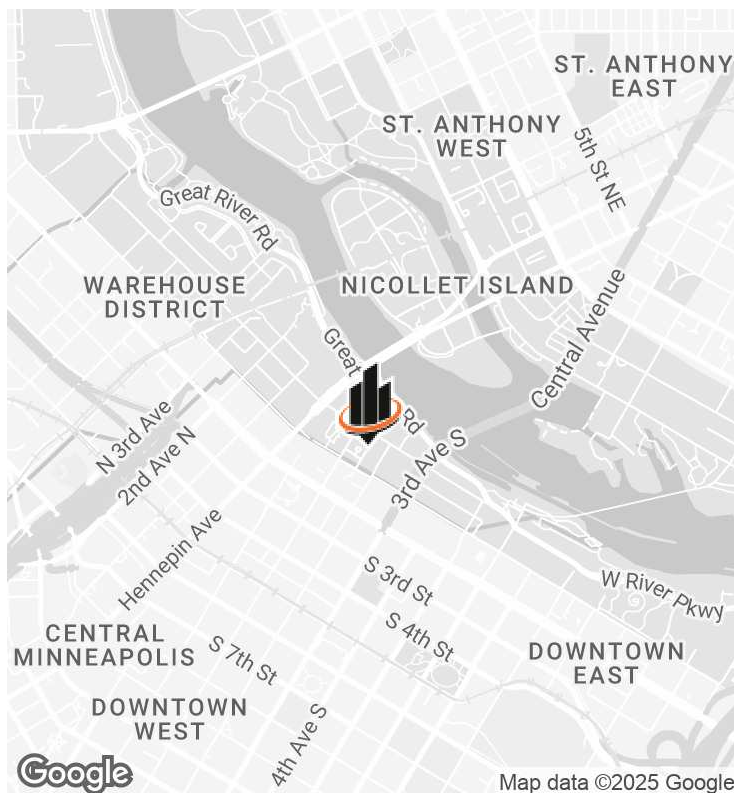

## OFFERING SUMMARY

<b>LEASE RATE:</b>	\$925.00 per month (Gross)
<b>AVAILABLE SF:</b>	450 SF
<b>AVAILABLE DATE:</b>	5/1/2025

## PROPERTY OVERVIEW

The Churchill is conveniently located in Downtown Minneapolis' Mill District and is connected to the Minneapolis Skyway System. It is less than one mile away from US Bank Stadium and just blocks away from the trending North Loop neighborhood. Five retail/office spaces - 1) Bottle House Wine & Spirits [LEASED], 2) The Downtown Market [LEASED], 3) Art of Barbering [LEASED], 4) BK Law [LEASED], and 5) a 450 SF Retail/Office [AVAILABLE].

## PROPERTY HIGHLIGHTS

- Lease includes Utilities
- Available on 5/1/2025
- High Traffic from Apartments and Skyway System
- Connected to The Churchill Apartments [360 units, 98% Occupied]
- Rivergate apartments nearby [270 units, 99% Occupied]
- Hard corner of 2nd St & 2nd Ave - providing great visibility
- Connected to Minneapolis skyway system

### CHRIS KUBESH

O: 952.820.1668

chris.kubesh@svn.com

SPACE PHOTOS

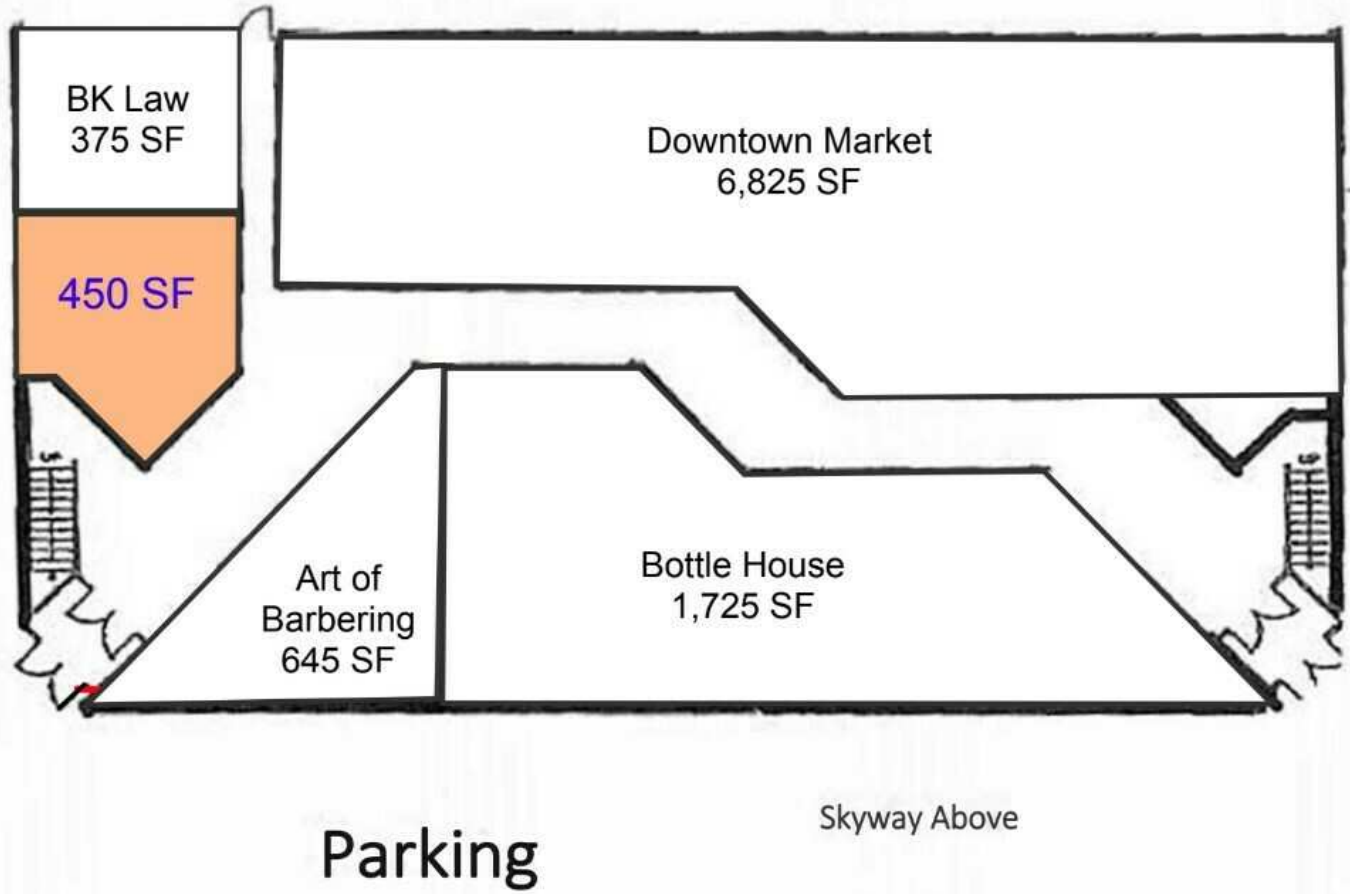

**CHRIS KUBESH**

O: 952.820.1668

chris.kubesh@svn.com

# MPLS SKYWAY MAP - CONNECTED

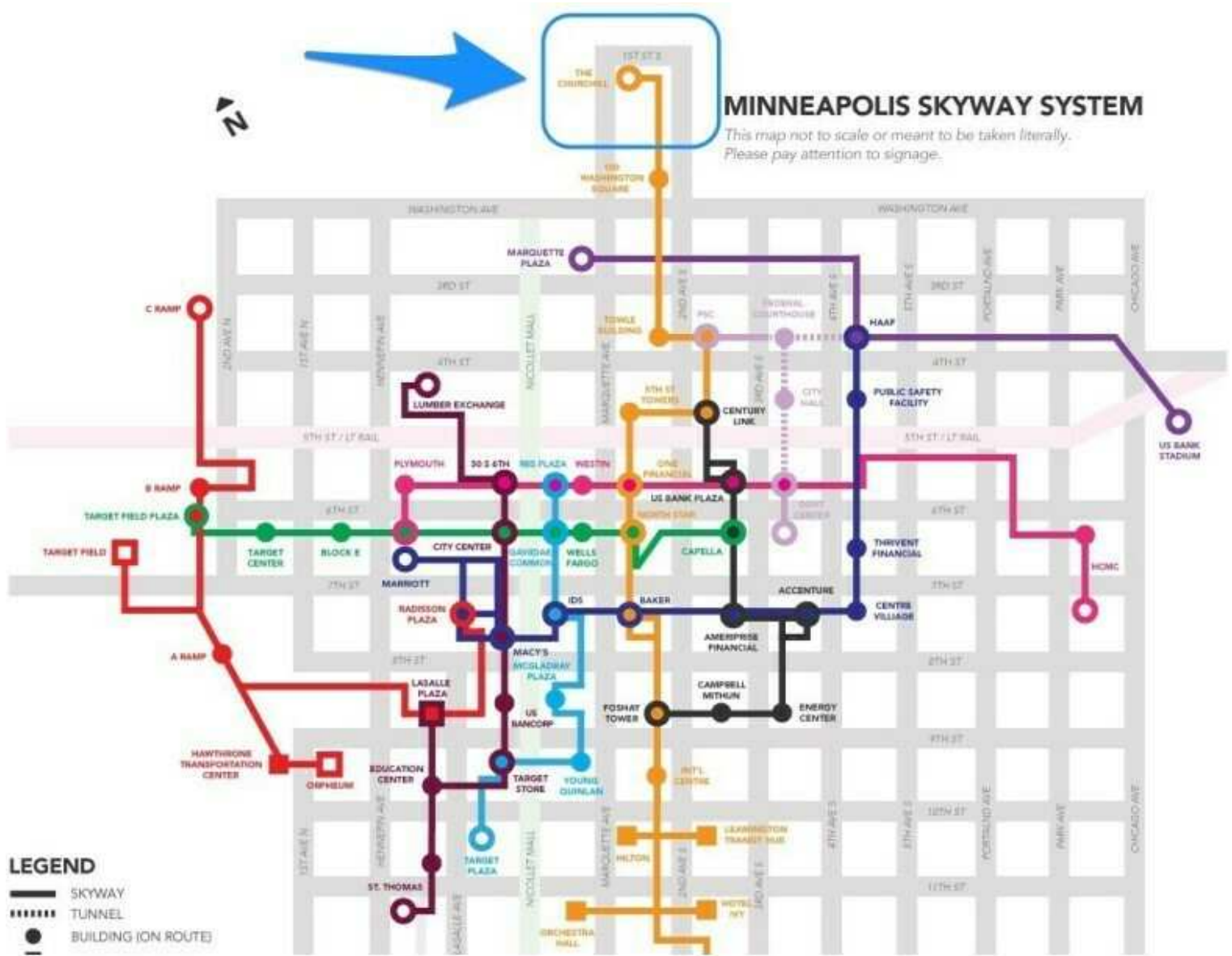

**CHRIS KUBESH**  
 O: 952.820.1668  
 chris.kubesh@svn.com