

## INTERIOR SPACE PLAN

PID: 121

SFID: 0015e00000jBPoFAAW|

Client: Boost Mobile

Project: Next Gen 4.0

Door Type: 4.0 Relo

Title: Interior

Site Address: 200 South Westwood Boulevard, Poplar Bluff, Missouri 63901

Project Manager: Wilfredo Ortiz

Sq Ft / M: 844 SQ FT / 78.4 SQ M\_APPROX FOH

Drawn by: CD-Q

Date: 12th Septmber 2022

Revision: Rev B - 4th October 2022

\_\_\_\_\_  
Signature of (Owner/Lessor/Mortgage or security Interest holder)

\_\_\_\_\_  
Print Name

\_\_\_\_\_  
Date





FIXTURE PLAN

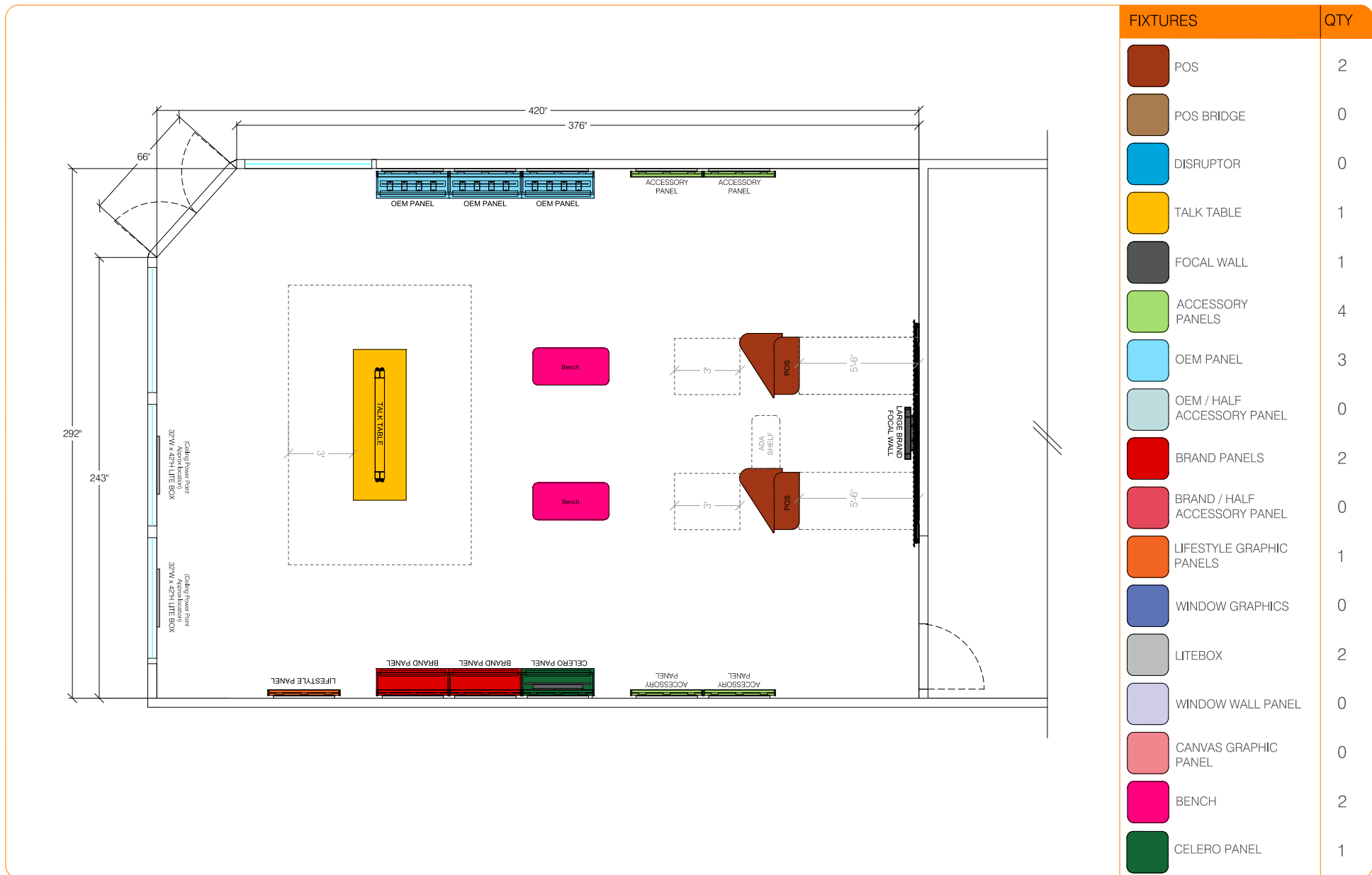

Information provided is for sample purposes only and doesn't reflect actual conditions or cover the entire scope.



COPYRIGHT © The details shown on this drawing are confidential and are the exclusive property of Principle Group of companies. No use, copy or disclosure of this disclosure of this drawing may be made without written permission and it is to be returned to Principle Group of Companies upon request.

2035 Lakeside Centre Way #250,  
Knoxville, Tennessee, TN 37922  
T +1 865 692 4058 F +1 865 692 4104

Revision notes



Client:	Boost Mobile	Principle ID:	121
Project:	Next Gen 4.0	Checked by:	
Title:	Interior Space Plan	Scale:	NTS
Drawn by:	CD-Q	Revision:	B
Date:	4th October 2022	Page:	3

SPACE PLAN

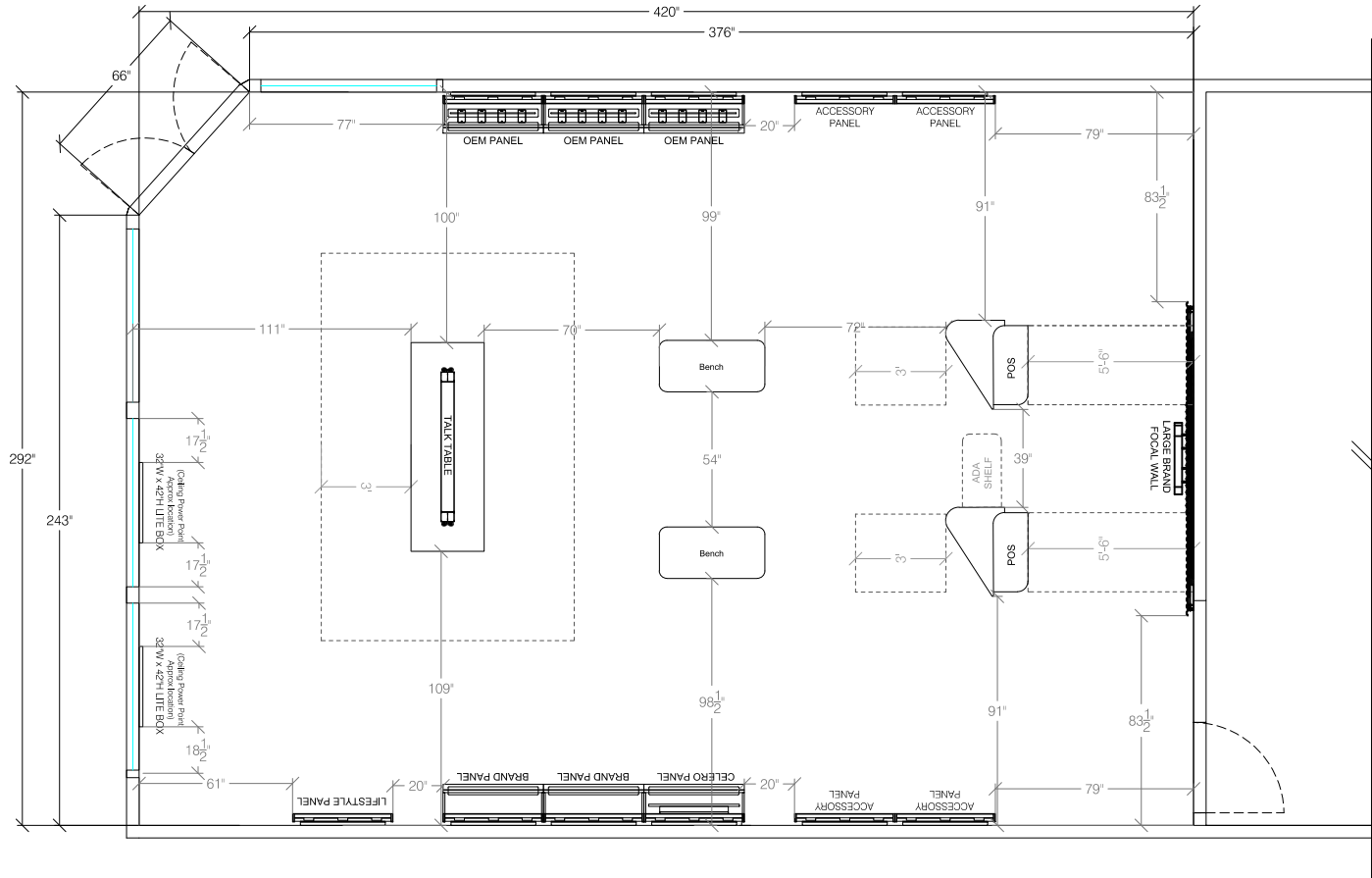

ALL ITEMS ON THE STORE CEILING TO BE REMOVED WITH THE EXCEPTION OF LIGHTING FLUSH WITH CEILING TILES, CEILING TILES, BEAMS (UNLESS DIRECTED BY PM TO REMOVE) AND FIRE SPRINKLERS.

OVERALL SQ FT/M: 844 SQ FT / 78.4 SQ M\_APPROX FOH

Information provided is for sample purposes only and doesn't reflect actual conditions or cover the entire scope.



COPYRIGHT © The details shown on this drawing are confidential and are the exclusive property of Principle Group of companies. No use, copy or disclosure of this disclosure of this drawing may be made without written permission and it is to be returned to Principle Group of Companies upon request.

2035 Lakeside Centre Way #250,  
Knoxville, Tennessee, TN 37922  
T +1 865 692 4058 F +1 865 692 4104

Revision notes



Client:	Boost Mobile	Principle ID:	121
Project:	Next Gen 4.0	Checked by:	
Title:	Interior Space Plan	Scale:	NTS
Drawn by:	CD-Q	Revision:	B
Date:	4th October 2022	Page:	4

BUILD OUT DETAILS

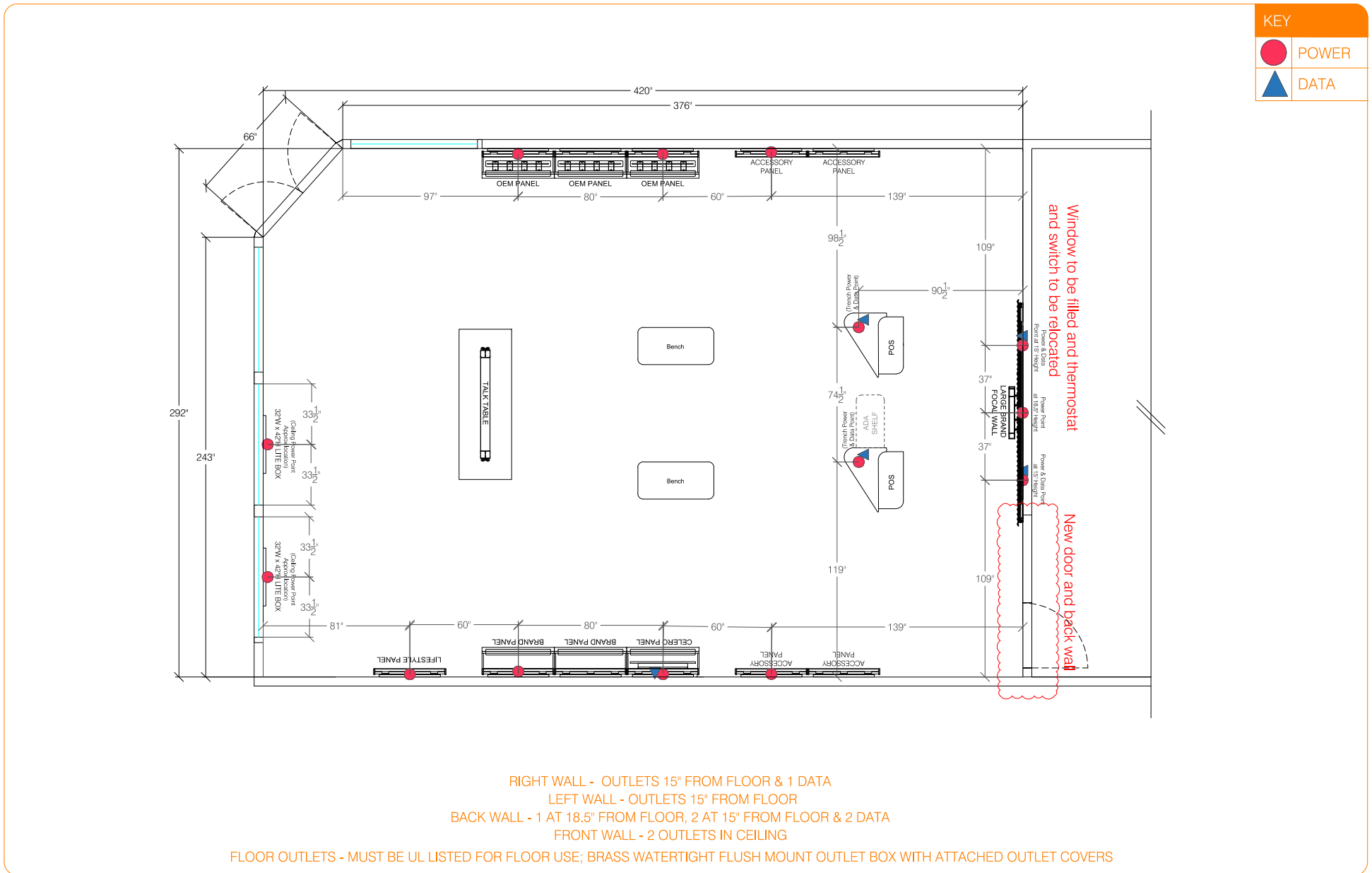

Information provided is for sample purposes only and doesn't reflect actual conditions or cover the entire scope.

2035 Lakeside Centre Way #250,  
 Knoxville, Tennessee, TN 37922  
 T +1 865 692 4058 F +1 865 692 4104

Revision notes

	Client: Boost Mobile	Principle ID: 121
	Project: Next Gen 4.0	Checked by:
	Title: Build out Details	Scale: NTS
	Drawn by: CD-Q	Revision: B
	Date: 4th October 2022	Page: 5

## ELEVATIONS

RIGHT WALL ELEVATION

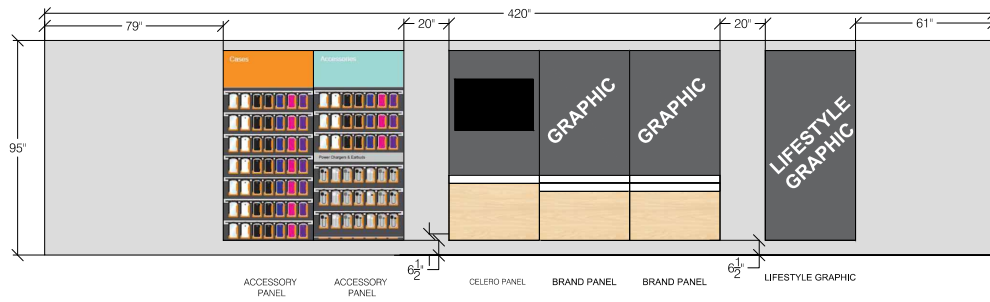

BACK WALL

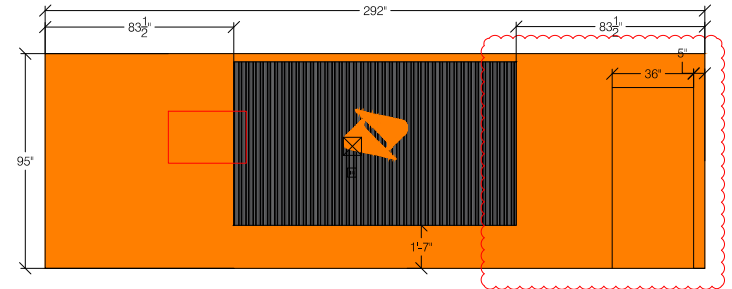

Window to be filled and thermostat and switch to be relocated

New door and back wall

LEFT WALL ELEVATION

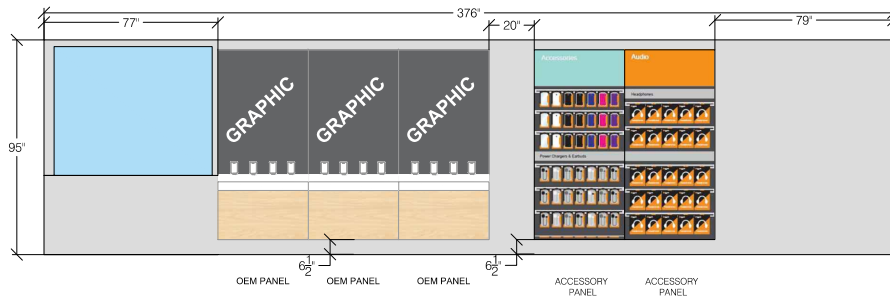

FRONT ELEVATION

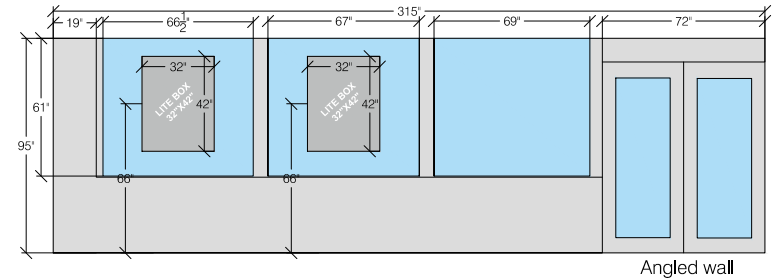

Angled wall

NOTE: Final graphics to be confirmed

### ARCHITECTURAL FINISHES



NAME: BOOST ORANGE  
MANUFACTURER: SHERWIN-WILLIAMS  
FINISH: EGGSHELL

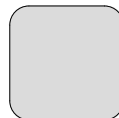

NAME: BOOST GREY w/ CRUSHED WALNUTS  
MANUFACTURER: SHERWIN-WILLIAMS  
FINISH: FLAT



NAME: BOOST BLACK  
MANUFACTURER: SHERWIN-WILLIAMS  
FINISH: EGGSHELL

SHERWIN WILLIAMS ACCOUNT NUMBER: 5530-0478-9

Information provided is for sample purposes only and doesn't reflect actual conditions or cover the entire scope.



COPYRIGHT © The details shown on this drawing are confidential and are the exclusive property of Principle Group of companies. No use, copy or disclosure of this disclosure of this drawing may be made without written permission and it is to be returned to Principle Group of Companies upon request.

2035 Lakeside Centre Way #250,  
Knoxville, Tennessee, TN 37922  
T +1 865 692 4058 F +1 865 692 4104

#### Revision notes



Client:	Boost Mobile	Principle ID:	121
Project:	Next Gen 4.0	Checked by:	
Title:	Elevations	Scale:	NTS
Drawn by:	CD-Q	Revision:	B
Date:	4th October 2022	Page:	6

WINDOW GRAPHICS

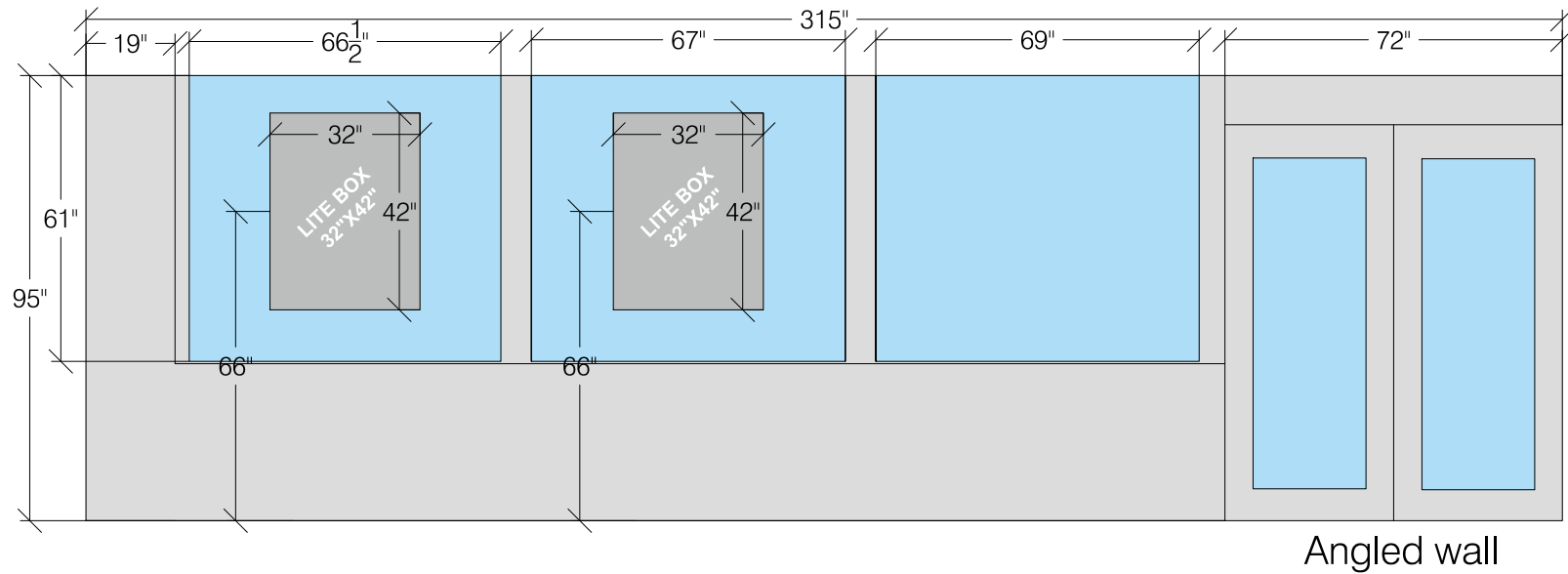

Any existing neon lighting, rope lighting and/or other branded signage MUST BE REMOVED prior to Next Gen 4.0 installation

Information provided is for sample purposes only and doesn't reflect actual conditions or cover the entire scope.



COPYRIGHT © The details shown on this drawing are confidential and are the exclusive property of Principle Group of companies. No use, copy or disclosure of this disclosure of this drawing may be made without written permission and it is to be returned to Principle Group of Companies upon request.

2035 Lakeside Centre Way #250,  
Knoxville, Tennessee, TN 37922  
T +1 865 692 4058 F +1 865 692 4104

Revision notes



Client:	Boost Mobile	Principle ID:	121
Project:	Next Gen 4.0	Checked by:	
Title:	Window Graphics	Scale:	NTS
Drawn by:	CD-Q	Revision:	B
Date:	4th October 2022	Page:	7

PHOTOGRAPHS



Information provided is for sample purposes only and doesn't reflect actual conditions or cover the entire scope.



 COPYRIGHT © The details shown on this drawing are confidential and are the exclusive property of Principle Group of companies. No use, copy or disclosure of this disclosure of this drawing may be made without written permission and it is to be returned to Principle Group of Companies upon request.

2035 Lakeside Centre Way #250,  
 Knoxville, Tennessee, TN 37922  
 T +1 865 692 4058 F +1 865 692 4104

Revision notes



Client:	Boost Mobile	Principle ID:	121
Project:	Next Gen 4.0	Checked by:	
Title:	Photographs	Scale:	NTS
Drawn by:	CD-Q	Revision:	B
Date:	4th October 2022	Page:	8