



For sale

±105 Acres off Shipyard Rd. Chesapeake, VA

Land Opportunity

Colliers International is pleased to present a residential development opportunity consisting of 105 acres of land in the rapidly growing city of Chesapeake, VA.

Asking Price:

\$4,500,000

Contact:

Patrick Gill, CCIM

Senior Vice President

+1 757 228 1832

patrick.gill@colliers.com

150 West Main St | Suite 1100

Norfolk, VA 23510

P: +1 757 490 3300

F: +1 757 490 1200

colliers.com

Colliers

Property Details

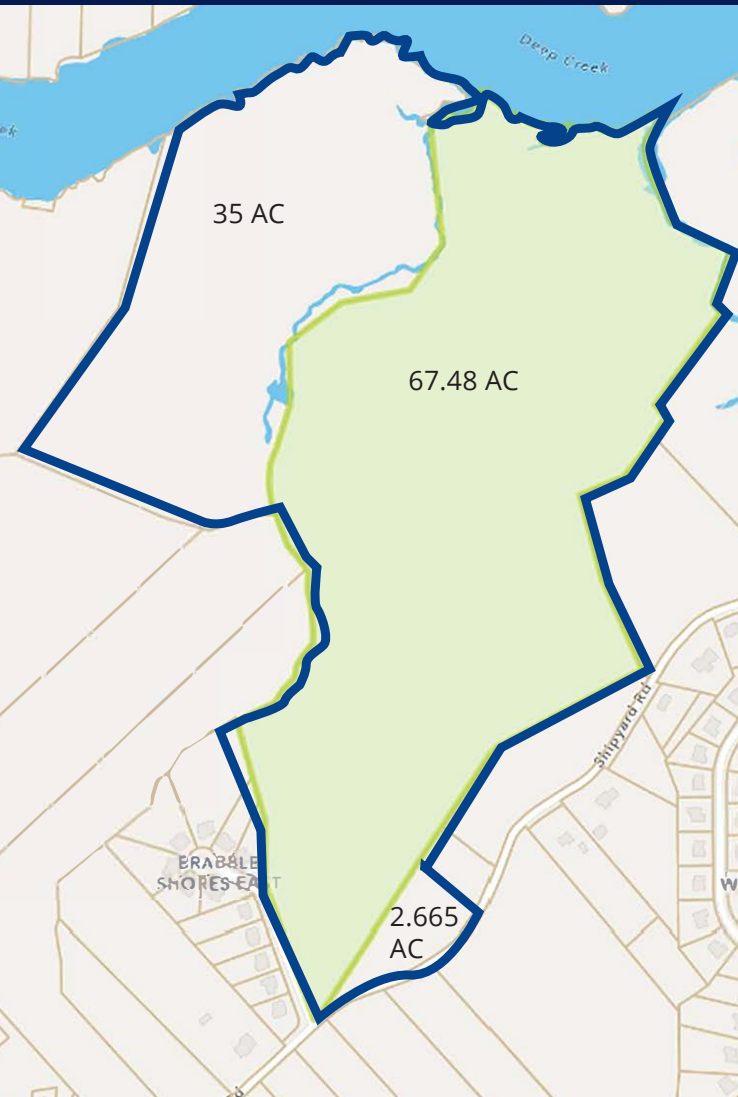

Summary

These three parcels are strategically positioned in the desirable Grassfield area of Chesapeake with frontage on Shipyard Rd.

The Chesapeake 2045 Comprehensive Plan designates the use as low-scale residential character district. A single-family development with a rezoning to R-8 (8,000 SF lots) would likely be supported by city staff and elected officials.

Shopping, boating, golfing, historical attractions, and a highly sought-after schools are all only a few minutes away. Greenbrier, downtown Norfolk, the Virginia Beach oceanfront, and Virginia Beach Town Center are all within a quick 30-minute drive.

Features

Address: 1972 Shipyard Rd., Chesapeake, VA

Parcel	Size	Zoning
0340000001040	67.48 AC	M-2
0340000001010	2.665 AC	M-2
0340000001050	35 AC	R-15S

Utilities

City water is available to serve the site. The connection to city sewer is approximately 700 feet away at the entrance to the Bryan's Cove townhouse development

Wetland Delineation: Available

Asking Price: \$4.5 million or best offer

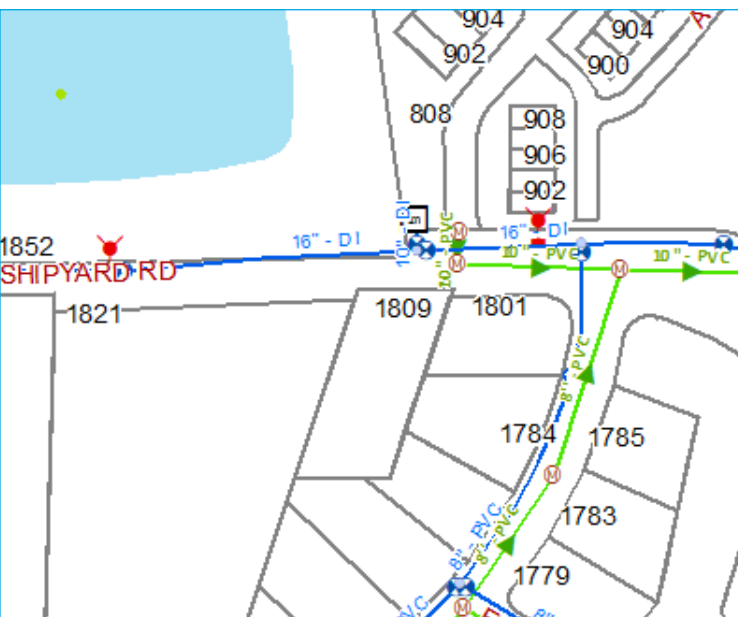

Demographics

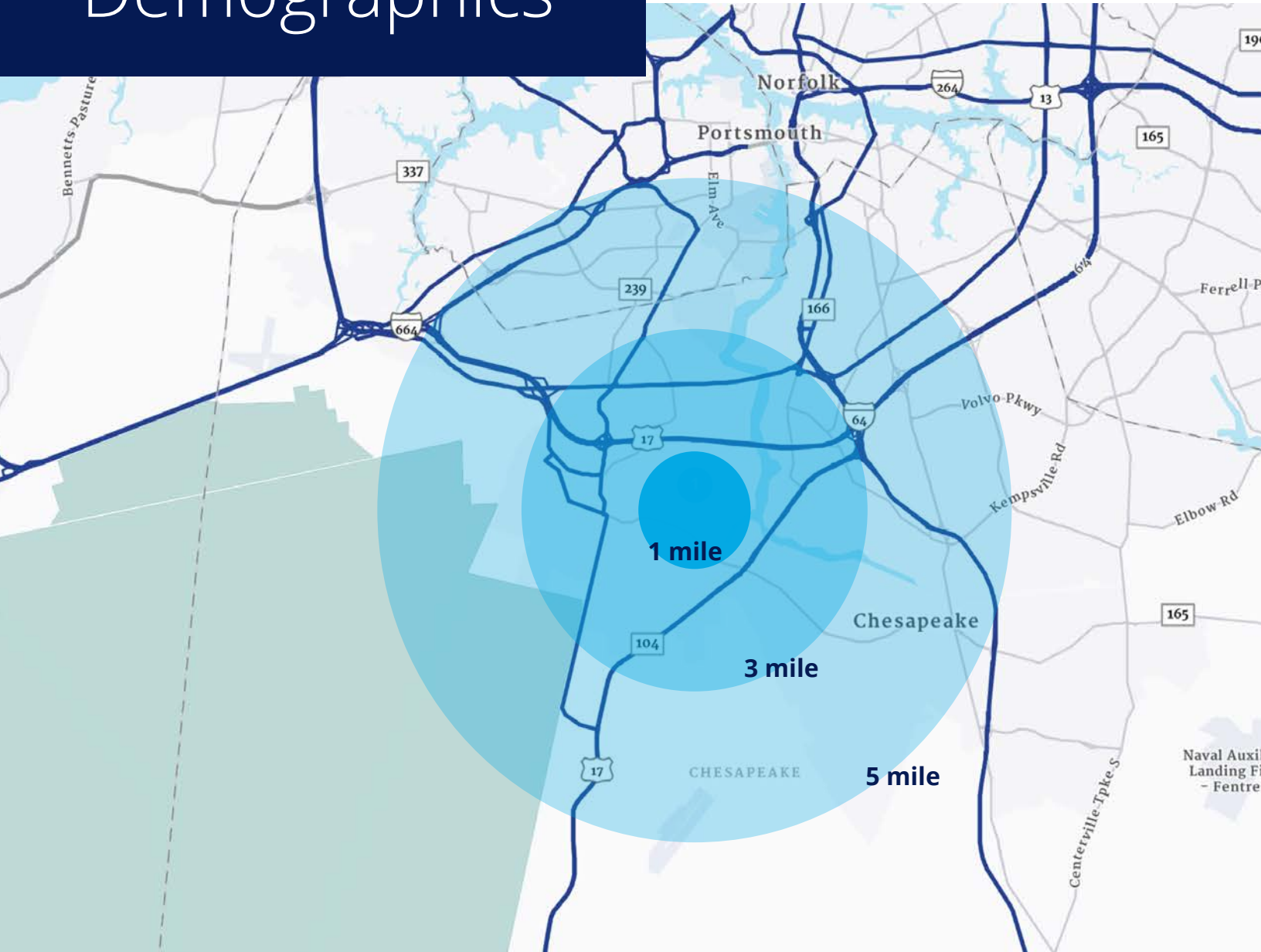

Address: 1972 Shipyard Rd., Chesapeake, VA

	1 Mile	3 Mile	5 Mile
2025 Total Population	4,346	53,828	140,408
2025 Households	558	13,403	40,511
2025 Household Income	\$137,665	\$102,911	\$84,341
2025 Home Value	\$498,031	\$428,778	\$382,408

Site Aerial

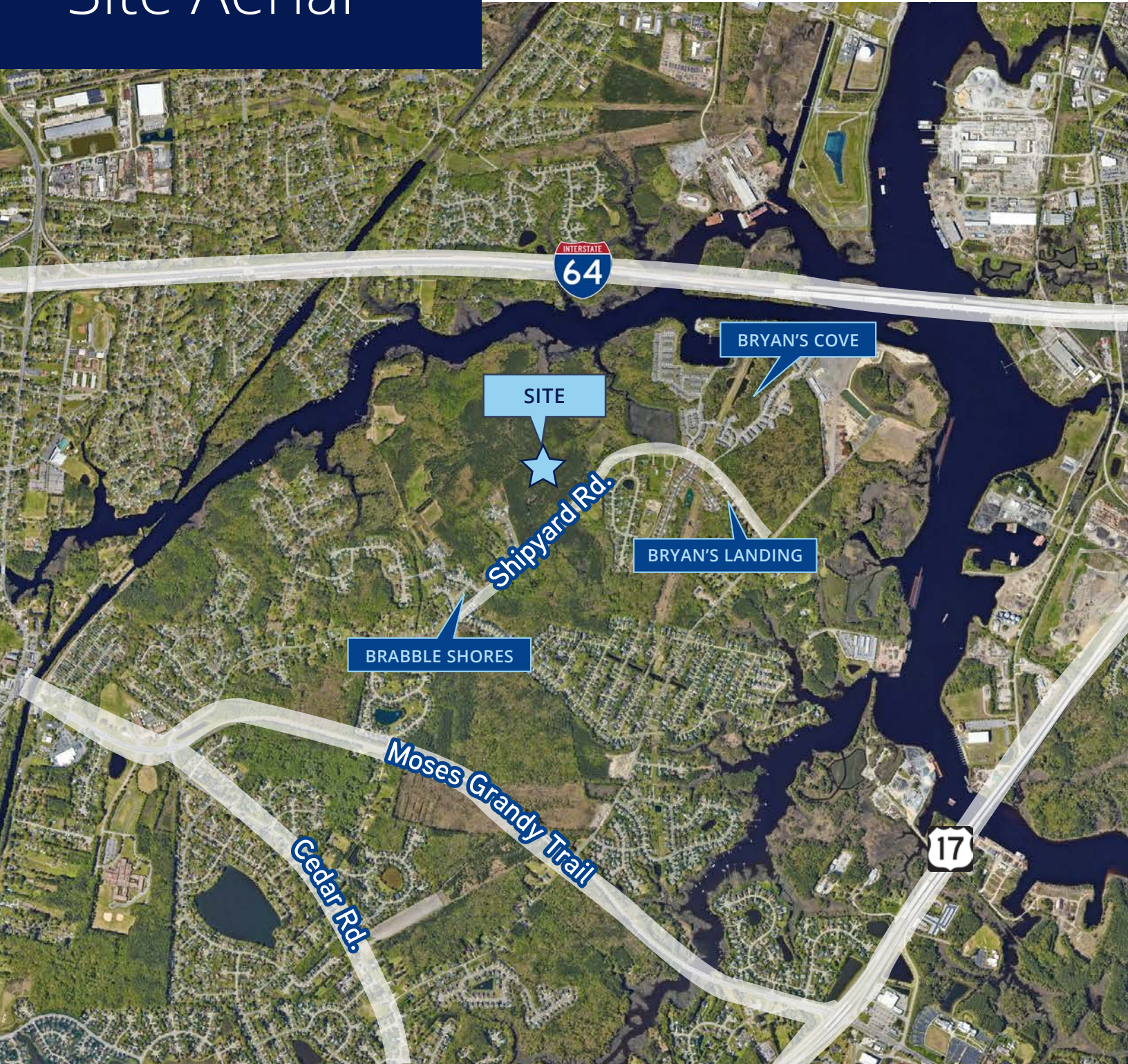

This document has been prepared by Colliers International for advertising and general information only. Colliers International makes no guarantees, representations or warranties of any kind, expressed or implied, regarding the information including, but not limited to, warranties of content, accuracy and reliability. Any interested party should undertake their own inquiries as to the accuracy of the information. Colliers International excludes unequivocally all inferred or implied terms, conditions and warranties arising out of this document and excludes all liability for loss and damages arising there from. This publication is the copyrighted property of Colliers International and/or its licensor(s). ©2026. All rights reserved.



Wetland Map

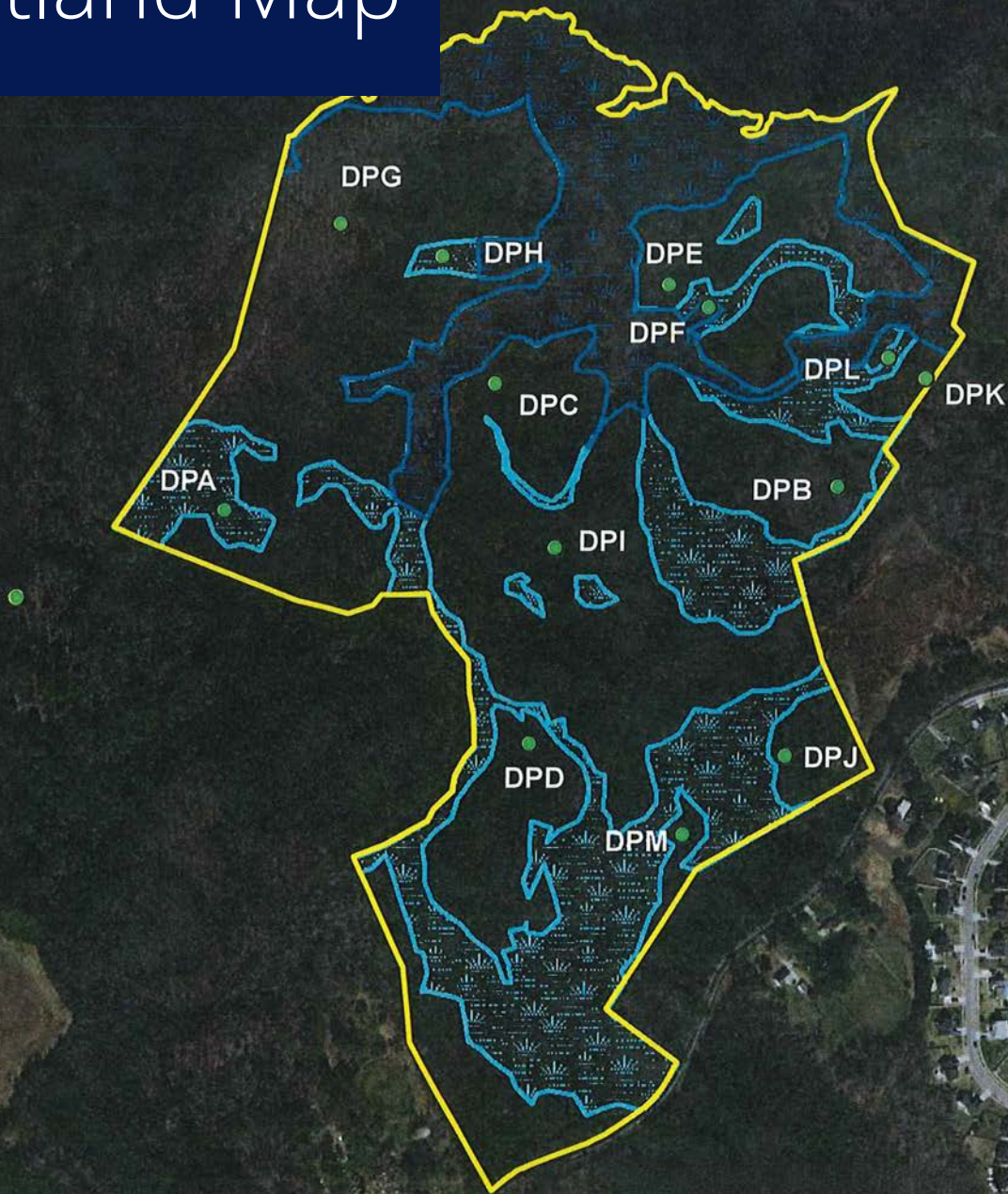

Contact:

Patrick Gill, CCIM

Senior Vice President

+1 757 228 1832

patrick.gill@colliers.com

Colliers

150 West Main St | Suite 1100

Norfolk, VA 23510

P: +1 757 490 3300

F: +1 757 490 1200

colliers.com

This document has been prepared by Colliers International for advertising and general information only. Colliers International makes no guarantees, representations or warranties of any kind, expressed or implied, regarding the information including, but not limited to, warranties of content, accuracy and reliability. Any interested party should undertake their own inquiries as to the accuracy of the information. Colliers International excludes unequivocally all inferred or implied terms, conditions and warranties arising out of this document and excludes all liability for loss and damages arising there from. This publication is the copyrighted property of Colliers International and/or its licensor(s). ©2026. All rights reserved.