

FOR LEASE

Modern Shallow Bay Industrial Development



ADAM GREEN, SIOR

agreen@lee-associates.com
D 512.410.8263
C 512.699.1103

MITCHELL BECKER

mbecker@lee-associates.com
D 512.410.8265
C 281.795.7906

WILL SMITH

wsmith@lee-associates.com
D 512.410.8268
C 406.788.8672

LEASING:

 **LEE &
ASSOCIATES**

OWNERSHIP:

LIGHTSTONE

BUILDING 1

- ±2,446 SF
- ±353 SF Office
- ±18' Clear Height
- Cross Dock, Two (2) Oversized 12' x 14' Grade-Level Doors
- R30 insulation
- HVAC Ready
- Stained Concrete Flooring
- **Available Now**

AVAILABILITY

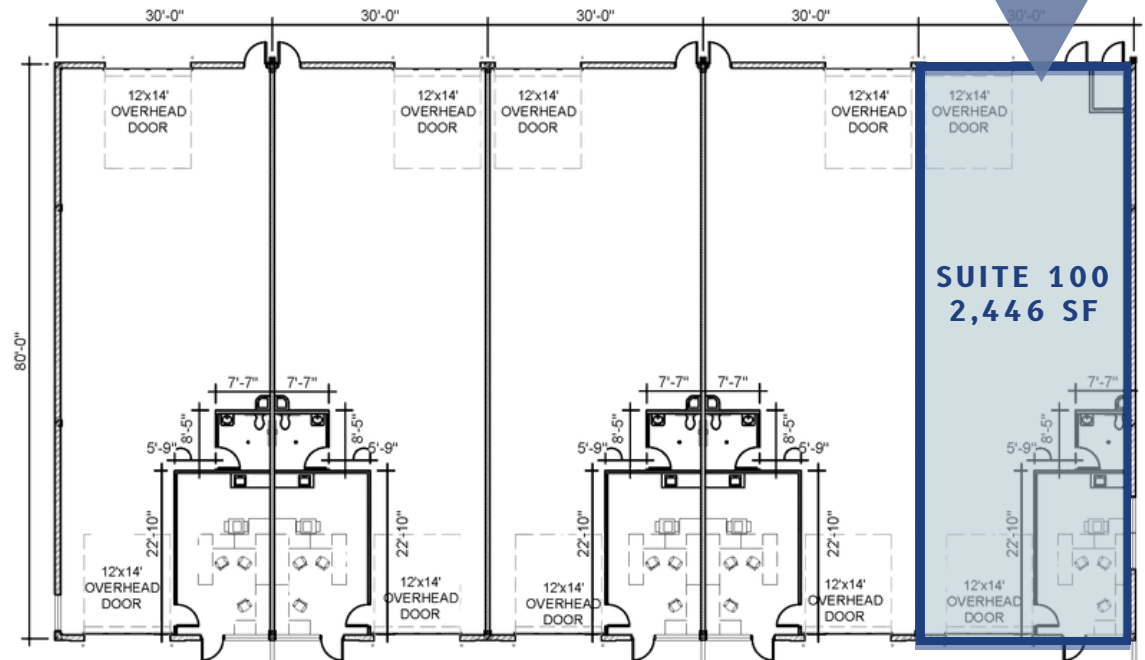
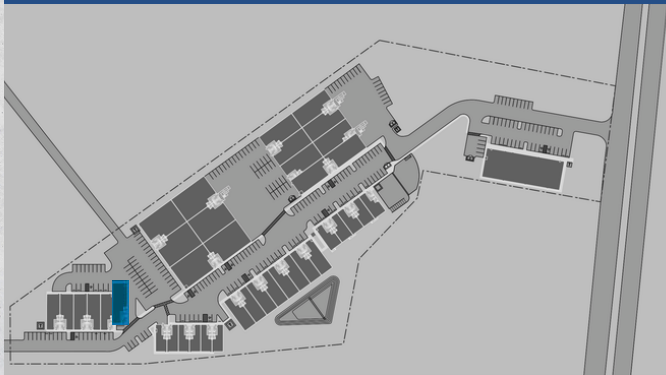

ADAM GREEN, SIOR

agreen@lee-associates.com
D 512.410.8263
C 512.699.1103

MITCHELL BECKER

mbecker@lee-associates.com
D 512.410.8265
C 281.795.7906

WILL SMITH

wsmith@lee-associates.com
D 512.410.8268
C 406.788.8672

 **LEE &
ASSOCIATES**

LIGHTSTONE

INTERIOR PHOTOS

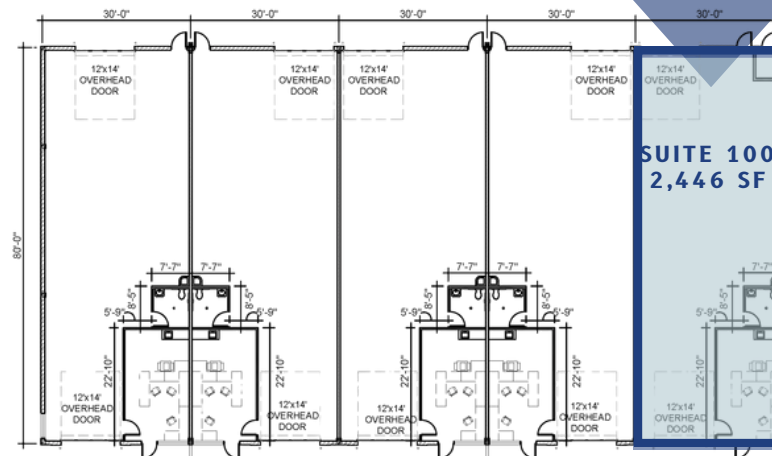

ADAM GREEN, SIOR
agreen@lee-associates.com
D 512.410.8263
C 512.699.1103

MITCHELL BECKER
mbecker@lee-associates.com
D 512.410.8265
C 281.795.7906

WILL SMITH
wsmith@lee-associates.com
D 512.410.8268
C 406.788.8672



LIGHTSTONE

BUILDING 2

- ±1,535 SF
- ±308 SF Office
- ±18' Clear Height
- One (1) Oversized 12' x 14' Overhead Door.
- R30 insulation, HVAC ready and 100% HVAC spaces
- LED Warehouse Lighting
- Stained Concrete Flooring

AVAILABILITY

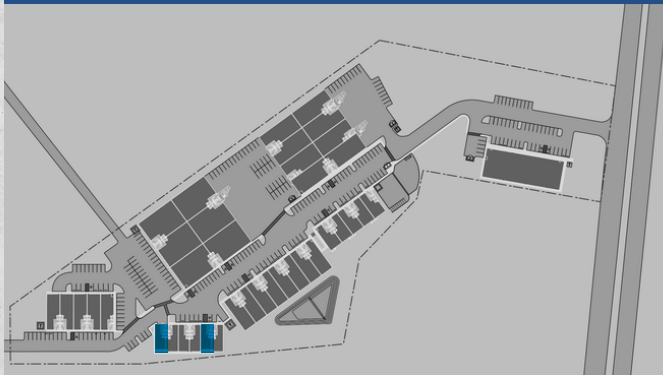

SUITE 200 1,535 SF AVAILABLE 10/01/26	SUITE 210 1,535 SF AVAILABLE 08/01/26
---	---

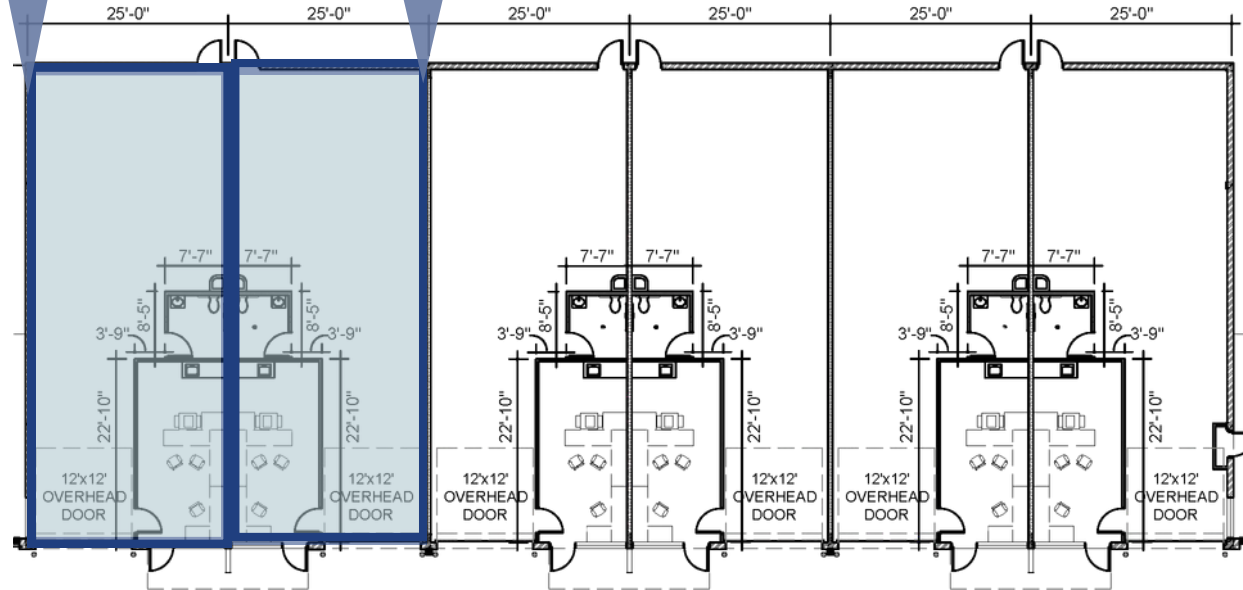

ADAM GREEN, SIOR

agreen@lee-associates.com
D 512.410.8263
C 512.699.1103

MITCHELL BECKER

mbecker@lee-associates.com
D 512.410.8265
C 281.795.7906

WILL SMITH

wsmith@lee-associates.com
D 512.410.8268
C 406.788.8672



LIGHTSTONE

BUILDING 3

- ±2,440 - 7,320 SF*
- ±360 - 1,080 SF Office
- ±21' Clear Height
- Three (3) Oversized 12' x 14' Overhead Door
- R30 insulation, HVAC ready and 100% HVAC spaces
- Stained Concrete Flooring
- **Available 09/01/2026**

AVAILABILITY

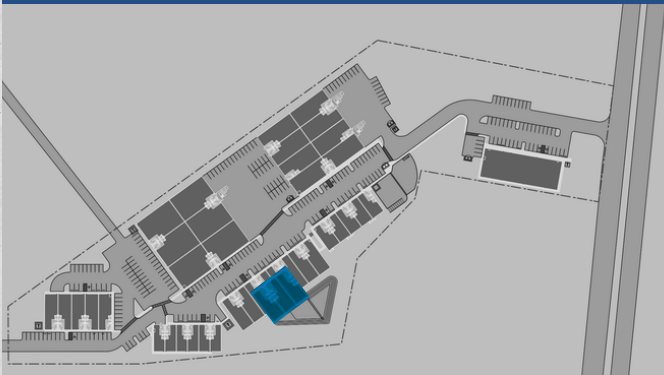

SUITE 350*
2,440 - 7,320 SF
AVAILABLE 09/01/26

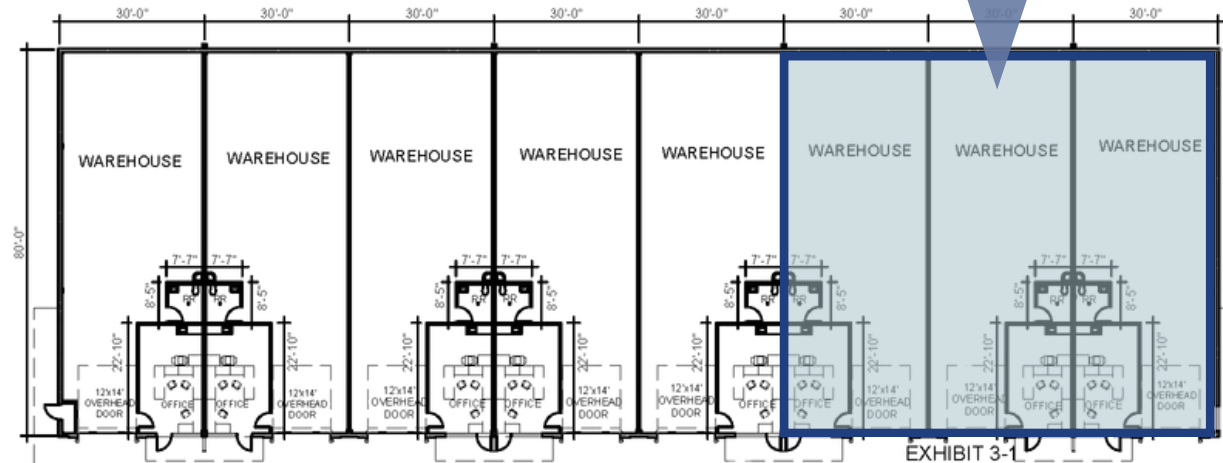

*Can be demised into 1, 2 or 3 spaces

ADAM GREEN, SIOR

agreen@lee-associates.com
D 512.410.8263
C 512.699.1103

MITCHELL BECKER

mbecker@lee-associates.com
D 512.410.8265
C 281.795.7906

WILL SMITH

wsmith@lee-associates.com
D 512.410.8268
C 406.788.8672



LIGHTSTONE

BUILDING 4

- ±5,460 SF
- ±360 SF Office
- ±25' Clear Height
- Two (2) 12' x 14' Grade Level Doors
- R30 Insulation
- LED Warehouse Lighting
- 3-phase power
1600 amps
- **Available 11/01/2026**

AVAILABILITY



SUITE 440
5,505 SF
AVAILABLE 11/01/26

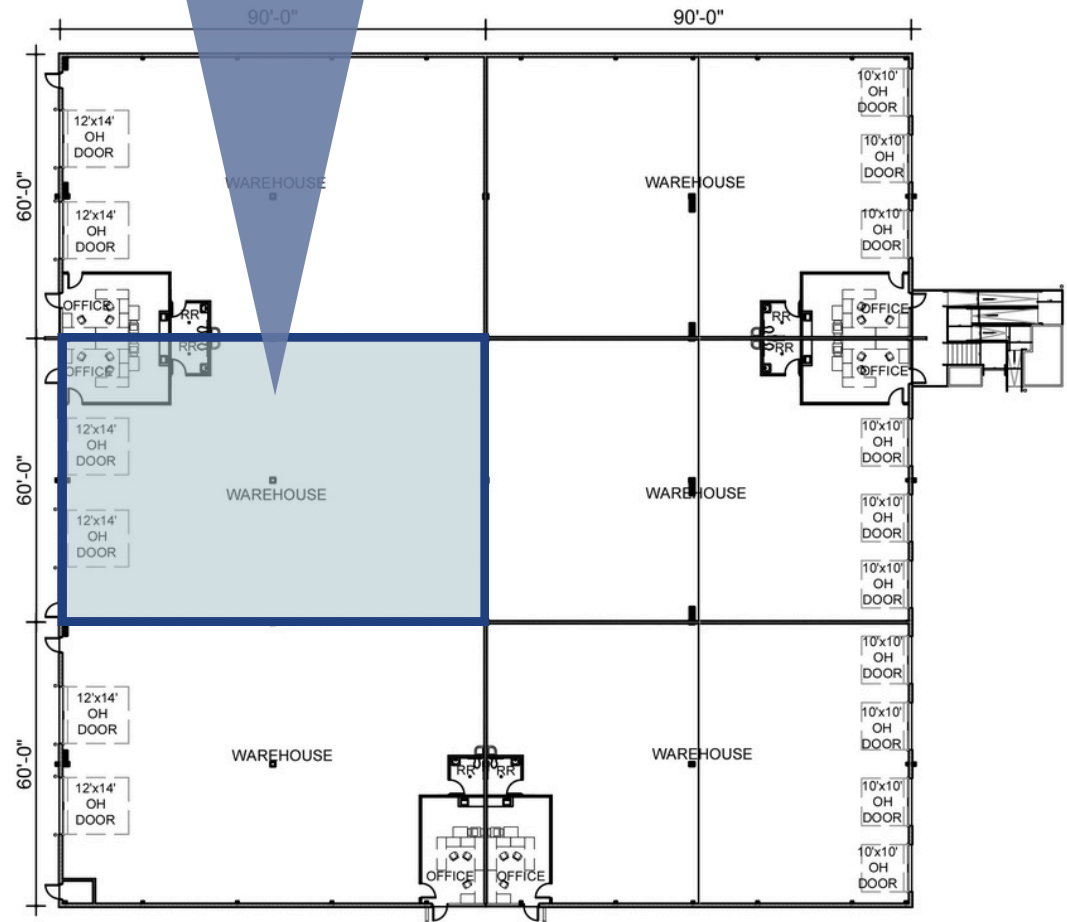

ADAM GREEN, SIOR

agreen@lee-associates.com
D 512.410.8263
C 512.699.1103

MITCHELL BECKER

mbecker@lee-associates.com
D 512.410.8265
C 281.795.7906

WILL SMITH

wsmith@lee-associates.com
D 512.410.8268
C 406.788.8672



LIGHTSTONE

SITE PLAN

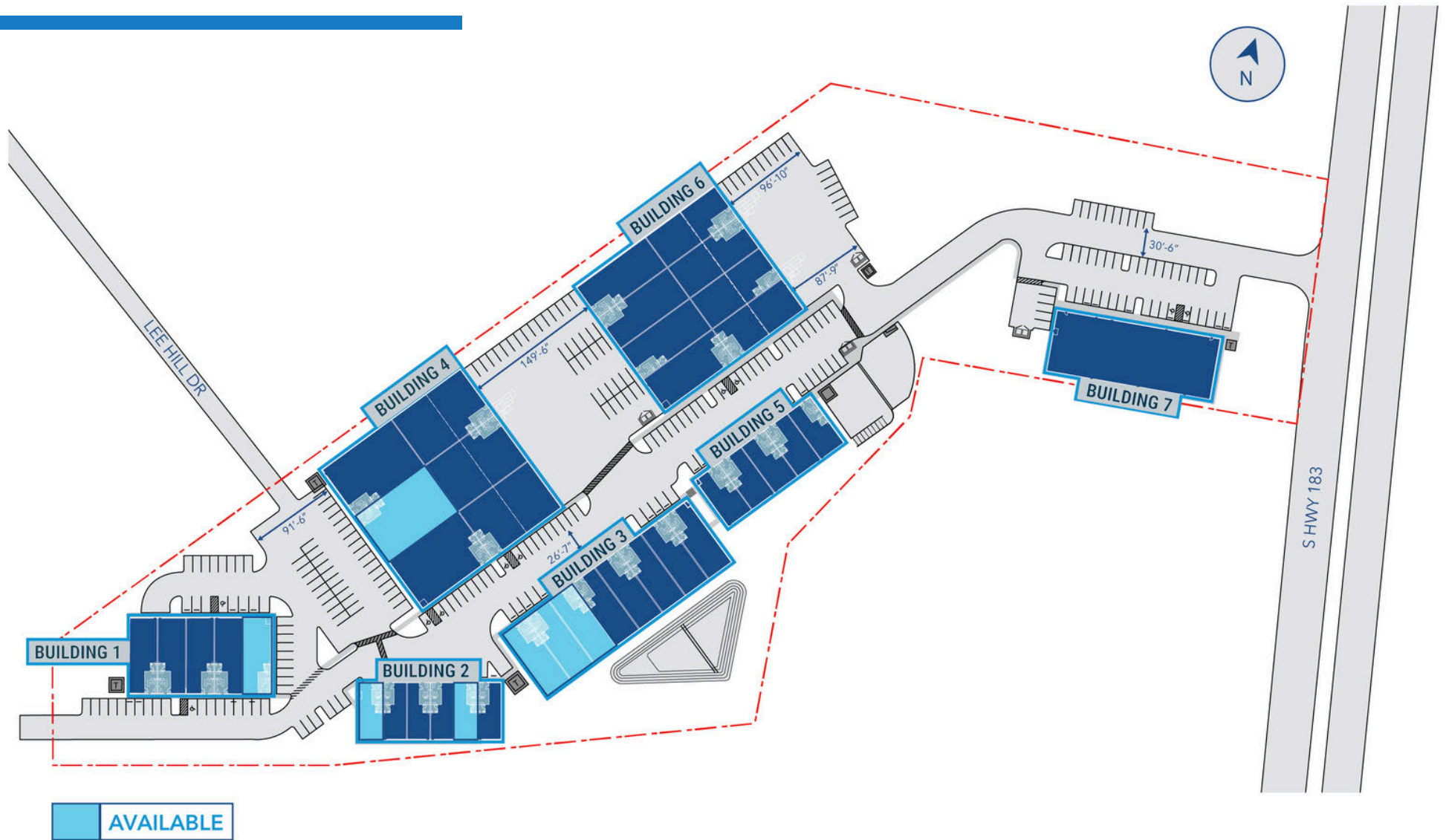

ADAM GREEN, SIOR

agreen@lee-associates.com
D 512.410.8263
C 512.699.1103

MITCHELL BECKER

mbecker@lee-associates.com
D 512.410.8265
C 281.795.7906

WILL SMITH

wsmith@lee-associates.com
D 512.410.8268
C 406.788.8672

LEE & ASSOCIATES

LIGHTSTONE

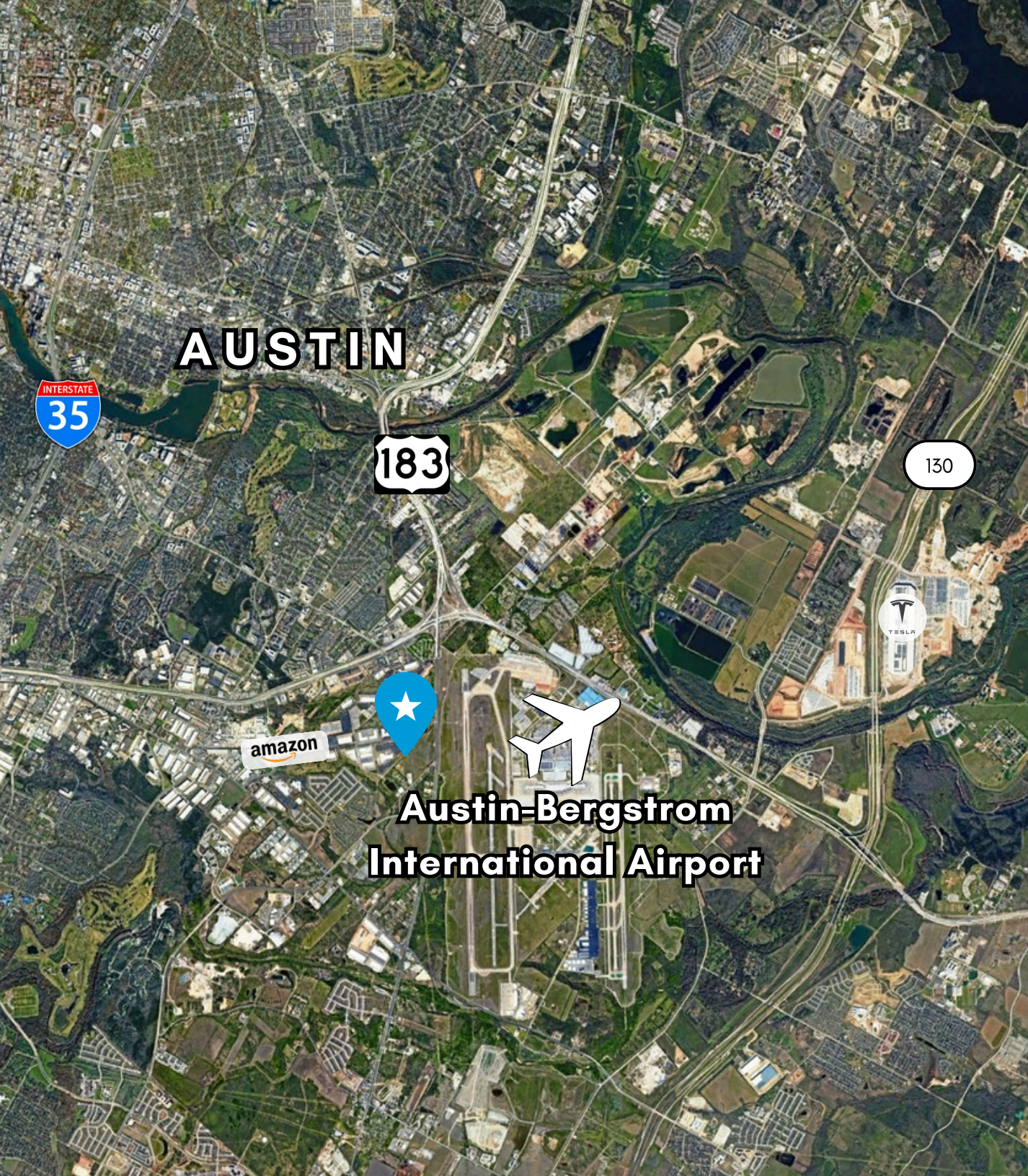

AUSTIN

183

130

amazon

**Austin-Bergstrom
International Airport**

Drive Times

- Austin Bergstrom International Airport **9 miles**
- Downtown Austin **20 miles**
- University of Texas, Austin **25 miles**

Corporate Neighbors



TESLA

amazon



WAYMO



FOUR HANDS
FURNISHING STYLE

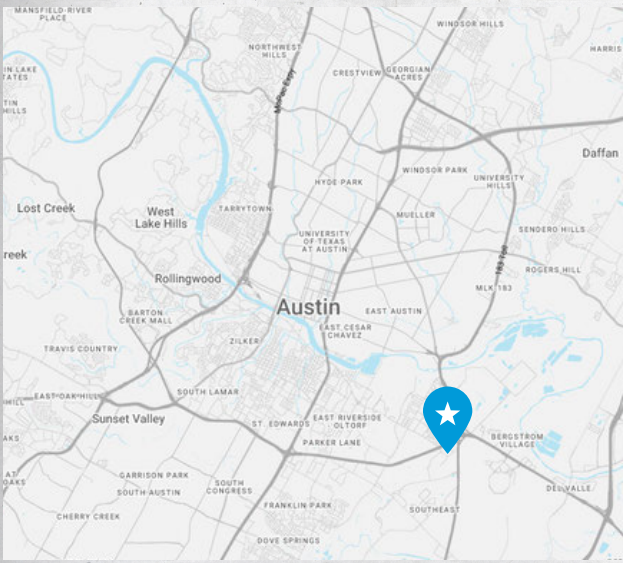

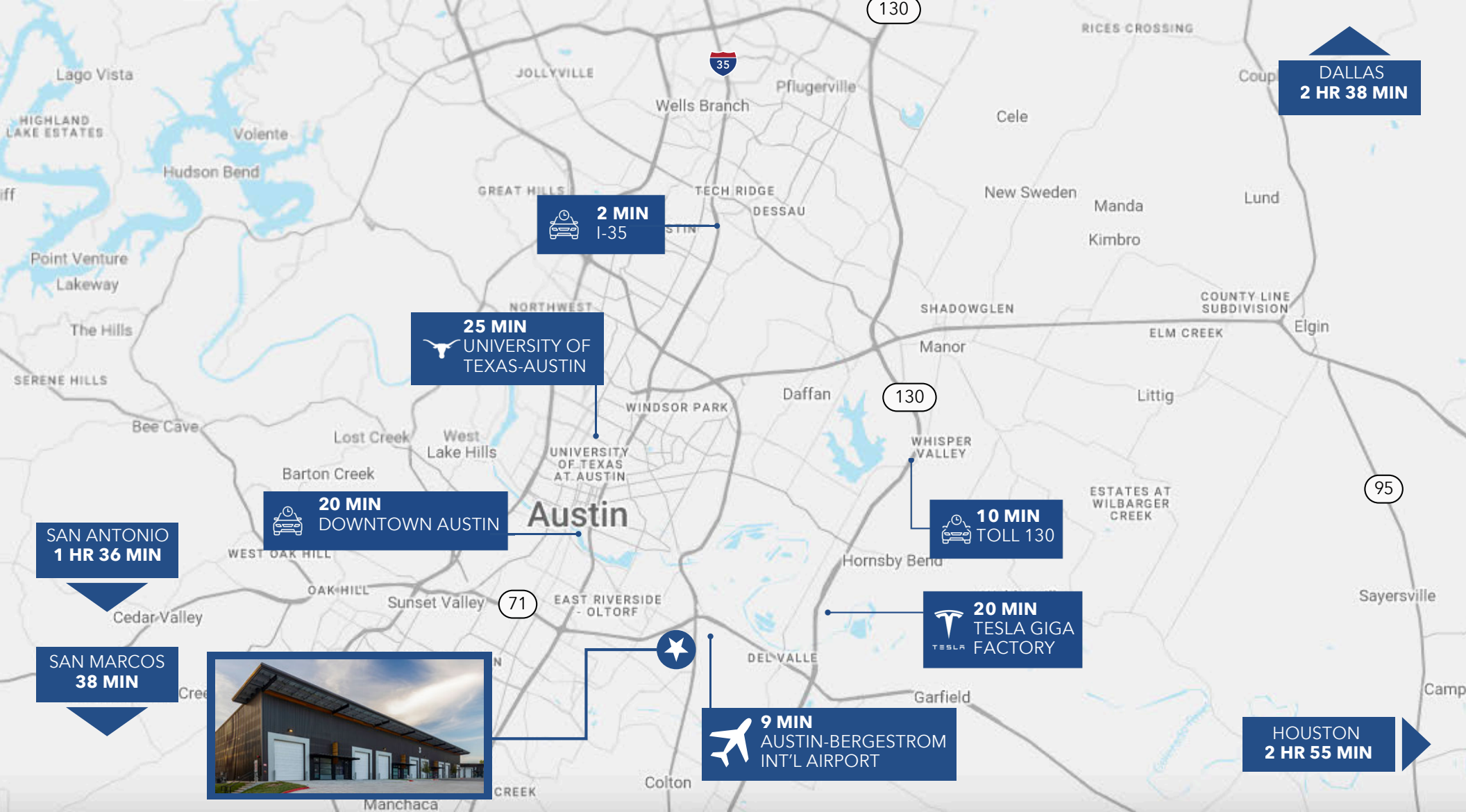

ADAM GREEN, SIOR

agreen@lee-associates.com
D 512.410.8263
C 512.699.1103

MITCHELL BECKER

mbecker@lee-associates.com
D 512.410.8265
C 281.795.7906

WILL SMITH

wsmith@lee-associates.com
D 512.410.8268
C 406.788.8672

SCAN FOR MORE INFORMATION



LIGHTSTONE