

101 PARK AVENUE

ONE BLOCK FROM GRAND CENTRAL.
EVERY COMMUTE, SIMPLIFIED.

Class-A Sublease Opportunity | Up to ~15,000 SF Available Immediately

Lincoln



101 PARK AVE OFFERS THE WHOLE PACKAGE



CLUB 101

Private club with dining, lounge and patio offering free membership to tenants.



CAFÉ 101

Grab-and-go or seated breakfast and lunch.



FIVE IRON GOLF

Work on your swing at the Five Iron Golf indoor urban golf experience.



CONVENE

Elevated conference space to fit a variety of needs—from meetings to conventions.



ON-SITE AMENITIES

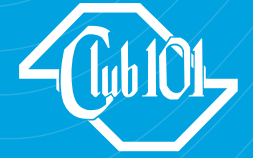

Café 101



FIVE IRON GOLF

convene

UNMATCHED CONNECTIVITY



RAILROAD

Metro-North Railroad

Long Island Railroad



MTA SUBWAY

GRAND CENTRAL



BRYANT PARK



- 124 car garage with in-building access
- CitiBike Station in front of building
- Central bus station hub for all major airports
- Newark Airport Express
- 3 blocks from Bryant Park

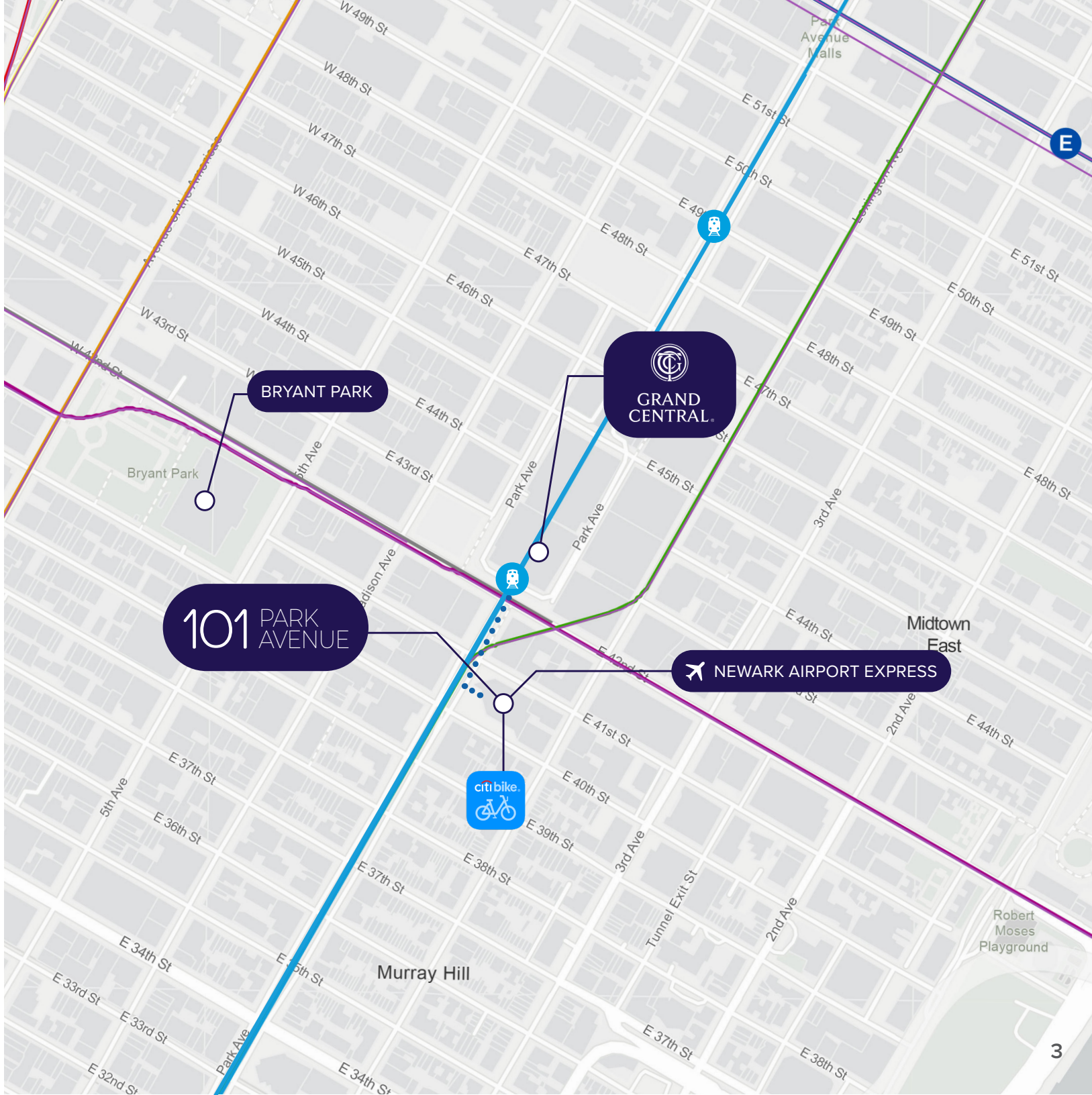

BUILDING DETAILS

PROPERTY HIGHLIGHTS



24/7 LOBBY
CONCIERGE



MESSENGER
CENTER



FULL-SERVICE
NEWSSTAND



KEYCARD
ACCESS

BUILDING CERTIFICATIONS



AMENITY-RICH MIDTOWN LOCATION

101 Park Avenue delivers a best-in-class Midtown address surrounded by an unmatched amenity base.

Tenants benefit from immediate access to premier restaurants, grab-and-go dining, fitness clubs, high-end hotels, and everyday conveniences—creating a dynamic, employee-friendly environment that supports recruitment, retention, and productivity.



omakase
OSUKĀĀ

THE GRILL

BLUESTONE LANE

★ **PRET A MANGER** ★

BUCATINI

le **PAVILLON**
DANIEL BOULUD
FINE CUISINE

THE BROADWAY
BOBBY VAN'S
230 PARK

STK
STEAKHOUSE

EQUINOX

JOJI
BOX

Y&Y

THE **CAPITAL**
GRILL • L.L.E.

point seven

GRAND CENTRAL
OYSTER
BAR • RESTAURANT

pera
MEDITERRANEAN BRASSERIE

BONDI

BENJAMIN
STEAK HOUSE
PRIME

101 PARK AVENUE

[solidcore]

tartinery
CAFÉ • BAR

KONA
COFFEE ROASTERS

FLOOR PLAN

12TH FLOOR

UP TO ~15,000 SF

Sublease through April 2031

Flexible Layout

Furniture Available

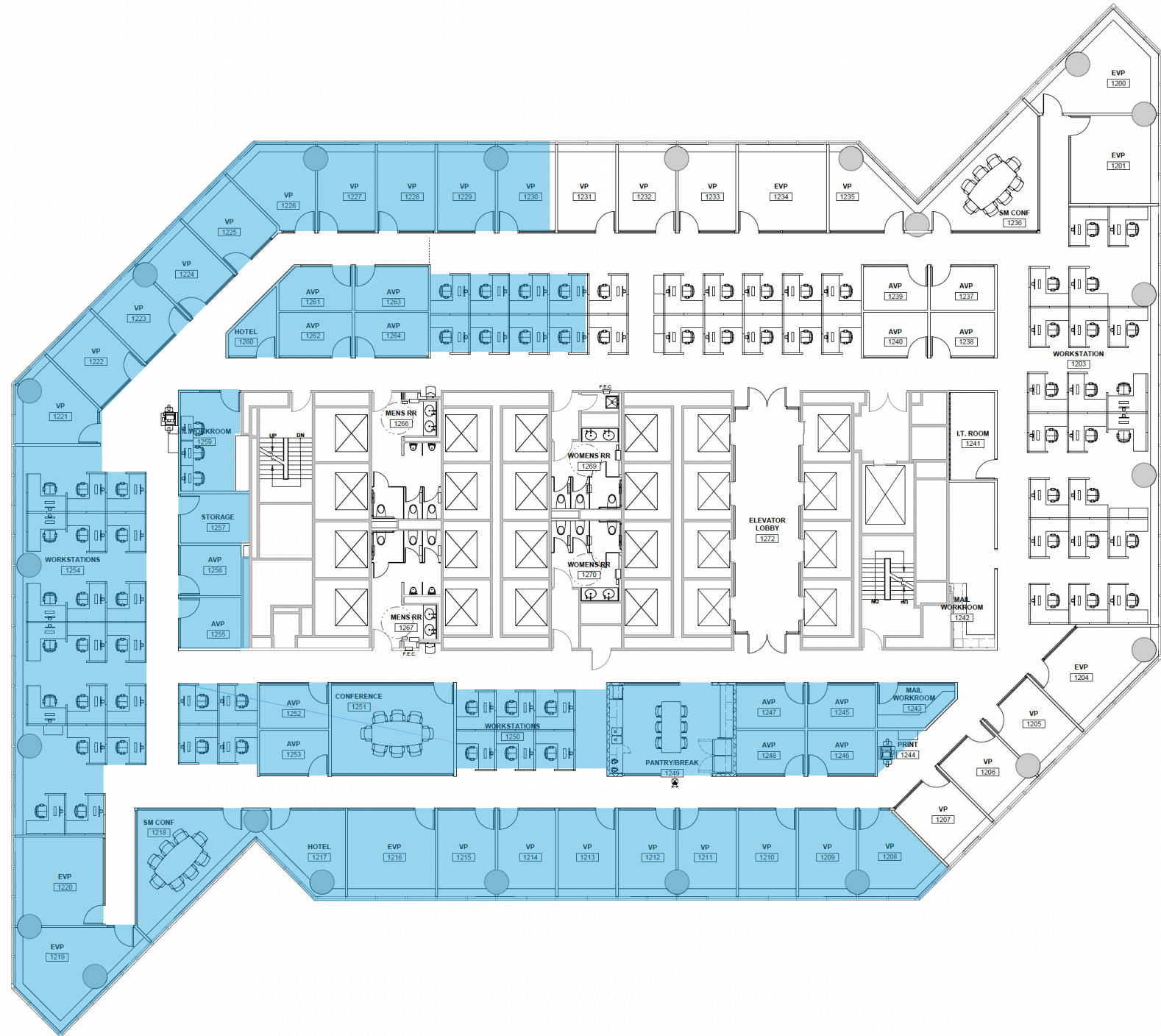



101 PARK AVENUE

Christopher Wittmann
212.752.1041

Lincoln

Lincoln Property Company | www.lpc.com