

DRONE VIDEO



Parktowne Village

1600 East Woodlawn Road
Charlotte, NC 28209



1111 Metropolitan Avenue,
Suite 700
Charlotte, NC 28204

Contact: George Cornelson
direct: 704.975.4652
gcornelson4@gmail.com

The information contained herein has been obtained by sources we deem reliable. We have no reason to doubt its accuracy, but we do not guarantee it. All information should be verified prior to purchase or lease.

Parktowne Village

Property Overview

PROPERTY FEATURES

- Available Spaces:
SF 1,657 SF
- Tenants include: Easy Like Sunday, Bon Chon, Total Wine, Starbucks, Jason's Deli, Charlotte Yoga, Project Lean Nation, The Joint Chiropractic, Smoothie King, Palm Beach Tan, Jon Ric Med Spa, The Local Scoop, Anjou, Verizon, Sports Clips, Calico, Massage Envy and more!
- ParkTowne Village is located at the heavily-trafficked intersection of Woodlawn Road and Park Road in Charlotte, NC. This ±101,802 SF Specialty Center is located across from Charlotte's oldest shopping center, Park Road Shopping Center.

DEMOGRAPHICS (2025)

	1 mile	3 miles	5 miles
Population	14,474	114,535	290,675
Projected Pop.	14,813	120,074	310,246
Daytime Pop.	9,616	110,785	229,819
Avg. HH Income	\$188,177	\$208,034	\$167,039

TRAFFIC COUNTS (2023)

East Woodlawn Rd	27,546 VPD
Park Road	29,191 VPD

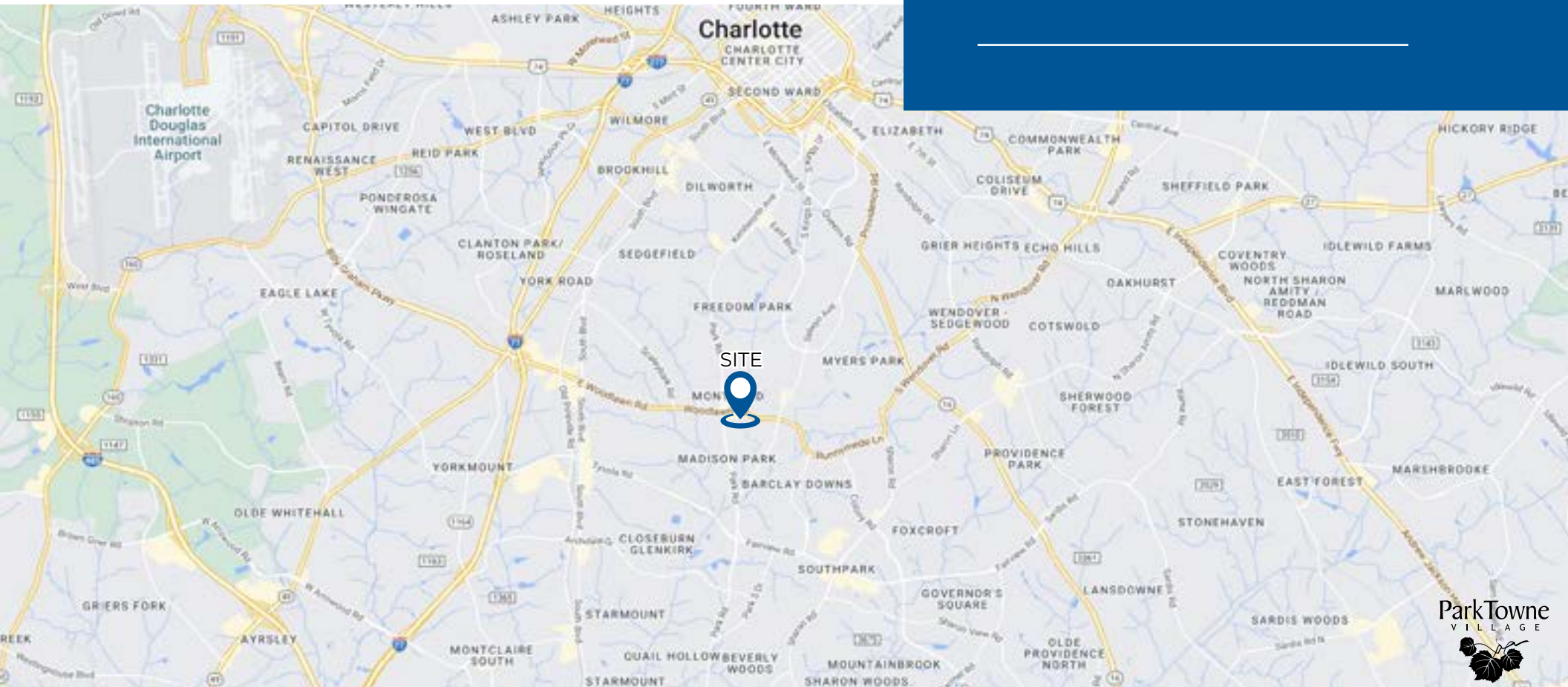

Parktowne Village

Property Overview



FOR LEASE
Available 11/26

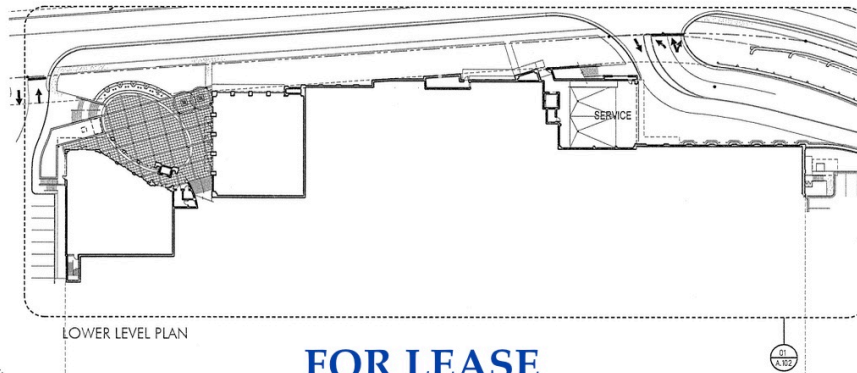
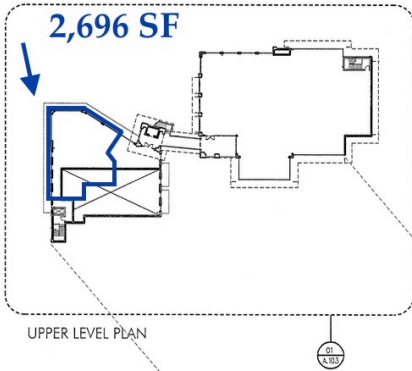

FOR LEASE
Available Now
1,657 SF

East Woodlawn Rd

Park Rd

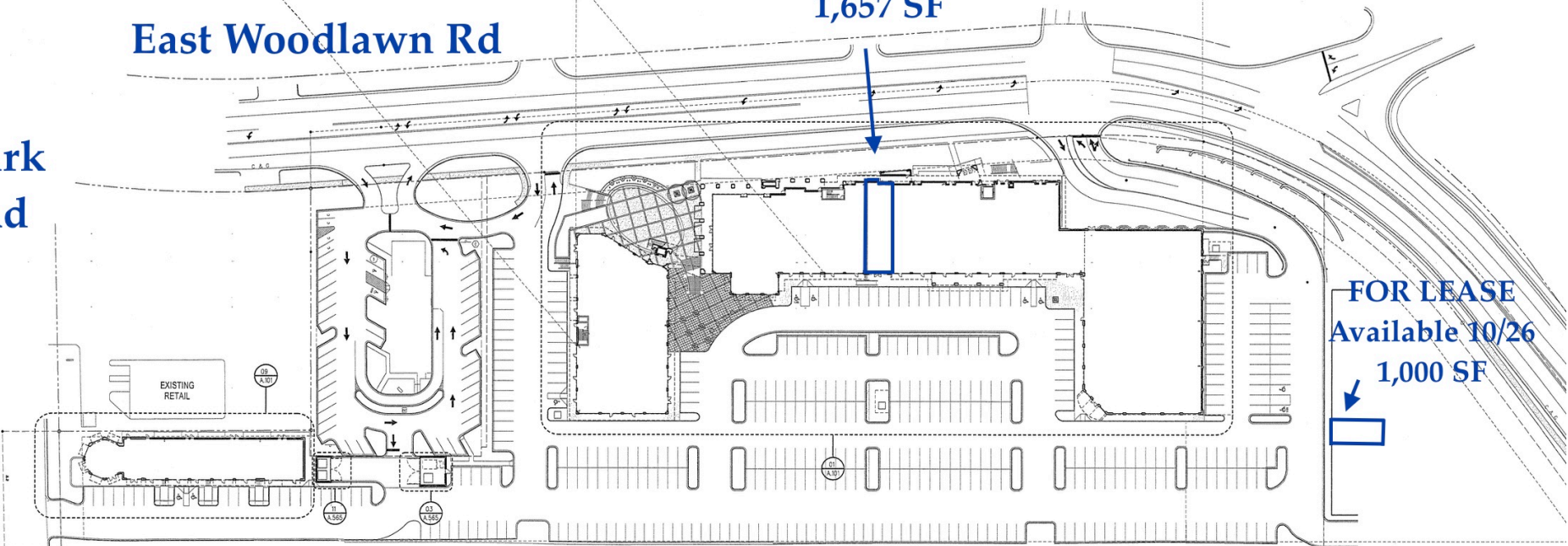

FOR LEASE
Available 10/26
1,000 SF