



FOR LEASE - ±5,318 SF INDUSTRIAL UNIT

17443 MOUNT CLIFFWOOD CIRCLE, UNIT A | FOUNTAIN VALLEY, CA



PROPERTY FEATURES:

- » ±800 SF of Office Space
- » Recently Renovated Office Area and Windows
- » 16' Clear Height
- » One (1) Ground Level Loading Door
- » 400 Amps, 120/208 Volts (*verify*)
- » Fire Sprinklers
- » 10 Parking Spaces
- » Shared Secured Exterior Parking/Storage Area
- » Minutes from Costco and Other Retail Amenities
- » Great San Diego (405) Freeway Access

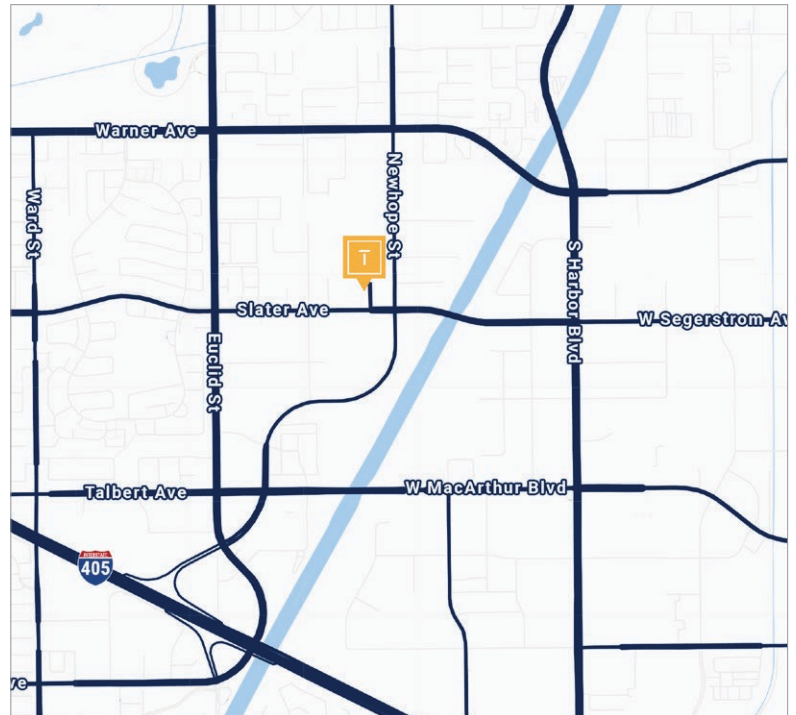

ASKING LEASE RATE: \$1.45 PSF IG

CONTACT US:

TIDEMARK
Real Estate Services

**BROKERAGE | INVESTMENTS
PROPERTY MANAGEMENT**

TAYLOR SNYDER, MBA
Senior Vice President
(949) 533-1321
taylor@tidemarkrealestate.com
DRE Lic. 02092420

PAT LACEY
Executive Director
(714) 875-4134
pat@tidemarkrealestate.com
DRE Lic. 00988663

STEPHEN MARGARETIS
Senior Associate
(949) 439-1988
stephen@tidemarkrealestate.com
DRE Lic. 02112014

DISCLAIMER: The information contained herein has been obtained from the property owner or other third party and is provided to you without verification as to accuracy. We (Tidemark Real Estate Services, Inc., its brokers, employees, agents, principals, officers, directors and affiliates) make no warranty or representation regarding the information, property, or transaction. You and your attorneys, advisors and consultants should conduct your own investigation of the property and transaction.

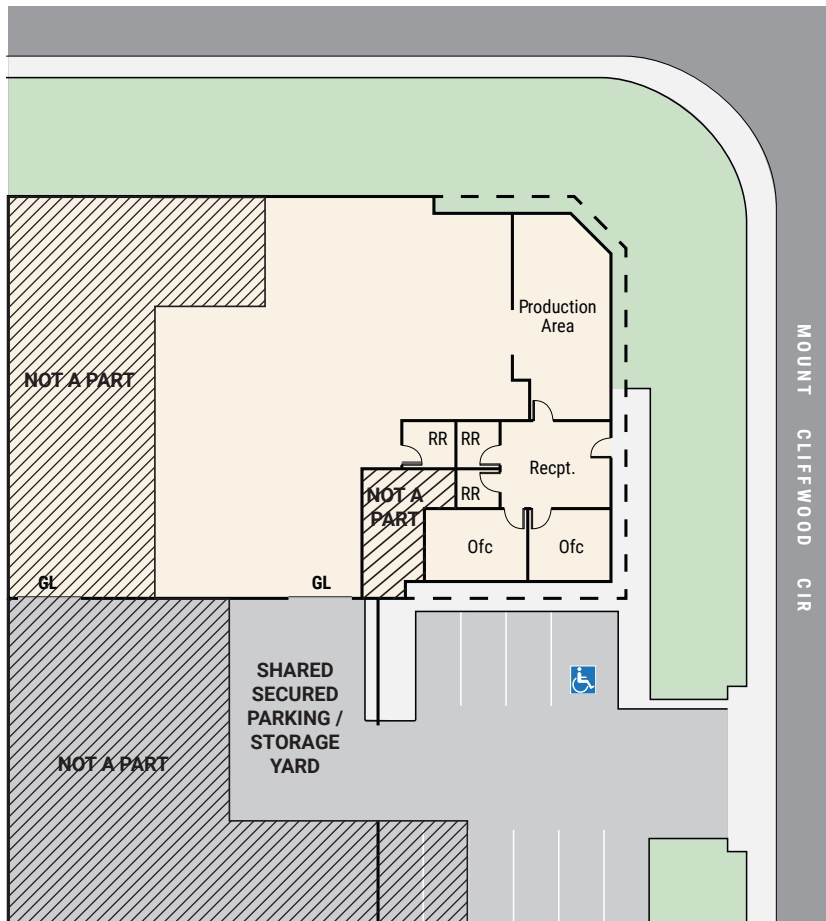

CONTACT US:

TIDEMARK
Real Estate Services
BROKERAGE | INVESTMENTS
PROPERTY MANAGEMENT

TAYLOR SNYDER, MBA
Senior Vice President
(949) 533-1321
taylor@tidemarkrealestate.com
DRE Lic. 02092420

PAT LACEY
Executive Director
(714) 875-4134
pat@tidemarkrealestate.com
DRE Lic. 00988663

STEPHEN MARGARETIS
Senior Associate
(949) 439-1988
stephen@tidemarkrealestate.com
DRE Lic. 02112014

DISCLAIMER: The information contained herein has been obtained from the property owner or other third party and is provided to you without verification as to accuracy. We (Tidemark Real Estate Services, Inc., its brokers, employees, agents, principals, officers, directors and affiliates) make no warranty or representation regarding the information, property, or transaction. You and your attorneys, advisors and consultants should conduct your own investigation of the property and transaction.