

AVAILABLE FOR LEASE

523 HOLLYWOOD AVENUE

CHERRY HILL, NJ 08002



8,287 SF OFFICE SUITE

OFFICE BUILDING ON ROUTE 38

\$19.75
PSF + UTIL & JAN
LEASE RATE

EXECUTIVE
LEVEL TOP
FLOOR

PROPERTY HIGHLIGHTS

- Window-lined offices. Luxury finishes throughout
- Completely renovated and upgraded building
- Improvements include new roof, new HVAC, Upgraded LED lighting as well as new safety / security cameras
- Nearby amenities abound
- Great location on Route 38 in Cherry Hill



CONTACT

REBECCA TING, SIOR
+1 856 234 9600 x206
rebecca.ting@naimertz.com

JULIE KRONFELD
+1 856 802 6516
julie.kronfeld@naimertz.com

NAIMertz
856.234.9600 | naimertz.com

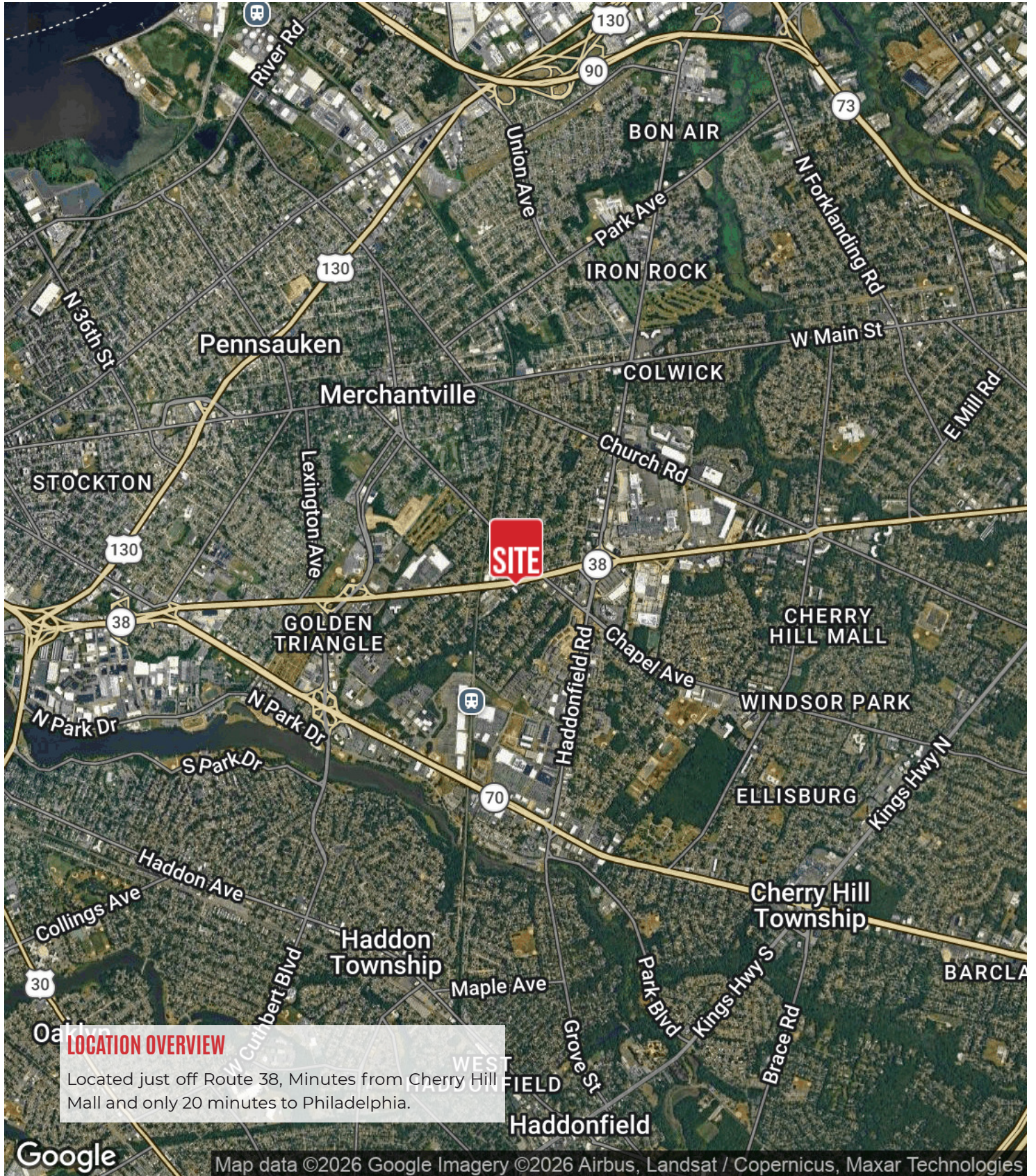

CONTACT

REBECCA TING, SIOR
+1 856 234 9600 x206
rebecca.ting@naimertz.com

JULIE KRONFELD
+1 856 802 6516
julie.kronfeld@naimertz.com

ADDITIONAL PHOTOS

523 HOLLYWOOD AVENUE CHERRY HILL, NJ



CONTACT

REBECCA TING, SIOR
+1 856 234 9600 x206
rebecca.ting@naimertz.com

JULIE KRONFELD
+1 856 802 6516
julie.kronfeld@naimertz.com

NAIMertz
856.234.9600 | naimertz.com

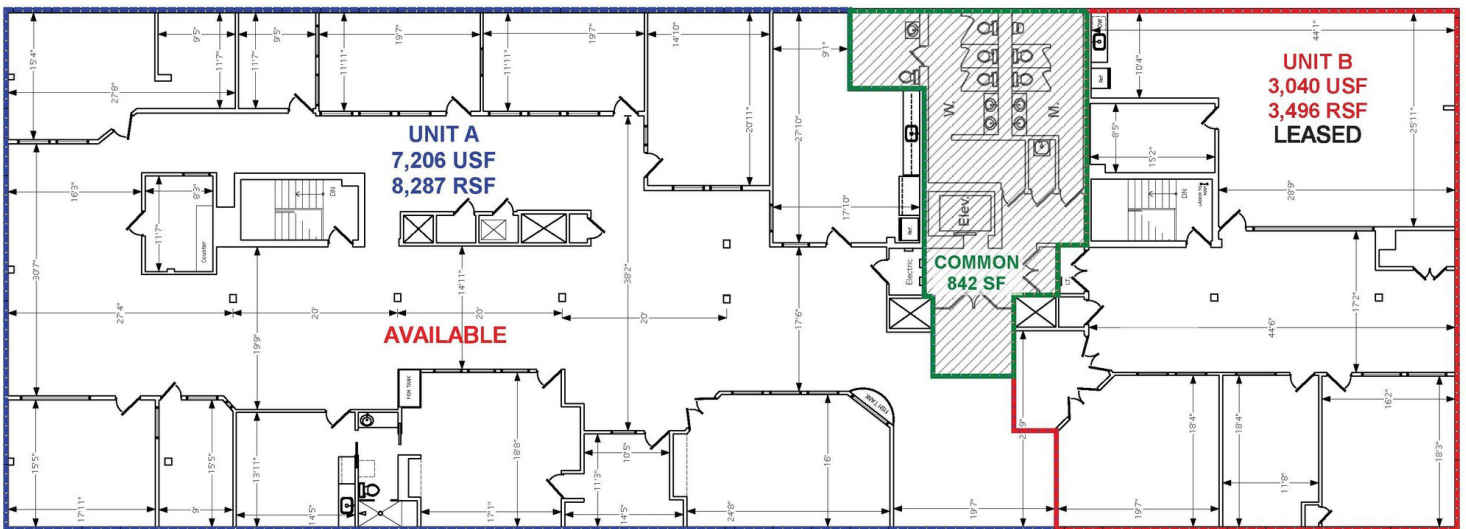

CONTACT

REBECCA TING, SIOR
+1 856 234 9600 x206
rebecca.ting@naimertz.com

JULIE KRONFELD
+1 856 802 6516
julie.kronfeld@naimertz.com