

# FOR LEASE

**+1,644 SF INDUSTRIAL BUILDING**  
**REDLANDS CORPORATE CENTER**



**2351 LUGONIA AVENUE, UNIT K | REDLANDS, CA 92374**



**ALEX SMITH** | Vice President | 951.276.3668 | [asmith@leeriverside.com](mailto:asmith@leeriverside.com) | DRE #02031896

**CARLY HAMILTON** | Leasing Director | 951.276.3663 | [chamilton@leeriverside.com](mailto:chamilton@leeriverside.com) | DRE #01968295

**TOBY TEWELL** | Senior Vice President | 951.276.3662 | [ttewell@leeriverside.com](mailto:ttewell@leeriverside.com) | DRE #01822772

# PROPERTY HIGHLIGHTS

Industrial Building: ±1,644 SF

Availability: Now

Business Park: Redlands Corporate Center

Location: Excellent Freeway Access to I-10 at California St & Mountain View Ave

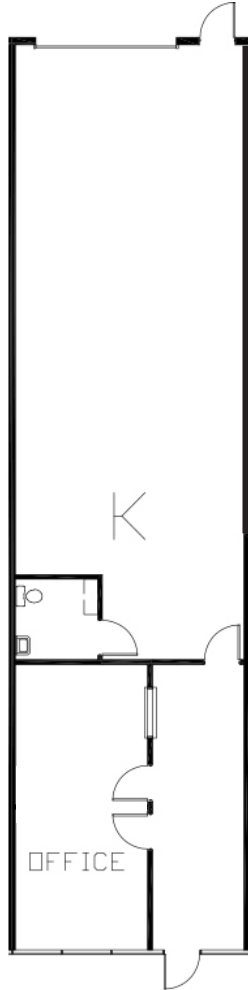

- ▶ ±600 SF Office
- ▶ Reception, 1 Private Office, Restroom, Warehouse
- ▶ 1 Ground Level Door
- ▶ 24' Clear Height
- ▶ SP-42 Zoning
- ▶ 3:1 Parking Ratio
- ▶ TBD Amps; TBDV (Need to Verify)
- ▶ Retail Frontage on Lugonia Avenue

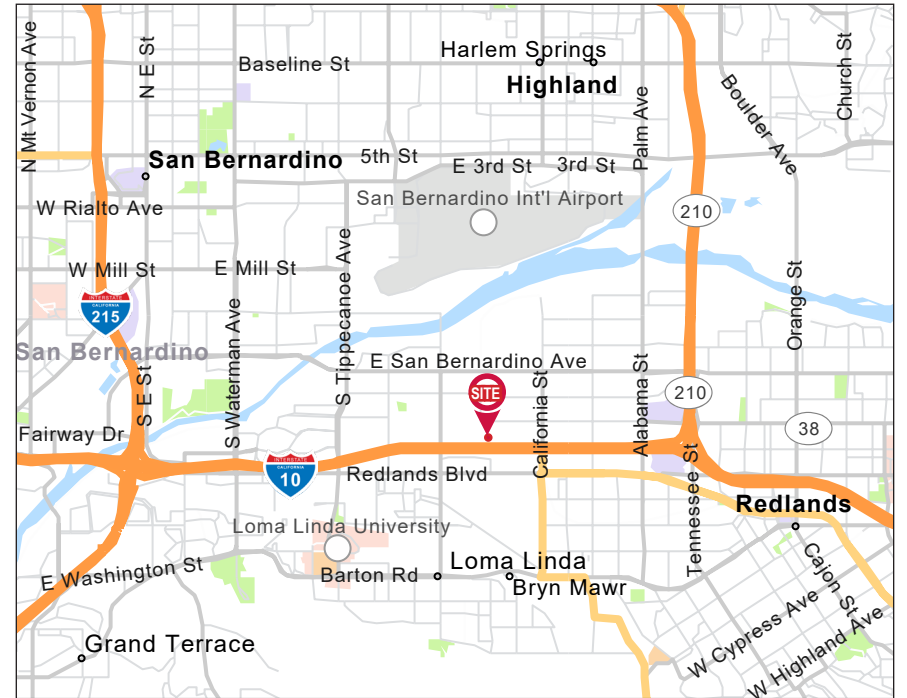

# PROPERTY PHOTOS



# SITE PLAN

