

OFFICE/WAREHOUSE FOR SALE

29 20TH Court NW | Center Point, AL 35215

\$375,000



- Building: 5,640 ± sf total including 800 sf of office & 4,840 sf of warehouse
- Zoning I-1 Light Industrial
- Fenced yard approx 5,000 sf with gate
- Covered outside storage/loading area
- 3 grade level drive-in doors
- Newer roof (7 yrs old)
- 13'-15' ceiling height
- Just a block off Hwy 75/Center Point Pkwy and 4 miles North of I-59
- Lots of nearby shopping, restaurants, etc.

AUSTIN BLAIR

ablair@lahcommercial.com | (205) 478-7805

PERRY KING

pking@lahcommercial.com | (205) 873-0584

LAH COMMERCIAL
REAL ESTATE

2850 Cahaba Road, Suite 200 • Birmingham, AL 35223 • 205-870-8580 (o) • lahcommercial.com

Information deemed reliable but not guaranteed.

WAREHOUSE



AUSTIN BLAIR

ablair@lahcommercial.com | (205) 478-7805

PERRY KING

pking@lahcommercial.com | (205) 873-0584

LAH COMMERCIAL
REAL ESTATE

2850 Cahaba Road, Suite 200 • Birmingham, AL 35223 • 205-870-8580 (o) • lahcommercial.com

Information deemed reliable but not guaranteed.

INTERIOR



AUSTIN BLAIR

ablair@lahcommercial.com | (205) 478-7805

PERRY KING

pking@lahcommercial.com | (205) 873-0584

LAH COMMERCIAL
REAL ESTATE

2850 Cahaba Road, Suite 200 • Birmingham, AL 35223 • 205-870-8580 (o) • lahcommercial.com

Information deemed reliable but not guaranteed.

YARD



AUSTIN BLAIR

ablair@lahcommercial.com | (205) 478-7805

PERRY KING

pking@lahcommercial.com | (205) 873-0584

LAH COMMERCIAL
REAL ESTATE

2850 Cahaba Road, Suite 200 • Birmingham, AL 35223 • 205-870-8580 (o) • lahcommercial.com

Information deemed reliable but not guaranteed.

FLOOR PLAN

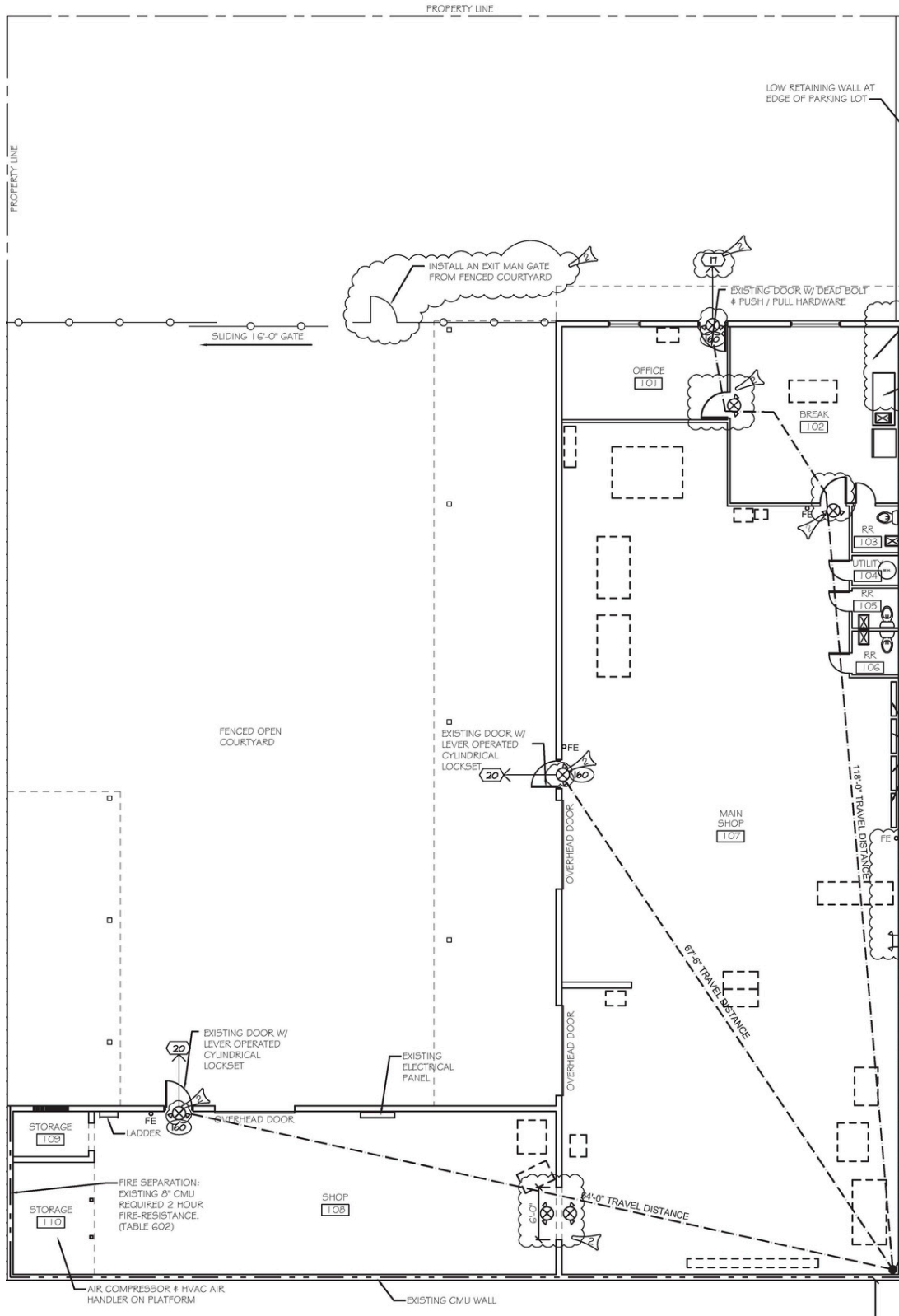

AUSTIN BLAIR
 ablair@lahcommercial.com | (205) 478-7805
PERRY KING
 pking@lahcommercial.com | (205) 873-0584



2850 Cahaba Road, Suite 200 • Birmingham, AL 35223 • 205-870-8580 (o) • lahcommercial.com

Information deemed reliable but not guaranteed.