

Governors Club Professional Center 144 Kings Hwy, Dover, DE 19901

Carol Plummer, Director

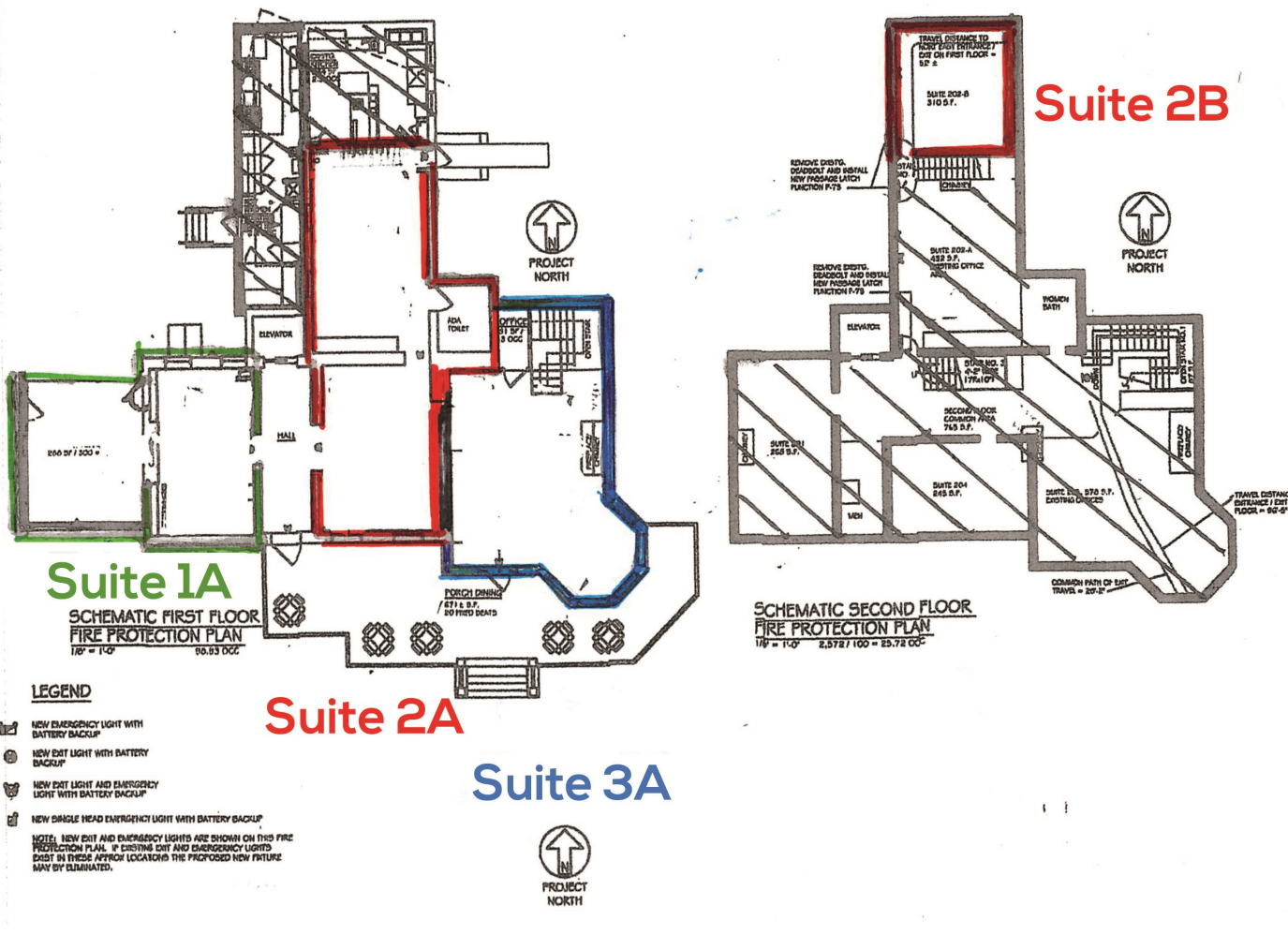

Elegant Ground Floor Suites
Overlook Governor's Mansion
Close to Legislature, Courts,
State Government Buildings

STE 1A = 503 sf STE 2A = 655 sf
STE 2B = 310 sf STE 3A = 576 sf

KW COMMERCIAL
200 Bellevue Pkwy Ste 415
Wilmington, DE 19809
302-299-1100 Office
302-632-3311 Cell
302-526-2991 Fax

Carol Plummer, Director



KW COMMERCIAL
200 Bellevue Pkwy Ste 415
Wilmington, DE 19809
302-299-1100 Office
302-632-3311 Cell
302-526-2991 Fax