

# ORCHARD DR

## LOCATION

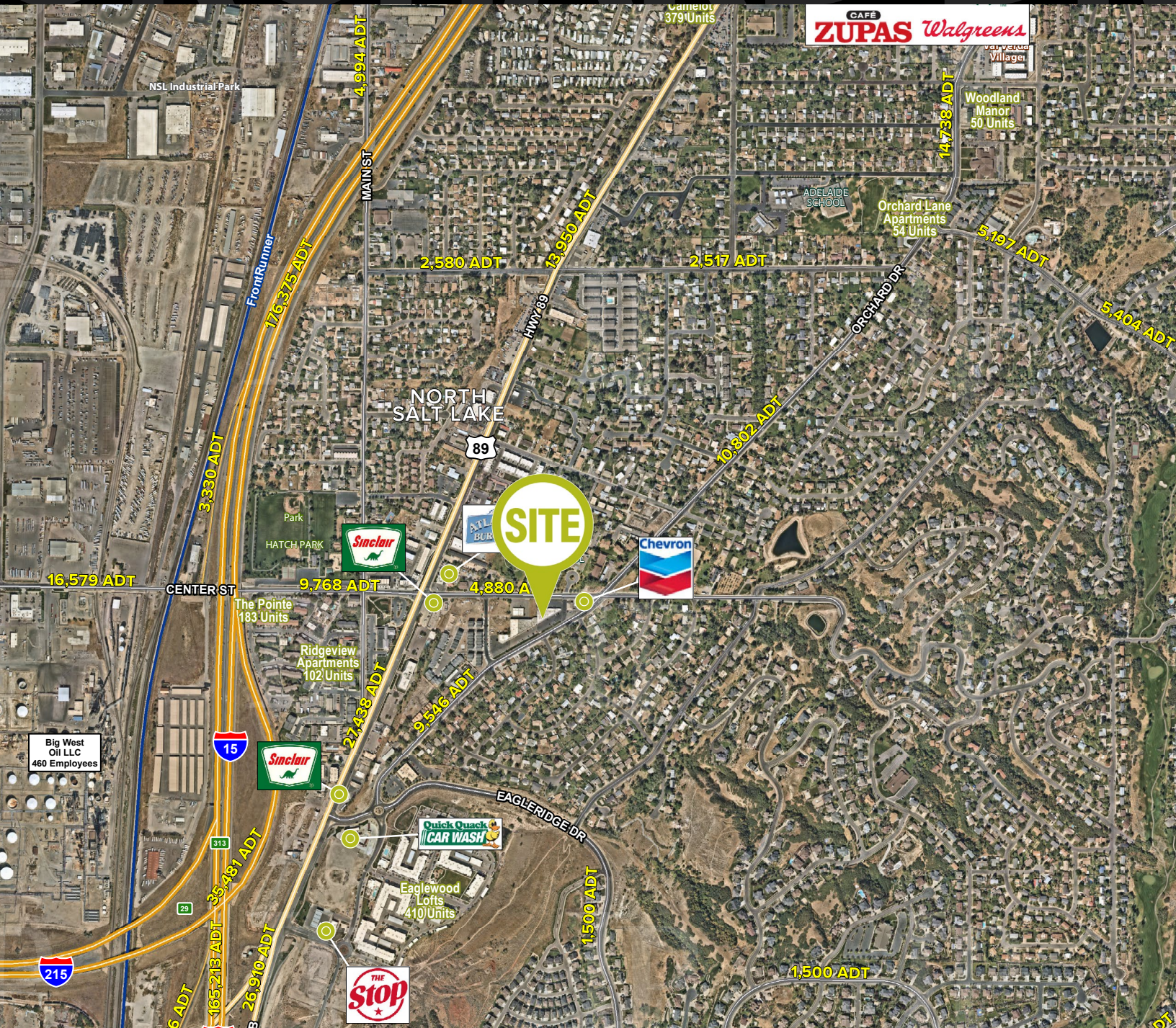

## ORCHARD PLAZA

60 S Orchard Drive | North Salt Lake, UT 84054



## HIGHLIGHTS

**MONICA TARANTINI**  
801.860.1074 | mtarantini@legendllp.com

**ALEXANDRA BRAND**  
801.349.7720 | abrand@legendllp.com

- AVAILABLE FOR LEASE
  - 1,200 SF
  - 1,804 SF
  - 2,000 SF
- RENTAL RATE: \$12 PSF
- NNN: \$3.34 PSF
- GREAT OFFICE SPACE

## DEMOGRAPHICS

	1 MILE	3 MILE	5 MILE
2022 EST. POPULATION	12,912	55,406	142,428
2027 PROJECTED POPULATION	13,946	58,204	150,108
2022 EST. DAYTIME POPULATION	4,841	33,303	83,965
2022 EST. AVG HH INCOME	\$91,384	\$108,144	\$102,462
2022 EST. HOUSEHOLDS	4,280	18,048	50,102
2022 EST. BUSINESSES	257	1,908	4,322

## TRAFFIC

**S ORCHARD DRIVE**  
10,802 VEHICLES PER DAY

**HIGHWAY 89**  
27,438 VEHICLES PER DAY



## LEGEND PARTNERS

801.930.6750 | www.legendllp.com  
2180 S 1300 E, Suite 240 | Salt Lake City, UT 84106



© Legend Partners, LLP. All rights reserved. All information contained herein is from sources deemed reliable; however, no representation or warranty is made to the accuracy thereof.



NORTH SALT LAKE CITY CENTER  
BRIGHTON HOMES

ATLANTIS BURGERS

E CENTER ST 4,880 VPD

NACHO HOUSE MEXICAN GRILL

BUFFALO BARBERS

SPECIAL EFFECT SUPPLY CORP

LAKEY INTERNATIONAL



#210 2,000 SF

#212 1,200 SF

#60 1,804 SF



S ORCHARD DR 9,546 VPD

HWY-89 27,438 VPD

UTAH LOCAL GOVERNMENTS TRUST

60 S ORCHARD DRIVE  
1,804 SF



210 E CENTER ST  
2,000 SF

