**FOR LEASE**

Harry Karageorge
0417 355 911

Office
336 Williamstown Rd,
Yarraville 9939 1717

Footscray

2A /8-18 Whitehall Street

Commercial Tenancy Suit Medical/Office/Retail

- 175 sqm of floor space over two levels (commercial 1 zone)
- Three onsite car spaces
- Kitchenette facilities with WWC's & shower facility
- Newly refurbished fit out with flexible floor plan
- Communal rooftop garden



2-2A/8-18 Whitehall Street, Footscray

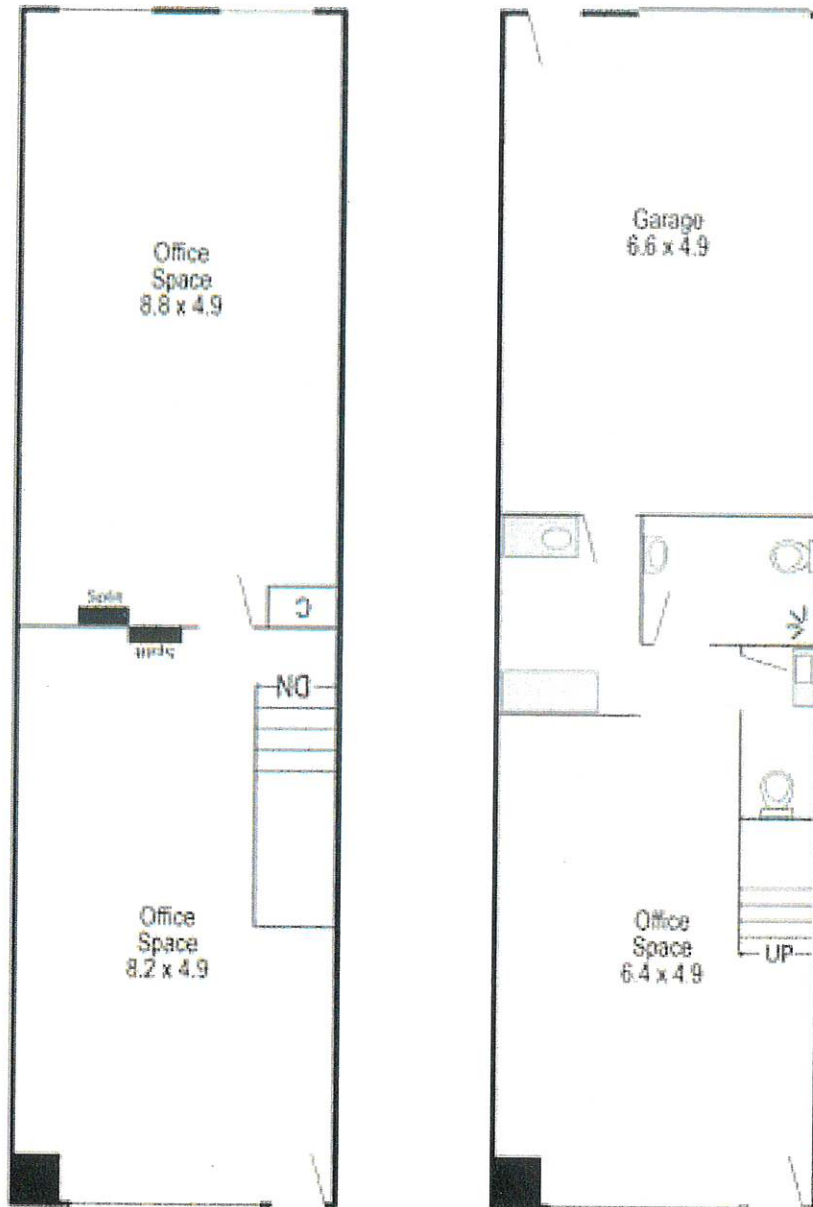

Footscray 2A /8-18 Whitehall St

Considering selling?

We will provide an assessment of the value of your property, free of charge or obligation. If this property is of interest to you, please register so that every effort can be made to contact you if sale is imminent.

Harry Karageorge 0417 355 911