

20400

CENTURY BLVD

GERMANTOWN, MD 20874

19,692 SF
AVAILABLE
NOW

Lab & Office Space

For Sublease

Term through February 2034



Building Highlights

- Recently delivered lab and office
- 18 chemical fume hoods (varying sizes) throughout
- Ability to construct additional chemical storage on site
- Shared lab amenities to include autoclave, glass wash, and ice maker
- Shared office amenities to include tenant lounge, outdoor patio, and conference
- Common generator to the building

301-337-4700

www.scheerpartners.com

 **Scheer Partners**
A Reputation for Results

Floor Plan

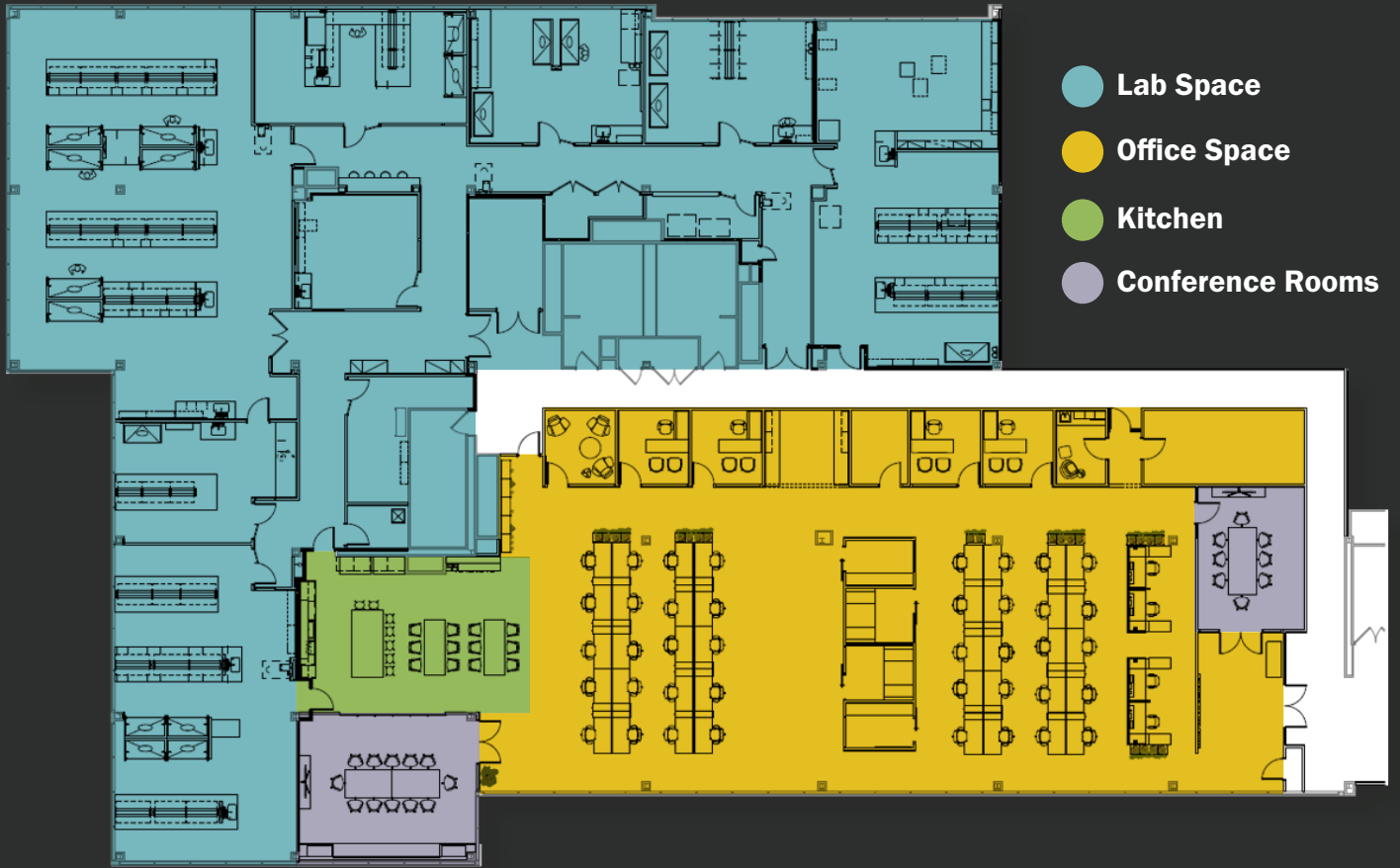

Building Photos



Lab



Lab



Lab



Office



Conference Room



Private Offices



Outdoor Patio



Tenant Lounge

Well-Connected Montgomery County Location

Located in Germantown's primary commercial corridor, 20400 Century Blvd offers direct access to Interstate 270, providing convenient connectivity throughout Montgomery County and the greater Washington, D.C. metro region. The property is minutes from a wide range of retail, dining, and service amenities at nearby destinations such as Germantown Town Center and surrounding commercial hubs, offering everyday convenience while maintaining an efficient, business-focused setting.

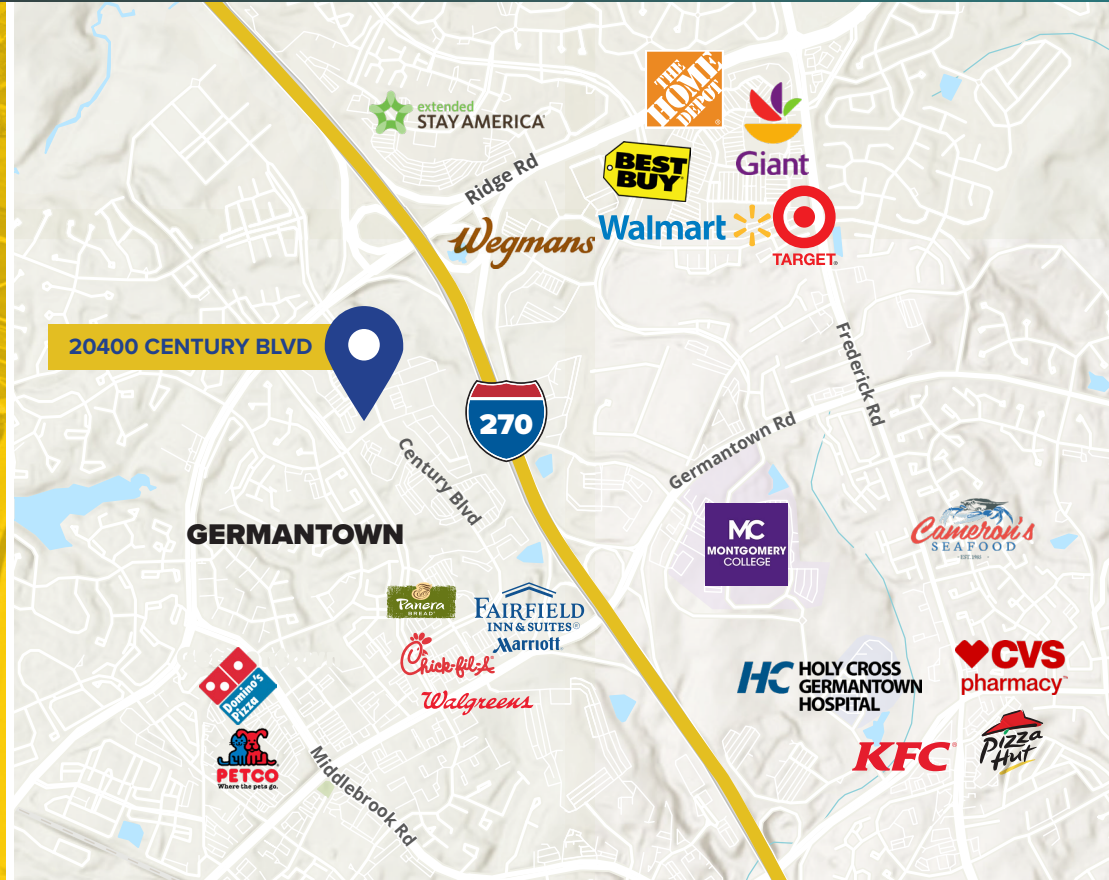

For Leasing Opportunities:

Matthew Brady

Executive Vice President

301.980.0641

mbrady@scheerpartners.com

Andrew Davis

Senior Vice President

203.803.7283

adavis@scheerpartners.com

301.337.4700

www.scheerpartners.com