



# FOR SUBLEASE

**±20,365 SF INDUSTRIAL BUILDING WITH ±4,716 SF OFFICE SPACE**  
9160 NORWALK BLVD | SANTA FE SPRINGS | CA

## PROPERTY HIGHLIGHTS:

- ± 20,365 SF Available
- ± 4,716 SF Office
- Outstanding Distribution Space in Mid-Countries
- 3 Dock High w/ EOD Levelers + Ramp
- 24' Clearance
- .45 GPM/3,000 SF Fire Sprinkler
- Good Access to 5, 605, 105, and 60 Freeways
- Sublease Through 8/31/2032

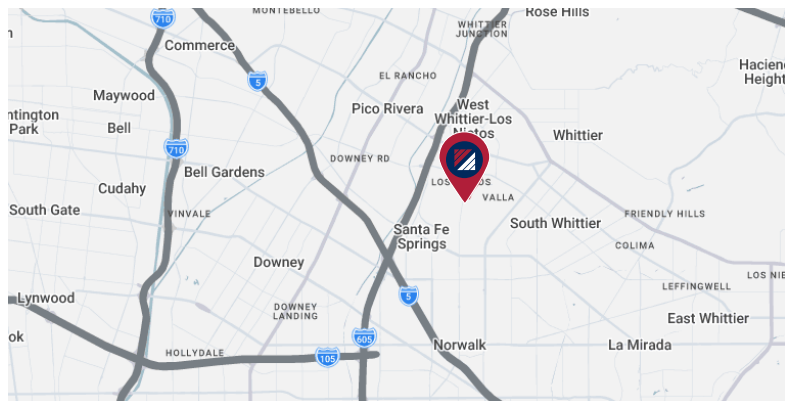

## FOR MORE INFORMATION, PLEASE CONTACT:

**IAN GROSSMAN**  
ASSOCIATE VICE PRESIDENT  
P: 213.270.2219 | M: 914.610.5398  
igrossman@daumcre.com  
CADRE #02179242

**RYAN ZURCHER**  
ASSOCIATE  
P: 213.270.2268 | M: 714.651.9068  
rzurcher@daumcre.com  
CADRE #02238179

**RICH ATNIP**  
ASSOCIATE  
P: 562.207.3310 | M: 714.722.1594  
ratnip@daumcre.com  
CADRE #02347863



# GALLERY



**FOR MORE INFORMATION, PLEASE CONTACT:**

**IAN GROSSMAN**  
ASSOCIATE VICE PRESIDENT  
P: 213.270.2219 | M: 914.610.5398  
igrossman@daumcre.com  
CADRE #02179242

**RYAN ZURCHER**  
ASSOCIATE  
P: 213.270.2268 | M: 714.651.9068  
rzurcher@daumcre.com  
CADRE #02238179

**RICH ATNIP**  
ASSOCIATE  
P: 562.207.3310 | M: 714.722.1594  
ratnip@daumcre.com  
CADRE #02347863



# GALLERY

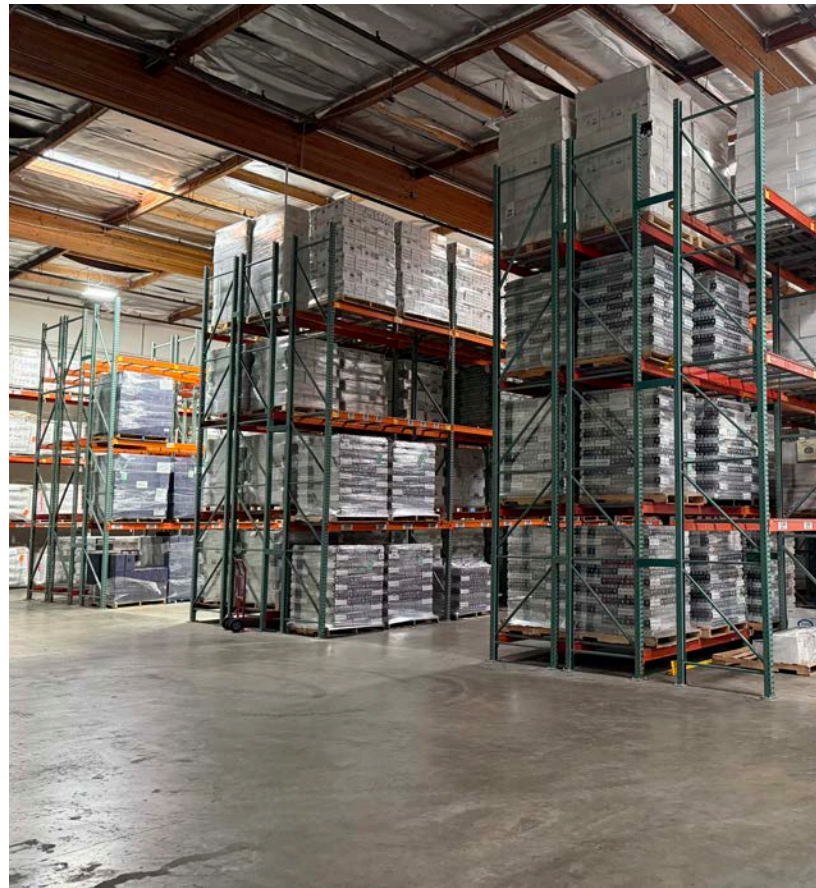

**FOR MORE INFORMATION, PLEASE CONTACT:**

**IAN GROSSMAN**  
ASSOCIATE VICE PRESIDENT  
P: 213.270.2219 | M: 914.610.5398  
igrossman@daumcre.com  
CADRE #02179242

**RYAN ZURCHER**  
ASSOCIATE  
P: 213.270.2268 | M: 714.651.9068  
rzurcher@daumcre.com  
CADRE #02238179

**RICH ATNIP**  
ASSOCIATE  
P: 562.207.3310 | M: 714.722.1594  
ratnip@daumcre.com  
CADRE #02347863



# SITE PLAN



**\*NOT TO SCALE**

**FOR MORE INFORMATION, PLEASE CONTACT:**

**IAN GROSSMAN**  
 ASSOCIATE VICE PRESIDENT  
 P: 213.270.2219 | M: 914.610.5398  
 igrossman@daumcre.com  
 CADRE #02179242

**RYAN ZURCHER**  
 ASSOCIATE  
 P: 213.270.2268 | M: 714.651.9068  
 rzurcher@daumcre.com  
 CADRE #02238179

**RICH ATNIP**  
 ASSOCIATE  
 P: 562.207.3310 | M: 714.722.1594  
 ratnip@daumcre.com  
 CADRE #02347863



# FLOOR PLAN

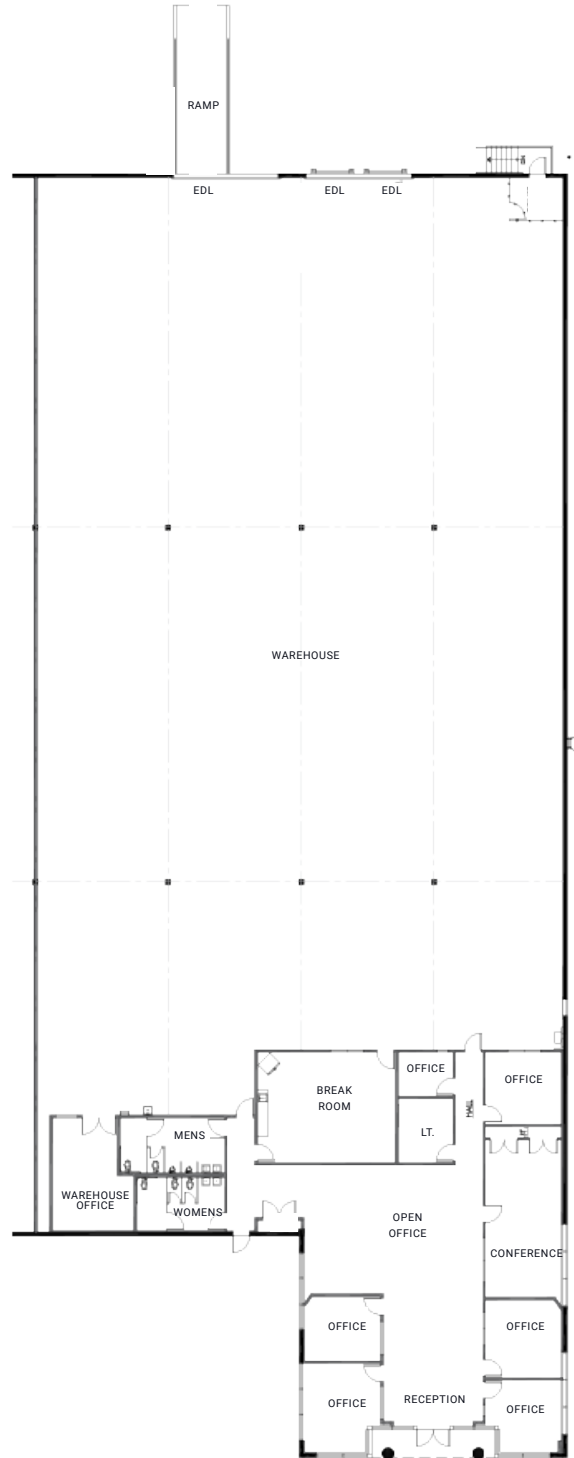

**\*NOT TO SCALE**

**FOR MORE INFORMATION, PLEASE CONTACT:**

**IAN GROSSMAN**  
ASSOCIATE VICE PRESIDENT  
P: 213.270.2219 | M: 914.610.5398  
igrossman@daumcre.com  
CADRE #02179242

**RYAN ZURCHER**  
ASSOCIATE  
P: 213.270.2268 | M: 714.651.9068  
rzurcher@daumcre.com  
CADRE #02238179

**RICH ATNIP**  
ASSOCIATE  
P: 562.207.3310 | M: 714.722.1594  
ratnip@daumcre.com  
CADRE #02347863



# LOCATION & AMENITY MAPS

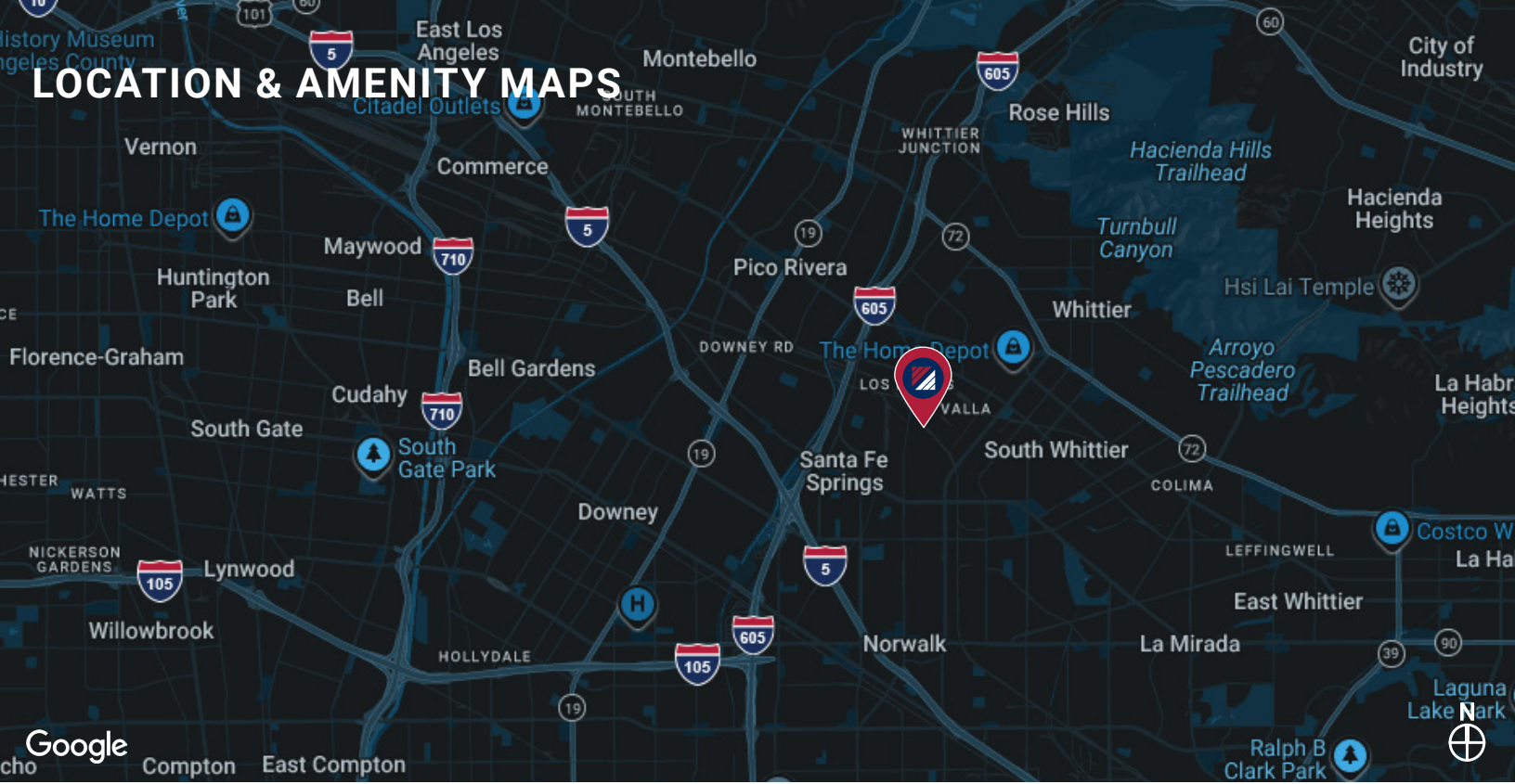

FOR MORE INFORMATION, PLEASE CONTACT:

**IAN GROSSMAN**  
 ASSOCIATE VICE PRESIDENT  
 P: 213.270.2219 | M: 914.610.5398  
 igrossman@daumcre.com  
 CADRE #02179242

**RYAN ZURCHER**  
 ASSOCIATE  
 P: 213.270.2268 | M: 714.651.9068  
 rzurcher@daumcre.com  
 CADRE #02238179

**RICH ATNIP**  
 ASSOCIATE  
 P: 562.207.3310 | M: 714.722.1594  
 ratnip@daumcre.com  
 CADRE #02347863



D/AQ Corp. #01129558. Maps Courtesy ©Google & ©Microsoft. Although all information is furnished regarding for sale, rental or financing is from sources deemed reliable, such information has not been verified and no express representation is made nor is any to be implied as to the accuracy thereof, and it is submitted subject to errors, omissions, changes of price, rental or other conditions, prior sale, lease or financing, or withdrawal without notice.