

FOR SALE
437 Central Avenue, Pawtucket, RI
\$595,000

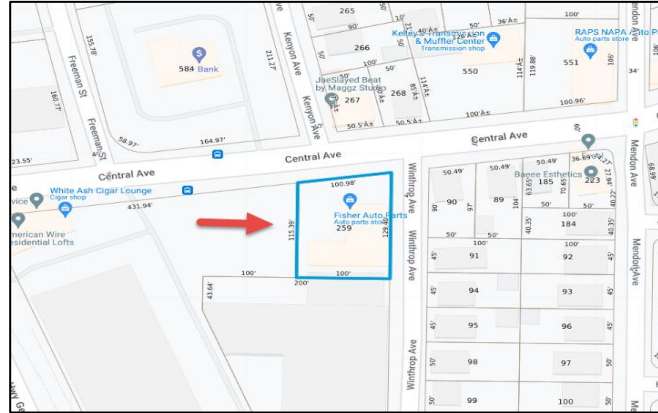

- Site: 12,239 SF
- Utilities: All
- Zoning: MB
- Building: Circa 1962, one level masonry block retail.
- Heat/AC: Package HVAC, roof mounted
- Roof: Tar and gravel
- Foundation: Slab on grade
- Parking: 18 cars
- Taxes: \$6,350.00

High visibility 4,900 SF retail property located between Newport Avenue and Cottage Street. Traffic count 14,000 VPD. Currently occupied by Fisher Auto Parts, leaving end of October 2026.



Peter M. Scotti
Peter M. Scotti & Associates
24 Bridge Street, Providence, RI 02903
401-421-8888 Ext. 13
pmgbs@scottire.net