



**NORTHPARK
LOGISTICS**

Colliers

**HAMILTON
DEVELOPMENT**



21,600 - 131,220 SF AVAILABLE
NORTHPARK LOGISTICS - BUILDING 2

4175 Guthrie Hwy | Clarksville, TN

FOR LEASE

OR

BUILD-TO-SUIT

Zac Cypress, CCIM

Principal & Executive Vice President

Dir. 615 491 5161

zac.cypress@colliers.com

Max Smith, SIOR

Principal & Executive Vice President

Dir. 615 429 4509

max.smith@colliers.com

Luke Price

Associate

Dir. 615 850 2747

luke.price@colliers.com

HIGHWAY 79

SITE PLAN

AVAILABLE

BUILDING 2

131,220 SF
±124 CAR PARKS
±43 TRAILER PARKS
32' CLEAR HEIGHT

BUILDING 3

131,220 SF
±132 CAR PARKS
±51 TRAILER PARKS
32' CLEAR HEIGHT

BUILDING 5

530,880 SF

LEASED

BUILDING 1

206,752 SF

LEASED

BUILDING 4

74,196 SF
±88 CAR PARKS
32' CLEAR HEIGHT

BUILDING 7

131,220 SF
±136 CAR PARKS
32' CLEAR HEIGHT

BUILDING 6

108,864 SF
±127 CAR PARKS
±26 TRAILER PARKS
32' CLEAR HEIGHT

BUILDING 8

108,864 SF
±129 CAR PARKS
32' CLEAR HEIGHT

BUILDING 9

63,504 SF
±70 CAR PARKS
±22 TRAILER PARKS
32' CLEAR HEIGHT



BUILDING 12

254,136 SF
±168 CAR PARKS
±64 TRAILER PARKS
32' CLEAR HEIGHT

BUILDING 11

254,136 SF
±170 CAR PARKS
±70 TRAILER PARKS
32' CLEAR HEIGHT

BUILDING 10

145,476 SF
±126 CAR PARKS
±29 TRAILER PARKS
32' CLEAR HEIGHT

RJ CORMAN

BUILDING 2 OVERVIEW

State-of-the-art Class A Industrial Park
with excellent access to Interstate 24.

Total Available SF 131,220 | Office - 3,140 SF

Divisible SF 21,600

Dock Doors 30 (9' x 10') with levelers

Grade Level Doors 4 (14' x 16')

Clear Height 32'

Column Spacing 54' x 50' (60' speed bay)

Building Dimensions 200' x 648'

Sprinkler System ESFR with common fire pump

Electrical Power 2 800 amps (expandable)

Truck Court Depth 180'

Trailer Parks 43

Auto Parks 124

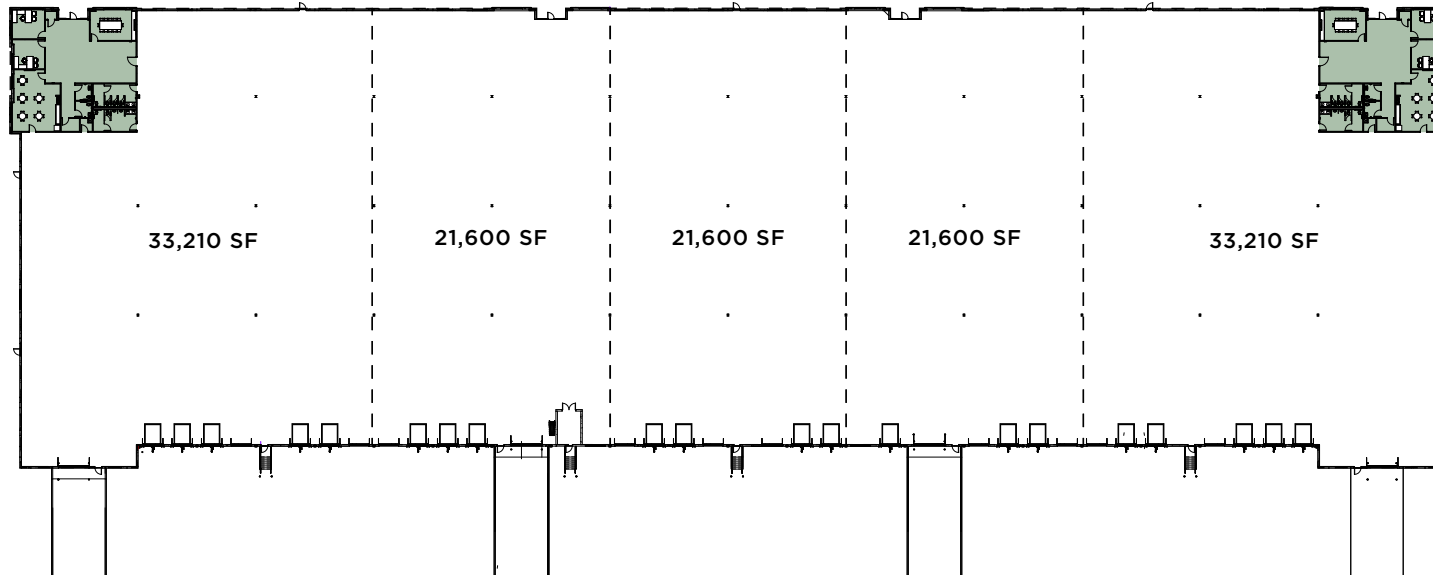

Any and all
spaces can be
combined



Colliers

HAMILTON
DEVELOPMENT

NORTHPARK LOGISTICS - BUILDING 2

Zac Cypress, CCIM

Principal & Executive Vice President

Dir. 615 491 5161

zac.cypress@colliers.com

Max Smith, SIOR

Principal & Executive Vice President

Dir. 615 429 4509

max.smith@colliers.com

Luke Price

Associate

Dir. 615 850 2747

luke.price@colliers.com