

# 1313 NORTH MARKET

Downtown Wilmington, Delaware

## 4th Floor

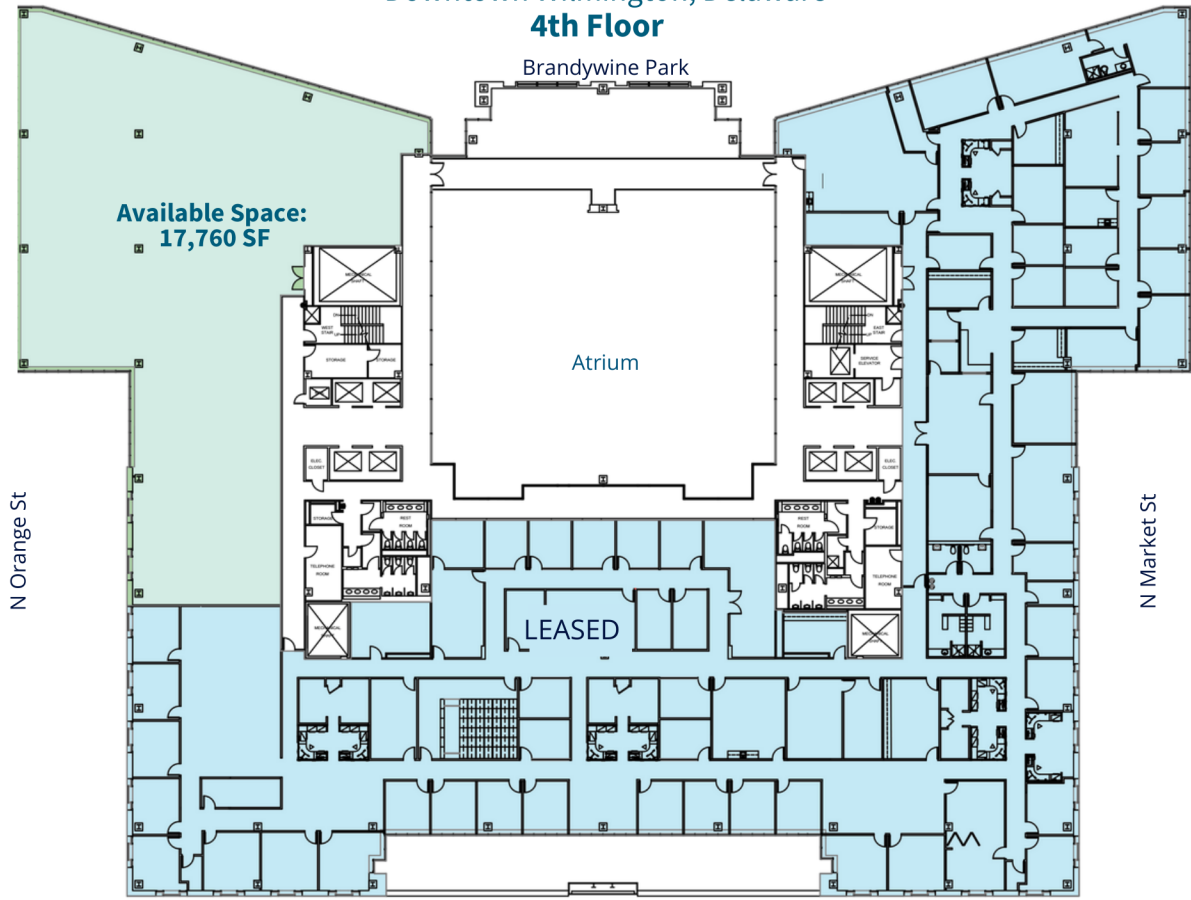



## Trophy Office Opportunity

1313 North Market is an award-winning architectural gem. Our 12-story, Class A office building is minutes from all downtown Wilmington has to offer. Incredible amenities, stellar customer service, expansive green space, and availability of over 2,000 parking spaces makes 1313 N. Market a highly sought-after location where employees love coming to work. JCRE leases and manages the building – providing full engagement and quick response times.



### The Chancery Market Food Hall

The Chancery Market Food Hall, opened in December 2022, is a 12,000-square-foot culinary collective with 8 different food concepts, indoor/outdoor bar, and private dining and event space.



### Park-Like Setting in the CBD

Views of the beautiful Brandywine Park are abundant from the north side of the building. These picturesque views and park-like setting aren't found in any other area of Wilmington's Central Business District.



### Technology Worth Bragging About

Not only are we WiredScore Platinum Certified, but on-site multi-tenant data center provider DaSTOR, as well as 15 on-site internet & dark fiber providers ensures your business will always have the connectivity you need.



## 1313 NORTH MARKET

Downtown Wilmington, Delaware

Class A office. Amenities. State-of-the-art technology.

- Class A Office Building with spectacular 12-story open atrium
- Virtually column-free floor plates allow tenants to customize their space to maximize operating efficiency
- Unobstructed views of rivers, park, downtown skyline
- On-site building management with 24/7 security

## PROPERTY FEATURES

- GLA (SF): 505,000
- LAND ACRES: 2.69
- YEAR BUILT: 1982
- YEAR RENOVATED: 2013
- ZONING TYPE: C-4
- BUILDING CLASS: A
- NUMBER OF STORIES: 12
- NUMBER OF PARKING SPACES: 138 Covered Parking Spaces

## NEIGHBORING PROPERTIES

- NORTH: Brandywine Park
- SOUTH: Office
- EAST: Hotels
- WEST: Residential

## LOCATION HIGHLIGHTS

- Park-like setting not found anywhere else in downtown Wilmington
- Less than a mile walk to the Leonard L. Williams Justice Center
- Minutes from regional highways and mass transit
- Abundant restaurants, cafes, hotels and entertainment – all within walking distance

## BUILDING AMENITIES

- Plentiful on-site Parking
- Fitness center with upgrades scheduled to begin in 2023
- Common areas with collaborative spaces
- Home to The Chancery Market Food Hall

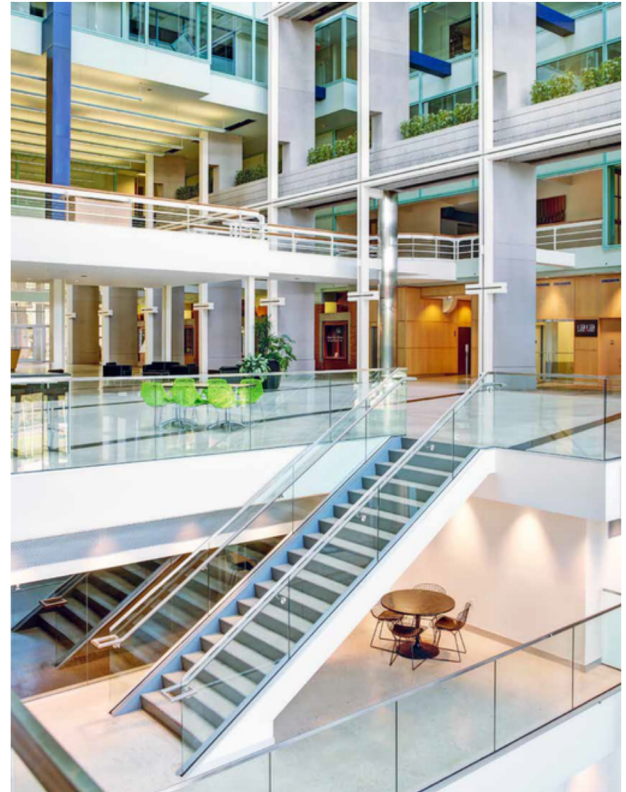

## TECHNOLOGY FEATURES

- WiredScore Platinum Certified
- DaSTOR multi-tenant data center provider on site
- 15 on-site internet and dark fiber providers

## Leasing Information:

Scott Johnson, Partner, Broker  
 (302) 437-4990  
 SJohnson@jcomre.com



JOHNSON  
 COMMERCIAL  
 REAL ESTATE