



# 16 NEW STREET | HEWLETT, NEW YORK



## PROPERTY OVERVIEW

- Located on New Street between Station Plaza, Hewlett Plaza and Broadway, in the heart of the hamlet of Hewlett, Nassau County,
- Prime corner offers outstanding visibility
- Within two blocks of the Hewlett LIRR station
- Neighboring retailers include: Trader Joe's, Duane Reade, Subway, TD Bank, Wells Fargo Bank, Capital One Bank
- Property located within the affluent Five Towns area (Cedarhurst, Lawrence, Woodmere, Hewlett, Island Park)

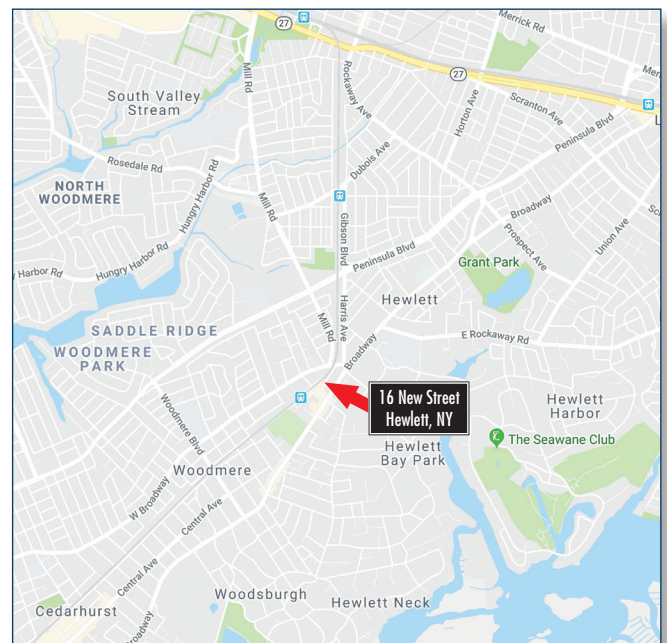

DEMOGRAPHICS	1 MILE	3 MILES	5 MILES
▪ Population	20,541	174,881	553,814
▪ Average HH Income	\$177,640	\$138,990	\$123,470
▪ Total HH	6,798	58,448	188,140
▪ Median Age	41.9	40.0	40.0





# 16 NEW STREET | HEWLETT, NEW YORK

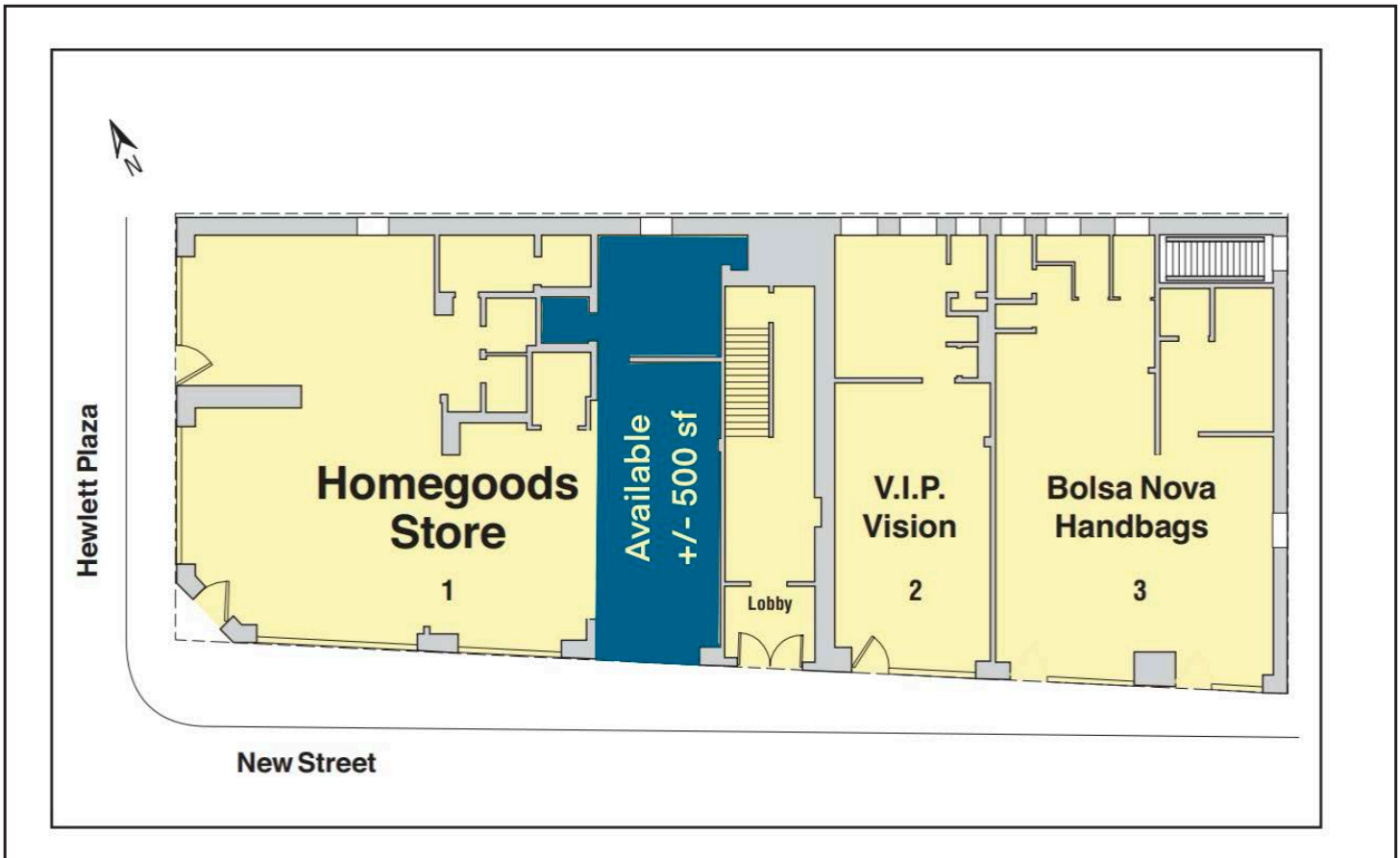

## PROPERTY BUSINESSES

1. Homegoods Store
2. V.I.P. Vision Eye Care
3. Bolsa Nova Handbags
4. **Available +/- 500 sf**



**CONTACT: Michael Robbins** | T: 212-951-3828 | F: 212-545-1355 | [mrobbins@pihc.com](mailto:mrobbins@pihc.com)

All areas and dimensions are approximate. This plan is intended for identification purposes only and is not to be deemed a representation by Landlord as to the accuracy or square footage.

