

*Plug & Play Sublease
in the Heart of
Downtown Denver*

AVAILABLE FOR SUBLEASE

TABOR CENTER

1200 17TH STREET
DENVER, CO 80202



**CUSHMAN &
WAKEFIELD**

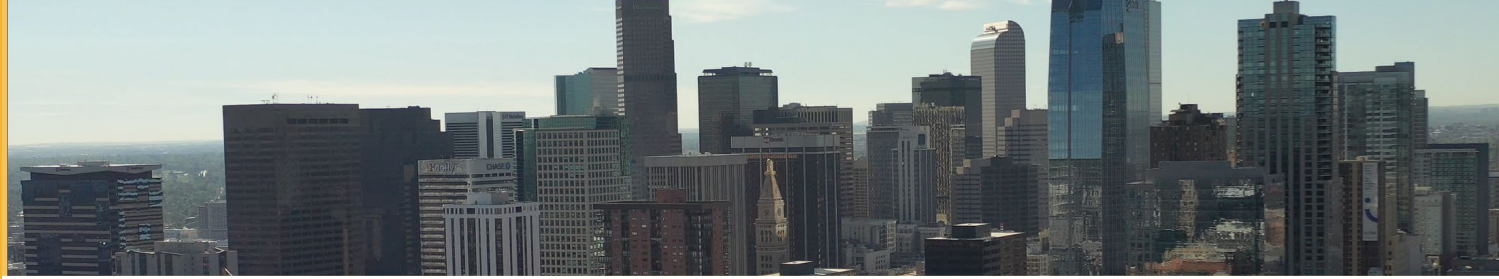

SUITE 2300
22,461 RSF

PROPERTY HIGHLIGHTS

BUILDING SIZE	696,000 RSF
AVAILABLE SUITES	Suite 2300: 22,461 RSF (can demise to approx. 8k RSF)
TERM	Thru 11/30/2033 (open to shorter term)
AVAILABILITY	30 Days
ASKING RATE	Negotiable
FURNITURE	Available

BUILDING HIGHLIGHTS

- Ample mountain views
- Large windows provide abundant natural light
- Colorado Athletic Club in building
- Numerous F&B/retail within walking distance
- Property management on-site
- Immediate access to newly renovated 16th Street and RTD shuttle

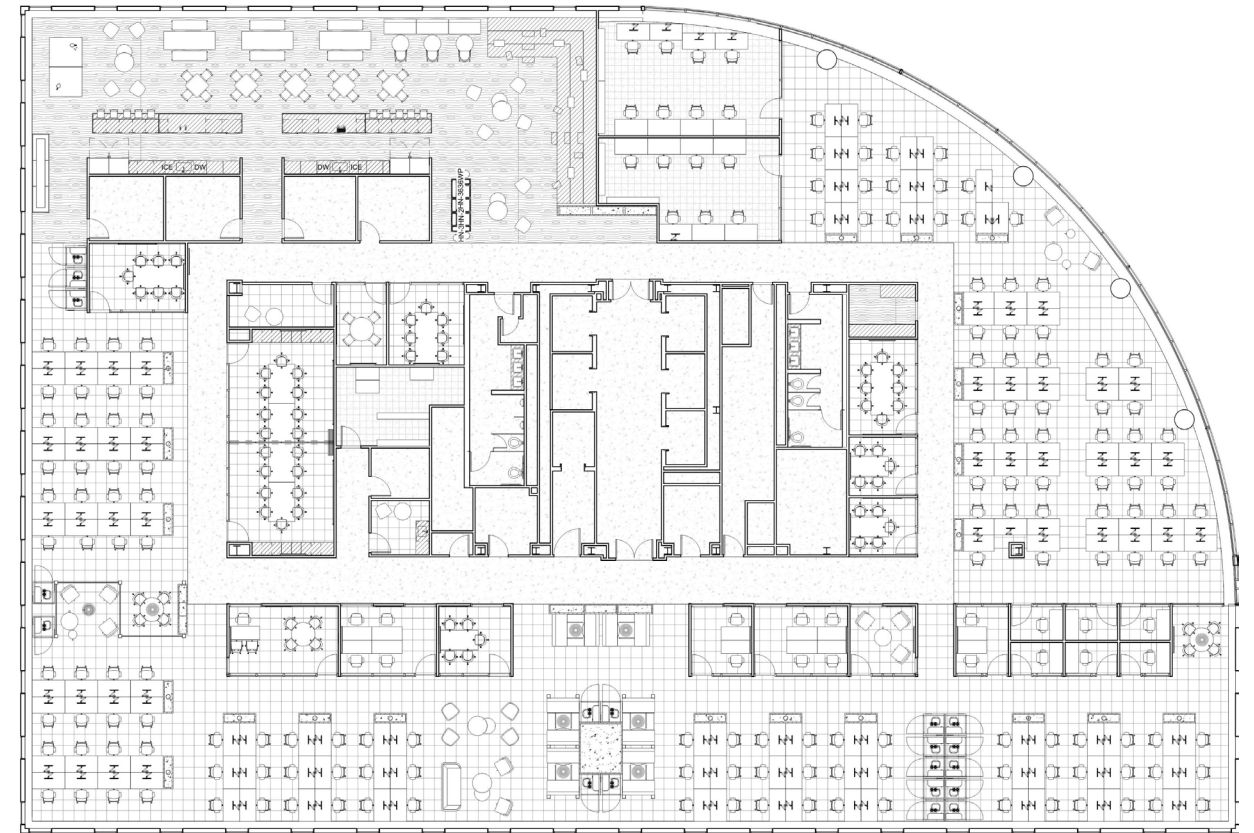

360° *Click to View Matterport*





The DENVER CENTRAL MARKET
H. H. Tammen 1928

RINO



UNION STATION
EST. 1881

MCGREGOR SQUARE

DAIRY BLOCK

LARIMER ST

BROADWAY

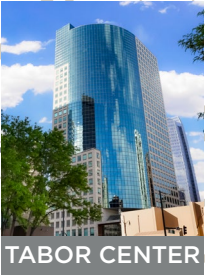

TABOR CENTER

MARKET STATION

Larimer Square

NEWLY RENOVATED 16TH STREET

Ball Arena

METROPOLITAN STATE UNIVERSITY OF DENVER

DENVER PAVILIONS

COLORADO CONVENTION CENTER



COLORADO STATE CAPITOL



GOLDEN TRIANGLE

DENVER art MUSEUM

For more information, please contact:

MICHAEL COPPOLA
Director
+1 303 312 4212
michael.coppola@cushwake.com

TODD WHEELER
Vice Chair
+1 303 813 6441
todd.wheeler@cushwake.com



©2025 Cushman & Wakefield. All rights reserved. The information contained in this communication is strictly confidential. This information has been obtained from sources believed to be reliable but has not been verified. NO WARRANTY OR REPRESENTATION, EXPRESS OR IMPLIED, IS MADE AS TO THE CONDITION OF THE PROPERTY (OR PROPERTIES) REFERENCED HEREIN OR AS TO THE ACCURACY OR COMPLETENESS OF THE INFORMATION CONTAINED HEREIN, AND SAME IS SUBMITTED SUBJECT TO ERRORS, OMISSIONS, CHANGE OF PRICE, RENTAL OR OTHER CONDITIONS, WITHDRAWAL WITHOUT NOTICE, AND TO ANY SPECIAL LISTING CONDITIONS IMPOSED BY THE PROPERTY OWNER(S). ANY PROJECTIONS, OPINIONS OR ESTIMATES ARE SUBJECT TO UNCERTAINTY AND DO NOT SIGNIFY CURRENT OR FUTURE PROPERTY PERFORMANCE.